

UNITED STATES  
DEPARTMENT OF THE INTERIOR  
BUREAU OF LAND MANAGEMENT

APPLICATION FOR PERMIT TO DRILL, DEEPEN, OR PLUG BACK

1a. TYPE OF WORK DRILL <input checked="" type="checkbox"/> DEEPEN <input type="checkbox"/> PLUG BACK <input type="checkbox"/>		5. LEASE DESIGNATION AND SERIAL NO. SF-078764 <del>8</del> Fee			
b. TYPE OF WELL OIL WELL <input type="checkbox"/> GAS WELL <input checked="" type="checkbox"/> OTHER <input type="checkbox"/>		6. IF INDIAN, ALLOTTEE OR TRIBE NAME			
2. NAME OF OPERATOR Northwest Pipeline Corporation		7. UNIT AGREEMENT NAME Rosa Unit			
3. ADDRESS OF OPERATOR 3539 East 30th Street - Farmington, NM 87401		8. FARM OR LEASE NAME Rosa Unit			
4. LOCATION OF WELL (Report location clearly and in accordance with any State requirements.) At surface 1315' FSL & 1020' FWL SE/4 SW/4 At proposed prod. zone Same		9. WELL NO. #219			
14. DISTANCE IN MILES AND DIRECTION FROM NEAREST TOWN OR POST OFFICE* Approximately 20 miles to Gobernador		10. FIELD AND POOL, OR WILDCAT Basin Fruitland Pool			
15. DISTANCE FROM PROPOSED* LOCATION TO NEAREST PROPERTY OR LEASE LINE, FT. (Also to nearest drlg. unit line, if any) 1020'		11. SEC., T., R., M., OR BLK. AND SURVEY OR AREA Sec. 19, T31N, R5W			
16. NO. OF ACRES IN LEASE N/A		12. COUNTY OR PARISH Rio Arriba			
17. NO. OF ACRES ASSIGNED TO THIS WELL 232.43		13. STATE New Mexico			
18. DISTANCE FROM PROPOSED LOCATION* TO NEAREST WELL, DRILLING, COMPLETED, OR APPLIED FOR, ON THIS LEASE, FT. + 2500'		20. ROTARY OR CABLE TOOLS Rotary			
21. ELEVATIONS (Show whether DF, RT, GR, etc.) DRILLING OPERATIONS AUTHORIZED ARE SUBJECT TO COMPLIANCE WITH ATTACHED PROPOSED CASING AND CEMENTING PROGRAM		22. APPROX. DATE WORK WILL START* 3-1-89			
SIZE OF HOLE		SIZE OF CASING	WEIGHT PER FOOT	SETTING DEPTH	
12-1/4"	9-5/8"	32.3#	200'	125 cu.ft.	
8-3/4"	7"	20#	3002'	150 cu.ft.	
6-1/4"	5-1/2"	23#	3153'	Open hole completion	

The S/2 of Section 19 is dedicated to this well.

RECEIVED  
BLM MAIL ROOM  
88 NOV 15 PM 12:58  
ARMINGTON RESOURCE AREA  
FARMINGTON, NEW MEXICO

RECEIVED  
AUG 13 1989  
OIL CON. DIV  
DIST. 3

IN ABOVE SPACE DESCRIBE PROPOSED PROGRAM: If proposal is to deepen or plug back, give data on present productive zone and proposed new productive zone. If proposal is to drill or deepen directionally, give pertinent data on subsurface locations and measured and true vertical depths. Give blowout preventer program, if any.

24. SIGNED <u>Mike Turnbaugh</u> TITLE <u>Sr. Engineer</u>		DATE <u>11-11-89</u>	
(This space for Federal or State office use)		APPROVED AS AMENDED	
PERMIT NO. _____		APPROVAL DATE _____	
APPROVED BY _____		TITLE _____	
CONDITIONS OF APPROVAL, IF ANY:		AREA MANAGER	

ch-1

NSP-1563 (L)  
2

\*See Instructions On Reverse Side

All distances must be from the outer boundaries of the Section.

Northwest Pipeline Corporation			Lease Rosa Unit		Well No. 219
Section 19	Township 31 North	Range 5 West	County Rio Arriba		
Actual Footage Location of Well:					
1315	feet from the South line and	1020	feet from the West line		
Ground Level Elev. 6290	Producing Formation Fruitland	Pool Basin Fruitland	Dedicated Acreage: 232.43		Acreage

1. Outline the acreage dedicated to the subject well by colored pencil or hatchure marks on the plat below.
2. If more than one lease is dedicated to the well, outline each and identify the ownership thereof (both as to working interest and royalty).
3. If more than one lease of different ownership is dedicated to the well, have the interests of all owners been consolidated by communitization, unitization, force-pooling, etc?

☒ Yes ☐ No If answer is "yes," type of consolidation unitization

If answer is "no," list the owners and tract descriptions which have actually been consolidated. (Use reverse side of this form if necessary.)

No allowable will be assigned to the well until all interests have been consolidated (by communitization, unitization, forced-pooling, or otherwise) or until a non-standard unit, eliminating such interests, has been approved by the Commission.

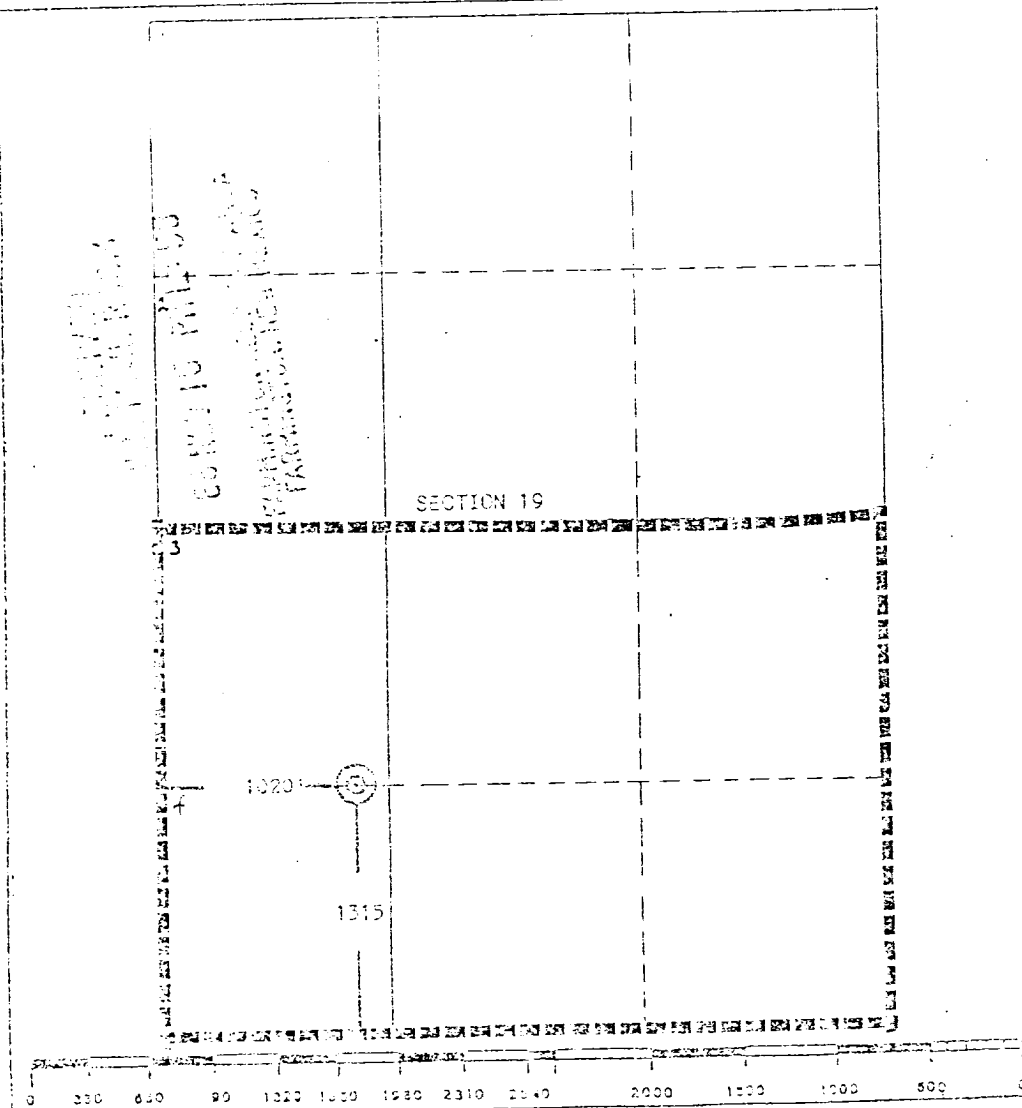

#### CERTIFICATION

I hereby certify that the information contained herein is true and complete to the best of my knowledge and belief.

Name

Mike Turnbaugh

Position

Senior Engineer

Company

Northwest Pipeline Corp.

Date

10-21-88

I hereby certify that the well location shown on this plat is correct and that the notes of actual survey made by me or under my supervision, and that the same is true and correct to the best of my knowledge.

Date Surveyed

September 14, 1983

Registered Professional Engineer and/or Land Surveyor

*Edgar L. Risenhoover*

Certificate No. 5919

Edgar L. Risenhoover, L.S.