

Submit to Appropriate
District Office
State Lease - 6 copies
Fee Lease - 5 copies

State of New Mexico
Energy, Minerals and Natural Resources Department

Form C-101
Revised 1-1-89

DISTRICT I
P.O. Box 1980, Hobbs, NM 88240

DISTRICT II
P.O. Drawer DD, Artesia, NM 88210

DISTRICT III
1000 Rio Brazos Rd., Aztec, NM 87410

OIL CONSERVATION DIVISION
P.O. Box 2088
Santa Fe, New Mexico 87504-2088

API NO. (assigned by OCD on New Wells) <u>30-039-24638</u>
5. Indicate Type of Lease STATE <input checked="" type="checkbox"/> FEE <input type="checkbox"/>
6. State Oil & Gas Lease No. E-346-25

APPLICATION FOR PERMIT TO DRILL, DEEPEN, OR PLUG BACK					
1a. Type of Work: DRILL <input checked="" type="checkbox"/> RE-ENTER <input type="checkbox"/> DEEPEN <input type="checkbox"/> PLUG BACK <input type="checkbox"/>				7. Lease Name or Unit Agreement Name San Juan 31-6 Unit	
b. Type of Well: OIL WELL <input type="checkbox"/> GAS WELL <input checked="" type="checkbox"/> OTHER <input type="checkbox"/>				8. Well No. 223	
2. Name of Operator Phillips Petroleum Co.				9. Pool name or Wildcat Basin Fruitland Coal Gas	
3. Address of Operator 300 W. Arrington, Suite 200, Farmington, NM 87401					
4. Well Location Unit Letter L : 1956 Feet From The South Line and 1162 Feet From The West Line Section 32 Township 31N Range 6W NMPM Rio Arriba County					
10. Proposed Depth 3109' (+)		11. Formation Fruitland		12. Rotary or C.T. Rotary	
13. Elevations (Show whether DF, RT, GR, etc.) 6312' (GL Unprepared)		14. Kind & Status Plug. Bond Blanket		15. Drilling Contractor Advise Later	
				16. Approx. Date Work will start Upon Approval	
17. PROPOSED CASING AND CEMENT PROGRAM E/2 320 Acres					
SIZE OF HOLE	SIZE OF CASING	WEIGHT PER FOOT	SETTING DEPTH	SACKS OF CEMENT	EST. TOP
12-1/4"	9-5/8"	36#, K-55	250'	200 sxs	Circ to Surface
8-1/2"	7"	23#, K-55	2875'	600 sxs	Circ to Surface
6-1/8"	5-1/2"	15.5# or 23#	3109		*

*If the coal is cleated a 5-1/2", 23#, P-110 liner will be run in the open hole without being cemented.

*If the coal is not cleated a 5-1/2", 15.5# liner will be run, cemented with 100 sxs cement and the well fractured.

Use mud additives as required for control.

BOP equipment: See attached schematic (Fig. 7-9 or 7-10)

APPROVAL EXPIRES 9-7-90
UNLESS DRILLING IS COMMENCED.
SPUD NOTICE MUST BE SUBMITTED
WITHIN 10 DAYS

IN ABOVE SPACE DESCRIBE PROPOSED PROGRAM: IF PROPOSAL IS TO DEEPEN OR PLUG BACK, GIVE DATA ON PRESENT PRODUCTIVE ZONE AND PROPOSED NEW PRODUCTIVE ZONE. GIVE BLOWOUT PREVENTER PROGRAM, IF ANY.

I hereby certify that the information above is true and complete to the best of my knowledge and belief.

SIGNATURE L. M. Sanders TITLE Supv. Regulatory Affairs DATE 3-6-90
TYPE OR PRINT NAME L. M. Sanders TELEPHONE NO. (505) 599-3431

(This space for State Use)

APPROVED BY E. M. Bush TITLE DEPUTY OIL & GAS INSPECTOR, DIST. #3 DATE MAR 27 1990
CONDITIONS OF APPROVAL, IF ANY:

ALL INFORMATION CONTAINED
HEREIN IS UNCLASSIFIED
DATE 01-11-2011 BY 60322
AUTHORITY 50 USC 3024

FIELD PRACTICES AND STANDARDS

ALTERNATIVE

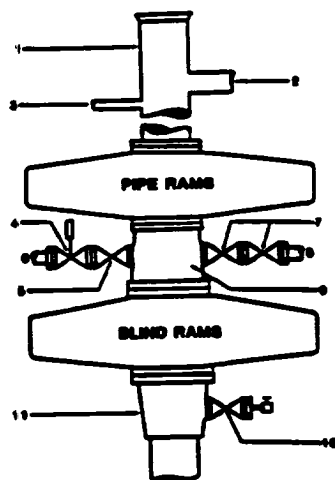

1. BELL NIPPLE
2. FLOW LINE
3. FILL-UP LINE
4. 2" FE PRESSURE OPERATED CHOKE LINE VALVE
5. 2" FE GATE VALVE
6. 2" FE CHOKE LINE TO MANIFOLD
7. 2" FE GATE VALVES
8. 2" FE KILL LINE
9. DRILLING SPOOL
10. 2" SE OR FE GATE VALVE WITH NEEDLE VALVE
11. CASING HEAD HOUSING

NOTE: THE DRILLING SPOOL MAY BE LOCATED BELOW BOTH SETS OF RAMS IF A DOUBLE PREVENTER IS USED AND IT DOES NOT HAVE SUITABLE OUTLETS BETWEEN RAMS

Figure 7-9. Standard Hydraulic Blowout Preventer Assembly
3 M Working Pressure Alternative 1

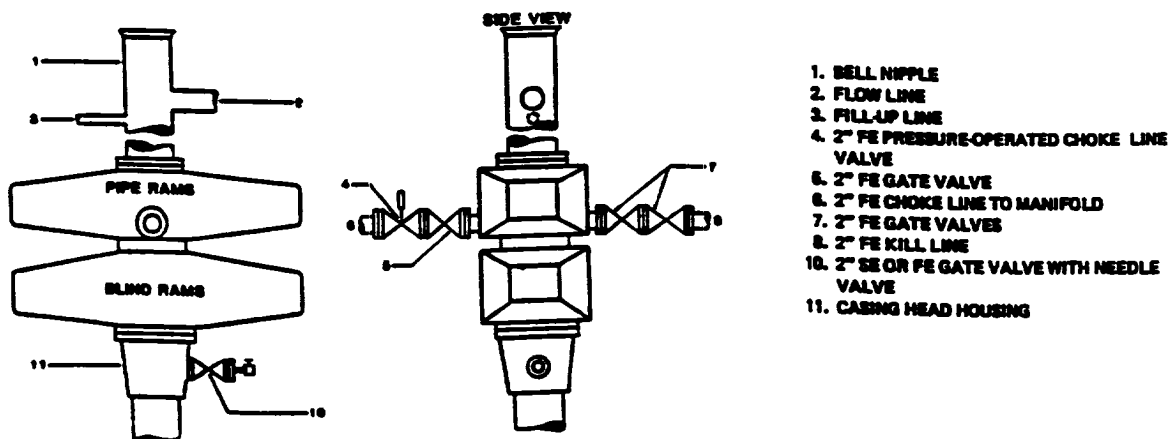

1. BELL NIPPLE
2. FLOW LINE
3. FILL-UP LINE
4. 2" FE PRESSURE-OPERATED CHOKE LINE VALVE
5. 2" FE GATE VALVE
6. 2" FE CHOKE LINE TO MANIFOLD
7. 2" FE GATE VALVES
8. 2" FE KILL LINE
9. 2" SE OR FE GATE VALVE WITH NEEDLE VALVE
11. CASING HEAD HOUSING

Figure 7-10. Standard Hydraulic Blowout Preventer Assembly
3 M Working Pressure Alternative 3 (without Drilling Spool)

Submit to Appropriate
District Office
State Lease - 4 copies
Fee Lease - 3 copies

State of New Mexico
Energy, Minerals and Natural Resources Department

Form C-102
Revised 1-1-89

OIL CONSERVATION DIVISION

P.O. Box 2088
Santa Fe, New Mexico 87504-2088

DISTRICT I
P.O. Box 1980, Hobbs, NM 88240

DISTRICT II
P.O. Drawer DD, Artesia, NM 88210

DISTRICT III
1000 Rio Brazos Rd., Aztec, NM 87410

WELL LOCATION AND ACREAGE DEDICATION PLAT

All Distances must be from the outer boundaries of the section

Operator PHILLIPS PETROLEUM			Lease SAN JUAN 31-6		Well No. 223
Unit Letter L	Section 32	Township T.31 N.	Range R.6 W.	County RIO ARriba COUNTY	
Actual Footage Location of Well: 1956 feet from the SOUTH line and 1162 feet from the WEST line					
Ground level Elev. 6312	Producing Formation Fruitland		Pool Basin Fruitland Coal Gas		Dedicated Acreage: 320 Acres

1. Outline the acreage dedicated to the subject well by colored pencil or hatchure marks on the plat below.
2. If more than one lease is dedicated to the well, outline each and identify the ownership thereof (both as to working interest and royalty).
3. If more than one lease of different ownership is dedicated to the well, have the interest of all owners been consolidated by communitization, unitization, force-pooling, etc?
☒ Yes ☐ No If answer is "yes" type of consolidation Unitization
If answer is "no" list the owners and tract descriptions which have actually been consolidated. (Use reverse side of this form if necessary.)
No allowable will be assigned to the well until all interests have been consolidated (by communitization, unitization, forced-pooling, or otherwise) or until a non-standard unit, eliminating such interest, has been approved by the Division.

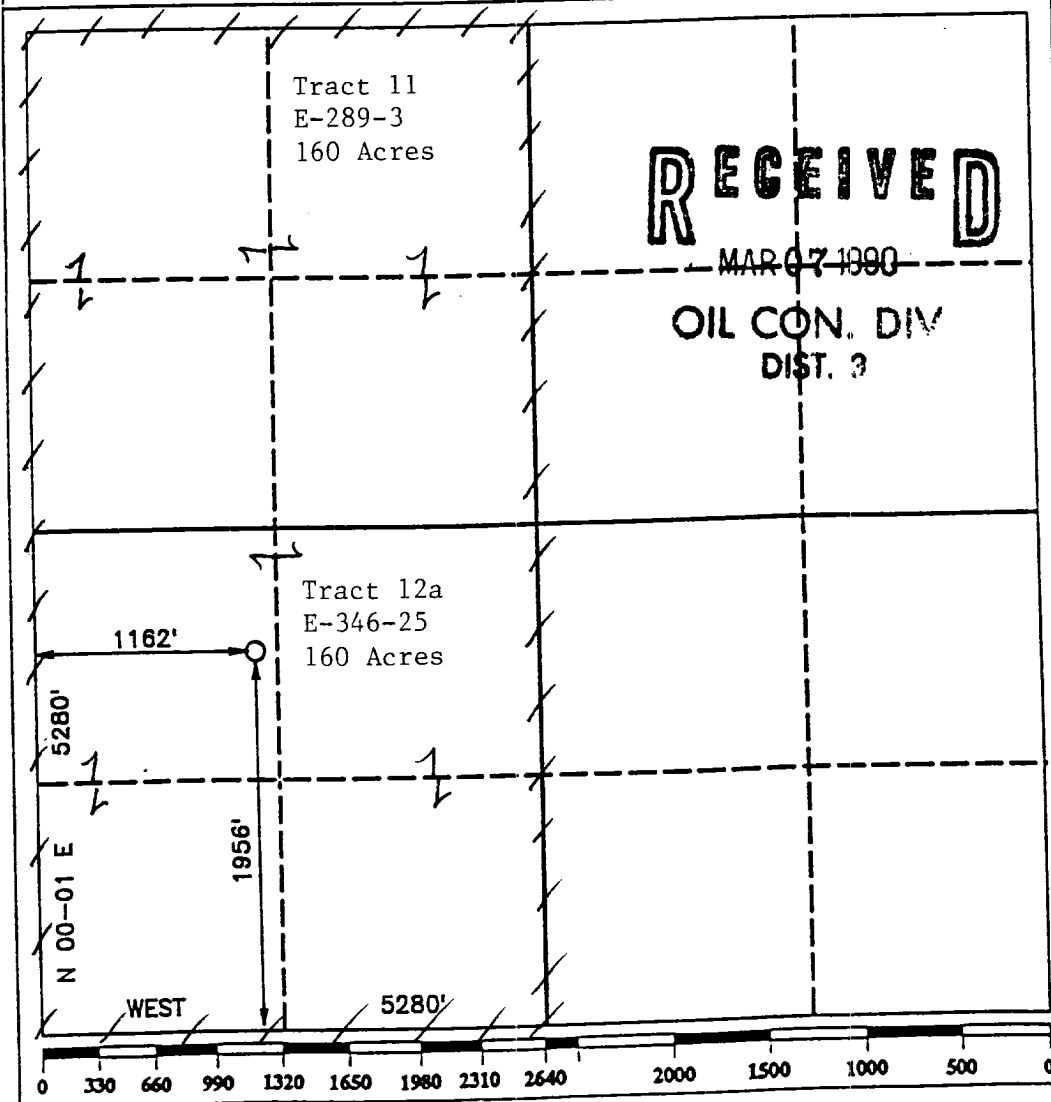

OPERATOR CERTIFICATION

I hereby certify that the information contained herein is true and complete to the best of my knowledge and belief.

Signature
L. M. Sanders
Printed Name
L. M. Sanders
Position
Supv. Regulatory Affairs
Company
Phillips Petroleum Co.
Date
March 6, 1990

SURVEYOR CERTIFICATION

I hereby certify that the well location shown on this plat was plotted from field notes of actual surveys made by me or under my supervision, and that the same is true and correct to the best of my knowledge and belief.

Date Surveyed
FEBRUARY 1990

Signature & Seal
Professional Surveyor
R. HOWARD DAGGETT
Certificate No. **00780**
Registered Professional
Land Surveyor