

UNITED STATES
DEPARTMENT OF THE INTERIOR
GEOLOGICAL SURVEY

30-039-25134

APPLICATION FOR PERMIT TO DRILL, DEEPEN, OR PLUG BACK

1a. TYPE OF WORK

DRILL ☒DEEPEN ☐PLUG BACK ☐

b. TYPE OF WELL

OIL
WELL ☐GAS
WELL ☒

OTHER

SINGLE
ZONE ☒MULTIPLE
ZONE ☐

2. NAME OF OPERATOR

MITCHELL ENERGY CORPORATION

3. ADDRESS OF OPERATOR

555 Seventeenth Street - Suite 3500
Denver, CO 80202

4. LOCATION OF WELL (Report location clearly and in accordance with any State requirements.)*

At surface

1440' FSL & 1825' FWL Sec. 11-T31N-R4W

At proposed prod. zone

SAME

14. DISTANCE IN MILES AND DIRECTION FROM NEAREST TOWN OR POST OFFICE*

+61 miles northeast of Blanco, New Mexico

15. DISTANCE FROM PROPOSED*

LOCATION TO NEAREST
PROPERTY OR LEASE LINE, FT.
(Also to nearest drg. unit line, if any) 1440'

18. DISTANCE FROM PROPOSED LOCATION*

TO NEAREST WELL, DRILLING, COMPLETED,
OR APPLIED FOR, ON THIS LEASE, FT. 2308'

21. ELEVATIONS (Show whether DF, RT, GR, etc.)

7002' 6975' GR

25. PROPOSED CASING AND CEMENTING PROGRAM

SIZE OF HOLE	SIZE OF CASING	WEIGHT PER FOOT	SETTING DEPTH	DRILLING OPERATIONS AUTHORIZED ARE SUBJECT TO COMPLIANCE WITH ATTACHED "GENERAL REQUIREMENTS"
12-1/4"	8-5/8"	24# K-55	500'	350 sx circ to surface
7-7/8"	5-1/2"	15.5# K-55	4000'	700 sxs est. TOC @ 350'

The operator proposes to drill to a depth sufficient to test the Fruitland Formation. If productive, 5-1/2" casing will be run and set at ±4000'. If non-productive, the well will be plugged and abandoned consistent with Federal Regulations. Any zones above the Fruitland may be tested for productivity prior to Abandonment.

EXHIBITS ATTACHED

Ten Point Compliance Program

Surface Use & Operating Plan

Exhibit No. 1 Blowout Preventer Schematic

Exhibit No. 2 Location Elevation Plat

Exhibit No. 3 Planned Access Roads

Exhibit No. 4 Planned Pipeline Map

Exhibit No. 5 One Mile Radius Map

Exhibit No. 6 Production Facilities

Layout

Exhibit No. 7 Drilling Rig Layout

IN ABOVE SPACE DESCRIBE PROPOSED PROGRAM: If proposal is to deepen or plug back, give data on present productive zone and proposed new productive zone. If proposal is to drill or deepen directionally, give pertinent data on subsurface locations and measured and true vertical depths. Give blowout preventer program, if any.

24.

SIGNED

James C. Anderson

TITLE District Production Manager

DATE 7/31/90

(This space for Federal or State office use)

PERMIT NO.

APPROVAL DATE

APPROVED BY

NOV 1 1991

TITLE

CONDITIONS OF APPROVAL, IF ANY:

OIL CON. DIV.

*See Instructions On Reverse Side

5. LEASE DESIGNATION AND SERIAL NO.

SF078888

6. IF INDIAN, ALLOTTEE OR TRIBE NAME

NA

7. UNIT AGREEMENT NAME

Rosa Unit

8. FARM OR LEASE NAME

NA

9. WELL NO.

341

10. FIELD AND POOL OR WILDCAT

Fruitland CORP

11. SEC., T., R., M., OR BLK.
AND SURVEY OR AREA

Sec. 11-T31N-R4W

12. COUNTY OR PARISH

Rio Arriba

13. STATE

NM

DRILLING OPERATIONS AUTHORIZED ARE
SUBJECT TO COMPLIANCE WITH ATTACHED
"GENERAL REQUIREMENTS"

Submit to Appropriate
District Office
State Lease - 4 copies
Fee Lease - 3 copies

State of New Mexico
Energy, Minerals and Natural Resources Department

Form C-102
Revised 1-1-89

OIL CONSERVATION DIVISION

DISTRICT I
P.O. Box 1980, Hobbs, NM 88240

P.O. Box 2088
Santa Fe, New Mexico 87504-2088

DISTRICT II
P.O. Drawer DD, Artesia, NM 88210

DISTRICT III
1000 Rio Brizos Rd., Aztec, NM 87410

WELL LOCATION AND ACREAGE DEDICATION PLAT

All Distances must be from the outer boundaries of the section

Operator Mitchell Energy Corporation			Lease Rosa Unit		Well No. 341
Unit Letter K	Section 11	Township 31 North	Range 4 West	County NMPM	Rio Arriba
Actual Footage Location of Well: 2315 feet from the South line and 2335 feet from the West line					
Ground level Elev. 7002'		Producing Formation COAL		Dedicated Acreage: BASIN FRUITLAND GAS POOL Acres	

- Outline the acreage dedicated to the subject well by colored pencil or lecture marks on the plat below.
- If more than one lease is dedicated to the well, outline each and identify the ownership thereof (both as to working interest and royalty).
- If more than one lease of different ownership is dedicated to the well, have the interest of all owners been consolidated by communitization, unitization, force-pooling, etc.?
☐ Yes ☐ No If answer is "yes" type of consolidation _____
If answer is "no" list the owners and tract descriptions which have actually been consolidated. (Use reverse side of this form if necessary).
No allowable will be assigned to the well until all interests have been consolidated (by communitization, unitization, forced-pooling, or otherwise) or until a non-standard unit, eliminating such interest, has been approved by the Division.

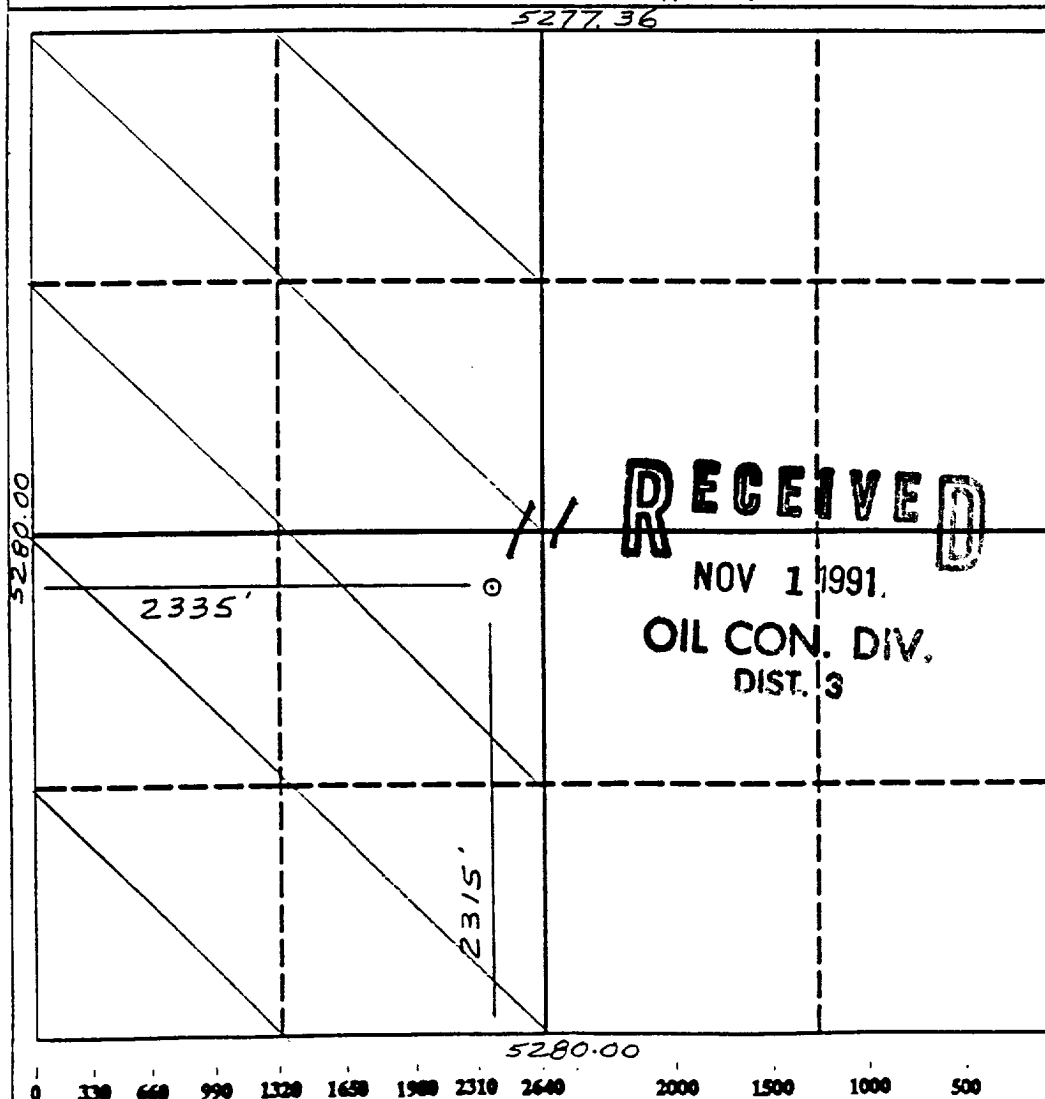

OPERATOR CERTIFICATION

I hereby certify that the information contained herein is true and complete to the best of my knowledge and belief.

Signature
Albert Libersat
Printed Name
ALBERT LIBERSAT
Position
DISTRICT ENGINEER
Company
MITCHELL ENERGY CORP
Date
6-12-91

SURVEYOR CERTIFICATION

I hereby certify that the well location shown on this plat was plotted from field notes of actual surveys made by me or under my supervision, and that the same is true and correct to the best of my knowledge and belief.

Date Surveyed
6-7-91
Signature
Neale Edwards
Professional Surveyor
NEW MEXICO
6857
6857
REGISTERED LAND SURVEYOR
Certificate No.
Neale Edwards

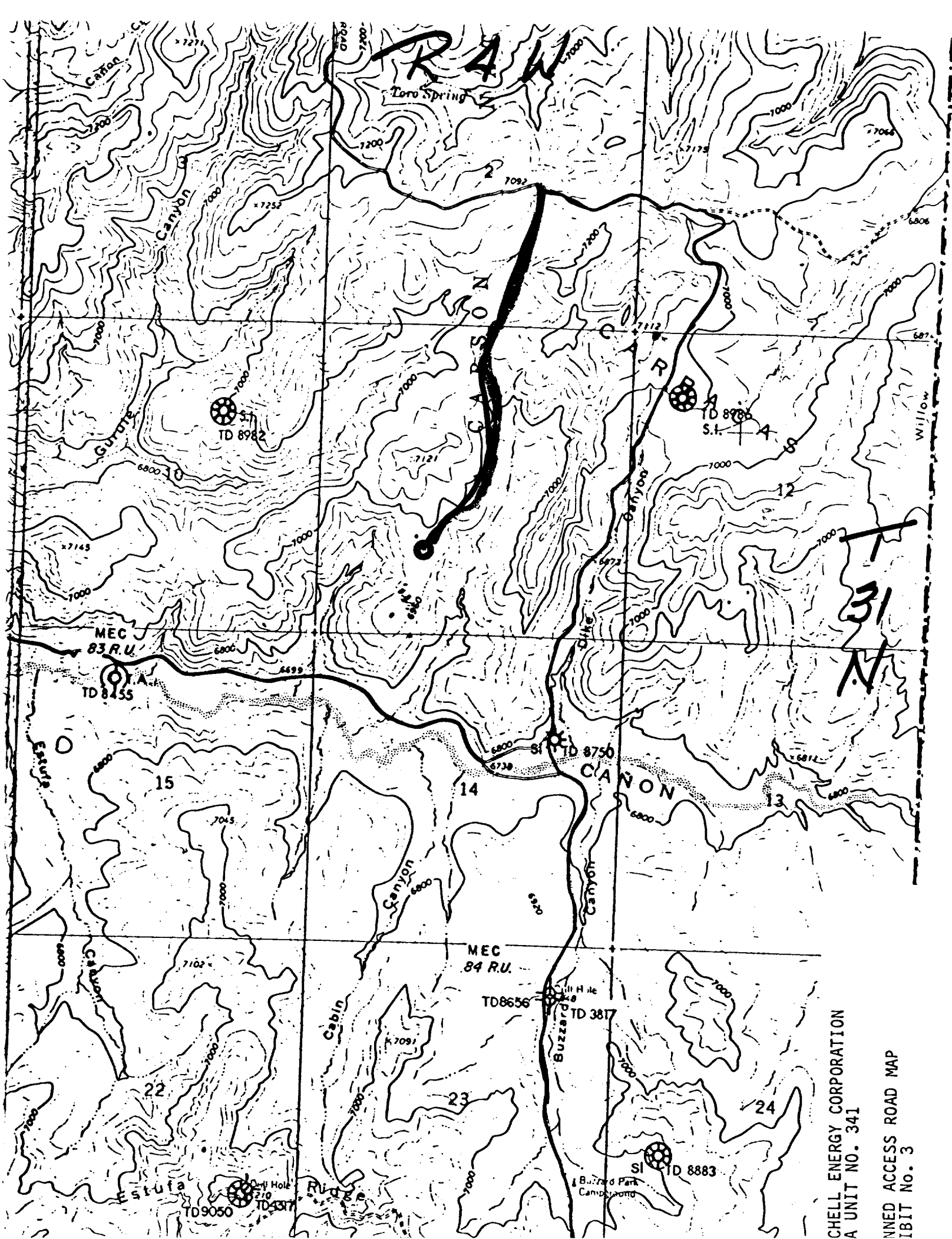

CHELL ENERGY CORPORATION
A UNIT NO. 341

UNED ACCESS ROAD MAP
IBIT No. 3