

UNITED STATES
DEPARTMENT OF THE INTERIOR
BUREAU OF LAND MANAGEMENT

30-039-25219

APPLICATION FOR PERMIT TO DRILL, DEEPEN, OR PLUG BACK

1a. Type of Work DRILL	5. Lease Number SF-078774
1b. Type of Well GAS	6. If Indian, Name of Tribe or Allottee
2. Operator Evergreen Operating Corporation	7. Unit Agreement Name ROSA UNIT
3. Address & Phone No. of Operator SA. R. KENDRICK BOX 516, AZTEC, NM 87410 (505) 334-2555	8. Farm or Lease Name ROSA UNIT
4. Location of Well 2548' FSL 2066' FWL	9. Well Number 315
	10. Field, Pool, or Wildcat BASIN-FRUITLAND COAL GAS POOL
	11. Section, Township, & Range, Meridian, or Block K - 30 - 31N - 4W
14. Distance in Miles from Nearest Town 21 MILES WEST OF DULCE, NM	12. County RIO ARRIBA
	13. State NEW MEXICO
15. Distance from Proposed Location To Nearest Property Line or Lease Line. 360'	16. Acres in Lease 508.84 Acres
	17. Acres Assigned to Well W-294.00
18. Distance From Proposed Location To Nearest Well Dr., Compl., Or Applied For On Lease. None	19. Proposed Depth 3675'
	20. Rotary or Cable Tools ROTARY
21. Elevations (DF, RT, GR, Etc.) 6549' GR	22. Approximate Date Work Will Start. Fall of 1992

23. Proposed Casing and Cementing Program:

Exhibits attached as follows:

"A" Location and Elevation Plat

"B" Vicinity Map - Access Roads

"C" Ten-Point Compliance Program

"D" Multi-Point Requirements for APD

"E" Blowout Preventer Schematic

"F" Location Profile

"G" Drill Rig Layout

"H" Completion Rig Layout

"I" Production Facility Schematic

RECEIVED

AUG 26 1992

OIL CON. DIV.
DIST. 3

24. Signed AR Kendrick Title Agent Date JUL 23 1992

Permit No. _____ Approval Date APPROVED AS AMENDED

Approved By _____ Title _____ Date AUG 25 1992

NM-3147

NOTE: THIS FORMAT IS ISSUED IN LIEU OF U.S. BLM FORM 3160-3

NM000

John Shella
AREA MANAGER

Submit to Appropriate
District Office
State Lease - 4 copies
For Lease - 3 copies

State of New Mexico
Energy, Minerals and Natural Resources Department

Form C-102
Revised 1-1-89

OIL CONSERVATION DIVISION

P.O. Box 2088

Santa Fe, New Mexico 87504-2088

DISTRICT I

P.O. Box 1980, Hobbs, NM 88240

DISTRICT II

P.O. Drawer DD, Artesia, NM 88210

DISTRICT III

1000 Rio Brazos Rd., Aztec, NM 87410

WELL LOCATION AND ACREAGE DEDICATION PLAT

All Distances must be from the outer boundaries of the section

Operator Evergreen Operating Corporation			Lease Rosa Unit		Well No. 315
Unit Letter K	Section 30	Township 31 North	Range 4 West	County Rio Arriba	
Actual Footage Location of Well: 2548 feet from the South line and 2066 feet from the West line					
Ground level Elev. 6549 Est.		Producing Formation Fruitland Coal	Pool Basin Fruitland Coal	Dedicated Acreage: 294.00 Acres	

1. Outline the acreage dedicated to the subject well by colored pencil or hatchure marks on the plat below.

2. If more than one lease is dedicated to the well, outline each and identify the ownership thereof (both as to working interest and royalty).

3. If more than one lease of different ownership is dedicated to the well, have the interest of all owners been consolidated by communitization, unitization, force-pooling, etc.?

☐ Yes ☐ No If answer is "yes" type of consolidation

If answer is "no" list the owners and tract descriptions which have actually been consolidated. (Use reverse side of this form if necessary).

No allowable will be assigned to the well until all interests have been consolidated (by communitization, unitization, forced-pooling, or otherwise) or until a non-standard unit, eliminating such interest, has been approved by the Division.

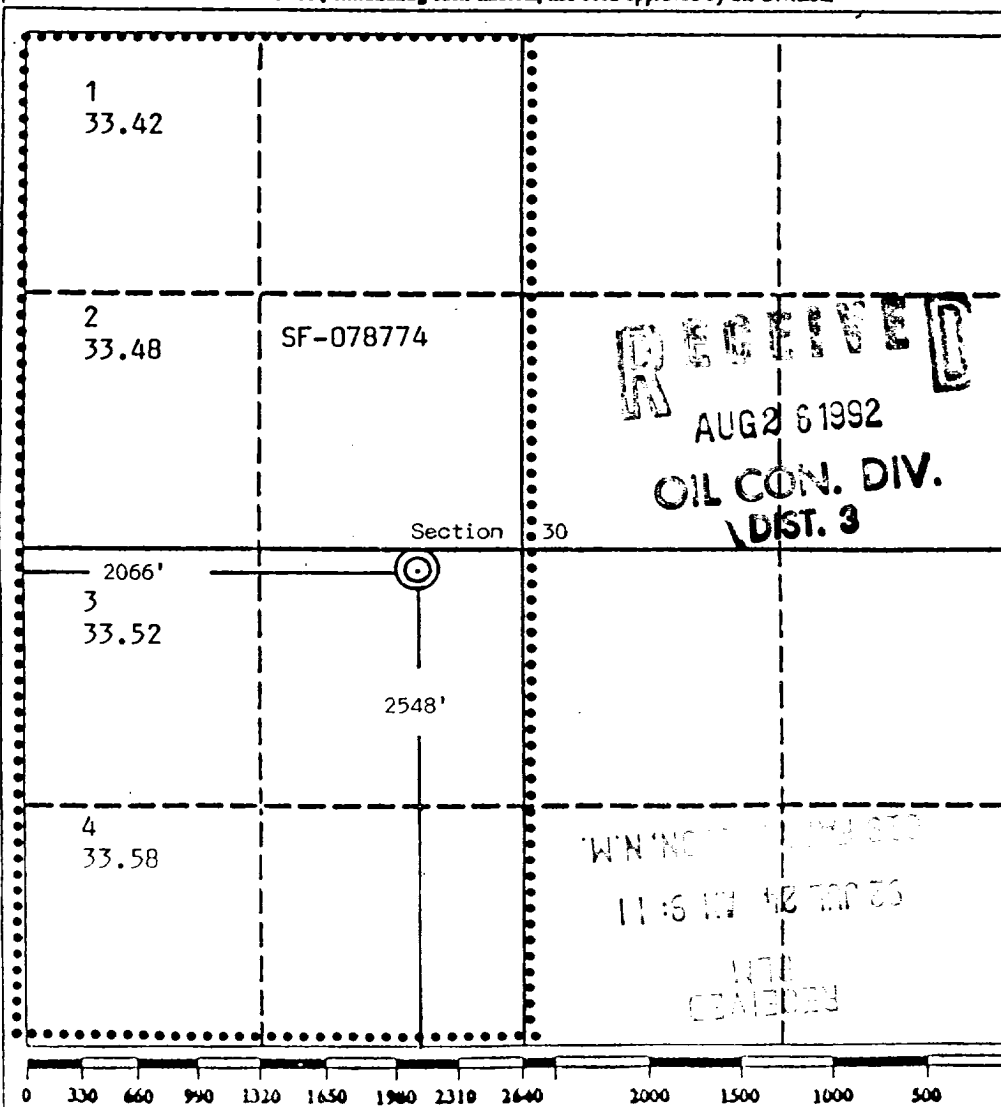

OPERATOR CERTIFICATION

I hereby certify that the information contained herein is true and complete to the best of my knowledge and belief.

Signature

Printed Name

A. R. Kendrick

Position

Agent

Company

Evergreen Operating Corp.

Date

July 23, 1992

SURVEYOR CERTIFICATION

I hereby certify that the well location shown on this plat was plotted from field notes of actual surveys made by me or under my supervision, and that the same is true and correct to the best of my knowledge and belief.

Date Surveyed

July 15, 1992

Signature & Seal of
Professional Surveyor

EDGAR R. RISENHOOVER

NEW MEXICO

5979

Edgar R. Risenhoover

RECEIVED

EXHIBIT A

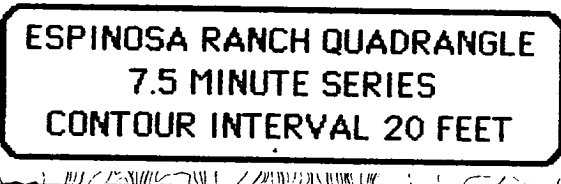

TEN-POINT COMPLIANCE PROGRAM

Evergreen Operating Corp.

Rosa Unit #315

2548' FSL 2066' FWL Sec. 30 - T 31 N - R 4 W

Elev: 6549' GR

Lease No. SF-078774

COPIED
2011
JAN 27 PM 2:43
JAN 27 PM 2:43

1. THE GEOLOGICAL SURFACE FORMATION IS: Nacimiento.
2. THE ESTIMATED TOPS OF IMPORTANT GEOLOGICAL MARKERS:

Ojo Alamo	2726'
Kirtland	2931'
Fruitland	3266'
Fruitland Coal	3286'
Pictured Cliffs	3426'
Total Depth	3675'

3. ESTIMATED DEPTHS OF ANTICIPATED WATER, OIL, GAS OR MINERALS:

<u>SUBSTANCE</u>	<u>FORMATION</u>	<u>ANTICIPATED DEPTH</u>
GAS	Fruitland Coal	3286'

4. THE PROPOSED CASING PROGRAM WILL BE AS FOLLOWS:

<u>DEPTH</u>	<u>HOLE SIZE</u>	<u>O.D.</u>	<u>WEIGHT</u>	<u>GRADE</u>	<u>TYPE</u>	<u>NEW/USED</u>
0-350'	12-1/4"	9-5/8"	36	K-55	ST&C	NEW
0-TD	7-7/8"	5-1/2"	15.5	K-55	ST&C	NEW

PROPOSED CEMENT PROGRAM: To effectively isolate and seal off all water, oil, gas and coalbearing strata encountered by the utilization of spacers, centralizers and swirling centralizers as specified by NTL-FRA 90-1 III.B and API standards; and by using cement volumes as follows:

Surface: 265 CuFt (225 Sx) Class B w/1/4# Flocele/Sx plus 2% CaCl.

Production: 1st stage: 30 CuFt (25 Sx) 50/50 pozolon, 2% gel and 1/2#/Sx Flocele plus 118 CuFt (100 Sx) Class B w/4% Halad-344 and 1/2#/Sx Flocele. 1st stage Totals: 148 CuFt (125 Sx). 2nd stage: 1160 CuFt (628 Sx) Halliburton Lite w/2% CaCl plus 118 CuFt (100 Sx) Class B w/2% CaCl. 2nd stage totals: 1318 CuFt (750 Sx). Grand Totals: 1466 CuFt (875 Sx). (Exact volumes to be determined from well logs.)

5. OPERATOR'S MINIMUM SPECIFICATIONS FOR PRESSURE CONTROL:

Exhibit E is a schematic of the blowout preventer used by a local contractor for other wells in the area. The BOPs are to be test-operated before drilling out from under the surface casing, and operation checks will be made daily thereafter and recorded in the Daily Drilling Report. Accessories to BOP will include floor safety valve and choke manifold with pressure rating equivalent to the BOP stack.

Exhibit C