

RECEIVED
MAY 22 1996

Form 3160-3

(December 1990)

OIL CON. DIV.
DIST. 3

RECEIVED

UNITED STATES
DEPARTMENT OF THE INTERIOR
BUREAU OF LAND MANAGEMENT

SUBMIT IN TRIPPLICATE*

(Other instructions on reverse side)

Form approved
Budget Bureau No. 1004-0136
Expires: December 31, 1991

APPLICATION FOR PERMIT TO DRILL OR DEEPEN

1a. TYPE OF WORK DRILL <input checked="" type="checkbox"/> DEEPEN <input type="checkbox"/>		5. LEASE DESIGNATION AND SERIAL NO. SF-078767	
b. TYPE OF WELL OIL WELL <input type="checkbox"/> GAS WELL <input checked="" type="checkbox"/> OTHER <input type="checkbox"/> SINGLE ZONE <input checked="" type="checkbox"/> MULTIPLE ZONE <input type="checkbox"/>		6. IF INDIAN, ALLOTTEE OR TRIBE NAME	
2. NAME OF OPERATOR WILLIAMS PRODUCTION COMPANY ✓ OGRID 120782		7. UNIT AGREEMENT NAME	
3. ADDRESS AND TELEPHONE NO. c/o Walsh Engr. & Prod. Corp. 7415 E. Main Farmington, N.M. 87402 (505) 327-4892		8. FARM OR LEASE NAME, WELL NO. Rosa Unit #19A (008480) 17033	
4. LOCATION OF WELL (Report location clearly and in accordance with any State requirements.) At surface 1620' FNL & 1665' FWL At proposed prod. sede Same		9. APPROX. WELL NO. 30-039-25577 ✓	
14. DISTANCE IN MILES AND DIRECTION FROM NEAREST TOWN OR POST OFFICE* 25 miles NE of Blanco, NM		10. FIELD AND FOOT, OR WILDCAT Blanco Mesa Verde 72319	
15. DISTANCE FROM PROPOSED LOCATION TO NEAREST PROPERTY OR LEASE LINE, FT. (Also to nearest drig. unit line, if any) 975		11. SEC., T., R., M., OR BLK. AND SURVEY OR AREA F Sec. 24, T31N, R6W	
16. NO. OF ACRES IN LEASE 2518.04		12. COUNTY OR PARISH Rio Arriba	
17. DISTANCE FROM PROPOSED LOCATION TO NEAREST WELL, DRILLING, COMPLETED, OR APPLIED FOR, ON THIS LEASE, FT. 1600'		13. STATE NM	
18. PROPOSED DEPTH 5925		14. COUNTY OR PARISH Rio Arriba	
19. ROTARY OR CABLE TOOLS Rotary		15. STATE NM	
20. ELEVATIONS (Show whether DP, RT, GR, etc.) 6231' GR		16. APPROX. DATE WORK WILL START* May 1996	

This location is subject to technical and procedural review pursuant to 43 CFR 3165.3 and appeal pursuant to 43 CFR 3165.4.

PROPOSED CASING AND CEMENTING PROGRAM				
SIZE OF HOLE	GRADE SIZE OF CASING	WEIGHT PER FOOT	SETTING DEPTH	QUANTITY OF CEMENT
12-1/4"	9-5/8", K-55	36.0	250-320	157 cuft Cl "B" w/3% CaCl2
8-3/4"	7", K-55	20.0	3505	811 cuft 65/35 Poz, 192 cuft Cl
6-1/4"	4-1/2", K-55	10.5	3405-5925	414 cuft Cl "B" w/4% gel & additives

WILLIAMS PRODUCTION COMPANY proposes to drill a vertical well to develop the Mesa Verde formation at the above described site in accordance with the attached drilling and surface use programs.

DRILLING OPERATIONS AUTHORIZED ARE
SUBJECT TO COMPLIANCE WITH ATTACHED
"GENERAL REQUIREMENTS"

This location has been archaeologically surveyed by CRMC. Copies of the report will be submitted directly to your office.

This APD also is serving as an application to obtain BLM road and pipeline right-of-way. This well will be accessed by a new road approximately 1600' long which crosses the SE/NE and NE/SW of Section 24 where it joins an existing road. This road crosses the NE/SW and NW/SW of Section 24 and the NE/SE of Section 23, T31N, R6W, where it joins the main Rosa Road. The Rosa Road continues SE for 15 miles where it joins the Sims Mesa Highway.

IN ABOVE SPACE DESCRIBE PROPOSED PROGRAM: If proposal is to deepen, give data on present productive zone and proposed new productive zone. If proposal is to drill or deepen directionally, give pertinent data on subsurface locations and measured and true vertical depths. Give blowout prevention program, if any.

APPROVED Paul C. Thompson
(This space for Federal or State office use)

TITLE Paul C. Thompson, Agent

2/26/96

APPROVED
AS AMENDED

PERMIT NO.

APPROVAL DATE

Application approval does not warrant or certify that the applicant holds legal or equitable title to those rights in the subject lease which would entitle the applicant to conduct operations thereunder.

CONDITIONS OF APPROVAL, IF ANY

OK

MAJCO

MAY 20 1996
DISTRICT MANAGER

District I
PO Box 1980, Hobbs, NM 88241-1980
District II
PO Drawer DD, Artesia, NM 88211-0719
District III
1000 Rio Brazos Rd., Aztec, NM 87410
District IV
PO Box 2088, Santa Fe, NM 87504-2088

State of New Mexico
Energy, Minerals & Natural Resources Department

OIL CONSERVATION DIVISION
PO Box 2088
Santa Fe, NM 87504-2088

Form C-10
Revised February 21, 199
Instructions on back
Submit to Appropriate District Office
State Lease - 4 Copies
Fee Lease - 3 Copies

☐ AMENDED REPORT

WELL LOCATION AND ACREAGE DEDICATION PLAT

API Number <u>30-039-25577</u>	Pool Code 72319	Pool Name Blanco Mesa Verde
Property Code <u>008480</u> <u>17033</u>	Property Name Rosa Unit	Well Number 19A
OGRID No. 120782	Operator Name Williams Production Co.	Elevation 6231'

¹⁰ Surface Location

UL or lot no.	Section	Township	Range	Lot Idn	Feet from the	North/South line	Feet from the	East/West line	County
F	24	31 N	6 W		1620	North	1665	West	R.A.

¹¹ Bottom Hole Location If Different From Surface

UL or lot no.	Section	Township	Range	Lot Idn	Feet from the	North/South line	Feet from the	East/West line	County

¹² Dedicated Acres	¹³ Joint or Infill	¹⁴ Consolidation Code	¹⁵ Order No.
320	N	U	

NO ALLOWABLE WILL BE ASSIGNED TO THIS COMPLETION UNTIL ALL INTERESTS HAVE BEEN CONSOLIDATED
OR A NON-STANDARD UNIT HAS BEEN APPROVED BY THE DIVISION

	¹⁷ OPERATOR CERTIFICATION I hereby certify that the information contained herein is true and complete to the best of my knowledge and belief. <u>Paul C. Thompson</u> Signature Paul C. Thompson, P.E. (Agent) Printed Name President Walsh Engr. & Prod. Corp. Title 2/26/96 Date	
	¹⁸ SURVEYOR CERTIFICATION I hereby certify that the well location shown on this plat was plotted from field notes of actual surveys made by me or under my supervision, and that the same is true and correct to the best of my belief. 1-12-96 Date of Survey <u>HERLE C. EDWARDS</u> Signature and Professional Engineer 8857 6857 Certificate Number	

<u>DATE:</u>	2/1/96		
<u>WELLNAME:</u>	ROSA UNIT #19A	<u>FIELD:</u>	Blanco MV
<u>LOCATION:</u>	SE/4 NW/4 Sec. 29, T31N, R5W San Juan Co., NM	<u>SURFACE:</u>	NM Game & Fish
<u>ELEVATION:</u>	6231' GR	<u>MINERALS:</u>	Federal
<u>TOTAL DEPTH:</u>	5925'	<u>LEASE #</u>	SF-078767
<u>I. GEOLOGY:</u>	Surface formation - San Jose		

Ojo Alamo	2308	Cliff House	5253'
Kirtland	2408'	Menefee	5298'
Fruitland	2808'	Point Lookout	5523'
Pictured Cliffs	3053'	Mancos	5673'
Lewis	3353'	Total Depth	5925'

C. NATURAL GAUGES: Gauge any noticeable increases in gas flow. Record all gauges in Tour book and on morning reports.

B. BOP TESTING: While drill pipe is in use, the pipe rams will be tested not less than once each day. The blind rams will be tested once each trip. The drum brakes will inspected and tested each tour. All tests and inspections will be recorded in the tour book as to time and results.

<u>CASING TYPE</u>	<u>HOLE SIZE</u>	<u>DEPTH</u>	<u>CASING SIZE</u>	<u>WT. & GRADE</u>
Surface	12-1/4"	250'	9-5/8"	36# K-55
Intermediate	8-3/4"	3505'	7"	20# K-55
Prod. Liner	6-1/4"	3405-5925'	4-1/2"	10.5# K-55

1. **SURFACE CASING:** 9-5/8" notched regular pattern guide shoe.
2. **INTERMEDIATE CASING:** 7" cement nose guide shoe with a self- fill insert float. Place float one(1) joint above the shoe and five(5) centralizers, spaced every other joint, starting with the float collar. Place turbulent centralizers, at 120' intervals, starting at 2308' to the surface. Total centralizers = 5 regular and 19 turbulent.
3. **PRODUCTION CASING:** 4-1/2" whirler type cement nose guide shoe with a latch collar on top of 20' joint. Place 20' marker joint above 5253'.

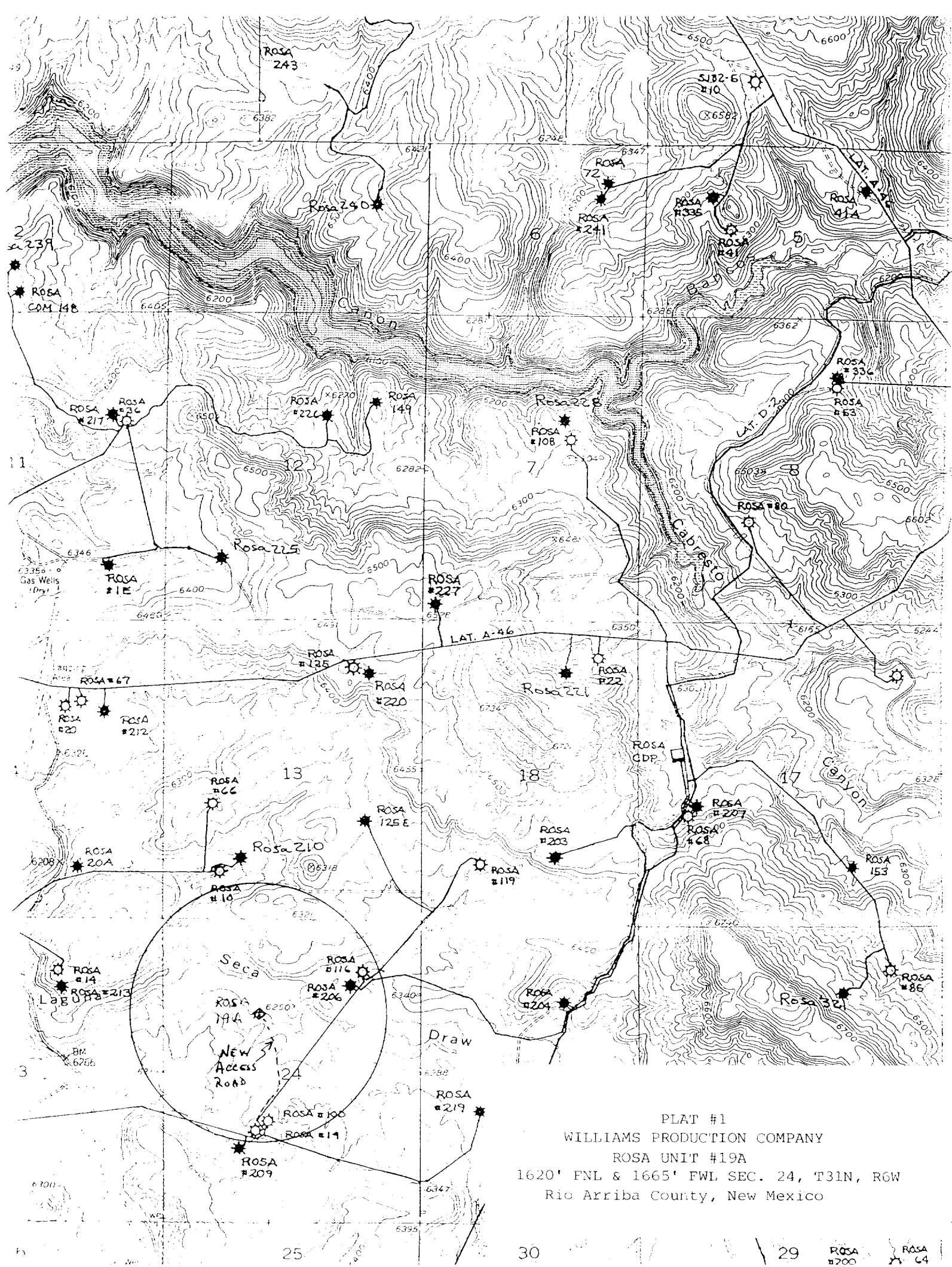

PLAT #1
WILLIAMS PRODUCTION COMPANY
ROSA UNIT #19A
1620' FNL & 1665' FWL SEC. 24, T31N, R6W
Rio Arriba County, New Mexico