

District I  
 PO Box 1980, Hobbs, NM 88241-1980  
 District II  
 PO Drawer DD, Artesia, NM 88211-0719  
 District III  
 1000 Rio Brazos Rd., Aztec, NM 87410  
 District IV  
 PO Box 2088, Santa Fe, NM 87504-2088

State of New Mexico  
 Energy, Minerals & Natural Resources Department  
**OIL CONSERVATION DIVISION**  
 PO Box 2088  
 Santa Fe, NM 87504-2088

Form C-101  
 Revised February 10, 1994  
 Instructions on back  
 Submit to Appropriate District Office  
 State Lease - 6 Copies  
 Fee Lease - 5 Copies

AMENDED REPORT

**APPLICATION FOR PERMIT TO DRILL, RE-ENTER, DEEPEN, PLUGBACK, OR ADD A ZONE**

Operator Name and Address. WILLIAMS PRODUCTION COMPANY c/o Walsh Engr. & Prod. Corp. 7415 E. Main St., Farmington, New Mexico 87402 (505) 327-4892		OGRID Number 120782
		API Number 30-039-25721
Property Code <del>008480</del> 17033	Property Name Rosa Unit	Well No. 337

<sup>7</sup> Surface Location

UL or lot no.	Section	Township	Range	Lot Idn	Feet from the	North/South line	Feet from the	East/West line	County
K	32	31N	5W		2045	South	1450	West	Rio Arriba

<sup>8</sup> Proposed Bottom Hole Location If Different From Surface

UL or lot no.	Section	Township	Range	Lot Idn	Feet from the	North/South line	Feet from the	East/West line	County
<sup>9</sup> Proposed Pool 1 71629 Basin Fruitland Coal w/320					<sup>10</sup> Proposed Pool 2				

<sup>11</sup> Work Type Code N	<sup>12</sup> Well Type Code G	<sup>13</sup> Cable/Rotary Rotary	<sup>14</sup> Lease Type Code S	<sup>15</sup> Ground Level Elevation 6525'
<sup>16</sup> Multiple No	<sup>17</sup> Proposed Depth 3350	<sup>18</sup> Formation Basin Fr. Coal	<sup>19</sup> Contractor Four Corners	<sup>20</sup> Spud Date Sept. 15, 1997

<sup>21</sup> Proposed Casing and Cement Program

Hole Size	Casing Size	Casing weight/foot	Setting Depth	Sacks of Cement	Estimated TOC
12 1/4	9 5/8	36#	250	265sx(315cuft)	Surface
8 3/4	7	20#	3230	305sx(627cuft)	Surface
				120sx(201cuft)	
6 1/4	5 1/2	15.5#	3160 - 3350	None	

<sup>22</sup> Describe the proposed program. If this application is to DEEPEN or PLUG BACK give the data on the present productive zone and proposed new productive zone. Describe the blowout prevention program, if any. Use additional sheets if necessary.

Williams Production Company proposes to drill a vertical well to test the Basin Fruitland Coal Formation at the above location according to the attached Operation Plan.

RECEIVED  
AUG 18 1997  
OIL CON. DIV.

<sup>23</sup> I hereby certify that the information given above is true and complete to the best of my knowledge and belief.		<b>OIL CONSERVATION DIVISION</b>	
Signature: <i>Paul C. Thompson</i>	Printed name: Paul C. Thompson	Title: DEPUTY OIL & GAS INSPECTOR, DIST. #3	Approved by: <i>Ernie Busch</i> 8-20-97
Title: Agent	Date: 8/15/97	Phone: (505) 327-4892	Approval Date: AUG 20 1997
		Expiration Date: AUG 20 1998	
		Conditions of Approval: Attached <input type="checkbox"/>	

District I  
PO Box 1980, Hobbs, NM 88241-1980

District II  
PO Drawer 00, Artesia, NM 88211-0719

District III  
1000 Rio Brazos Rd., Aztec, NM 87410

District IV  
PO Box 2088, Santa Fe, NM 87504-2088

State of New Mexico  
Energy, Minerals & Natural Resources Department

OIL CONSERVATION DIVISION  
PO Box 2088  
Santa Fe, NM 87504-2088

Form C-102  
Revised February 21, 1994  
Instructions on back  
Submit to Appropriate District Office  
State Lease - 4 Copies  
Fee Lease - 3 Copies

AMENDED REPORT

WELL LOCATION AND ACREAGE DEDICATION PLAT

*API Number <i>30-039-25721</i>		*Pool Code 72319	*Pool Name Basin Fruitland Coal
*Property Code <del>008480</del> <i>17033</i>	*Property Name ROSA UNIT		*Well Number 337
*OGRID No. 120782	*Operator Name WILLIAMS PRODUCTION COMPANY		*Elevation 6525'

<sup>10</sup> Surface Location

UL or lot no.	Section	Township	Range	Lot Idn	Feet from the	North/South line	Feet from the	East/West line	County
K	32	31N	5W		2045	South	1450	WEST	RIO ARRIBA

<sup>11</sup> Bottom Hole Location If Different From Surface

UL or lot no.	Section	Township	Range	Lot Idn	Feet from the	North/South line	Feet from the	East/West line	County

<sup>12</sup> Dedicated Acres <i>W/320</i>	<sup>13</sup> Joint or Infill N	<sup>14</sup> Consolidation Code U	<sup>15</sup> Order No.
---	------------------------------------	---------------------------------------	-------------------------

NO ALLOWABLE WILL BE ASSIGNED TO THIS COMPLETION UNTIL ALL INTERESTS HAVE BEEN CONSOLIDATED OR A NON-STANDARD UNIT HAS BEEN APPROVED BY THE DIVISION

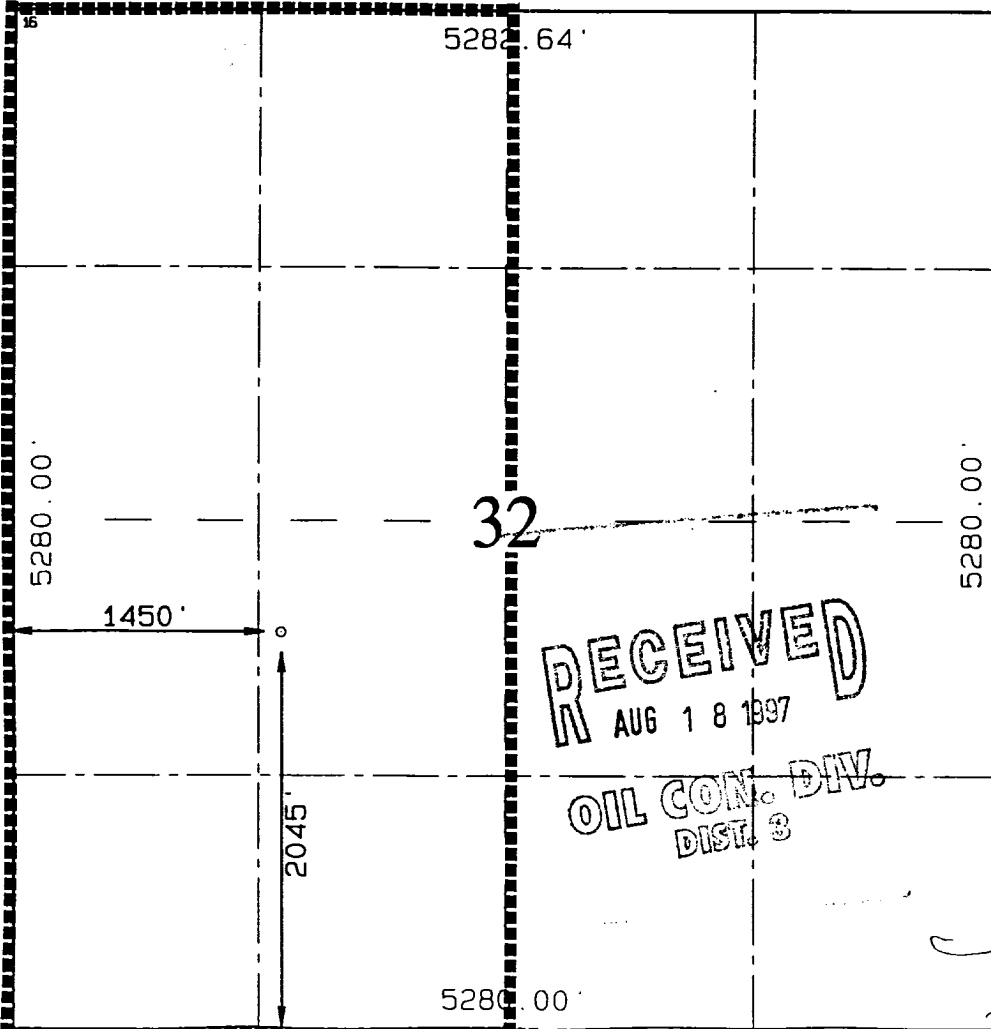

<sup>17</sup> OPERATOR CERTIFICATION  
I hereby certify that the information contained herein is true and complete to the best of my knowledge and belief.

*Paul C. Thompson*  
Signature  
Paul C. Thompson  
Printed Name  
Agent  
Title  
8/15/97  
Date

<sup>18</sup> SURVEYOR CERTIFICATION  
I hereby certify that the well location shown on this plat was plotted from field notes of actual surveys made by me or under my supervision, and that the same is true and correct to the best of my belief.

AUGUST 4, 1997  
Date of Survey  
Signature and Seal of Professional Surveyor  
*Neale C. Edwards*  
NEALE C. EDWARDS  
NEW MEXICO  
6857  
REGISTERED PROFESSIONAL SURVEYOR  
Certificate No. 6857

RECEIVED  
AUG 18 1997  
OIL CON. DIV.  
DIST. 3



Rosa #337  
Operations Plan  
Page #2

3. PRODUCTION CASING: 5-1/2" liner with notched collar on bottom.

**C. CEMENTING:**

1. SURFACE: Use 265 sx (315 cu.ft.) of class "B" with 3% CaCl<sub>2</sub> and 1/4# of cello-flake/sk (Yield = 1.19 cu.ft./sk, Weight = 15.6 #/gal.). Use 100% excess to circulate the surface. WOC 12 hours. Test to 1500#.

2. INTERMEDIATE: Lead - 305 sx (627 cu.ft.) of class "B" 65/35 poz with 10% gel and 1/4# cello-flake/sk (Yield = 2.1 cu.ft./sk, Weight = 12.1 #/gal.). Tail - 120 sx (201 cu.ft.) of class "B" with 4% gel, 1/4# cello-flake/sk, 0.5% FL-25 and 2% CaCl<sub>2</sub> (Yield = 1.74 cu.ft./sk, Weight = 13.5#/gal.). Use 100% excess in lead and 75% excess in tail to circulate to surface. Total volume = 828 cu.ft. WOC 12 hours. Run a temperature survey after 8 hours if cement is not circulated. Test to 1500#.

3. PRODUCTION LINER: Open hole completion. No cement.

**IV COMPLETION**

**A. PRESSURE TEST**

Pressure test 7" & 4-1/2" casing to 3300# for 15 minutes.

**B. STIMULATION**

Cavitate Well with reciprocation and rotation. Surge wells with water and air and then flow back to pit. Cavitate for 2 to 3 weeks. Maximum pressure not expected to exceed 2,000 psi.

**C. RUNNING TUBING**

1. Mesa Verde: Run 2-7/8", 6.5#, J-55, EUE tubing with a SN (1.375" ID) on top of bottom joint. Land tubing approximately 50' above TD.

---

Lance A. Hobbs  
Engineer, Production & Drilling

file:rosa337.wpd