

(SUBMIT IN TRIPLICATE)

UNITED STATES
DEPARTMENT OF THE INTERIOR
GEOLOGICAL SURVEYLand Office Santa Fe
Lease No. 87 07254A
Unit _____

SUNDRY NOTICES AND REPORTS ON WELLS

NOTICE OF INTENTION TO DRILL	<input checked="" type="checkbox"/>	SUBSEQUENT REPORT OF WATER SHUT-OFF	
NOTICE OF INTENTION TO CHANGE PLANS		SUBSEQUENT REPORT OF SHOOTING OR ACIDIZING	
NOTICE OF INTENTION TO TEST WATER SHUT-OFF		SUBSEQUENT REPORT OF ALTERING CASING	
NOTICE OF INTENTION TO RE-DRILL OR REPAIR WELL		SUBSEQUENT REPORT OF RE-DRILLING OR REPAIR	
NOTICE OF INTENTION TO SHOOT OR ACIDIZE		SUBSEQUENT REPORT OF ABANDONMENT	
NOTICE OF INTENTION TO PULL OR ALTER CASING		SUPPLEMENTARY WELL HISTORY	
NOTICE OF INTENTION TO ABANDON WELL			

(INDICATE ABOVE BY CHECK MARK NATURE OF REPORT, NOTICE, OR OTHER DATA)

6-12, 19 62

Trish Pat. B-130
Well No. _____ is located 1100 ft. from S line and 1000 ft. from E line of sec. 33
SW 1/4 Sec. 33 T 30 N R 20 W N.M.
(1/4 Sec. and Sec. No.) (Twp.) (Range) (Meridian)
Santa Fe San Juan New Mexico
(Field) (County or Subdivision) (State or Territory)

The elevation of the ~~surface~~ ground above sea level is 6000 ft.

DETAILS OF WORK

(State names of and expected depths to objective sands; show sizes, weights, and lengths of proposed casings; indicate mudding jobs, cementing points, and all other important proposed work)

It is proposed to drill a 13 1/4" surface hole to a 230', set 9 5/8" N-40, 32.324 surface casing; cement w/800 con. A 7 7/8" hole will be drilled to a 7100'; 5 1/2 O.D. 15 1/2 (N-40) casing will be run to T.B. and cemented w/800 con. A D.V. tool will be run at the base of the Flathead Cliff with 125 con cement used. The well will be logged and perforated. A pump out of 80,000 gallons of water and 80,000 of sand will be used per acre of free on the Dakota formation.

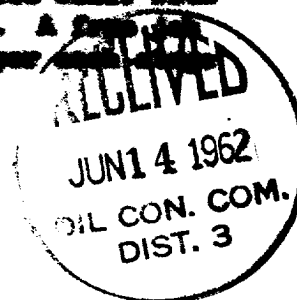

I understand that this plan of work must receive approval in writing by the Geological Survey before operations may be commenced.

Company Palco Petroleum CorporationAddress P. O. Box 1419Albuquerque, New MexicoBy H. E. Maxwell, Jr.Title Manager, Production Department

NEW MEXICO OIL CONSERVATION COMMISSION
Well Location and Acreage Dedication Plat

Section A.

Date June 12, 1962

Operator PUBCO PETROLEUM CO. Lease TRIEB FEDERAL
Well No. 2-33-0 Unit Letter O Section 33 Township 30 N Range 10W NMPM
Located 1190 Feet From south Line, 1650 Feet From east Line
County San Juan G. L. Elevation 6019 Dedicated Acreage 320 Acres
Name of Producing Formation Dakota Pool Basin Dakota

1. Is the Operator the only owner* in the dedicated acreage outlined on the plat below?
Yes X No .
2. If the answer to question one is "no," have the interests of all the owners been consolidated by communitization agreement or otherwise? Yes X No . If answer is "yes," Type of Consolidation Communitization Agreement
3. If the answer to question two is "no," list all the owners and their respective interests below:

Owner

Land Description

Pubco Petroleum Corporation

E/2 Sec. 33 T30N R10W



Section B

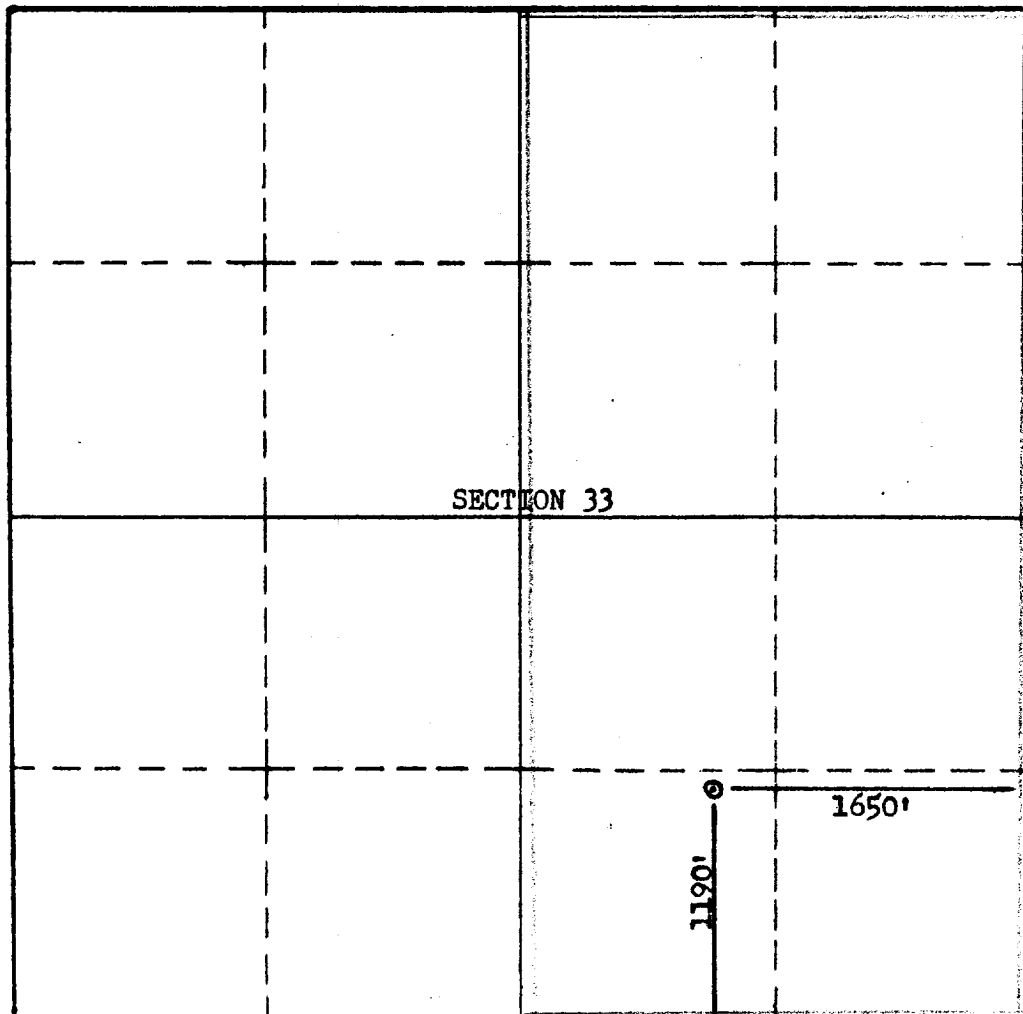

This is to certify that the information in Section A above is true and complete to the best of my knowledge and belief.

Pubco Petroleum Corporation
(Operator)
N. E. Maxwell, Jr.
(Representative)

Box 1419, Albuquerque, N.M.
Address

This is to certify that the well location shown on the plat in Section B was plotted from field notes of actual surveys made by me or under my supervision and that the same is true and correct to the best of my knowledge and belief.

Date Surveyed June 12, 1962
STEPHEN E. RYAN
Registered Professional Engineer and Surveyor.

Certificate No. 803