

Submit to Appropriate  
District Office  
State Lease - 6 copies  
Fee Lease - 5 copies

State of New Mexico  
Energy, Minerals and Natural Resources Department

Form C-101  
Revised 1-1-89

## OIL CONSERVATION DIVISION

DISTRICT I  
P.O. Box 1980, Hobbs, NM 88240

DISTRICT II  
P.O. Drawer DD, Artesia, NM 88210

DISTRICT III  
1000 Rio Brazos Rd., Aztec, NM 87410

P.O. Box 2088  
Santa Fe, New Mexico 87504-2088

API NO. (assigned by OCD on New Wells)

30-045-08958

5. Indicate Type of Lease

STATE ☒FEE ☐

6. State Oil &amp; Gas Lease No.

E-6714

## APPLICATION FOR PERMIT TO DRILL, DEEPEN, OR PLUG BACK

1a. Type of Work:

DRILL ☐RE-ENTER ☒DEEPEN ☐PLUG BACK ☐

b. Type of Well:

OIL WELL ☐GAS WELL ☒OTHER ☐SINGLE ZONE ☒MULTIPLE ZONE ☐

2. Name of Operator

Dugan Production Corp. 6515

3. Address of Operator

P.O. Box 420, Farmington, NM 87499

7. Lease Name or Unit Agreement Name

O Henry

8. Well No.

1

9. Pool name or Wildcat

Basin Fruitland Coal 71629

4. Well Location

Unit Letter

N

: 790

Feet From The

South

Line and

1850

Feet From The

West

Line

Section

36

Township

30N

Range

14W

NMPM

San Juan

County

10. Proposed Depth

1260'

11. Formation

Fruitland Coal

12. Rotary or C.T.

Rotary

13. Elevations (Show whether DF, RT, GR, etc.)

5566'

14. Kind &amp; Status Plug. Bond

state-wide

15. Drilling Contractor

Salazar

16. Approx. Date Work will start

ASAP

## 17. PROPOSED CASING AND CEMENT PROGRAM

SIZE OF HOLE	SIZE OF CASING	WEIGHT PER FOOT	SETTING DEPTH	SACKS OF CEMENT	EST. TOP
	*8-5/8"	24#	91'	50 sx	surface
6-1/4"	4-1/2"	10.5#	1260'	155 sx (183 ft <sup>3</sup> )	surface

Plan to re-enter 8-5/8" original casing set to 91'; then re-enter with 6-1/4" hole to total depth with gel-water-mud program to test Basin Fruitland Coal formation. Plan to run IES and COL logs. If determined productive, will run 4-1/2", 10.5#, J-55 casing, selectively perforate, frac, clean out after frac and complete well.

RECEIVED

MAR 27 1991

OIL CON. DIV.  
DIST. 3

\*previously set

APPROVAL EXPIRES 10-2-91  
UNLESS DRILLING IS COMMENCED.  
SPUD NOTICE MUST BE SUBMITTED  
WITHIN 10 DAYS.

IN ABOVE SPACE DESCRIBE PROPOSED PROGRAM: IF PROPOSAL IS TO DEEPEN OR PLUG BACK, GIVE DATA ON PRESENT PRODUCTIVE ZONE AND PROPOSED NEW PRODUCTIVE ZONE. GIVE BLOWOUT PREVENTER PROGRAM, IF ANY.

I hereby certify that the information above is true and complete to the best of my knowledge and belief.

SIGNATURE

Sherman E. Dugan

TITLE Vice-President

DATE 3-21-91

TYPE OR PRINT NAME

Sherman E. Dugan

TELEPHONE NO.

(This space for State Use)

APPROVED BY

Garcia Bracha

TITLE

DEPUTY OIL &amp; GAS INSPECTOR, DIST. #3

DATE

APR 04 1991

CONDITIONS OF APPROVAL, IF ANY:

Hold C-104 For C&G  
L&S still make 1 Corn #1000 placed RT to PB

VIA AIR MAIL  
JAN 1960

1. *Pharmaceutical industry* – The pharmaceutical industry is the largest of the three industries, with sales of \$10.5 billion in 1997. It is the only industry that has a significant presence in all three markets.

Submit to Appropriate  
District Office  
State Lease - 4 copies  
Fee Lease - 3 copies

State of New Mexico  
Energy, Minerals and Natural Resources Department

Form C-102  
Revised 1-1-89

OIL CONSERVATION DIVISION

P.O. Box 2088  
Santa Fe, New Mexico 87504-2088

DISTRICT I  
P.O. Box 1980, Hobbs, NM 88240

DISTRICT II  
P.O. Drawer DD, Artesia, NM 88210

DISTRICT III  
1000 Rio Brazos Rd., Aztec, NM 87410

WELL LOCATION AND ACREAGE DEDICATION PLAT

All Distances must be from the outer boundaries of the section

Operator Dugan Production Corp.			Lease O Henry		Well No. 1
Unit Letter N	Section 36	Township 30N	Range 14W	County San Juan	
Actual Footage Location of Well: 790 feet from the South line and 1850 feet from the West line					
Ground level Elev. 5566'	Producing Formation Fruitland Coal		Pool Basin Fruitland Coal	Dedicated Acreage: 320 Acres	

1. Outline the acreage dedicated to the subject well by colored pencil or hatchure marks on the plat below.
2. If more than one lease is dedicated to the well, outline each and identify the ownership thereof (both as to working interest and royalty).
3. If more than one lease of different ownership is dedicated to the well, have the interest of all owners been consolidated by communitization, unitization, force-pooling, etc.?  
☒ Yes ☐ No If answer is "yes" type of consolidation will be communitized  
If answer is "no" list the owners and tract descriptions which have actually been consolidated. (Use reverse side of this form if necessary.)  
No allowable will be assigned to the well until all interests have been consolidated (by communitization, unitization, forced-pooling, or otherwise) or until a non-standard unit, eliminating such interest, has been approved by the Division.

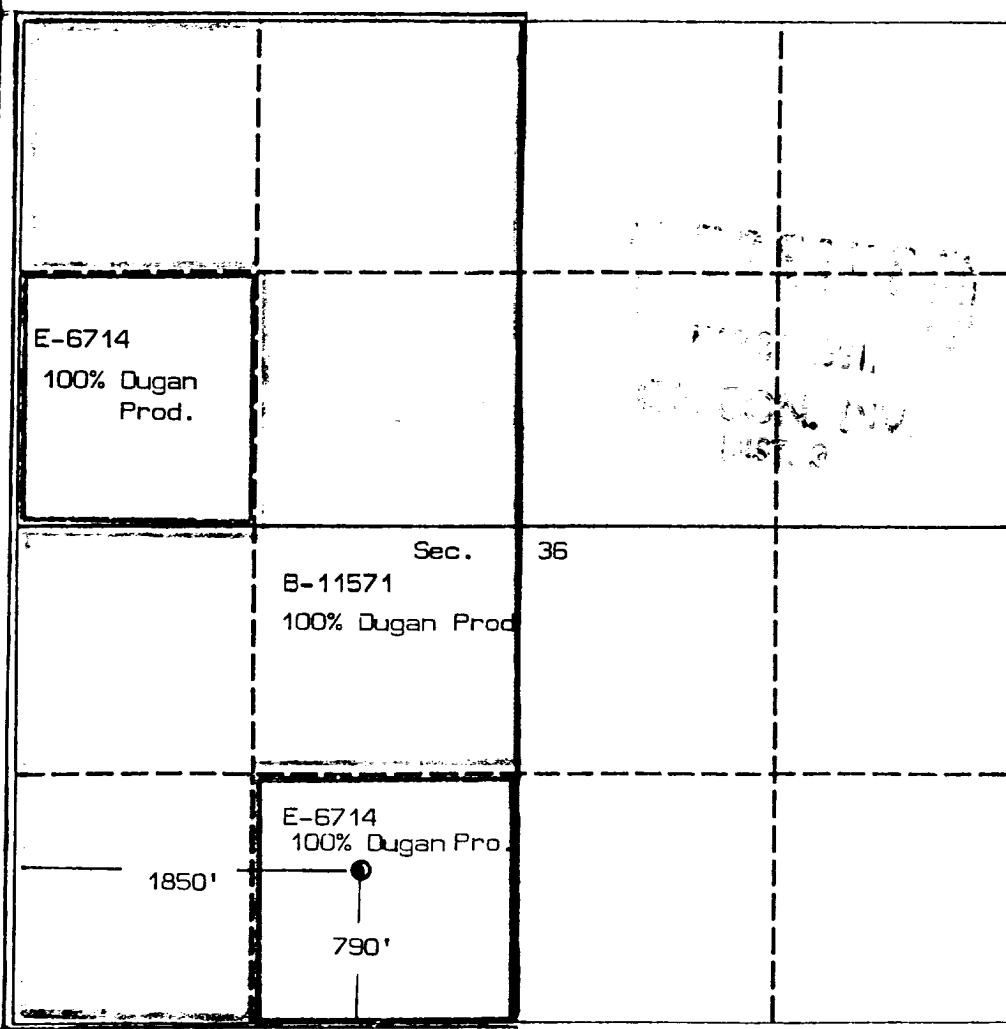

OPERATOR CERTIFICATION

I hereby certify that the information contained herein is true and complete to the best of my knowledge and belief.

Signature  
*Sherman E. Dugan*  
Printed Name  
Sherman E. Dugan  
Position  
Vice-President  
Company  
Dugan Production Corp.  
Date  
3-21-91

SURVEYOR CERTIFICATION

I hereby certify that the well location shown on this plat was plotted from field notes of actual surveys made by me or under my supervision, and that the same is true and correct to the best of my knowledge and belief.

Date Surveyed  
1/21/59  
Signature & Seal of  
Professional Surveyor  
Redraft of original surveyed by Ernest V. Echohawk

Certificate No.  
1545