

NEW MEXICO OIL CONSERVATION COMMISSION
Santa Fe, New Mexico

NOTICE OF INTENTION TO DRILL OR RECOMPLETE

Notice must be given to the District Office of the Oil Conservation Commission and approval obtained before drilling or recompletion begins. If changes in the proposed plan are considered advisable, a copy of this notice showing such changes will be returned to the sender. Submit this notice in QUINTUPPLICATE. One copy will be returned following approval. See additional instructions in Rules and Regulations of the Commission.

Albuquerque, New Mexico

(Place)

July 13, 1959

(Date)

OIL CONSERVATION COMMISSION
SANTA FE, NEW MEXICO

Gentlemen:

You are hereby notified that it is our intention to commence the (Drilling) (Recompletion) of a well to be known as

Pubco Petroleum Corporation

(Company or Operator)

Delhi-State

(Lease)

Well No. #1

in I

(Unit)

The well is

located 1800 feet from the South line and 890 feet from the

East

line of Section 36

T. 30N

R. 9W

NMPM.

(GIVE LOCATION FROM SECTION LINE) Undesignated Pool, San Juan County

If State Land the Oil and Gas Lease is No. See attached gas plat

If patented land the owner is

Address

We propose to drill well with drilling equipment as follows: Rotary through the
Pictured Cliffs formation.The status of plugging bond is \$10,000 Blanket Bond previously
approved and filed with the Commission.

Drilling Contractor not selected

We intend to complete this well in the Pictured Cliffs JUL 15 1959

formation at an approximate depth of 2630

OIL CON. CO. DIST. 3

CASING PROGRAM

We propose to use the following strings of Casing and to cement them as indicated:

Size of Hole	Size of Casing	Weight per Foot	New or Second Hand	Depth	Sacks Cement
9 5/8	8 5/8	24	new	100+	cement circulated
6 3/4	4 1/2	9.5	new	2630+	250 sacks

If changes in the above plans become advisable we will notify you immediately.

ADDITIONAL INFORMATION (If recompletion give full details of proposed plan of work.)

It is proposed to drill through the Pictured Cliffs formation with rotary, set 4 1/2" pipe to total depth (2630+) and perforate and sand-water frac the Pictured Cliffs formation. After frac the well will be cleaned out and 1" tubing run to 2575+.

JUL 15 1959

Approved....., 19.....
Except as follows:

Sincerely yours,

Pubco Petroleum Corporation

(Company or Operator)

By James E. Holdeman

Position District Geologist

Send Communications regarding well to

Name James E. Holdeman

Address Pubco Petroleum Corporation

Box 1419, Albuquerque, New Mexico

OIL CONSERVATION COMMISSION

By A. R. Kuehnle
Title PETROLEUM ENGINEER DIST NO. 3

NEW MEXICO OIL CONSERVATION COMMISSION
Well Location and Acreage Dedication Plat

Section A.

Date July 13, 1959

Operator PUBCO PETROLEUM CO. Lease DELHI STATE
Well No. 1 Unit Letter I Section 36 Township 30 N Range 9 W NMPM
Located 1800 Feet From south Line, 890 Feet From east Line
County San Juan G. L. Elevation 5847 Dedicated Acreage 160 Acres
Name of Producing Formation Pictured Cliffs Pool Undesignated

1. Is the Operator the only owner* in the dedicated acreage outlined on the plat below?
Yes _____ No X.
2. If the answer to question one is "no," have the interests of all the owners been consolidated by communitization agreement or otherwise? Yes X No _____. If answer is "yes," Type of Consolidation Communitization Agreement
3. If the answer to question two is "no," list all the owners and their respective interests below:

Owner	Land Description	
<u>Pubco Petroleum Corporation</u>	<u>NE/4 SE/4</u>	<u>B 11479-22</u> 40 acres
<u>Pubco Petroleum Corporation</u>	<u>NW/4 SE/4</u>	<u>E 5315</u> 40 acres
<u>Pubco Petroleum Corporation</u>	<u>SW/4 SE/4</u>	<u>B 11479-20</u> 40 acres
<u>Delhi-Taylor Oil Corporation</u>	<u>SE/4 SE/4</u>	<u>E 1641</u> 40 acres
		160 acres

Section B

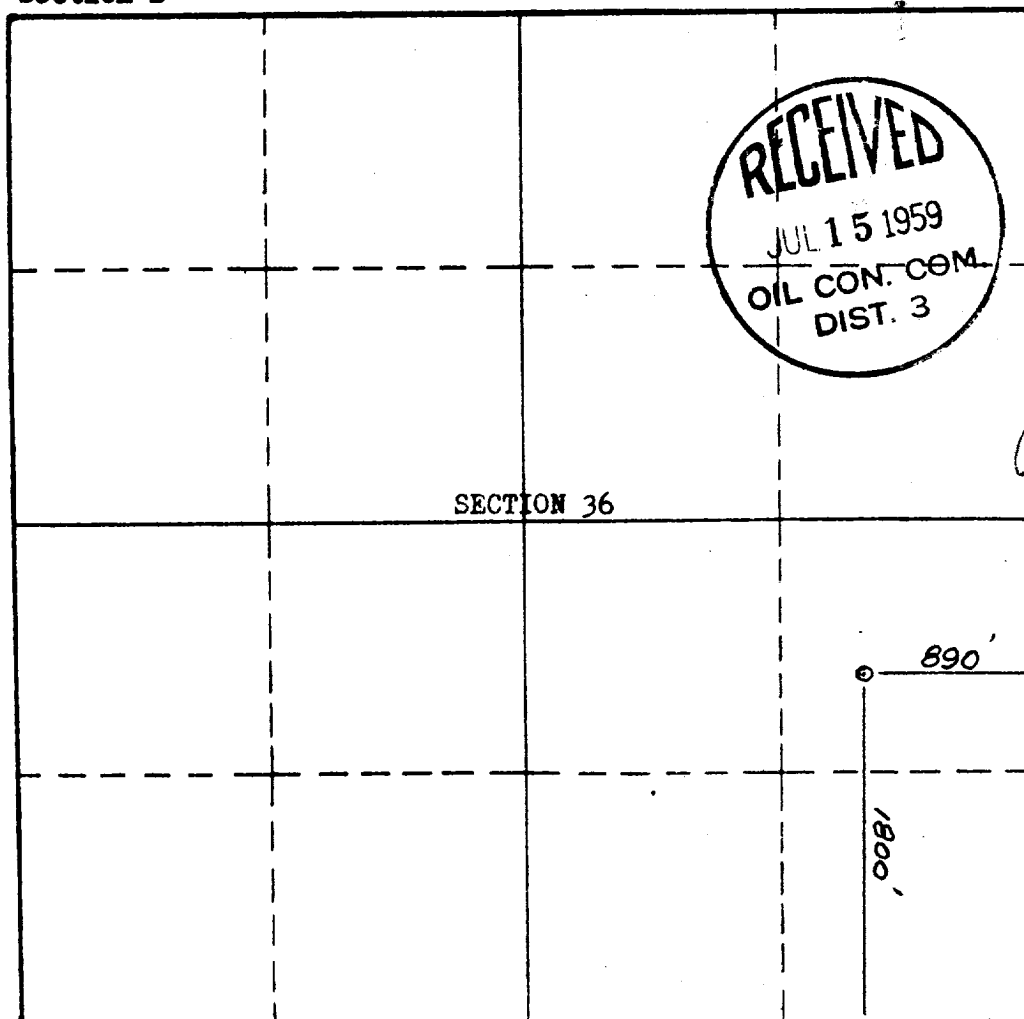

This is to certify that the information in Section A above is true and complete to the best of my knowledge and belief.

PUBCO PETROLEUM CORPORATION
(Operator)

James E. Holdeman
(Representative)
James E. Holdeman, Dist. Geo.
Post Office Box 1419

Address
Albuquerque, New Mexico

This is to certify that the well location shown on the plat in Section B was plotted from field notes of actual surveys made by me or under my supervision and that the same is true and correct to the best of my knowledge and belief.

Date Surveyed July 9, 1959

Stephen E. Finney
STEPHEN E. FINNEY
Registered Professional
Engineer and/or Land Surveyor.

Certificate No. 803

NEW MEXICO
OIL CONSERVATION COMMISSION

Gas Well Plat

Date July 13, 1959

Pubco Petroleum Corporation Delhi-State #1
Operator Lease Well No.

Name of Producing Formation Pictured Cliffs Pool Undesignated

No. Acres Dedicated to the Well 160

SECTION 36 TOWNSHIP 30N RANGE 9W

			<div data-bbox="1088 851 1396 1170"><p>RECEIVED JUL 15 1959 OIL CON. COM. DIST. 3</p></div>
		Pubco Petr. Corp. E 5315	Pubco Petr. Corp. B 11479-22
		Pubco Petr. Corp. B 11479-20	Pubco Petr. Corp. E 1641

I hereby certify that the information given above is true and complete to the best of my knowledge.

James E. Holdeman
Name James E. Holdeman
Position District Geologist
Representing Pubco Petroleum Corp.
Address P. O. Box 1419, Albuquerque,
New Mexico

(over)

INSTRUCTIONS

1. Is this gas well a dual completion? Yes _____ No **X** _____.
2. If the answer to Question 1 is Yes, are there any other dually completed wells within the dedicated acreage?
Yes _____ No _____.

A separate plat must be filed for each gas well, outlining the area dedicated to such well and showing the location of all other wells (oil and gas) within the outlined area.

Mail in duplicate to the district office for the district in which the well is located.

OIL CONSERVATION COMMISSION		
AZTEC DISTRICT OFFICE		
No. Copies Received <u>5</u>		
DISTRIBUTION		
	NO. FURNISHED	
Operator		
Santa Fe	/	
Proration Off.		
State Land Office	/	
U. S. G. S.		
Transporter		
File	/	/