

Form 9-381b
(April 1962)

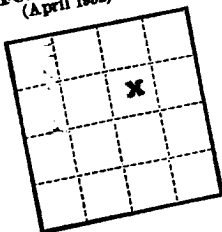

Calc

(SUBMIT IN TRIPLICATE)
**UNITED STATES
DEPARTMENT OF THE INTERIOR
GEOLOGICAL SURVEY**

Indian Agency Navajo

Allottee

Lease No. 14-20-603-1048

SUNDRY NOTICES AND REPORTS ON WELLS

RECEIVED

<input checked="" type="checkbox"/>	SUBSEQUENT REPORT OF WATER SHUT-OFF
<input type="checkbox"/>	SUBSEQUENT REPORT OF SHOOTING OR ACIDIZING
<input type="checkbox"/>	SUBSEQUENT REPORT OF ALTERING CASING
<input type="checkbox"/>	SUBSEQUENT REPORT OF REDRILLING OR REPAIR
<input type="checkbox"/>	SUBSEQUENT REPORT OF ABANDONMENT
<input type="checkbox"/>	SUPPLEMENTARY WELL HISTORY

NOTICE OF INTENTION TO DRILL _____

NOTICE OF INTENTION TO CHANGE PLANS _____

NOTICE OF INTENTION TO TEST WATER SHUT-OFF _____

NOTICE OF INTENTION TO REDRILL OR REPAIR WELL _____

NOTICE OF INTENTION TO SHOOT OR ACIDIZE _____

NOTICE OF INTENTION TO PULL OR ALTER CASING _____

NOTICE OF INTENTION TO ABANDON WELL _____

(INDICATE ABOVE BY CHECK MARK NATURE OF REPORT, NOTICE, OR OTHER DATA)

U.S. GEOLOGICAL SURVEY
FARMINGTON, NEW MEXICO

13

Well No. 2 is located 2475 ft. from [N] line and 2475 ft. from [E] line of sec. 33

SW 1/4 NE 1/4 Sec. 33 30N 13W 10MPM

Wildcat San Juan New Mexico

(Field) (County or Subdivision) (State or Territory)

The elevation of the derrick floor above sea level is 5094 ft.

DETAILS OF WORK

(State names of and expected depths to objective sands; show sizes, weights, and lengths of proposed casings; indicate mudding jobs, cementing points, and all other important proposed work)

Propose to air drill thru Gallup formation, at a depth of 500 feet, and if commercial production encountered set and cement 5 1/4 inch casing on top of producing formation.

REL
MAY 20 1963
OIL CON. COM.
DIST. 3

I understand that this plan of work must receive approval in writing by the Geological Survey before operations may be commenced.

Company Snow Flake Oil, Inc.

Address 515 Simms Bldg.
Albuquerque, New Mexico

By Frank A. King
Title Vice President

NUMBER OF COPIES RECEIVED	
DISTRIBUTION	
SANTA FE	
FILE	
U.S.G.S.	
LAND OFFICE	
TRANSPORTER	OIL GAS
PRODUCTION OFFICE	
OPERATOR	

NEW MEXICO OIL CONSERVATION COMMISSION
WELL LOCATION AND ACREAGE DEDICATION PLAT
 SEE INSTRUCTIONS FOR COMPLETING THIS FORM ON THE REVERSE SIDE

FORM C-128
 Revised 5/1/57

SECTION A

Operator Snow Flake Oil, Inc.		Lease Indian Cont. 14-20-603-1040		Well No. 2
Unit Letter 0	Section 33	Township 30N	Range 10W	County San Juan
Actual Footage Location of Well: 2475 feet from the North line and 2475 feet from the East line				
Ground Level Elev. 5094	Producing Formation Gallup	Pool Wildcat	Dedicated Acreage: 80 Acres	

1. Is the Operator the only owner in the dedicated acreage outlined on the plat below? YES ☒ NO ☐ . ("Owner" means the person who has the right to drill into and to produce from any pool and to appropriate the production either for himself or for himself and another. (65-3-29 (e) NMSA 1935 Comp.)
2. If the answer to question one is "no," have the interests of all the owners been consolidated by communitization agreement or otherwise? YES ☐ NO ☐ . If answer is "yes," Type of Consolidation _____
3. If the answer to question two is "no," list all the owners and their respective interests below:

Owner	Land Description

SECTION B

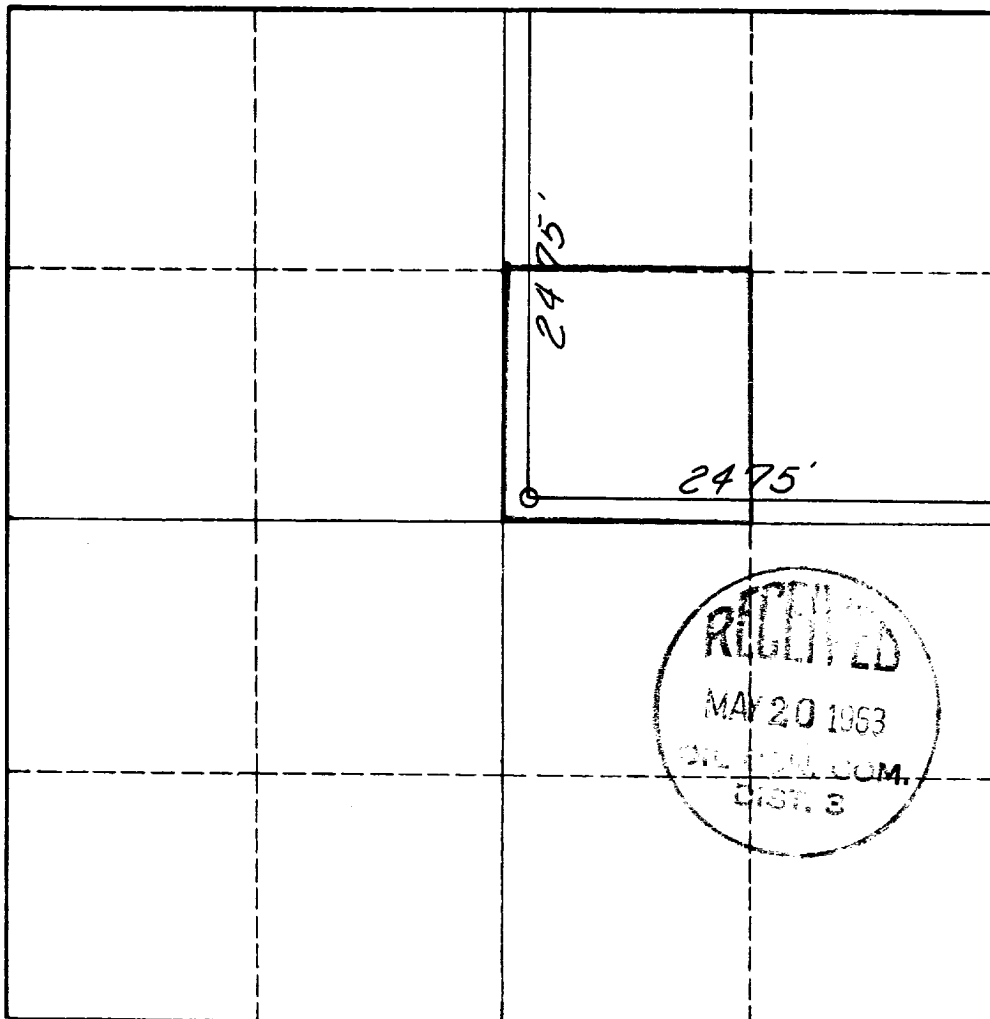

CERTIFICATION

I hereby certify that the information in SECTION A above is true and complete to the best of my knowledge and belief.

Name	Frank A. King
Position	Vice-President
Company	Snow Flake Oil, Inc.
Date	May 16, 1963

I hereby certify that the well location shown on the plat in SECTION B was plotted from field notes of actual surveys made by me or under my supervision, and that the same is true and correct to the best of my knowledge and belief.

Date Surveyed	April 24, 1963
Registered Professional Engineer and/or Land Surveyor	R.J. Scanlon
Certificate No.	2457

0 330 660 990 1320 1650 1980 2310 2640 2000 1500 1000 500 0

INSTRUCTIONS FOR COMPLETION OF FORM C-128

1. Operator shall furnish and certify to the information called for in Section A.
2. Operator shall outline the dedicated acreage for *both* oil and gas wells on the plat in Section B.
3. A registered professional engineer or land surveyor registered in the State of New Mexico or approved by the Commission shall show on the plat the location of the well and certify this information in the space provided.
4. All distances shown on the plat must be from the outer boundaries of the Section.
5. If additional space is needed for listing owners and their respective interests as required in question 3 of Section A, please use space below.