

(SUBMIT IN TRIPLICATE)

UNITED STATES
DEPARTMENT OF THE INTERIOR
GEOLOGICAL SURVEY

Land Office Santa Fe
Lease No. 078385
Unit W₂ Sec. 25

SUNDRY NOTICES AND REPORTS ON WELLS

NOTICE OF INTENTION TO DRILL	<input checked="" type="checkbox"/>	SUBSEQUENT REPORT OF WATER SHUT-OFF	
NOTICE OF INTENTION TO CHANGE PLANS		SUBSEQUENT REPORT OF SHOOTING OR ACIDIZING	
NOTICE OF INTENTION TO TEST WATER SHUT-OFF		SUBSEQUENT REPORT OF ALTERING CASING	
NOTICE OF INTENTION TO RE-DRILL OR REPAIR WELL		SUBSEQUENT REPORT OF REDRILLING OR REPAIR	
NOTICE OF INTENTION TO SHOOT OR ACIDIZE		SUBSEQUENT REPORT OF ABANDONMENT	
NOTICE OF INTENTION TO PULL OR ALTER CASING		SUPPLEMENTARY WELL HISTORY	
NOTICE OF INTENTION TO ABANDON WELL			

(INDICATE ABOVE BY CHECK MARK NATURE OF REPORT, NOTICE, OR OTHER DATA)

Florance

June 23, 1953, 19

Well No. 3-29 is located 1500 ft. from SW_{1/4} line and 3730 ft. from E line of sec. 25

SW_{1/4} Sec. 25 30-N 8-W NMPM
($\frac{1}{4}$ Sec. and Sec. No.) (Twp.) (Range) (Meridian)

Blanco San Juan New Mexico
(Field) (County or Subdivision) (State or Territory)

The elevation of the derrick floor above sea level is 6202 ft.

DETAILS OF WORK

(State names of and expected depths to objective sands; show sizes, weights, and lengths of proposed casings; indicate mudding jobs, cementing points, and all other important proposed work)

We propose to drill with rotary tools to the top of Cliffhouse sand, set pipe, then drill with rotary using gas thru Cliffhouse, Menefee & Point Lookout, shoot with nitro and clean out for gas completion in entire Mesa Verde.

Proposed Casing program:

250' - 10-3/4" 32.75# H-40 Casing - cemented to surface
4500' - 7" 20# J-55 Casing - cemented w/ 200 sx
5200' - 1.9" SS Tubing

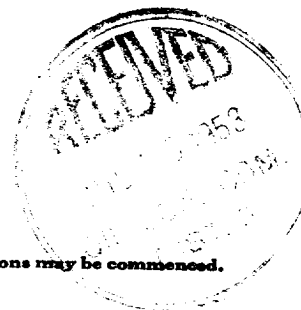

I understand that this plan of work must receive approval in writing by the Geological Survey before operations may be commenced.

Company Delhi Oil Corporation

Address Box #1175

Farmington, N.M.

By J. M. Maxwell

Title Supt.

COPY TO O.C.G.

RECEIVED

JUN 24 1953

U. S. GEOLOGICAL SURVEY
FARMINGTON, N. M.

Company.....Delhi Oil Corporation.....

Lease.....**Fluorance**.....Well No. **3-29**.....

37 - 078385

Sec. 25, T. 30 N., R. 8 W., N.M.P.M.

Location 1500' North and 3730' West of the SE Corner
of Sec. 25-30-8.

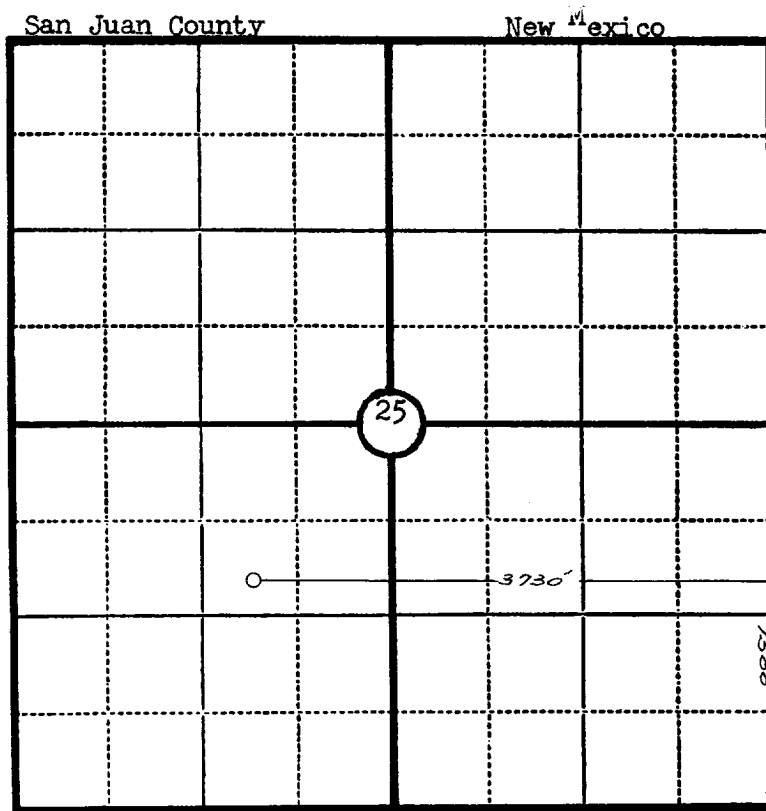

Scale—4 inches equal 1 mile.

This is to certify that the above plat was prepared from field notes of actual surveys made by me or under my supervision and that the same are true and correct to the best of my knowledge and belief.



Seal:

Registered Professional
Engineer and Land Surveyor.

Ernest V. Echohawk
N. Mex. Reg. No. 1545

Surveyed March 15, 1953.