

(SUBMIT IN TRIPLICATE)

UNITED STATES
DEPARTMENT OF THE INTERIOR
GEOLOGICAL SURVEY

Land Office **SF**
Lease No. **080212**
Unit **Malco-Coyote**

RECEIVED

SUNDRY NOTICES AND REPORTS ON WELLS

EEB 3 1958

U.S. GEOLOGICAL SURVEY
FARMINGTON, NEW MEXICO

NOTICE OF INTENTION TO DRILL.....	<input checked="" type="checkbox"/>	SUBSEQUENT REPORT OF WATER SHUT-OFF.....
NOTICE OF INTENTION TO CHANGE PLANS.....	<input type="checkbox"/>	SUBSEQUENT REPORT OF SHOOTING OR ACIDIZING.....
NOTICE OF INTENTION TO TEST WATER SHUT-OFF.....	<input type="checkbox"/>	SUBSEQUENT REPORT OF ALTERING CASING.....
NOTICE OF INTENTION TO RE-DRILL OR REPAIR WELL.....	<input type="checkbox"/>	SUBSEQUENT REPORT OF RE-DRILLING OR REPAIR.....
NOTICE OF INTENTION TO SHOOT OR ACIDIZE.....	<input type="checkbox"/>	SUBSEQUENT REPORT OF ABANDONMENT.....
NOTICE OF INTENTION TO PULL OR ALTER CASING.....	<input type="checkbox"/>	SUPPLEMENTARY WELL HISTORY.....
NOTICE OF INTENTION TO ABANDON WELL.....	<input type="checkbox"/>	

(INDICATE ABOVE BY CHECK MARK NATURE OF REPORT, NOTICE, OR OTHER DATA)

January 31, 1958

Well No. **7** is located **1980** ft. from **NE** line and **1980** ft. from **W** line of sec. **5**

NE SW/4 Sec. 5 (1/4 Sec. and Sec. No.)
Verde Gallup (Field)
30-N (Twp.)
15-W (Range)
SAN JUAN (County or Subdivision)
NMPM (Meridian)
NEW MEXICO (State or Territory)

The elevation of the derrick floor above sea level is **5391** ft.

DETAILS OF WORK

(State names of and expected depths to objective sands; show sizes, weights, and lengths of proposed casings; indicate mudlogging jobs, cementing points, and all other important proposed work)

It is intended to drill to the top of the Lower-Gallup with rotary tools using mud circulation. 5-1/2" casing will be set with a two stage collar set below the Point Lookout for circulation of cement.

It is then intended to drill into the Lower-Gallup using cable tools. A 4-1/2" slotted liner will be run following sandoil fracturing of the open-hole interval.

Estimated Total Depth 3310'.

Casing Program:

10-3/4" at 120' with 125 sacks cement circulated to surface.

5-1/2" at 3200' with 150 sacks cement - 1st stage; 50 sacks cement - 2nd stage.

4-1/2" liner at 3310' not cemented.

NE SW/4 of Sec. 5 is dedicated to this well. NE SW/4 Sec. 5 SF 080212

I understand that this plan of work must receive approval in writing by the Geological Survey before operations may be commenced.

Company **El Paso Natural Gas Products Company**

Address **Post Office Box 1565**
Farmington, New Mexico

ORIGINAL SIGNED BY: JOSEPH E. KRECH

By

Title **Petroleum Engineer**

NEW MEXICO OIL CONSERVATION COMMISSION

Well Location and Acreage Dedication Plat

Section A.

Date January 2, 1958

Operator El Paso Natural Gas Products Company Lease Melroe-Coppie SP-000212
Well No. 7 Unit Letter E Section 5 Township 30 North Range 15 West NMPM
Located 1980 Feet From South Line, 1980 Feet From West Line
County San Juan G. L. Elevation 5381 Dedicated Acreage 25.0 Acres
Name of Producing Formation Lower-Gallup Pool Verde-Gallup

1. Is the Operator the only owner* in the dedicated acreage outlined on the plat below?
Yes X No
2. If the answer to question one is "no," have the interests of all the owners been consolidated by communitization agreement or otherwise? Yes No . If answer is "yes,"
Type of Consolidation
3. If the answer to question two is "no," list all the owners and their respective interests below:

Owner

Land Description

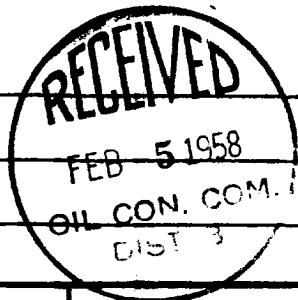

Section. B

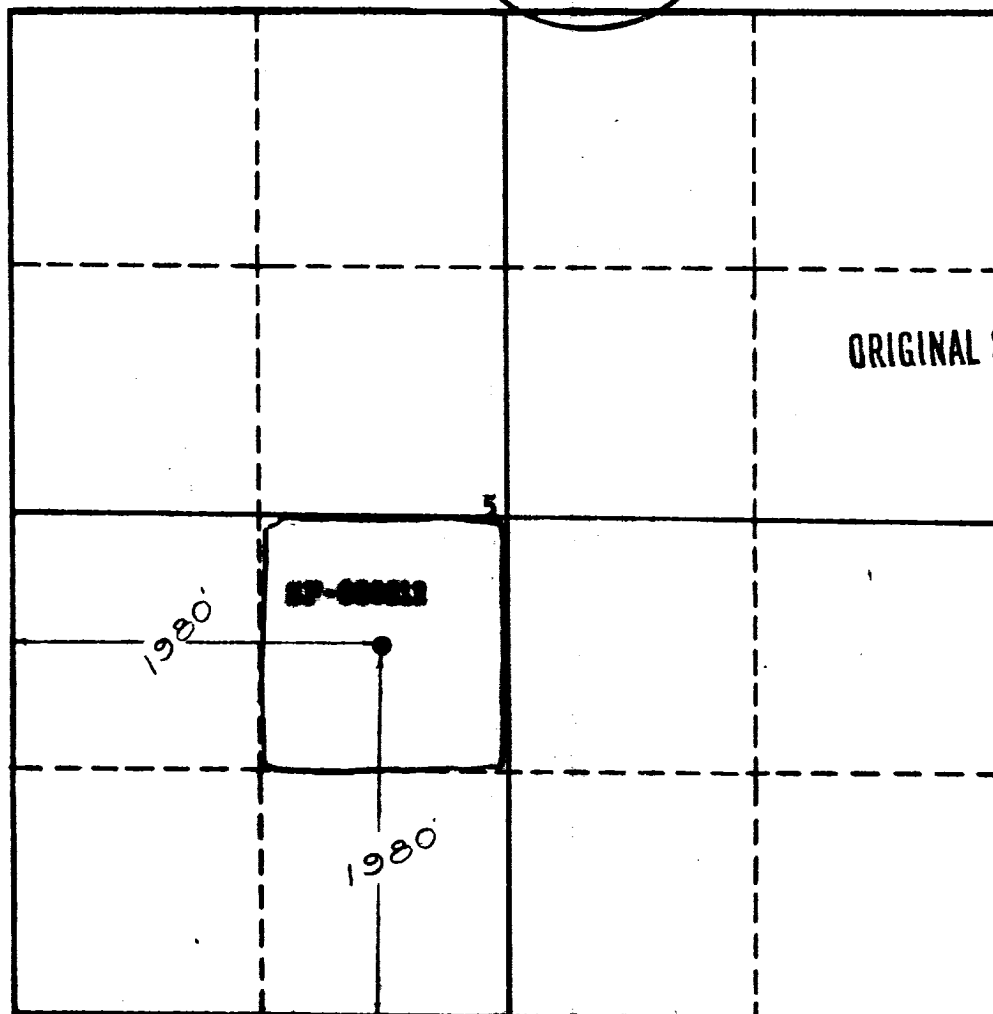

This is to certify that the information in Section A above is true and complete to the best of my knowledge and belief.

El Paso Natural Gas Products Co.

(Operator)

ORIGINAL SIGNED BY: JOSEPH E. KREGER

(Representative)

Box 1244, Farmington, New Mexico

Address

This is to certify that the well location shown on the plat in Section B was plotted from field notes of actual survey made by me or under my supervision and is the same in all respects to the best of my knowledge and belief.

Date Surveyed Jan. 7, 1958

Ernest V. Echohawk
Registered Land Surveyor.

Certificate No. 1545