

(SUBMIT IN TRIPLICATE)

Indian Agency Navajo Allotted

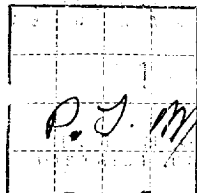

UNITED STATES
DEPARTMENT OF THE INTERIOR
GEOLOGICAL SURVEY

Allottee _____
Lease No. 14-20-603-4907

SUNDRY NOTICES AND REPORTS ON WELLS

| | | | |
|---|-------------------------------------|--|--|
| NOTICE OF INTENTION TO DRILL | <input checked="" type="checkbox"/> | SUBSEQUENT REPORT OF WATER SHUT-OFF | |
| NOTICE OF INTENTION TO CHANGE PLANS | | SUBSEQUENT REPORT OF SHOOTING OR ACIDIZING | |
| NOTICE OF INTENTION TO TEST WATER SHUT-OFF | | SUBSEQUENT REPORT OF ALTERING CASING | |
| NOTICE OF INTENTION TO REDRILL OR REPAIR WELL | | SUBSEQUENT REPORT OF REDRILLING OR REPAIR | |
| NOTICE OF INTENTION TO SHOOT OR ACIDIZE | | SUBSEQUENT REPORT OF ABANDONMENT | |
| NOTICE OF INTENTION TO PULL OR ALTER CASING | | SUPPLEMENTARY WELL HISTORY | |
| NOTICE OF INTENTION TO ABANDON WELL | | | |

(INDICATE ABOVE BY CHECK MARK NATURE OF REPORT, NOTICE, OR OTHER DATA)

Feb. 3, 1960

Well No. Navajo 82-1 1 is located 1997 ft. from S line and 1820 ft. from Ex line of sec. 1
NE 1, SW 1, Sec. 1 30N 16W NMPM
(¼ Sec. and Sec. No.) (Twp.) (Range) (Meridian)
Undesignated San Juan New Mexico
(Field) (County or Subdivision) (State or Territory)

The elevation of the derrick floor above sea level is _____ ft. **Will report later**

DETAILS OF WORK

(State names of and expected depths to objective sands; show sizes, weights, and lengths of proposed casings; indicate mudlogging jobs, cementing points, and all other important proposed work)

Notice is here given of intention to drill the Navajo 82-1-1 well. $5\frac{5}{8}$ " csg. will be set at 100 ft. and cement will be circulated to surface. The pipe will be tested with 1000 psi. after WOC for 24 hours. $5\frac{1}{2}$ " csg. will be set at 1575' with 200 sacks cement. Pipe will be tested with 1500 psi. pressure after WOC 30 hours. A $4\frac{3}{4}$ " hole will then be drilled to a TD of 1900 ft. The well will be completed in the Gallup Formation open hole.

I understand that this plan of work must receive approval in writing by the Geological Survey before operations may be commenced.

Company Standard Oil Co. of Texas

Address Box 1581

Farmington, New Mexico

By _____

Title Field Foreman

NEW MEXICO OIL CONSERVATION COMMISSION
WELL LOCATION AND ACREAGE DEDICATION PLAT

FORM C-128
 Revised 5/1/57

SEE INSTRUCTIONS FOR COMPLETING THIS FORM ON THE REVERSE SIDE

SECTION A

| | | | | | |
|--|---------------------|-----------------------------|--|---------------------------|----------------------|
| Operator STANDARD OIL COMPANY OF TEXAS | | | Lease NAVAJO 82 - 1 (11-20-603-1907) | | Well No. 1 |
| Unit Letter K | Section 1 | Township 30 NORTH | Range 16 WEST | County SAN JUAN | |

Actual Footage Location of Well:

1997 feet from the **SOUTH** line and **1820** feet from the **WEST** line

| | | | |
|--|---------------------|-------------------------|---------------------------------------|
| Ground Level Elev. | Producing Formation | Pool | Dedicated Acreage: 40 Acres |
| Will report later Gallup | | Undesignated | |

1. Is the Operator the only owner in the dedicated acreage outlined on the plat below? YES ☒ NO ____ . ("Owner" means the person who has the right to drill into and to produce from any pool and to appropriate the production either for himself or for himself and another. (65-3-29 (e) NMSA 1935 Comp.)
2. If the answer to question one is "no," have the interests of all the owners been consolidated by communitization agreement or otherwise? YES ____ NO ____ . If answer is "yes," Type of Consolidation ____
3. If the answer to question two is "no," list all the owners and their respective interests below:

| | |
|-------|------------------|
| Owner | Land Description |
| | |

SECTION B

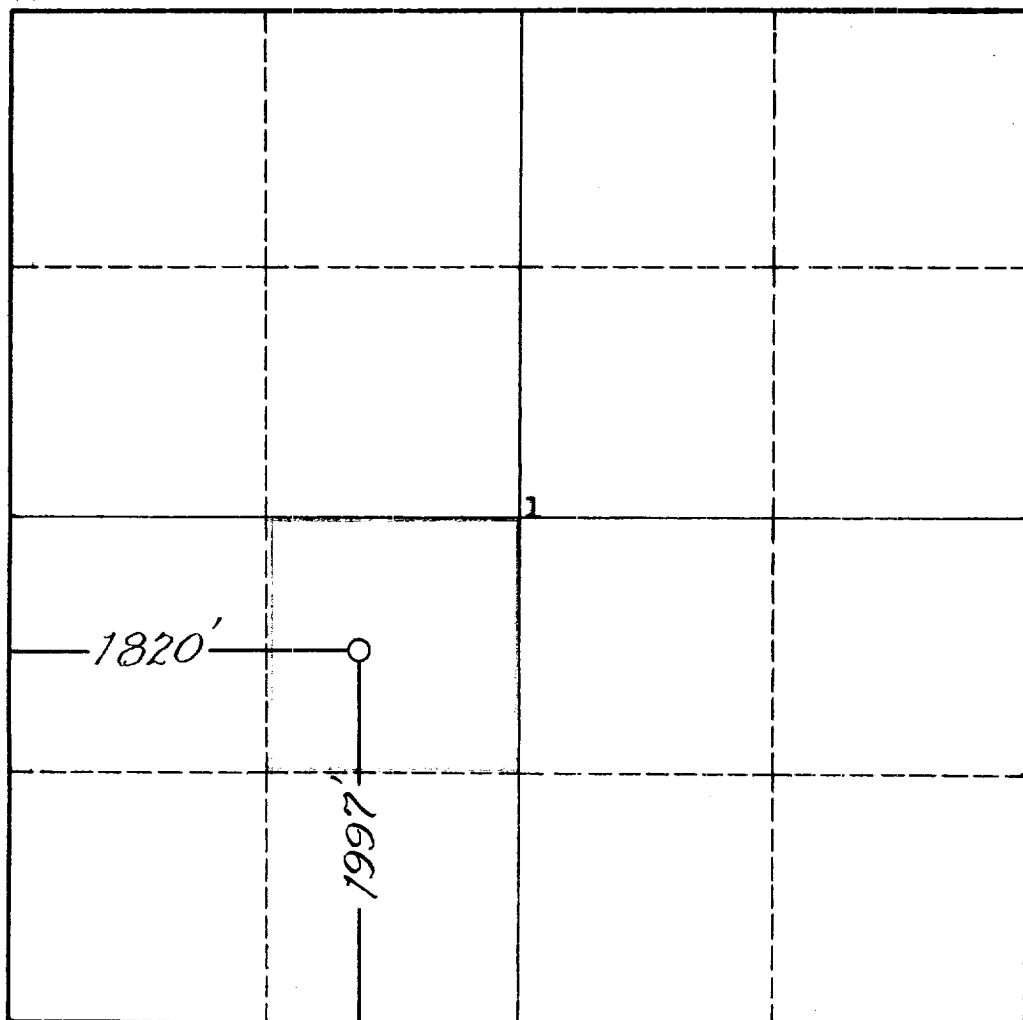

CERTIFICATION

I hereby certify that the information in SECTION A above is true and complete to the best of my knowledge and belief.

| |
|---|
| Name <i>P. L. Leese</i> |
| Position Field Foreman |
| Company Standard Oil Co. of Texas |
| Date Feb. 1, 1960 |

I hereby certify that the well location shown on the plat in SECTION B was plotted from field notes of actual surveys made by me or under my supervision, and that the same is true and correct to the best of my knowledge and belief.

| |
|--|
| Date Surveyed 2 February 1960 |
| Registered Professional Engineer and/or Land Surveyor <i>James P. Leese</i> |
| Certificate No. 1463 |

0 330 660 990 1320 1650 1980 2310 2640 2000 1500 1000 500 0

PLEASE READ BEFORE STARTING OPERATIONS

Attention is called to the following requirements for operators on Federal, Indian and Acquired land oil and gas leases. The District Engineer may require suspension of operations for your failure to comply with the "Oil & Gas Operating Regulations", and these requirements. A copy of the "Operating Regulations" will be furnished you upon request.

GENERAL

1. All drilling and producing wells must be permanently marked by a well sign in a conspicuous place showing the name of operator, lease name, serial number of lease, well number, and location. Well signs must be maintained in legible condition.

2. Any change in the proposed plan or condition of approval must have approval of the District Engineer BEFORE the change is made.

3. Approval of a notice of intention to drill or abandon any well will be rescinded without further notice if drilling or abandonment is not started within 90 days.

4. A Subsequent Report of Operations on form 9-331a (9331b Indian), in triplicate, must be submitted to the District Engineer giving complete information, including dates the work was done, covering:

A. On new wells

- a. Cementing casing and method and results of water shut off tests. (Show spud date on first report submitted.)

B. On work overs

- a. Deepening or plugging back
- b. Perforating, acidizing, fracturing, shooting, casing alterations.
- c. Drill stem and other production tests

5. Log, in quadruplicate, on form 9-330, must be submitted to the District Engineer within 15 days of completion, abandonment, or suspension unless operator is otherwise instructed by the District Engineer. The log should include a complete driller's log, descriptions and intervals of all cores, formation tops identified, results of all drill stem tests, perforating, fracturing, acidizing, shooting, production tests, and all other well information not previously reported. Duplicate copies of all electrical logs, sample logs, drilling time logs, temperature, deviation, and other well surveys also must be filed.

6. Monthly report of operations for each lease, in duplicate on form 9-329 (9-329A Indian), must be submitted promptly each month to U.S. Geological Survey, Box 6721, Roswell, New Mexico, beginning with spudding of the first well on a lease and continuing until abandonment of all drilling and producing operations is approved.

7. All wells and lease premises shall be maintained in a workman like manner with due regard to safety, conservation, and appearance.

Revised October 1957