

(SUBMIT IN TRIPLICATE)

Indian Agency Navajo

UNITED STATES
DEPARTMENT OF THE INTERIOR
GEOLOGICAL SURVEY

Allottee Bele lin chee Bega

Lease No. 14-20-603-4904

30
N

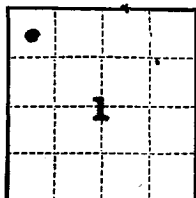

16W

SUNDRY NOTICES AND REPORTS ON WELLS

NOTICE OF INTENTION TO DRILL	X	SUBSEQUENT REPORT OF WATER SHUT-OFF	RECEIVED APR 3 1962 U. S. GEOLOGICAL SURVEY WASHINGTON, D. C.
NOTICE OF INTENTION TO CHANGE PLANS		SUBSEQUENT REPORT OF SHOOTING OR ACIDIZING	
NOTICE OF INTENTION TO TEST WATER SHUT-OFF		SUBSEQUENT REPORT OF ALTERING CASING	
NOTICE OF INTENTION TO REDRILL OR REPAIR WELL		SUBSEQUENT REPORT OF REDRILLING OR REPAIR	
NOTICE OF INTENTION TO SHOOT OR ACIDIZE		SUBSEQUENT REPORT OF ABANDONMENT	
NOTICE OF INTENTION TO PULL OR ALTER CASING		SUPPLEMENTARY WELL HISTORY	
NOTICE OF INTENTION TO ABANDON WELL			

(INDICATE ABOVE BY CHECK MARK NATURE OF REPORT, NOTICE, OR OTHER DATA)

February 19, 1962

Indian
Well No. 4-1 is located 660 ft. from N line and 660 ft. from EW line of sec. 1

NW NW 1 30N 16W NMPM
(1/4 Sec. and Sec. No.) (Twp.) (Range) (Meridian)

Horseshoe Canyon-Ext. San Juan New Mexico
(Field) (County or Subdivision) (State or Territory)

The elevation of the derrick floor above sea level is _____ ft. 5560 G.L.

DETAILS OF WORK

(State names of and expected depths to objective sands; show sizes, weights, and lengths of proposed casings; indicate mudding jobs, cementing points, and all other important proposed work)

Propose to test for oil in the Gallup formation. Subject test will have a total depth of 1800' unless commercial production is encountered before reaching that depth.

1. Set 8-5/8" surface casing at 200' with sufficient cement to circulate.
2. Drill with air to 1475', run IES log, set 5-1/2" casing with 100 sxs cement.
3. Drill to total depth with air and complete open hole.

I understand that this plan of work must receive approval in writing by the Geological Survey before operations may be commenced.

Company Compass Exploration, Inc.

Address 101 University Boulevard

Denver 6, Colorado

By P. J. Farrelly

Title Chief Geologist

NEW MEXICO OIL CONSERVATION COMMISSION

Well Location and Acreage Dedication Plat

Date February 19, 1962

Section A.

Operator COMPASS EXPLORATION, INC. Lease INDIAN
 Well No. 4-1 Unit Letter D Section 1 Township 30 NORTH Range 16 WEST, NMPM
 Located 660 Feet From the NORTH Line, 660 Feet From the WEST Line
 County SAN JUAN G. L. Elevation 5560.0 Dedicated Acreage 40 Acres
 Name of Producing Formation Gallup Pool Horseshoe Canyon-Ext.

1. Is the Operator the only owner in the dedicated acreage outlined on the plat below?

Yes X No _____

2. If the answer to question one is "no", have the interests of all the owners been consolidated by communization agreement or otherwise? Yes _____ No _____. If answer is "yes", Type of Consolidation.

3. If the answer to question two is "no", list all the owners and their respective interests below:

Owner

Land Description



Section B.

This is to certify that the information in Section A above is true and complete to the best of my knowledge and belief.

COMPASS EXPLORATION, INC.

(Operator)

(Representative)

101 University Boulevard

(Address)

Denver 6, Colorado

Ref: GLO plat dated 3 December 1928

Note: All distances must be from outer boundaries of section.

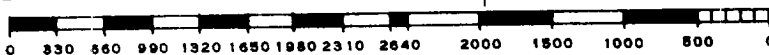
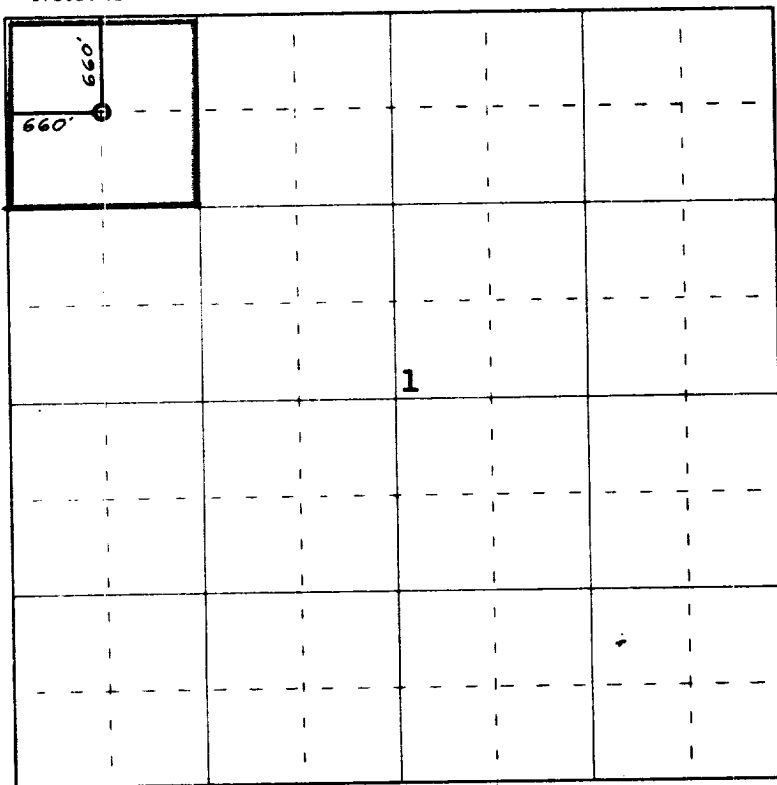

Scale 4 inches equal 1 mile

This is to certify that the above plat was prepared from field notes of actual surveys made by me or under my supervision and that the same are true and correct to the best of my knowledge and belief.

Date Surveyed 16 February 1962

James P. Leese
 Registered Professional Engineer and/or Land Surveyor
 James P. Leese N. Mex. Reg. No. 1463
 San Juan Engineering Company

Farmington, New Mexico

