

NEW MEXICO OIL CONSERVATION COMMISSION

SANTA FE, NEW MEXICO

7-3-58

APPLICATION FOR DUAL COMPLETION

Field Name Undesignated		County San Juan		Date November 28, 1958
Operator Blackwood & Nichols Company		Lease Northeast Blanco Unit		Well No. 56-34
Location of Well A	Unit 34	Section 34	Township 31N	Range 7N

1. Has the New Mexico Oil Conservation Commission heretofore authorized the dual completion of a well in these same pools or in the same zones within one mile of the subject well? YES ☒ NO ☐
2. If answer is yes, identify one such instance: Order No. **DC 695**; Operator, Lease, and Well No.:

Blackwood & Nichols Company NEU #55-22

3. The following facts are submitted:	Upper Zone	Lower Zone
a. Name of reservoir	Mesaverte	Bakota
b. Top and Bottom of Pay Section (Perforations)	5180'-5638'	7660'-7805'
c. Type of production (Oil or Gas)	Gas	Gas
d. Method of Production (Flowing or Artificial Lift)	Flow	Flow

4. The following are attached. (Please mark YES or NO)

- ☒ a. Diagrammatic Sketch of the Dual Completion, showing all casing strings, including size and setting, top of cement, perforated intervals, tubing strings, including diameters and setting depth, location and type of packers and side door chokes, and such other information as may be pertinent.
- ☒ b. Plat showing the location of all wells on applicant's lease, all offset wells on offset leases, and the names and addresses of operators of all leases offsetting applicant's lease.
- ☐ c. Waivers consenting to such dual completion from each offset operator, or in lieu thereof, evidence that said offset operators have been furnished copies of the application.*
- ☒ d. Electrical log of the well or other acceptable log with tops and bottoms of producing zones and intervals of perforation indicated thereon. (If such log is not available at the time application is filed, it shall be submitted as provided by Rule 112-A.)

5. List all offset operators to the lease on which this well is located together with their correct mailing address.

* **Offset acreage committed to Northeast Blanco Unit on which Blackwood & Nichols Company is Unit Operator.**

6. Were all operators listed in Item 5 above notified and furnished a copy of this application? YES ☐ NO ☐ If answer is yes, give date of such notification _____.

CERTIFICATE: I, the undersigned, state that I am the **Field Superintendent** of the **Blackwood & Nichols Co.** (company), and that I am authorized by said company to make this report; and that this report was prepared under my supervision and direction and that the facts stated therein are true, correct and complete to the best of my knowledge.

Original Signed
by **Delasso Loos**

Signature

Delasso Loos

- * Should waivers from all offset operators not accompany an application for administrative approval, the New Mexico Oil Conservation Commission will hold the application for a period of twenty (20) days from date of receipt by the Commission's Santa Fe office. If, after said twenty-day period, no protest nor request for hearing is received by the Santa Fe office, the application will then be processed.
- NOTE: If the proposed dual completion will result in an unorthodox well location and/or a non-standard proration unit in either or both of the producing zones, then separate application for approval of the same should be filed simultaneously with this application.

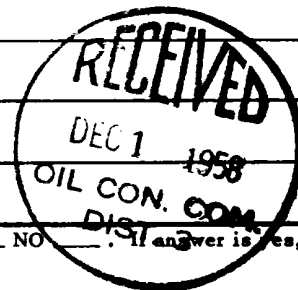

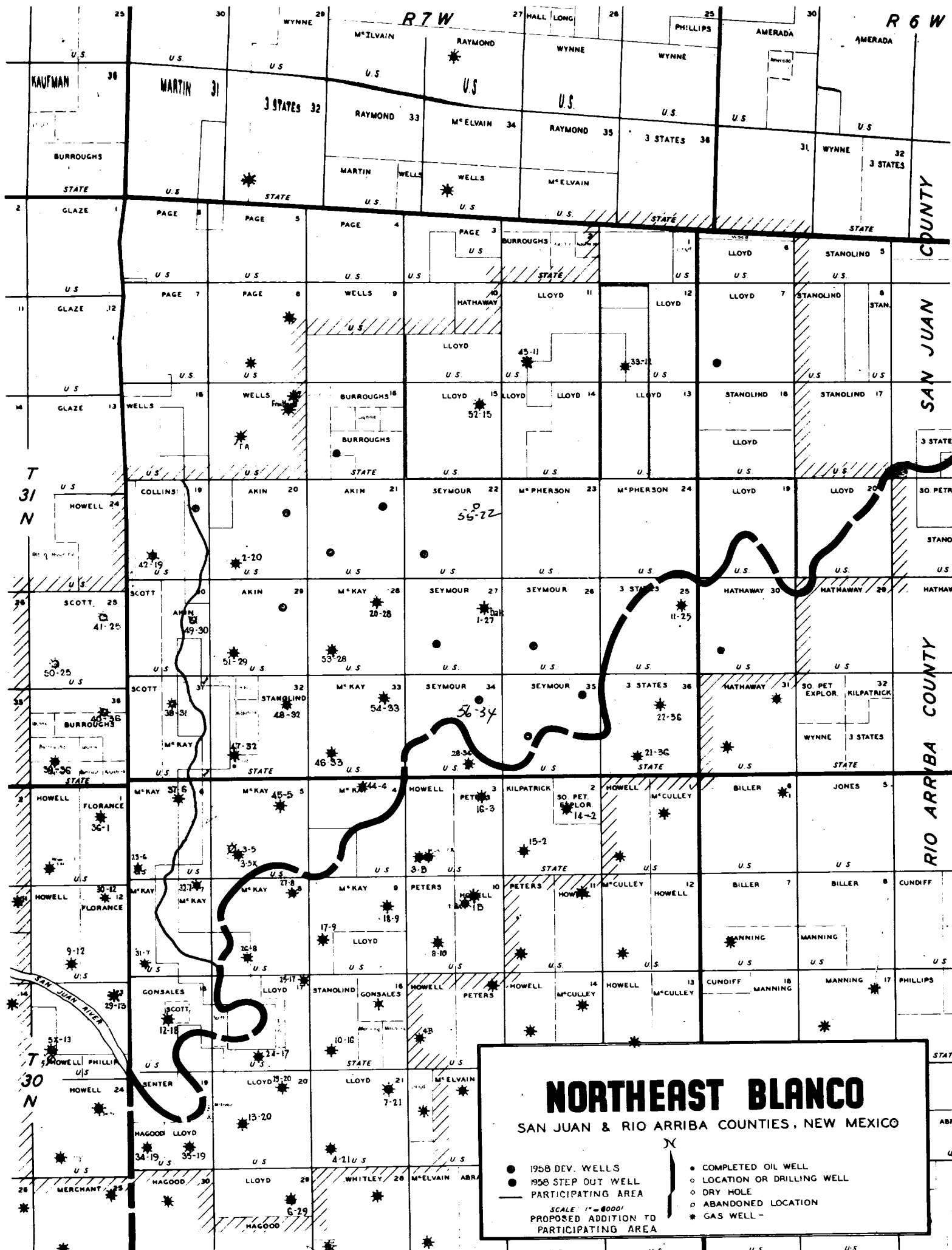

NORTHEAST BLANCO

SAN JUAN & RIO ARRIBA COUNTIES, NEW MEXICO

- 1958 DEV. WELLS
- 1958 STEP OUT WELL
- PARTICIPATING AREA

SCALE: 1" = 8000'
PROPOSED ADDITION TO
PARTICIPATING AREA

- COMPLETED OIL WELL
- LOCATION OR DRILLING WELL
- DRY HOLE
- ABANDONED LOCATION
- * GAS WELL -

SCHEMATIC DIAGRAM

BLACKWOOD & NICHOLS NEBU #56-34 DUAL COMPLETION (DAKOTA - MESAVERDE)

