

UNITED STATES
DEPARTMENT OF THE INTERIOR
GEOLOGICAL SURVEY

APPLICATION FOR PERMIT TO DRILL, DEEPEN, OR PLUG BACK

1a. TYPE OF WORK

DRILL ☒DEEPEN ☐PLUG BACK ☐

b. TYPE OF WELL

OIL
WELL ☒GAS
WELL ☐OTHER ☐SINGLE
ZONE ☒MULTIPLE
ZONE ☐

2. NAME OF OPERATOR

Thomas A. Dugan

3. ADDRESS OF OPERATOR

P.O. Box 234 Farmington, New Mexico

4. LOCATION OF WELL (Report location clearly and in accordance with any State requirements.)*

At surface

330' to 420' f=1 Sec 14 T30N R18W

At proposed prod. zone

Same As Above

14. DISTANCE IN MILES AND DIRECTION FROM NEAREST TOWN OR POST OFFICE*

2 Miles North of Shiprock N.M.

15. DISTANCE FROM PROPOSED*

LOCATION TO NEAREST

PROPERTY OR LEASE LINE, FT.

(Also to nearest drlg. line, if any)

330'

16. NO. OF ACRES IN LEASE

640

18. DISTANCE FROM PROPOSED LOCATION*
TO NEAREST WELL, DRILLING, COMPLETED,
OR APPLIED FOR, ON THIS LEASE, FT.

210'

19. PROPOSED DEPTH

1000'

21. ELEVATIONS (Show whether DF, RT, GR, etc.)

4961 GR

23.

PROPOSED CASING AND CEMENTING PROGRAM

SIZE OF HOLE	SIZE OF CASING	WEIGHT PER FOOT	SETTING DEPTH	QUANTITY OF CEMENT
9 3/4"	7"	20#	30'	5' 5x

Propose Drill a 9 3/4" hole to approx. 30' and run one joint 7" surface csg. cemented to the surface. A 6 1/2" hole will then be drilled to test the Del Norte Formation at approximately 1000'. If commercial oil production is indicated 4 1/2" csg. will be run and cemented, the well perforated and 4 1/2" run.

IN ABOVE SPACE DESCRIBE PROPOSED PROGRAM: If proposal is to deepen or plug back, give data on present productive zone and proposed new productive zone. If proposal is to drill or deepen directionally, give pertinent data on subsurface locations and measured and true vertical depths. Give blowout preventer program, if any.

24.

SIGNED

(This space for Federal or State office use)

TITLE

APPROVAL DATE

APPROVED BY

CONDITIONS OF APPROVAL, IF ANY:

TITLE

*See Instructions On Reverse Side

5. LEASE DESIGNATION AND SERIAL NO.

14-20-0603-8492

6. IF INDIAN, ALLOTTEE OR TRIBE NAME

Navajo

7. UNIT AGREEMENT NAME

8. FARM OR LEASE NAME

Shiprock

9. WELL NO.

2

10. FIELD AND POOL, OR WILDCAT

Wildcat

11. SEC., T., R., M., OR BLK.
AND SURVEY OR AREA

14-30N-18W

N.M.P.M.

12. COUNTY OR PARISH

San Juan

13. STATE

New Mexico

17. NO. OF ACRES ASSIGNED
TO THIS WELL

40 Acres

20. ROTARY OR CABLE TOOLS

Rotary

22. APPROX. DATE WORK WILL START*

9-1-66

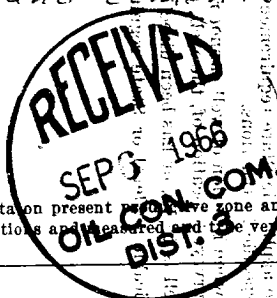

RECEIVED

SEP 3 1966

U. S. GEOLOGICAL SURVEY
FARMINGTON, N. M.

NEW MEXICO OIL CONSERVATION COMMISSION
WELL LOCATION AND ACREAGE DEDICATION PLAT

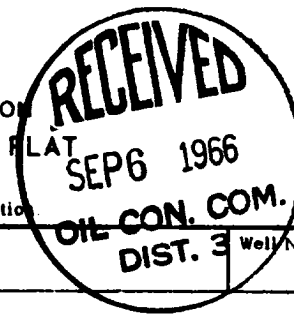

Form C-102
Supersedes C-128
Effective 1-1-65

All distances must be from the outer boundaries of the Section

Operator Thomas A. Dugan			Lease Shiprock		Well No. 2
Unit Letter A	Section 14	Township 30 North	Range 18 West	County San Juan	
Actual Footage Location of Well: 330 feet from the North line and 420 feet from the East line					
Ground Level Elev. 4961	Producing Formation Dakota		Pool Wildcat		Dedicated Acreage: 40 Acres

1. Outline the acreage dedicated to the subject well by colored pencil or hatchure marks on the plat below.
2. If more than one lease is dedicated to the well, outline each and identify the ownership thereof (both as to working interest and royalty).
3. If more than one lease of different ownership is dedicated to the well, have the interests of all owners been consolidated by communitization, unitization, force-pooling, etc?

☐ Yes ☐ No If answer is "yes," type of consolidation _____

If answer is "no," list the owners and tract descriptions which have actually been consolidated. (Use reverse side of this form if necessary.) _____

No allowable will be assigned to the well until all interests have been consolidated (by communitization, unitization, forced-pooling, or otherwise) or until a non-standard unit, eliminating such interests, has been approved by the Commission.

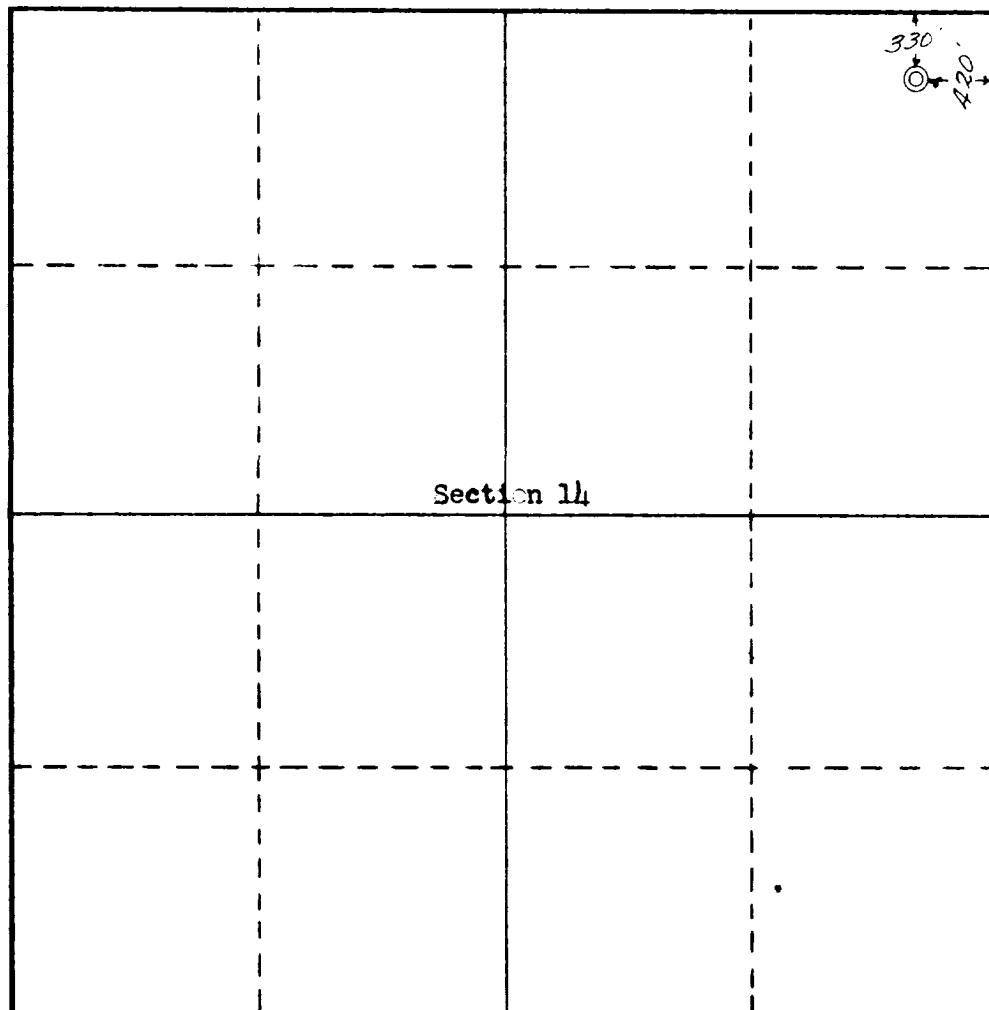

CERTIFICATION

I hereby certify that the information contained herein is true and complete to the best of my knowledge and belief.

Name
Original signed by T. A. Dugan

Position
Operator

Company

Date
9-1-66

I hereby certify that the well location shown on this plat was plotted from field notes of actual surveys made by me or under my supervision, and that the same is true and correct to the best of my knowledge and belief.

Date Surveyed
Aug. 29, 1966
J. D. Votaw
Registered Professional Engineer
and/or Land Surveyor

Certificate No.
3084

