

NO. OF COPIES RECEIVED	
DISTRIBUTION	
SANTA FE	
FILE	
U.S.G.S.	
LAND OFFICE	
OPERATOR	

# NEW MEXICO OIL CONSERVATION COMMISSION

Form C-101  
Revised 1-1-65

5A. Indicate Type of Lease	
STATE <input type="checkbox"/>	FEE <input checked="" type="checkbox"/>
5. State Oil & Gas Lease No.	

## APPLICATION FOR PERMIT TO DRILL, DEEPEN, OR PLUG BACK

1a. Type of Work		7. Unit Agreement Name	
b. Type of Well DRILL <input checked="" type="checkbox"/> DEEPEN <input type="checkbox"/> PLUG BACK <input type="checkbox"/> OIL WELL <input type="checkbox"/> GAS WELL <input checked="" type="checkbox"/> OTHER <input type="checkbox"/> SINGLE ZONE <input type="checkbox"/> MULTIPLE ZONE <input type="checkbox"/>		8. Farm or Lease Name	
2. Name of Operator		9. Well No.	
PAN AMERICAN PETROLEUM CORPORATION		Quine Gas Unit	
3. Address of Operator		10. Field and Pool, or Wildcat	
P. O. Box 480, Farmington, New Mexico		Basin Dakota	
4. Location of Well UNIT LETTER <u>I</u> LOCATED <u>1700</u> FEET FROM THE <u>south</u> LINE AND <u>1130</u> FEET FROM THE <u>east</u> LINE OF SEC. <u>31</u> TWP. <u>30N</u> RGE. <u>12W</u> NMPM		12. County	
		San Juan	
21. Elevations (Show whether DF, RT, etc.)		19. Proposed Depth	19A. Formation
Will report later.		6200	Dakota
21A. Kind & Status Plug. Bond	21B. Drilling Contractor	20. Rotary or C.T.	
Statewide	Man Drilling Company	Rotary	
22. Approx. Date Work will start		March 15, 1965	

### PROPOSED CASING AND CEMENT PROGRAM

SIZE OF HOLE	SIZE OF CASING	WEIGHT PER FOOT	SETTING DEPTH	SACKS OF CEMENT	EST. TOP
12-1/4"	8-5/8"	24#	500	350	Surface
7-7/8"	4-1/2"	10.5#	6200	1500*	Surface

\* Stage Collar set 100' below Mesaverde.

Copies of location plat are attached.

Copies of any logs run will be furnished upon completion of well.



IN ABOVE SPACE DESCRIBE PROPOSED PROGRAM: IF PROPOSAL IS TO DEEPEN OR PLUG BACK, GIVE DATA ON PRESENT PRODUCTIVE ZONE AND PROPOSED NEW PRODUCTIVE ZONE. GIVE BLOWOUT PREVENTER PROGRAM, IF ANY.

I hereby certify that the information above is true and complete to the best of my knowledge and belief.

Signed F. H. HOLLINGSWORTH ORIGINAL SIGNED BY Fred L. Nabors, District Engineer Title \_\_\_\_\_ Date March 10, 1965

(This space for State Use)

APPROVED BY \_\_\_\_\_ TITLE \_\_\_\_\_ DATE \_\_\_\_\_  
CONDITIONS OF APPROVAL, IF ANY:

## NEW MEXICO OIL CONSERVATION COMMISSION

Well Location and Acreage Dedication Plat

Section A.

Date **MARCH 10, 1965**

Operator PAN AMERICAN PETROLEUM CORPORATION Lease QUINE GAS UNIT  
 Well No. 1 Unit Letter I Section 31 Township 30 NORTH Range 12 WEST NMPM  
 Located 1700 Feet From SOUTH Line, 1130 Feet From EAST Line  
 County SAN JUAN G. L. Elevation REPORT LATER Dedicated Acreage 317.38 Acres  
 Name of Producing Formation DAKOTA Pool BASIN DAKOTA

1. Is the Operator the only owner in the dedicated acreage outlined on the plat below?

Yes        No X2. If the answer to question one is "no", have the interests of all the owners been consolidated by communitization agreement or otherwise? Yes X No       . If answer is "yes", Type of Consolidation **Communitization**  
**Agreements being prepared; force pooled by NMOC Order No. R-2859.**

3. If the answer to question two is "no", list all the owners and their respective interests below.

OwnerLand Description

Section B.

This is to certify that the information  
 in Section A above is true and complete  
 to the best of my knowledge and belief.

PAN AMERICAN PETROLEUM CORP.F. H. Hollingsworth (Operator)F. H. Hollingsworth  
 (Representative)P. O. Box 480  
 (Address)Farmington, New Mexico

Note: All distances must be from outer boundaries of Section.

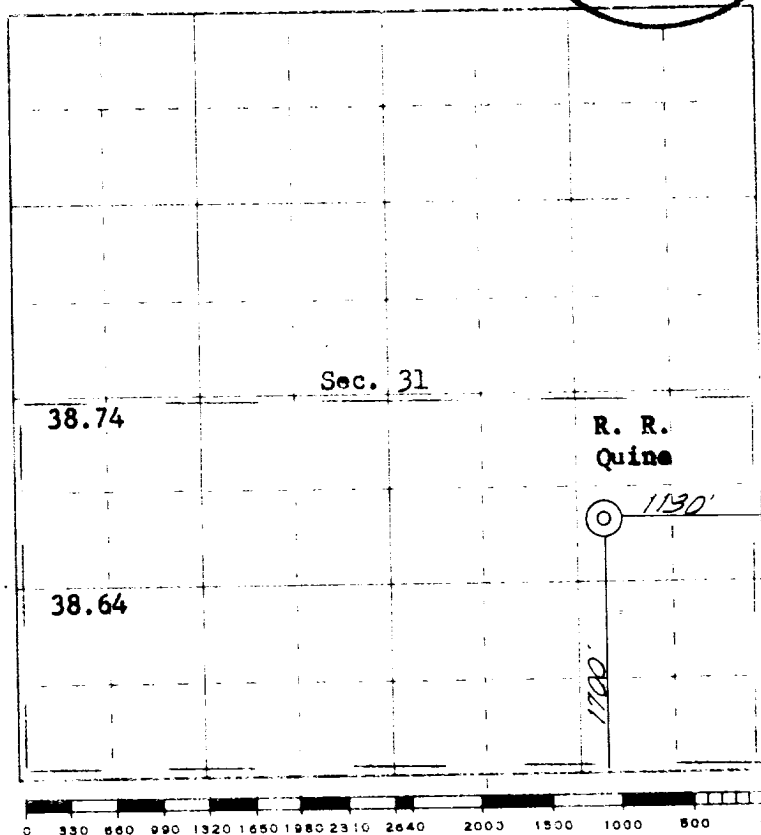

Ref: GLO plat dated 7 April 1881

Scale 4 inches equal 1 mile

This is to certify that the above plat was prepared from field notes of actual surveys  
 made by me or under my supervision and that the same are true and correct to the best  
 of my knowledge and belief.

Date Surveyed November 5, 1964

James P. Leese  
 Registered Professional Engineer and/or Land Surveyor