

NO. OF COPIES RECEIVED	5
DISTRIBUTION	
SANTA FE	1
FILE	1
U.S.G.S.	2
LAND OFFICE	
OPERATOR	1



Form C-101  
Revised 1-1-65 30-045-20073

5A. Indicate Type of Lease  
STATE ☐ FEE ☒

5. State Oil & Gas Lease No.

# APPLICATION FOR PERMIT TO DRILL, DEEPEN, OR PLUG BACK

1a. Type of Work DRILL <input checked="" type="checkbox"/> DEEPEN <input type="checkbox"/> PLUG BACK <input type="checkbox"/>		7. Unit Agreement Name
b. Type of Well OIL WELL <input type="checkbox"/> GAS WELL <input checked="" type="checkbox"/> OTHER <input type="checkbox"/> SINGLE ZONE <input checked="" type="checkbox"/> MULTIPLE ZONE <input type="checkbox"/>		8. Farm or Lease Name Flora Vista
2. Name of Operator El John Petroleum Corporation <i>PIONEER PRODUCTION CORP</i>		9. Well No. 1
3. Address of Operator Box 234, Farmington, New Mexico		10. Field and Pool, or Wildcat Basin Dakota
4. Location of Well UNIT LETTER <u>F</u> LOCATED <u>2500'</u> FEET FROM THE <u>North</u> LINE AND <u>1720'</u> FEET FROM THE <u>West</u> LINE OF SEC. <u>22</u> TWP. <u>30N</u> RGE. <u>12W</u> NMPM		12. County San Juan
19. Proposed Depth 6525		19A. Formation Dakota
20. Rotary or C.T. Rotary		
21. Elevations (Show whether DE, RT, etc.) 5534 gd.	21A. Kind & Status Plug. Bond Single Well	22. Approx. Date Work will start 5-18-67

23.

## PROPOSED CASING AND CEMENT PROGRAM

SIZE OF HOLE	SIZE OF CASING	WEIGHT PER FOOT	SETTING DEPTH	SACKS OF CEMENT	EST. TOP
12"	8 5/8	24.00	270	175	Surface
7 7/8"	4 1/2	10.5	6525	1000	600'

## Proposed Plans

1. Drill 12" hole to 270' and set 8 5/8" casing cemented to surface.
2. Drill 7 7/8" hole to 6525 with minimum mud to test Dakota formation.
3. Run 4 1/2" casing to T.D. - Cement first stage W/200 sx.  
Set two stage tool at 4450 and cement with 800 cu. ft. of cement to cover Mesa Verde, Pictured Cliffs and Fruitland formation.
4. Selective Perf. & frac Dakota formation.
5. Run tubing and complete well.

APPROVAL VALID  
FOR 90 DAYS UNLESS  
DRILLING COMMENCED,

EXPIRES August 16, 1967

IN ABOVE SPACE DESCRIBE PROPOSED PROGRAM: IF PROPOSAL IS TO DEEPEN OR PLUG BACK, GIVE DATA ON PRESENT PRODUCTIVE ZONE AND PROPOSED NEW PRODUCTIVE ZONE. GIVE BLOWOUT PREVENTER PROGRAM, IF ANY.

I hereby certify that the information above is true and complete to the best of my knowledge and belief.

Signed J. A. Hughes Title Engineer Date May 17, 1967

(This space for State Use)

APPROVED BY Emory C. Curren TITLE Sup Dist Mgr DATE 6-18-67

CONDITIONS OF APPROVAL, IF ANY:

**NEW MEXICO OIL CONSERVATION COMMISSION  
WELL LOCATION AND ACREAGE DEDICATION PLAT**

Form C-102  
Supersedes C-128  
Effective 1-1-65

All distances must be from the outer boundaries of the Section.

Operator <del>Eljohn</del> <b>PIONEER PRODUCTION CORP.</b>		Lease <b>Flora Vista</b>		Well No. <b>1</b>
Unit Letter <b>F</b>	Section <b>22</b>	Township <b>30 North</b>	Range <b>12 West</b>	County <b>San Juan</b>
Actual Footage Location of Well: <b>2500</b> feet from the <b>North</b> line and <b>1720</b> feet from the <b>West</b> line				
Ground Level Elev. <b>5534</b>	Producing Formation <b>Dakota</b>	Pool <b>Basin</b>	Dedicated Acreage: <b>320</b> Acres	

1. Outline the acreage dedicated to the subject well by colored pencil or hachure marks on the plat below.
2. If more than one lease is dedicated to the well, outline each and identify the ownership thereof (both as to working interest and royalty).
3. If more than one lease of different ownership is dedicated to the well, have the interests of all owners been consolidated by communitization, unitization, force-pooling, etc?

☐ Yes ☐ No If answer is "yes," type of consolidation \_\_\_\_\_

If answer is "no," list the owners and tract descriptions which have actually been consolidated. (Use reverse side of this form if necessary.) \_\_\_\_\_

No allowable will be assigned to the well until all interests have been consolidated (by communitization, unitization, forced-pooling, or otherwise) or until a non-standard unit, eliminating such interests, has been approved by the Commission.

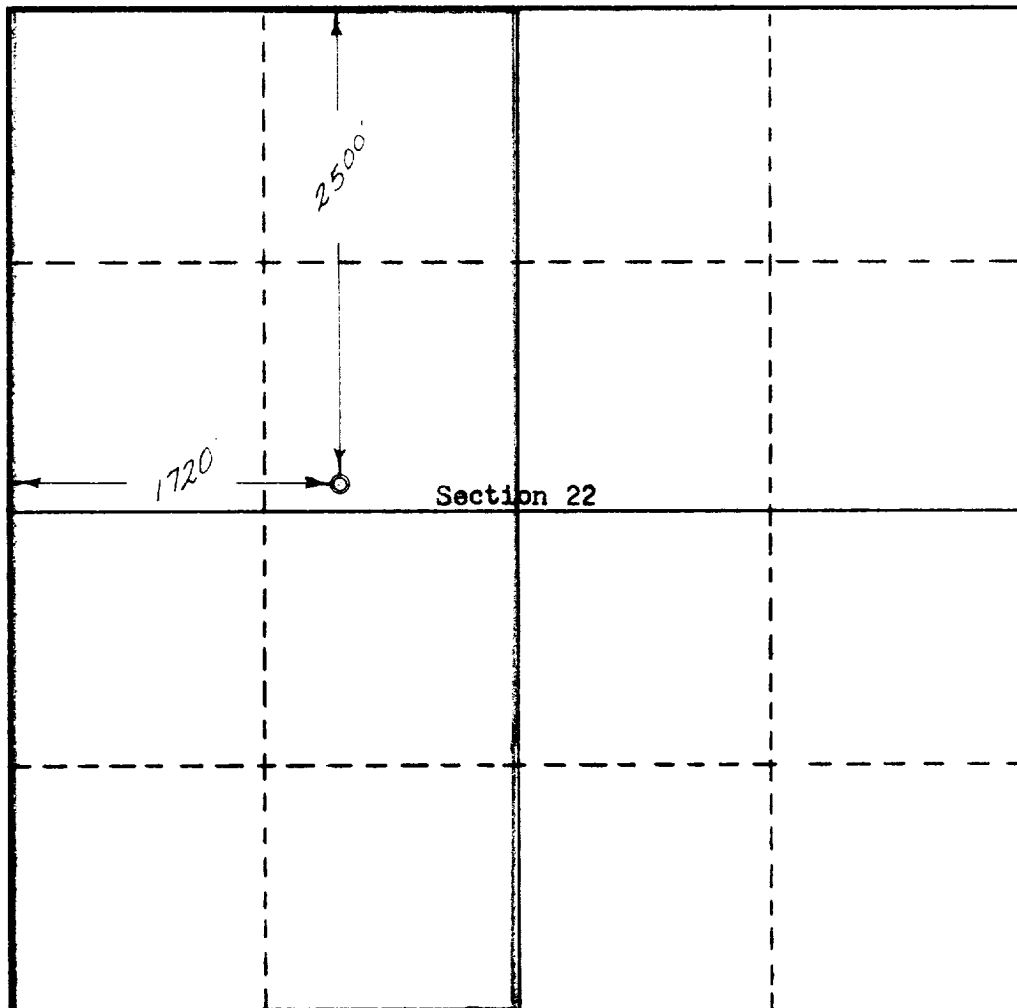
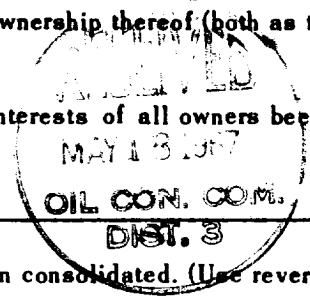

**CERTIFICATION**

I hereby certify that the information contained herein is true and complete to the best of my knowledge and belief.

Name \_\_\_\_\_  
**Thomas A. Dugan**  
 Position \_\_\_\_\_  
**Engineer**  
 Company \_\_\_\_\_  
**Eljohn Petroleum Corp.**  
 Date \_\_\_\_\_  
**5-17-67**

I hereby certify that the well location shown on this plat was plotted from field notes of actual surveys made by me or under my supervision, and that the same is true and correct to the best of my knowledge and belief.

Date Surveyed \_\_\_\_\_  
**May 13, 1967**  
 Registered Professional Engineer and/or Land Surveyor \_\_\_\_\_  
*C. J. Poter*  
 Certificate No. \_\_\_\_\_  
**3084**

