

BIRMINGHAM OFFICE COPY  
UNITED STATES  
DEPARTMENT OF THE INTERIOR  
GEOLOGICAL SURVEYSUBMIT IN TRIPLICATE\*  
Other instructions on  
reverse sideForm approved.  
Budget Bureau No. 42-R1425.

APPLICATION FOR PERMIT TO DRILL, DEEPEN, OR PLUG BACK			
1a. TYPE OF WORK DRILL <input checked="" type="checkbox"/> DEEPEN <input type="checkbox"/> PLUG BACK <input type="checkbox"/>		5. LEASE DESIGNATION AND SERIAL NO. 14-20-0603-742	
b. TYPE OF WELL OIL WELL <input checked="" type="checkbox"/> GAS WELL <input type="checkbox"/> OTHER <input type="checkbox"/>		6. IF INDIAN, ALLOTTEE OR TRIBE NAME Navajo Tribal Land	
2. NAME OF OPERATOR RiJan Oil Company, Inc.		7. UNIT AGREEMENT NAME None	
3. ADDRESS OF OPERATOR 341 Korber Building, Albuquerque, New Mexico		8. FARM OR LEASE NAME RiJan Oil Company, Inc.	
4. LOCATION OF WELL (Report location clearly and in accordance with any State requirements.)* At surface 330' fsl, 170' fwl, Sec. 31, T 30 N, R 16 W At proposed prod. zone 330' fsl, 170' fwl, Sec. 31, T 30 N, R 16 W		9. WELL NO. 1 RiJan	
14. DISTANCE IN MILES AND DIRECTION FROM NEAREST TOWN OR POST OFFICE* 7 miles east of Shiprock, New Mexico		10. FIELD AND POOL, OR WILDCAT Slack rock Pool	
15. DISTANCE FROM PROPOSED* LOCATION TO NEAREST PROPERTY OR LEASE LINE, FT. (Also to nearest drlg. unit line, if any) 170'		11. SEC., T., R., M., OR BLK. AND SURVEY OR AREA Sec. 31, T 30 N, R 16 W	
16. NO. OF ACRES IN LEASE 639.455		12. COUNTY OR PARISH San Juan	
17. NO. OF ACRES ASSIGNED TO THIS WELL 40		13. STATE New Mexico	
18. DISTANCE FROM PROPOSED LOCATION* TO NEAREST WELL, DRILLING, COMPLETED, OR APPLIED FOR, ON THIS LEASE, FT. None		20. ROTARY OR CABLE TOOLS Rotary	
21. ELEVATIONS (Show whether DF, RT, GR, etc.) 5047' Gr.		22. APPROX. DATE WORK WILL START* August 20, 1967	
23. PROPOSED CASING AND CEMENTING PROGRAM			
SIZE OF HOLE 10 3/4" 6 1/2"	SIZE OF CASING 7" 4.5"	WEIGHT PER FOOT 17 lbs. 9.5 lbs.	SETTING DEPTH 30' 745'
QUANTITY OF CEMENT 20 sx Circulated to surface 30 sx Regular			

Plan to set surface casing through surface gravels and then drill with mud to about 745', then log well and set 4.5 inch casing cemented. Will then core into top of Dakota Formation with air. Plan to complete well natural in the top of the Dakota Formation.

RECEIVED

AUG 17 1967

U. S. GEOLOGICAL SURVEY  
BIRMINGHAM OFFICE

IN ABOVE SPACE DESCRIBE PROPOSED PROGRAM: If proposal is to deepen or plug back, give data on present productive zone and proposed new productive zone. If proposal is to drill or deepen directionally, give pertinent data on subsurface locations and measured and true vertical depths. Give blowout preventer program, if any.

24. SIGNED [Signature] TITLE Vice President DATE August 14, 1967  
(This space for Federal or State office use)

PERMIT NO. \_\_\_\_\_

APPROVAL DATE \_\_\_\_\_

APPROVED BY [Signature]  
CONDITIONS OF APPROVAL, IF ANY: \_\_\_\_\_

TITLE \_\_\_\_\_

DATE \_\_\_\_\_

JUN 30 1967

\*See Instructions On Reverse Side

# NEW MEXICO OIL CONSERVATION COMMISSION

## WELL LOCATION AND ACERAGE DEDICATION PLAT

All distances must be from the outer boundaries of the Section

Operator Rijon Oil Company Lease 14-20-0603-742 Well No. 1 RI Jan  
 Unit Letter A Section 31 Township 30 North Range 16 West County San Juan  
 Actual Footage Location of Well 330 feet from the South end of 170 feet from the West end  
 Ground Level Elev. 5047 Producing Formation Dakota Pool Slick rock Estimated Average 40 Acres

1. Outline the acreage dedicated to the subject well by colored pencil or hatchure marks on the plat below \_\_\_\_\_
2. If more than one lease is dedicated to the well, outline each and identify the ownership thereof (both as to working interest and royalty). **One lease only,**
3. If more than one lease of different ownership is dedicated to the well, have the interests of all owners been consolidated by communitization, unitization, force-pooling, etc?  
 Yes ☐ No ☒ If answer is "yes," type of consolidation \_\_\_\_\_

If answer is "no," list the owners and tract descriptions which have actually consolidated. (Use reverse side of this form if necessary) **One lease only. Owned by Rijon Oil Co., Inc.**

No allowable will be assigned to the well until all interests have been consolidated (by communitization, unitization, forced-pooling, or otherwise) or until a non standard unit, eliminating such interests, has been approved by the Commission.

**Lease 14-20-0603-742**

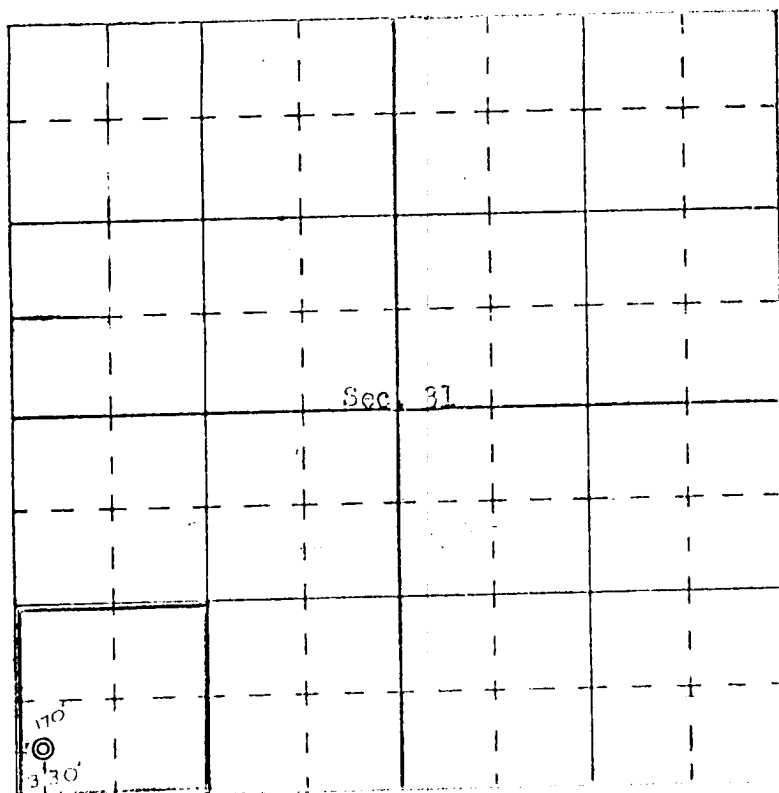

N

### CERTIFICATION

I hereby certify that the information contained herein is true and complete to the best of my knowledge and belief.

*Val R. Reese*  
 Name Val R. Reese  
 Position Vice President

Rijon Oil Company, Inc.  
 Company

August 14, 1967  
 Date

I hereby certify that the well location shown on this plat was plotted from field notes of actual surveys made by me or under my supervision, and that the same is true and correct to the best of my knowledge and belief.

*E. J. Cochran*  
 Date Entered July 18, 1967  
 Registered for mineral, timber, and/or land use

*E. J. Cochran*  
 Certificate No. 3602