



BRUCE KING
GOVERNOR

LARRY KEHOE
SECRETARY

STATE OF NEW MEXICO
ENERGY AND MINERALS DEPARTMENT
OIL CONSERVATION DIVISION

February 10, 1982

POST OFFICE BOX 2088
STATE LAND OFFICE BUILDING
SANTA FE, NEW MEXICO 87501
(505) 827-2434

Amoco Production Company (USA)
Petroleum Building
501 Airport Drive
Farmington, New Mexico 87401

Attention: R. W. Schroeder

Administrative Order NSL-1480

Gentlemen:

Reference is made to your application for a non-standard location for your L. M. Barton Well No. 1E to be located 1900 feet from the South line and 480 feet from the West line, Section 12, Township 30 North, Range 12 West, San Juan County, New Mexico.

By authority granted me under the provisions of Rule 3 of Order No. R-1670 and Rule 104F of the Division Rules and Regulations, the above-described unorthodox location is hereby approved.

Sincerely,

A handwritten signature in dark ink, appearing to read "Joe D. Ramey", written over a circular stamp that is partially obscured by the signature.

JOE D. RAMEY
Director

JDR/RLS/og

cc: Oil Conservation Division - Aztec
U. S. Minerals Management Service - Farmington





ENERGY AND MINERALS DEPARTMENT

OIL CONSERVATION DIVISION
AZTEC DISTRICT OFFICE

2-14-82

4.7

1000 RIO BRAZOS ROAD
AZTEC, NEW MEXICO 87410
(505) 334-6178

OIL CONSERVATION DIVISION
BOX 2088
SANTA FE, NEW MEXICO 87501

DATE 1-29-82

Still pending 8-20-82

RE: Proposed MC _____
Proposed DHC _____
Proposed NSL ✓ _____
Proposed SWD _____
Proposed WFX _____
Proposed PMX _____

NSL 1490

Gentlemen:

I have examined the application dated 1-21-82
for the Amoco Prod. Co. L.M. Barton #1E L-12-30N-12W
Operator Lease and Well No. Unit, S-T-R

and my recommendations are as follows:

Approve
11

Yours truly,

John A. Edmister



Amoco Production Company (USA)

Petroleum Center Building
501 Airport Drive
Farmington, New Mexico 87401
505-325-8841

R. W. Schroeder
District Superintendent

January 20, 1982

Mr. Joe D. Ramey
New Mexico Oil Conservation Division
P. O. Box 2088
Santa Fe, NM 87501

File: RWS-73-986.510

Dear Mr. Ramey:

Application for Unorthodox Location
L. M. Barton No. 1E
Basin Dakota/Aztec Pictured Cliffs Fields
San Juan County, New Mexico

Amoco Production Company hereby requests approval of our L. M. Barton Well No. 1E at a location 1900' FSL and 480' FWL, Section 12, T30N, R12W, San Juan County, New Mexico.

The attached Form C-102 illustrates the topographical problems encountered in selecting a suitable well site.

A copy of this application is being sent to offset lease holders and offset operators by Certified Mail with the request they furnish you a waiver of objection and return one copy of the same to me.

Yours very truly,

R. W. Schroeder

DDM/eb
Attachments

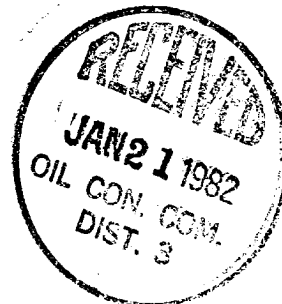

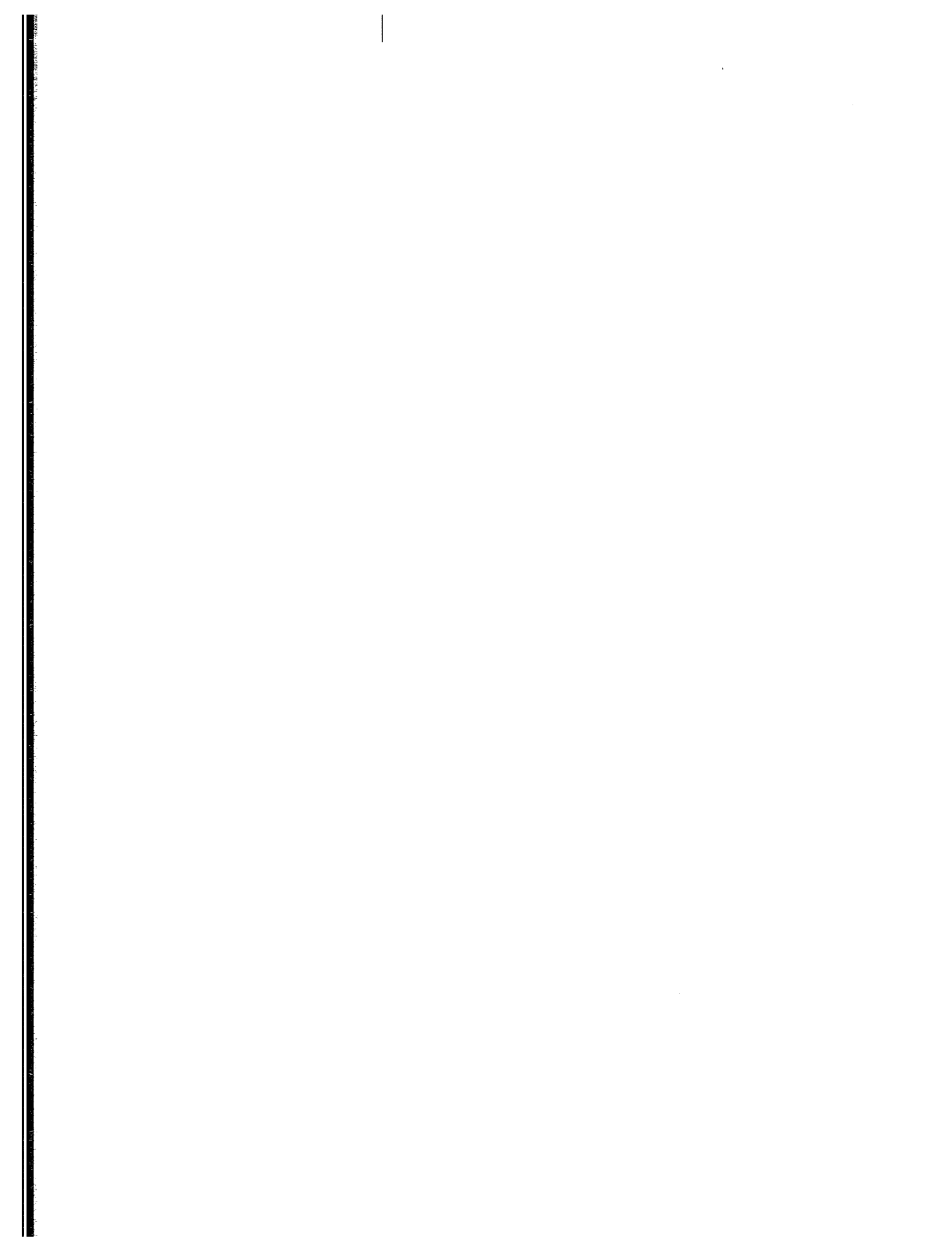

Page 2
January 20, 1982
File: RWS-73-986.510
Mr. Joe D. Ramey

cc: Mr. Frank Chavez ✓
New Mexico Oil Conservation Division
1000 Rio Brazos Road
Aztec, NM 87410

Texaco Inc.
P. O. Box 2100
Denver, CO 80201

Beta Development Corporation
P. O. Box 1659
Midland, TX 79702

Getty Oil Company
Three Park Central, Suite 700
1515 Arapahoe St.
Denver, CO 80202

Consolidated Oil & Gas Company
P. O. Box 2038
Farmington, NM 87401

C & E Operators, Inc.
1 Energy Square, Suite 170
Dallas, TX 75206

Manana Gas Inc.
P. O. Box 145
Farmington, NM 87401

Tenneco Inc.
P. O. Box 3249
Englewood, CO 80155

W. P. Carr
4849 Greenville Ave
2 Energy Square, Suite 200
Dallas, TX 75206



2025-01-01 10:00:00

1

WAIVER OF OBJECTION AND CONSENT TO
THE UNORTHODOX LOCATION APPLICATION
FOR AMOCO PRODUCTION COMPANY'S L. M. BARTON NO. 1E

THE UNDERSIGNED, as an Offset Operator/Lease Holder of a lease
offsetting

Amoco Production Co. L. M. Barton No. 1E
located 1900' FSL & 480' FWL, Sec. 12, T30N, R12W,
San Juan County, New Mexico,

does hereby acknowledge receipt of letter requesting approval of
an unorthodox location of the above-captioned well.

THE UNDERSIGNED HEREBY WAIVES any objection to this Application
and voluntarily consents to the unorthodox location.

DATED this _____ day of _____, _____.

SIGNED:

Name _____
Title _____
Firm _____

Please send one executed copy to Joe D. Ramey, Division Director, New Mexico Oil Conservation Division, P. O. Box 2088, Santa Fe, NM 87501, and return one executed copy to Amoco Production Company, 501 Airport Drive, Farmington, NM 87401.



OIL CONSERVATION DIVISION

P. O. BOX 2088

SANTA FE, NEW MEXICO 87501

Form C-107
Revised 10-

All distances must be from the outer boundaries of the Section.

STATE OF NEW MEXICO
ENERGY AND MINERALS DEPARTMENT

Operator AMOCO PRODUCTION COMPANY		Lease L. M. BARTON		Well No. 1E
Unit Letter L	Section 12	Township 30N	Range 12W	County San Juan
Actual Footage Location of Well: 1900 feet from the South line and 480 feet from the West line				
Ground Level Elev. 5827	Producing Formation Dakota/Pictured Cliffs	Pool Aztec Basin Dakota/ Pictured Cliffs	Dedicated Acreage: 320/160 Acres	

1. Outline the acreage dedicated to the subject well by colored pencil or hachure marks on the plat below.

2. If more than one lease is dedicated to the well, outline each and identify the ownership thereof (both as to working interest and royalty).

3. If more than one lease of different ownership is dedicated to the well, have the interests of all owners been consolidated by communitization, unitization, force-pooling, etc?

☒ Yes ☐ No If answer is "yes," type of consolidation Communitization

If answer is "no," list the owners and tract descriptions which have actually been consolidated. (Use reverse side of this form if necessary.) _____

No allowable will be assigned to the well until all interests have been consolidated (by communitization, unitization, forced-pooling, or otherwise) or until a non-standard unit, eliminating such interests, has been approved by the Commission.

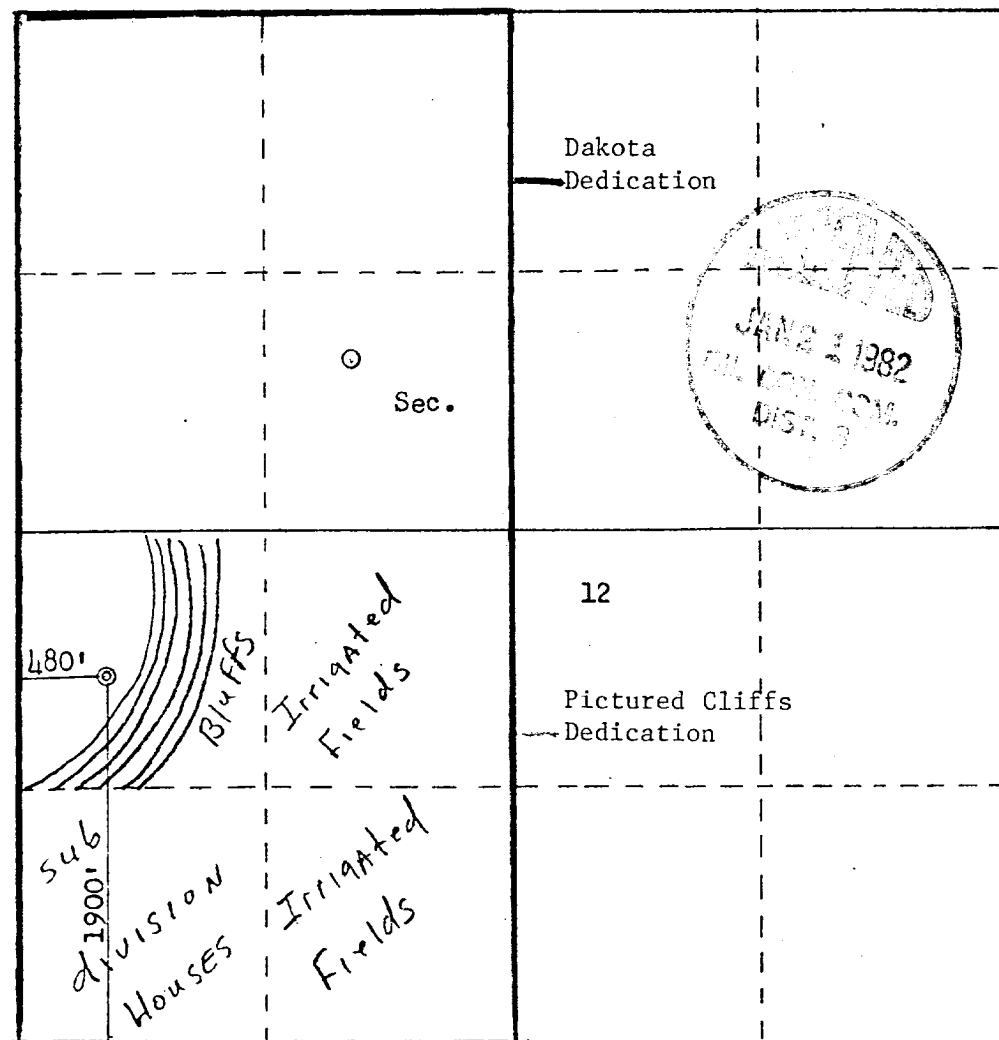

Scale: 1"=1000'

CERTIFICATION

I hereby certify that the information contained herein is true and complete to the best of my knowledge and belief.

W. L. Peterson
Name

W. L. PETERSON
Position

DISTRICT ENGINEER
Company

AMOCO PRODUCTION COMPANY
Date

NOV 24 1981

I hereby certify that the well location shown on this plat was plotted from field notes of actual surveys made by me or under my supervision, and that the same is true and correct to the best of my knowledge and belief.

Date Surveyed

March 4, 1981

Registered Professional Engineer and Land Surveyor

Fred B. Kerr
Certified No. 3850

3850

P12W.

P11W

[illegible]

T
30
N

