

NO. OF COPIES RECEIVED		
DISTRIBUTION		
SANTA FE		
FILE		
U.S.G.S.		
LAND OFFICE		
OPERATOR		

NEW MEXICO OIL CONSERVATION COMMISSION

30-045-25826  
Form C-101  
Revised 1-1-65

12 7 1983

OIL CONSERVATION COMMISSION

5A. Indicate Type of Lease  
STATE  FEE

5. State Oil & Gas Lease No.

APPLICATION FOR PERMIT TO DRILL, DEEPEN, OR PLUG BACK

1a. Type of Work DRILL <input checked="" type="checkbox"/> DEEPEN <input type="checkbox"/> PLUG BACK <input type="checkbox"/>		7. Unit Agreement Name	
b. Type of Well OIL WELL <input type="checkbox"/> GAS WELL <input checked="" type="checkbox"/> OTHER <input type="checkbox"/> SINGLE ZONE <input checked="" type="checkbox"/> MULTIPLE ZONE <input type="checkbox"/>		8. Farm or Lease Name Flora Vista	
2. Name of Operator Southland Royalty Company		9. Well No. 1E	
3. Address of Operator P.O. Drawer 570, Farmington, New Mexico 87499		10. Field and Pool, or Wildcat Basin Dakota	
4. Location of Well UNIT LETTER N LOCATED 920 FEET FROM THE South LINE AND 1520 FEET FROM THE West LINE OF SEC. 22 TWP. 30N RGE. 12W NMPM		12. County San Juan	
		19. Proposed Depth 6420'	19A. Formation Dakota
		20. Rotary or C.T. Rotary	
21. Elevations (Show whether DF, RT, etc.) 5500' GL	21A. Kind & Status Plug. Bond	21B. Drilling Contractor	22. Approx. Date Work will start November 21, 1983

PROPOSED CASING AND CEMENT PROGRAM

SIZE OF HOLE	SIZE OF CASING	WEIGHT PER FOOT	SETTING DEPTH	SACKS OF CEMENT	EST. TOP
12-1/4"	8-5/8"	24#, K-55	200'	165 cu.ft.	Circ to surface
7-7/8"	4-1/2"	10.5#, K-55	6420'	Stg 1-319cu.ft	Cover Gallup
				Stg 2-703cu.ft	Cover Chacra
				Stg 3-540cu.ft.	Cover Ojo Alamo

Surface formation is Nacimiento.  
 Top of Ojo Alamo sand is at 313'.  
 Top of Pictured Cliffs sand is at 1674'.  
 Fresh water mud will be used to drill from surface to total depth.  
 It is anticipated that an IES and GR-Density logs will be run from total depth to surface casing.  
 No abnormal pressures or Poisonous gases are anticipated in this well.  
 It is expected that this well will be drilled before December 15, 1983.  
 This depends on time required for approvals, rig availability and the weather.  
 Gas is dedicated.

IN ABOVE SPACE DESCRIBE PROPOSED PROGRAM: IF PROPOSAL IS TO DEEPEN OR PLUG BACK, GIVE DATA ON PRESENT PRODUCTIVE ZONE AND PROPOSED NEW PRODUCTIVE ZONE. GIVE BLOWOUT PREVENTER PROGRAM, IF ANY.

I hereby certify that the information above is true and complete to the best of my knowledge and belief.  
 Signed [Signature] Title District Engineer Date October 25, 1983

(This space for State Use)

APPROVED BY [Signature] TITLE SUPERVISOR DATE OCT 27 1983

CONDITIONS OF APPROVAL, IF ANY:

OIL CONSERVATION DIVISION

STATE OF NEW MEXICO  
ENERGY AND MINERALS DEPARTMENT

P. O. BOX 2088

SANTA FE, NEW MEXICO 87501

Form C-107  
Revised 10-1-78

All distances must be from the outer boundaries of the Section.

Operator SOUTHLAND ROYALTY COMPANY			Lease FLORA VISTA		Well No. 1E
Unit Letter N	Section 22	Township 30N	Range 12W	County San Juan	
Actual Footage Location of Well: 920 feet from the South line and 1520 feet from the West line					
Ground Level Elev. 5500 GL	Producing Formation Dakota	Pool Basin Dakota		Dedicated Acreage: 320 Acres	

1. Outline the acreage dedicated to the subject well by colored pencil or hachure marks on the plat below.
2. If more than one lease is dedicated to the well, outline each and identify the ownership thereof (both as to working interest and royalty).
3. If more than one lease of different ownership is dedicated to the well, have the interests of all owners been consolidated by communitization, unitization, force-pooling, etc?

Yes  No If answer is "yes," type of consolidation \_\_\_\_\_

If answer is "no," list the owners and tract descriptions which have actually been consolidated. (Use reverse side of this form if necessary.) \_\_\_\_\_

No allowable will be assigned to the well until all interests have been consolidated (by communitization, unitization, forced-pooling, or otherwise) or until a non-standard unit, eliminating such interests, has been approved by the Commission.

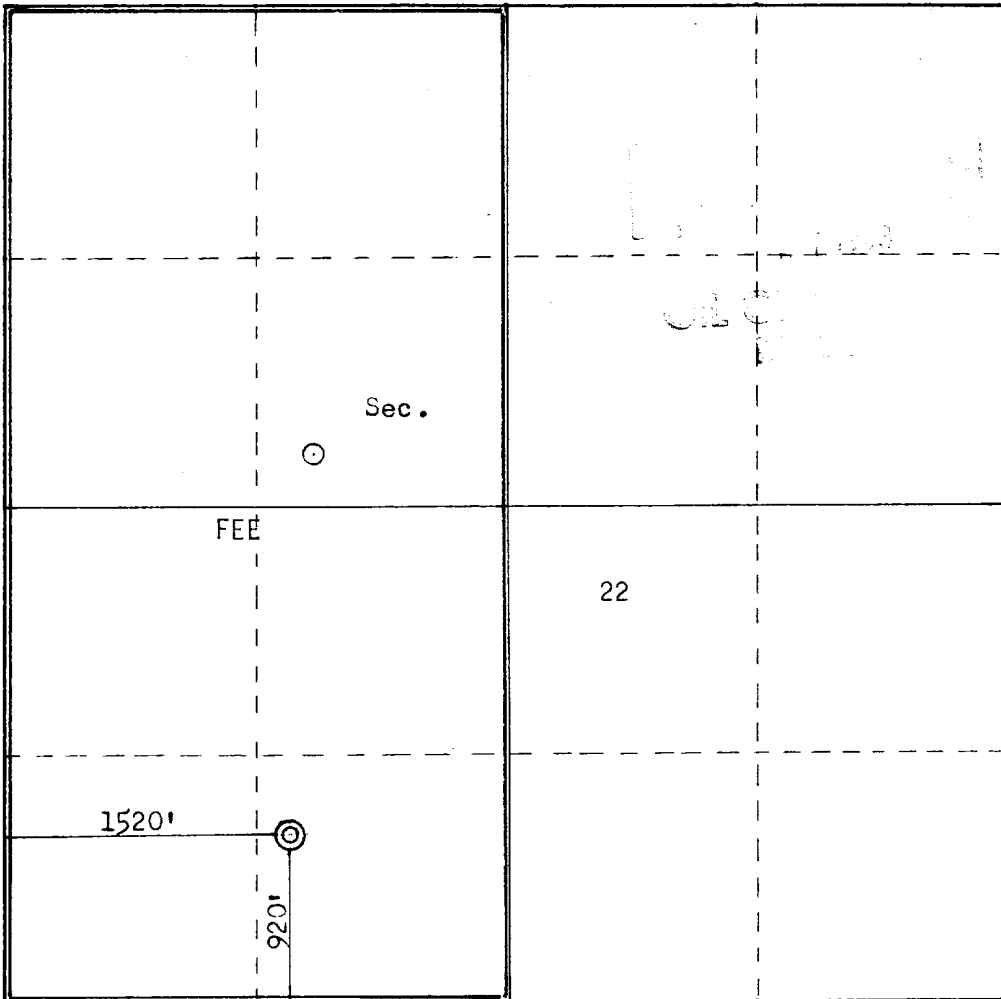

Scale: 1"=1000'

CERTIFICATION	
I hereby certify that the information contained herein is true and complete to the best of my knowledge and belief.	
<i>R. E. Fielder</i>	
Name	R. E. Fielder
Position	District Engineer
Company	Southland Royalty Company
Date	October 25, 1983
I hereby certify that the well location shown on this plat was plotted from field notes of actual surveys made by me or under my supervision, and that the same is true and correct to the best of my knowledge and belief.	
Date Surveyed	August 30, 1983
Registered Professional Engineer and Land Surveyor	<i>Fred B. Kerr Jr.</i> Fred B. Kerr Jr.
Certificate No.	3950

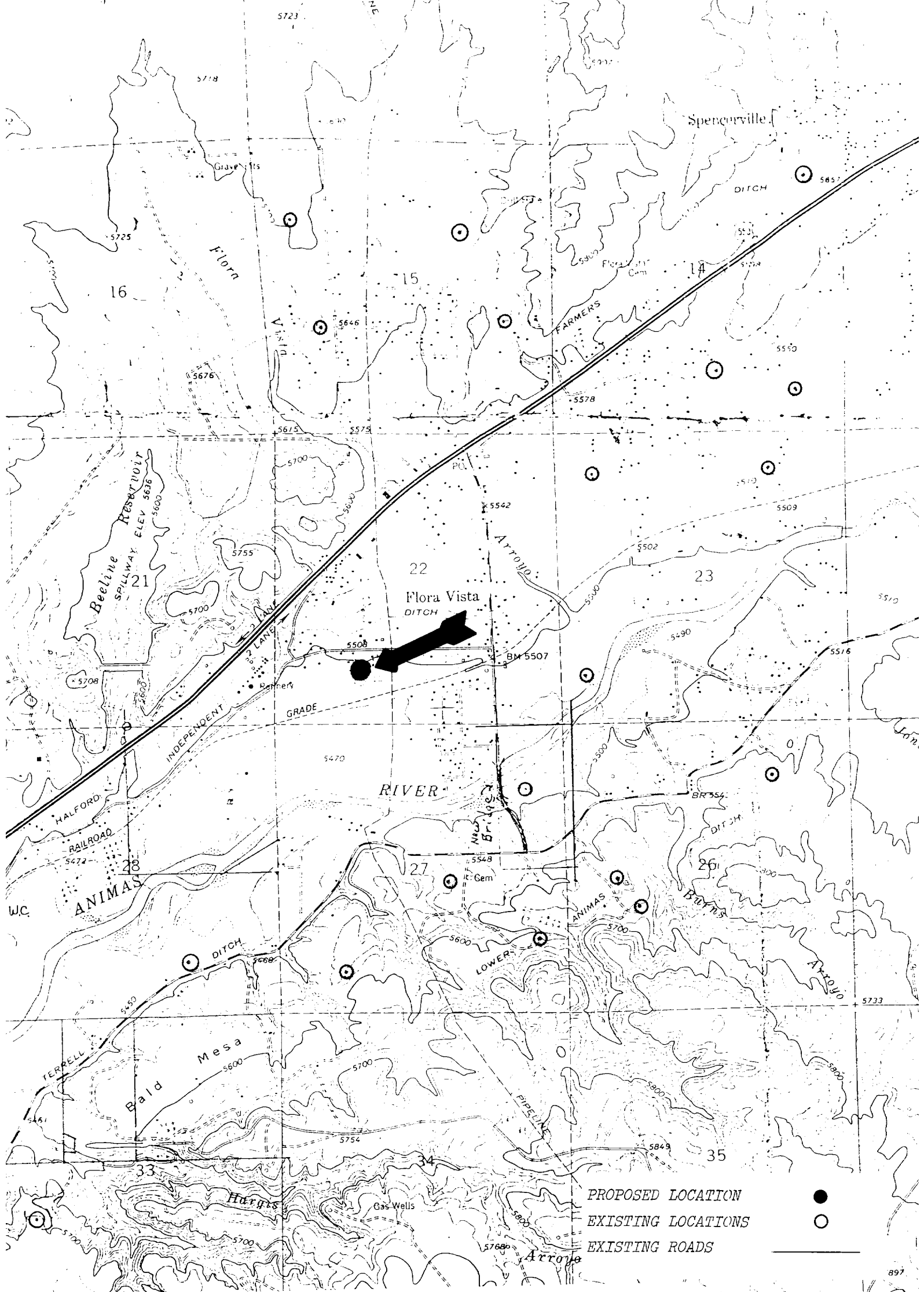

Vicinity Map for  
 SOUTHLAND ROYALTY COMPANY #1E FLORA VISTA  
 920'FSL 1520'FWL Sec. 22-T30N-R12W  
 SAN JUAN COUNTY, NEW MEXICO



**Southland Royalty Company**

October 25, 1983

Mr. Frank Chavez  
Oil Conservation Division  
1000 Rio Brazos Road  
Aztec, New Mexico 87410

RE: Blowout Preventer Plan

Dear Mr. Chavez:

All drilling and completion rigs will be equipped with 6" or larger double gate hydraulic blowout preventers and a hydraulic operated closing unit with steel lines.

The preventer is 3000# working pressure and 6000# test pressure. All crews will be thoroughly trained in the operation of this preventer. The preventer will be tested frequently enough to ensure proper operation.

Sincerely,

SOUTHLAND ROYALTY COMPANY

R. E. Fielder  
District Engineer

REF/eg

Attachment