

UNITED STATES  
DEPARTMENT OF THE INTERIOR  
GEOLOGICAL SURVEY

30-045-25913

APPLICATION FOR PERMIT TO DRILL, DEEPEN, OR PLUG BACK

1a. TYPE OF WORK  
 DRILL                       DEEPEN                       PLUG BACK   
 b. TYPE OF WELL  
 OIL WELL                       GAS WELL                       OTHER                       SINGLE ZONE                       MULTIPLE ZONE

2. NAME OF OPERATOR  
 Tenneco Oil Company

3. ADDRESS OF OPERATOR  
 P.O. Box 3249, Englewood, CO 80155

4. LOCATION OF WELL (Report location clearly and in accordance with any State requirements.)  
 At surface: 1640' FNL, 2215' FEL  
 At proposed prod. zone

14. DISTANCE IN MILES AND DIRECTION FROM NEAREST TOWN OR VILLAGE  
 10 mi NE of Aztec, NM

15. DISTANCE FROM PROPOSED\* LOCATION TO NEAREST PROPERTY OR LEASE LINE, FT. (Also to nearest drlg. unit line, if any)  
 1640'

18. DISTANCE FROM PROPOSED LOCATION\* TO NEAREST WELL, DRILLING, COMPLETED, OR APPLIED FOR, ON THIS LEASE, FT.  
 19. PROPOSED DEPTH: ± 7800'

21. ELEVATIONS (Show whether DF, RT, GR, etc.)  
 6262' GR

23. **"GENERAL REQUIREMENTS" CEMENTING PROGRAM**

SIZE OF HOLE	SIZE OF CASING	WEIGHT PER FOOT	SETTING DEPTH
12-1/4"	9-5/8"	36#	+ 300'
8-3/4"	7"	23#	+ 3685'
6-1/4"	4-1/2"	10.5#	+ 7000'
		11.6#	+ 7800'

5. LEASE DESIGNATION AND SERIAL NO.  
 SF-078336-B  
 6. IF INDIAN, ALLOTTEE OR TRIBE NAME  
 7. UNIT AGREEMENT NAME  
 8. FARM OR LEASE NAME  
 Barrett A  
 9. WELL NO.  
 1E  
 10. FIELD AND POOL, OR WILDCAT  
 Basin Dakota  
 11. SEC., T., R., M., OR BLK. AND SURVEY OR AREA  
 Sec. 20, T31N, R9W  
 12. COUNTY OR PARISH  
 San Juan  
 13. STATE  
 NM

RECEIVED  
 FEB 27 1984

BUREAU OF LAND MANAGEMENT  
 FARMINGTON RESOURCE AREA

16. NO. OF ACRES IN LEASE: 1166.40  
 17. NO. OF ACRES ASSIGNED TO THIS WELL: E 320.71  
 20. ROTARY OR CABLE TOOLS: Rotary  
 22. APPROX. DATE WORK WILL START\*: ASAP

This action is subject to administrative appeal pursuant to 30 CFR 290.

See Attached

We will be hauling water from EPEX - extraction point Ban 09 - Heart Canyon irrigation ditch.

RECEIVED  
 APR 4 1984  
 OIL CON. DIV.

IN ABOVE SPACE, DESCRIBE PROPOSED PROGRAM: If proposal is to deepen or plug back, give data on present productive zone and proposed new productive zone. If proposal is to drill or deepen directionally, give pertinent data on subsurface locations measured and true vertical depths. Give blowout preventer program, if any.

24. SIGNED: *[Signature]* TITLE: Production Analyst

(This space for Federal or State office use)

PERMIT NO. \_\_\_\_\_ APPROVAL DATE \_\_\_\_\_

APPROVED BY \_\_\_\_\_ TITLE \_\_\_\_\_

CONDITIONS OF APPROVAL, IF ANY:

APPROVED  
 DATE 2/22/84  
 AS AMENDED  
 APR 03 1984  
*[Signature]*  
 AREA MANAGER  
 FARMINGTON RESOURCE AREA

# OIL CONSERVATION DIVISION

P. O. BOX 2088

SANTA FE, NEW MEXICO 87501

Form C-107  
Revised 10-1-78

STATE OF NEW MEXICO  
ENERGY AND MINERALS DEPARTMENT

All distances must be from the outer boundaries of the Section.

Operator <b>TENNECO OIL COMPANY</b>		Lease <b>BARRETT "A"</b>		Well No. <b>1E</b>
Unit Letter <b>G</b>	Section <b>20</b>	Township <b>31N</b>	Range <b>9W</b>	County <b>San Juan</b>
Actual Footage Location of Well: <b>1640</b> feet from the <b>North</b> line and <b>2215</b> feet from the <b>East</b> line				
Ground Level Elev. <b>6262</b>	Producing Formation <b>Dakota</b>		Pool <b>Basin Dakota</b>	Dedicated Acreage: <b>320.77</b> Acres

1. Outline the acreage dedicated to the subject well by colored pencil or hachure marks on the plat below.
2. If more than one lease is dedicated to the well, outline each and identify the ownership thereof (both as to working interest and royalty).
3. If more than one lease of different ownership is dedicated to the well, have the interests of all owners been consolidated by communitization, unitization, force-pooling, etc?

Yes    No   If answer is "yes," type of consolidation \_\_\_\_\_

If answer is "no," list the owners and tract descriptions which have actually been consolidated. (Use reverse side of this form if necessary.) \_\_\_\_\_

No allowable will be assigned to the well until all interests have been consolidated (by communitization, unitization, forced-pooling, or otherwise) or until a non-standard unit, eliminating such interests, has been approved by the Commission.

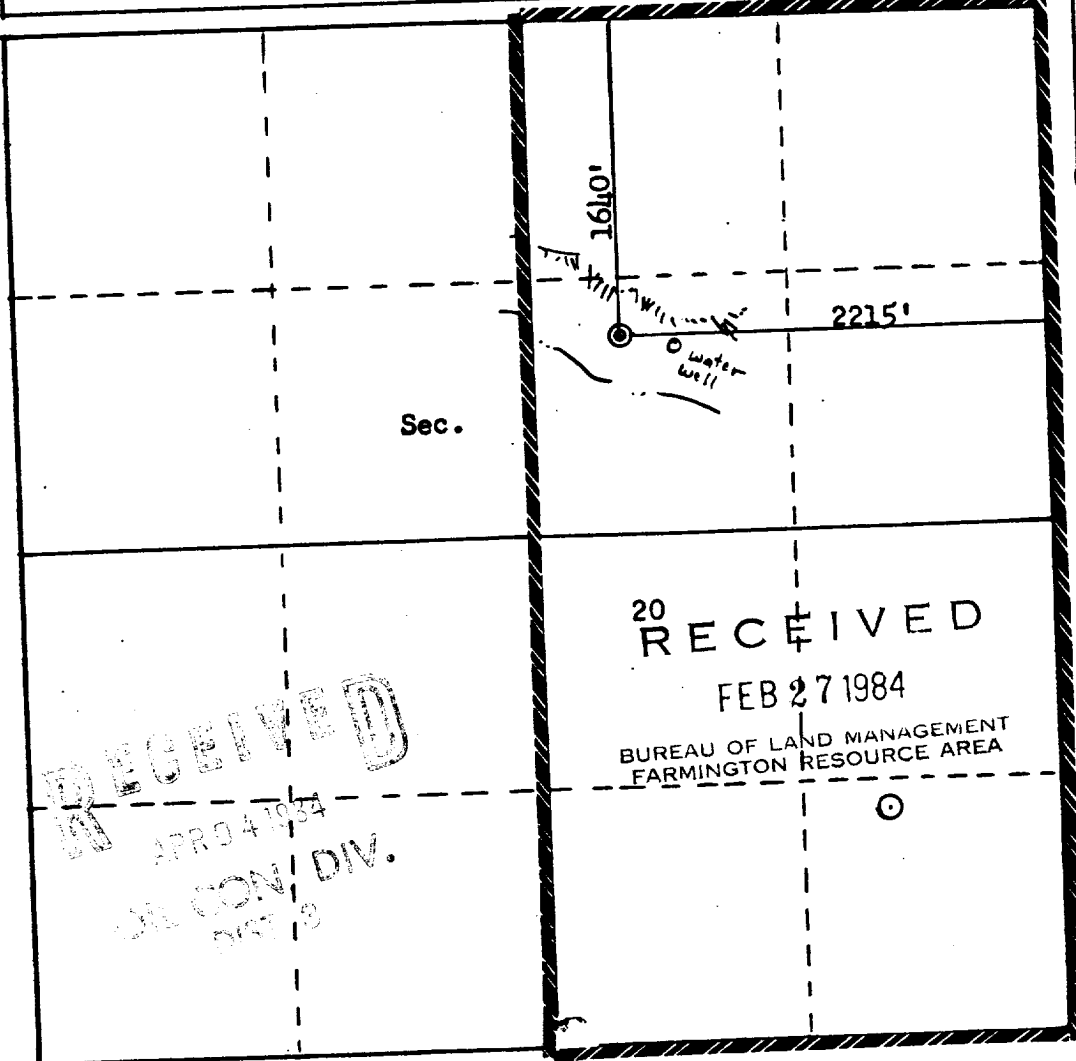

RECEIVED  
APR 4 1984  
OIL CON. DIV.  
DIST. 2

**20**  
**RECEIVED**  
**FEB 27 1984**  
 BUREAU OF LAND MANAGEMENT  
 FARMINGTON RESOURCE AREA

Scale: 1"=1000'

### CERTIFICATION

I hereby certify that the information contained herein is true and complete to the best of my knowledge and belief.

*[Signature]*

Name <b>John Orr</b>
Position <b>Production Analyst</b>
Company <b>Tenneco Oil Company</b>
Date <b>February 22, 1984</b>

I hereby certify that the well location shown on this plat was plotted from field notes of actual surveys made by me or under my supervision, and that the same is true and correct to the best of my knowledge and belief.

Date Surveyed <b>December 30, 1983</b>
Registered Professional Engineer and Land Surveyor <i>[Signature]</i> <b>Fred B. Kerr Jr.</b>
Certificate No. <b>3950</b>