



TONEY ANAYA  
GOVERNOR

STATE OF NEW MEXICO  
ENERGY AND MINERALS DEPARTMENT  
OIL CONSERVATION DIVISION

April 30, 1985

50 YEARS



1935 - 1985

POST OFFICE BOX 2088  
STATE LAND OFFICE BUILDING  
SANTA FE, NEW MEXICO 87501  
(505) 827-5800

Amoco Production  
Petroleum Center Building  
501 Airport Drive  
Farmington, New Mexico 87401

Attention: W. J. Holcomb

Administrative Order NSL-2013

Gentlemen:

Reference is made to your application for a non-standard location for your Ulibarri Gas Com Well No. 3E to be located 1340 feet from the South line and 1255 feet from the East line of Section 35, Township 30 North, Range 9 West, NMPM, Basin-Dakota Pool, San Juan County, New Mexico. The S/2 of said Section 35 is to be dedicated to the well.

By authority granted me under the provisions of Rule 104 F(I); the above-described unorthodox location is hereby approved.

Sincerely,

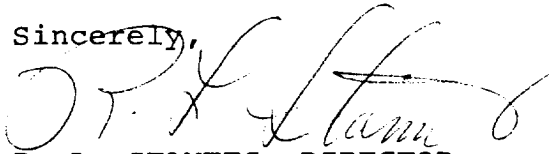
  
R. L. STAMETS, DIRECTOR

RLS/DC/dr

cc: Oil Conservation Division - Aztec  
Oil & Gas Engineering Committee - Hobbs  
Bureau of Land Management - Farmington

RECEIVED

MAY 03 1985

OIL CON. DIV.  
DIST. 3

NSL 2013

March 4, 1985

Mr. Gilbert Quintana  
New Mexico Oil Conservation Division  
P. O. Box 2088  
Santa Fe, NM 87501

RECEIVED

MAR 07 1985

File: DDL-269-400.1

OIL CON. DIV.  
DIST. 3

Application for Unorthodox Location  
Ulibarri Gas Com No. 3E  
Basin Dakota Field  
San Juan County, New Mexico

Amoco Production Company hereby requests approval of an unorthodox well location for the Ulibarri Gas Com No. 3E. The proposed location is 1340' FSL x 1255' FEL of Section 35, T30N, R9W, San Juan County, New Mexico.

This well was staked in the unorthodox location indicated above to stay out of a cultivated field and an irrigation ditch in the orthodox window for the Basin Dakota Field.

A copy of this application is being sent by certified mail to the offset lease holders, American Petrofina and Tenneco, with the request that they furnish you a waiver of objection and return one copy of the same to me.

Sincerely,

Original signed  
W. J. Malcomb  
by DDL-BDS  
KRJ/ct

Attachments

✓cc: Mr. Ernie Bush  
New Mexico Oil Conservation Division  
1000 Rio Brazos Road  
Aztec, NM 87410

\_\_\_\_\_ hereby waives objection to Amoco's application for an unorthodox location as proposed above.

By: \_\_\_\_\_ Date: \_\_\_\_\_  
AM18

OIL CONSERVATION DIVISION

STATE OF NEW MEXICO  
ENERGY AND MINERALS DEPARTMENT

P. O. BOX 2088  
SANTA FE, NEW MEXICO 87501

Form C-102  
Revised 10-1-78

All distances must be from the outer boundaries of the Section.

Operator <b>AMOCO PRODUCTION COMPANY</b>		Lease <b>ULIBARRI GAS COM</b>			Well No. <b>3E</b>
Unit Letter <b>I</b>	Section <b>35</b>	Township <b>30 N</b>	Range <b>9 W</b>	County <b>San Juan</b>	
Actual Footage Location of Wells <b>1340</b> feet from the <b>SOUTH</b> line and <b>1255</b> feet from the <b>EAST</b> line					
Ground Level Elev. <b>5625</b>	Producing Formation <b>Dakota</b>		Pool <b>Basin Dakota</b>		Dedicated Acreage <b>320</b> Acres

1. Outline the acreage dedicated to the subject well by colored pencil or hachure marks on the plat below.
2. If more than one lease is dedicated to the well, outline each and identify the ownership thereof (both as to working interest and royalty).
3. If more than one lease of different ownership is dedicated to the well, have the interests of all owners been consolidated by communitization, unitization, force-pooling, etc?

Yes  No If answer is "yes," type of consolidation communitized

If answer is "no," list the owners and tract descriptions which have actually been consolidated. (Use reverse side of this form if necessary.) \_\_\_\_\_

No allowable will be assigned to the well until all interests have been consolidated (by communitization, unitization, forced-pooling, or otherwise) or until a non-standard unit, eliminating such interests, has been approved by the Division.

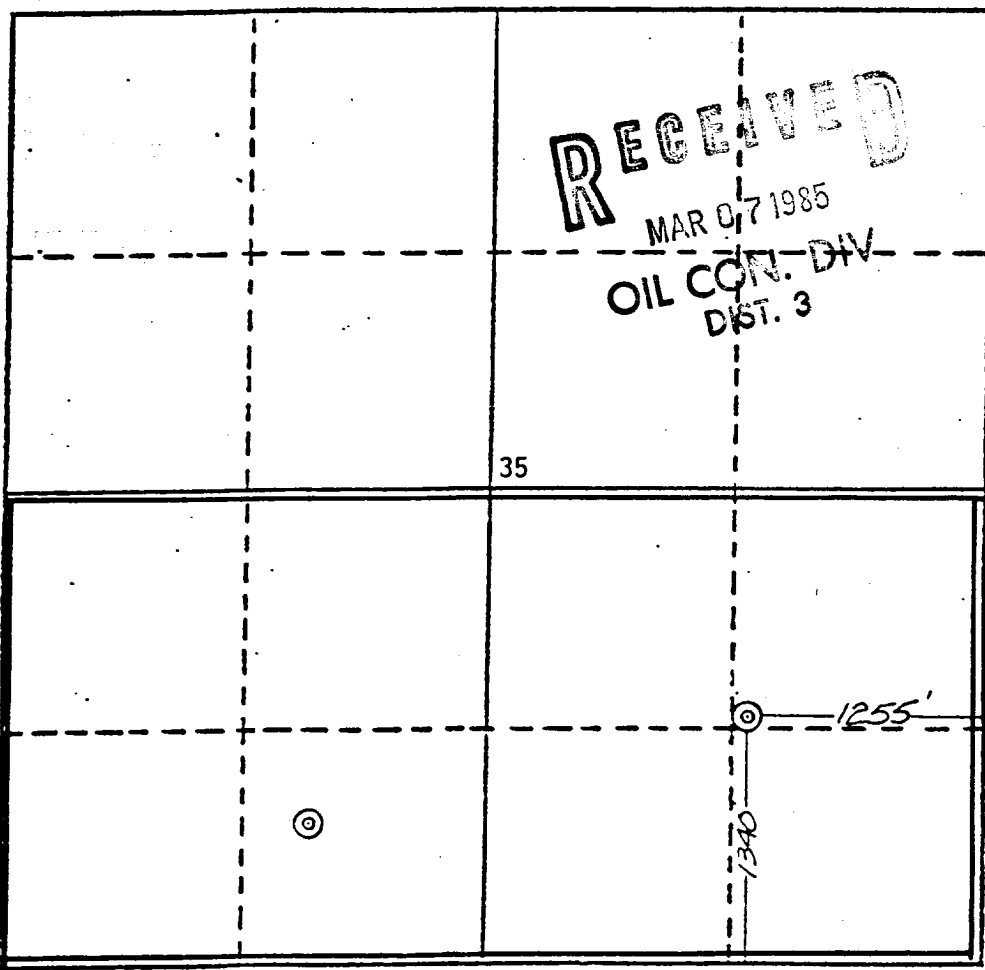

CERTIFICATION

I hereby certify that the information contained herein is true and complete to the best of my knowledge and belief.

Name  
**B.D. Shaw**

Position  
**Adm. Supervisor**

Company  
**Amoco Production Co.**

Date  
**2-26-85**

I hereby certify that the information shown on this plat was derived from field notes of actual surveys made by me or under my supervision, and that the same is true and correct to the best of my knowledge and belief.

**GARY D. VANN**  
NEW MEXICO  
7016  
REGISTERED PROFESSIONAL LAND SURVEYOR

Date Surveyed  
**January 9, 1985**

Registered Professional Engineer and/or Land Surveyor  
**Gary D. Vann**

Certificate No.  
**7016**

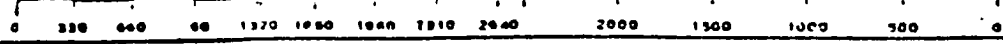

AMOCO PRODUCTION COMPANY  
ULIBARRI GAS COM No. 3E  
1340' F/SL 1255' F/EL  
Sec. 35, T30N, R9W, NMPM  
San Juan County, New Mexico

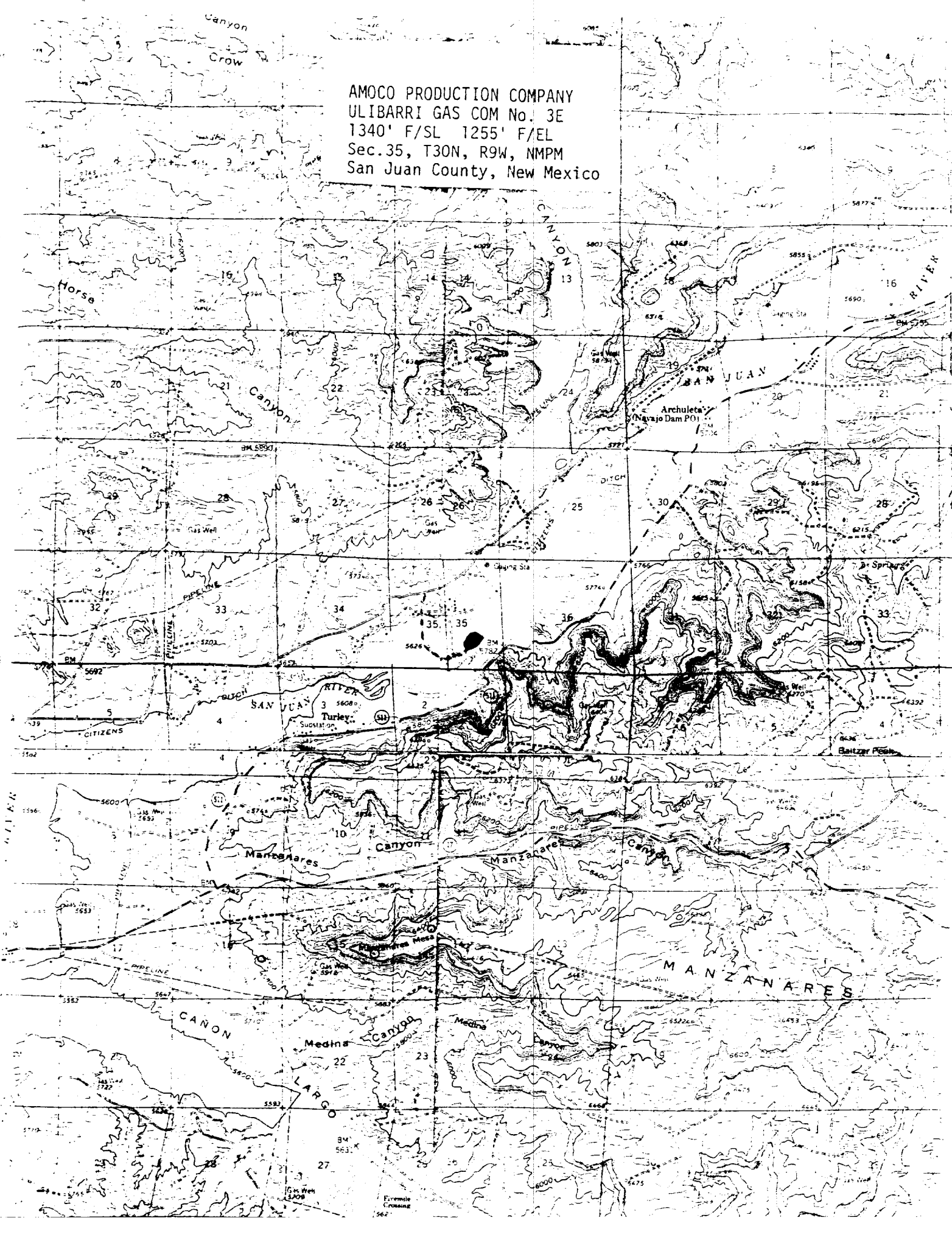

R9W

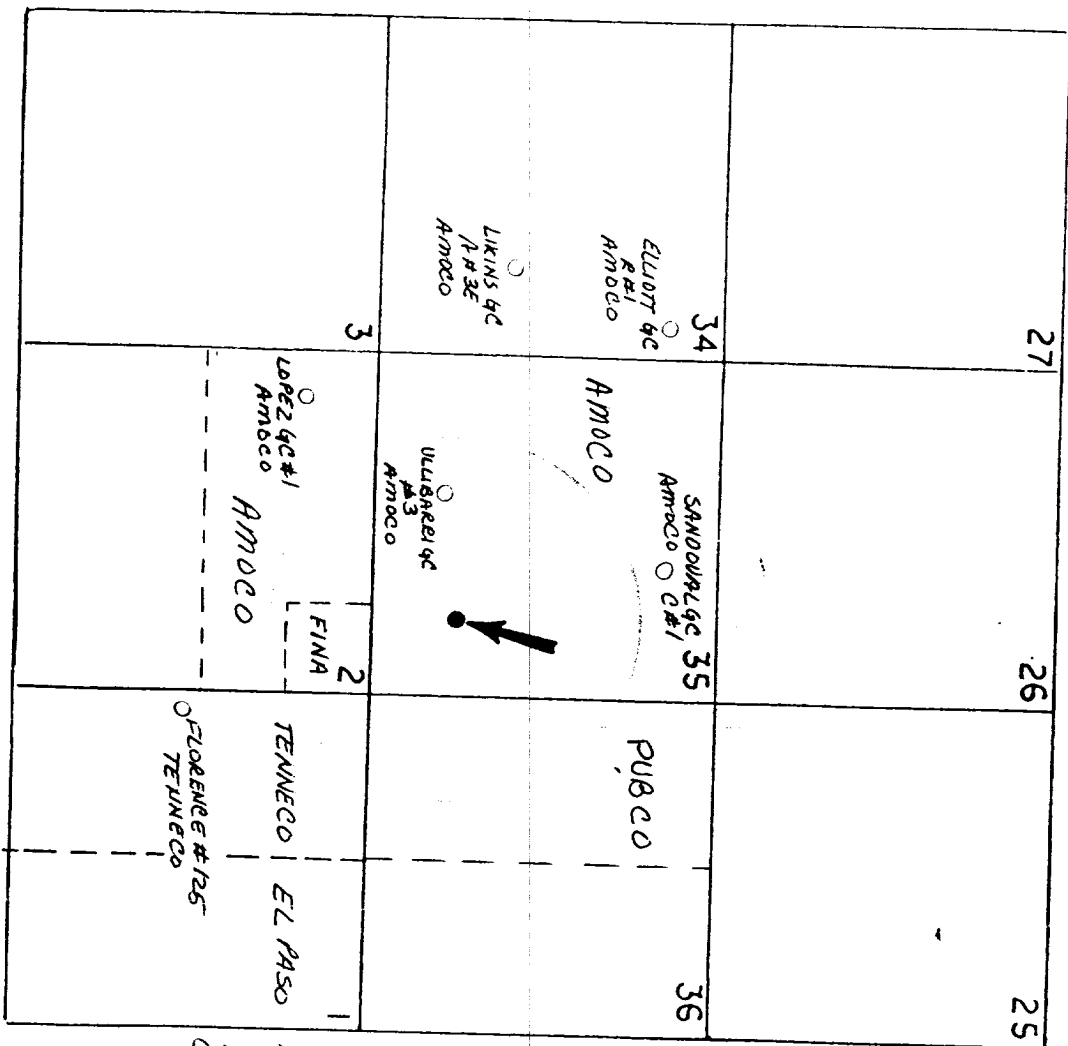

○ BASIN DAKOTA WELLS  
 ● PROPOSED WELL

T 30 N  
 T 29 N