

UNITED STATES
DEPARTMENT OF THE INTERIOR
BUREAU OF LAND MANAGEMENT

APPLICATION FOR PERMIT TO DRILL, DEEPEN, OR PLUG BACK

1A. TYPE OF WORK

DRILL ☒

DEEPEN ☐

PLUG BACK ☐

B. TYPE OF WELL

OIL WELL ☐

GAS WELL ☒

OTHER

SINGLE ZONE ☒

MULTIPLE ZONE ☐

2. NAME OF OPERATOR

Phillips Petroleum Company

3. ADDRESS OF OPERATOR

300 W. Arrington, Suite 200, Farmington, N.M. 87401

4. LOCATION OF WELL (Report location clearly and in accordance with any State requirements.)*

At surface

Unit M, 1058' FSL & 905' FWL

At proposed prod. zone

Unit M, 1058' FSL & 905' FWL

14. DISTANCE IN MILES AND DIRECTION FROM NEAREST TOWN OR POST OFFICE*

10. DISTANCE FROM PROPOSED*

LOCATION TO NEAREST
PROPERTY OR LEASE LINE, FT.
(Also to nearest drig. unit line, if any)

905' FWL

18. DISTANCE FROM PROPOSED LOCATION*

TO NEAREST WELL, DRILLING, COMPLETED,
OR APPLIED FOR, ON THIS LEASE, FT. 119' from #13

16. NO. OF ACRES IN LEASE

1720 Ac

19. PROPOSED DEPTH

3545'

17. NO. OF ACRES ASSIGNED
TO THIS WELL

320 Ac W/2 of Section

20. ROTARY OR CABLE TOOLS

Rotary

21. ELEVATIONS (Show whether DF, RT, GR, etc.)

6664' (GL Unprepared)

22. APPROX. DATE WORK WILL START*

Upon Approval

23.

PROPOSED CASING AND CEMENTING PROGRAM

DRILLING OPERATIONS AUTHORIZED ARE
SUBJECT TO COMPLIANCE WITH ATTACHED

| SIZE OF HOLE | SIZE OF CASING | WEIGHT PER FOOT | SETTING DEPTH | GENERAL QUANTITY OF CEMENT |
|--------------|----------------|-----------------|---------------|----------------------------|
| 12-1/4" | 9-5/8" | 36#, K-55 | 250' | 200 sxs, Circ to Surface |
| 8-3/4" | 7" | 23#, K-55 | 3337' | 600 sxs, Circ to Surface |
| 6-1/8" | 5-1/2" | 15.5# or 23# | 3237'-3545' | * |

*If the coal is cleated a 5-1/2", 23#, P-110 liner will be run in the open hole without being cemented.

*If the coal is not cleated a 5-1/2", 15.5#, K-55 liner will be run, cemented with 100 sxs cement and the well fractured.

RECEIVED

JUN 26 1990

OIL CON. DIV.

DIST. 3

Mud Program and BOP Equipment: See Attached

IN ABOVE SPACE DESCRIBE PROPOSED PROGRAM: If proposal is to deepen or plug back, give data on present productive zone and proposed new productive zone. If proposal is to drill or deepen directionally, give pertinent data on subsurface locations and measured and true vertical depths. Give blowout preventer program, if any.

24.

SIGNED L.M. Sanders

TITLE Supv. Regulatory Affairs

DATE 5/21/90

(This space for Federal or State office use)

PERMIT NO. _____

APPROVAL DATE _____

APPROVED BY _____

TITLE _____

DATE _____

CONDITIONS OF APPROVAL, IF ANY:

NMOCD

APPROVED

JUN 20 1990

AREA MANAGER

*See Instructions On Reverse Side

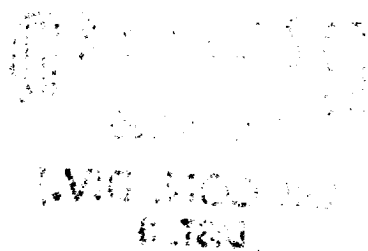

APR 1954

1954

APR 1954

Submit to Appropriate
District Office
State Lease - 4 copies
Fee Lease - 3 copies

State of New Mexico
Energy, Minerals and Natural Resources Department

OIL CONSERVATION DIVISION

P.O. Box 2088
Santa Fe, New Mexico 87504-2088

Form C-102
Revised 1-1-89

DISTRICT I
P.O. Box 1980, Hobbs, NM 88240

DISTRICT II
P.O. Drawer DD, Artesia, NM 88210

DISTRICT III
1000 Rio Brazos Rd., Aztec, NM 87410

WELL LOCATION AND ACREAGE DEDICATION PLAT

All Distances must be from the outer boundaries of the section

| | | | | |
|---|---|------------------------------------|-------------------------------------|--|
| Operator PHILLIPS PETROLEUM | | Lease SAN JUAN 32-8 UNIT | | Well No. 221 |
| Unit Letter M | Section 9 | Township T.31 N. | Range R.8 W. NMPM | County SAN JUAN COUNTY |
| Actual Footage Location of Well: 1058 feet from the SOUTH line and 905 feet from the WEST line | | | | |
| Ground level Elev. 6664 | Producing Formation Fruitland | | Pool Basin Fruitland Coal | Dedicated Acreage: 320 Acres |

1. Outline the acreage dedicated to the subject well by colored pencil or hatchure marks on the plat below.
2. If more than one lease is dedicated to the well, outline each and identify the ownership thereof (both as to working interest and royalty).
3. If more than one lease of different ownership is dedicated to the well, have the interest of all owners been consolidated by communization, unitization, force-pooling, etc.?
☒ Yes ☐ No If answer is "yes" type of consolidation Unitization
If answer is "no" list the owners and tract descriptions which have actually been consolidated. (Use reverse side of this form if necessary.)
No allowable will be assigned to the well until all interests have been consolidated (by communization, unitization, forced-pooling, or otherwise) or until a non-standard unit, eliminating such interest, has been approved by the Division.

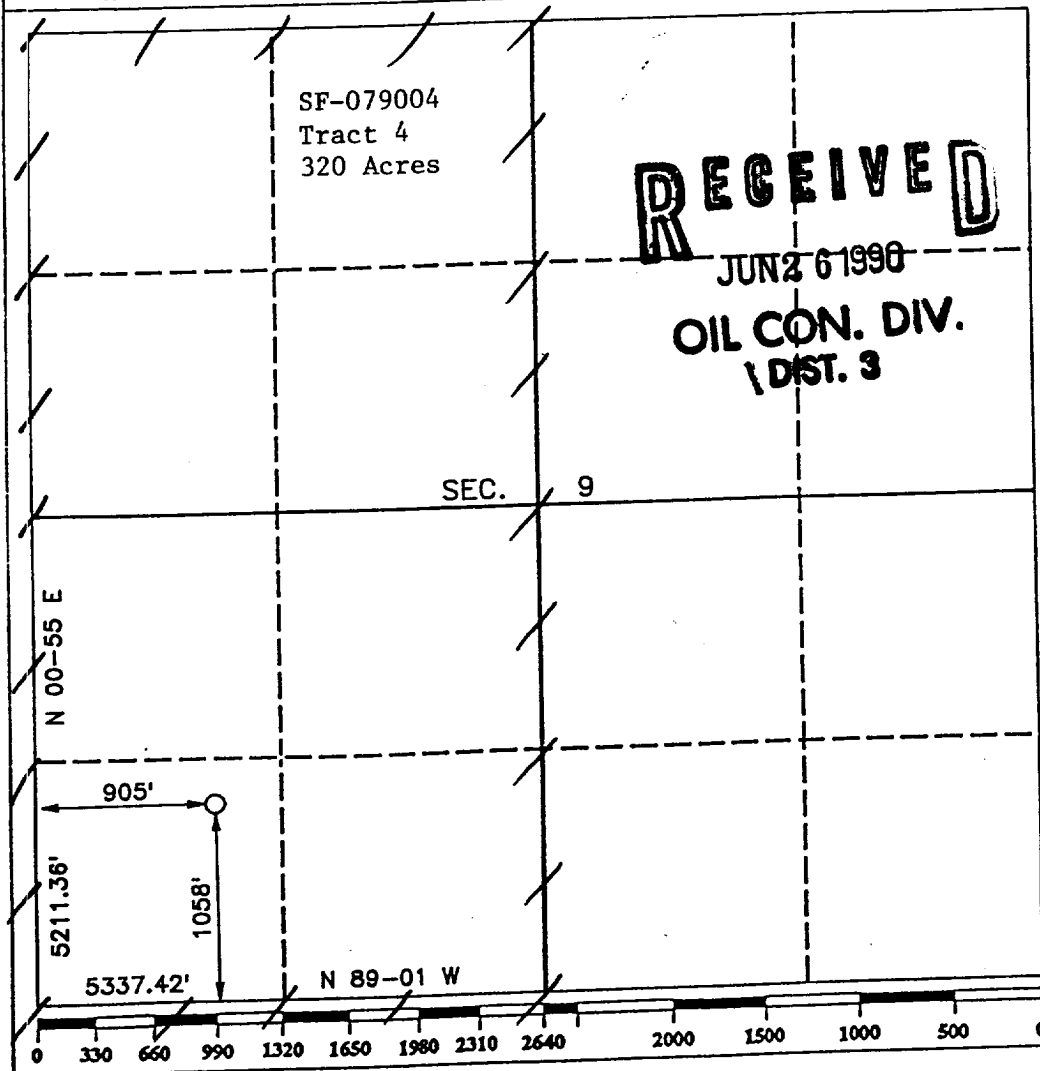

OPERATOR CERTIFICATION

I hereby certify that the information contained herein is true and complete to the best of my knowledge and belief.

Signature
L.M. Sanders
Printed Name
L.M. Sanders
Position
Supv. Regulatory Affairs
Company
Phillips Petroleum Co.
Date
5/21/90

SURVEYOR CERTIFICATION

I hereby certify that the well location shown on this plat was plotted from field notes of actual surveys made by me or under my supervision, and that the same is true and correct to the best of my knowledge and belief.

Date Surveyed
APRIL 10, 1990
Signature of Seal of Professional Surveyor
R. HOWARD DUGGETT
R. Howard Duggett
Certificate No. **9679**
Registered Professional Land Surveyor

