

(SUBMIT IN TRIPLICATE)

Land Office Santa Fe
0790.1
Lease No. San Juan 32-5
Unit _____UNITED STATES
DEPARTMENT OF THE INTERIOR
GEOLOGICAL SURVEY

SUNDRY NOTICES AND REPORTS ON WELLS

NOTICE OF INTENTION TO DRILL.....	<input checked="" type="checkbox"/>	SUBSEQUENT REPORT OF WATER SHUT-OFF.....	
NOTICE OF INTENTION TO CHANGE PLANS.....		SUBSEQUENT REPORT OF SHOOTING OR ACIDIZING.....	
NOTICE OF INTENTION TO TEST WATER SHUT-OFF.....		SUBSEQUENT REPORT OF ALTERING CASING.....	
NOTICE OF INTENTION TO RE-DRILL OR REPAIR WELL.....		SUBSEQUENT REPORT OF RE-DRILLING OR REPAIR.....	
NOTICE OF INTENTION TO SHOOT OR ACIDIZE.....		SUBSEQUENT REPORT OF ABANDONMENT.....	
NOTICE OF INTENTION TO PULL OR ALTER CASING.....		SUPPLEMENTARY WELL HISTORY.....	
NOTICE OF INTENTION TO ABANDON WELL.....			

(INDICATE ABOVE BY CHECK MARK NATURE OF REPORT, NOTICE, OR OTHER DATA)

August 29, 1960

19

Well No. San Juan 32-5 Unit
2-22 is located 22 ft. from N line and 1,750 ft. from E line
N 1/4 Sec. 25 (1/4 Sec. and Sec. No.) 22 (Twp.) 22 (Range) 25 (Meridian)
Indefinite (Field) San Juan (County or Subdivision) New Mexico (State or Territory)

The elevation of the derrick floor above sea level is 5,400 ft.

DETAILS OF WORK

(State names of and expected depths to objective sands; show sizes, weights, and lengths of proposed casings; indicate mudding jobs, cementing points, and all other important proposed work)

Objective Sands: 500 screen indicated in well.

Casing program: Set 5-7/8 casing at 600 feet and cement to surface.

Drill 7-7/8 hole through overburden formation to approximately 650' with mud and a Drilling fluid.

5-1/2 17-1/2 H-60 casing will be set and cemented to surface. The casing with approximately 200 sacks of cement.

Mesa Verde will be cemented off by means of a two-stage collar set approximately 250' below the base of the casing, cemented with approximately 200 sacks cement.

I understand that this plan of work must receive approval in writing by the Geological Survey before operations may be commenced.

Company Ac Data Gathering System, Inc.Address P. O. Box 728Farmington, New Mexico.By [Signature]
C. Beeson Neal, Agent in Farmington.
Title _____

NUMBER OF COPIES RECEIVED	
DISTRIBUTION	
SANTA FE	
FILE	
U.S.G.S.	
LAND OFFICE	
TRANSPORTER	OIL GAS
PRODUCTION OFFICE	
OPERATOR	

NEW MEXICO OIL CONSERVATION COMMISSION
WELL LOCATION AND ACREAGE DEDICATION PLAT
 SEE INSTRUCTIONS FOR COMPLETING THIS FORM ON THE REVERSE SIDE

FORM C-128
 Revised 5/1/57

SECTION A

Operator LA PLATA GATHERING SYSTEM		Lease SAN JUAN UNIT 32-5		Well No. 2-25
Unit Letter B	Section 25	Township 32 NORTH	Range 6 WEST	County RIO ARriba
Actual Footage Location of Well: 910 feet from the NORTH line and 1760 feet from the EAST line				
Ground Level Elev. 6393.0	Producing Formation Devota	Pool Undesignated	Dedicated Acreage: 330 Acres	

Ref. GLO Plat dated: 28 June 1887

- Is the Operator the only owner in the dedicated acreage outlined on the plat below? YES _____ NO X . ("Owner" means the person who has the right to drill into and to produce from any pool and to appropriate the production either for himself or for himself and another. (65-3-29 (e) NMSA 1935 Comp.)
- If the answer to question one is "no," have the interests of all the owners been consolidated by community agreement or otherwise? YES _____ NO _____. If answer is "yes," Type of Consolidation Jointure
- If the answer to question two is "no," list all the owners and their respective interests below:

Owner	Land Description

RECEIVED
SEP 7 1960
OIL CON. COM.
DIST. 3

SECTION B

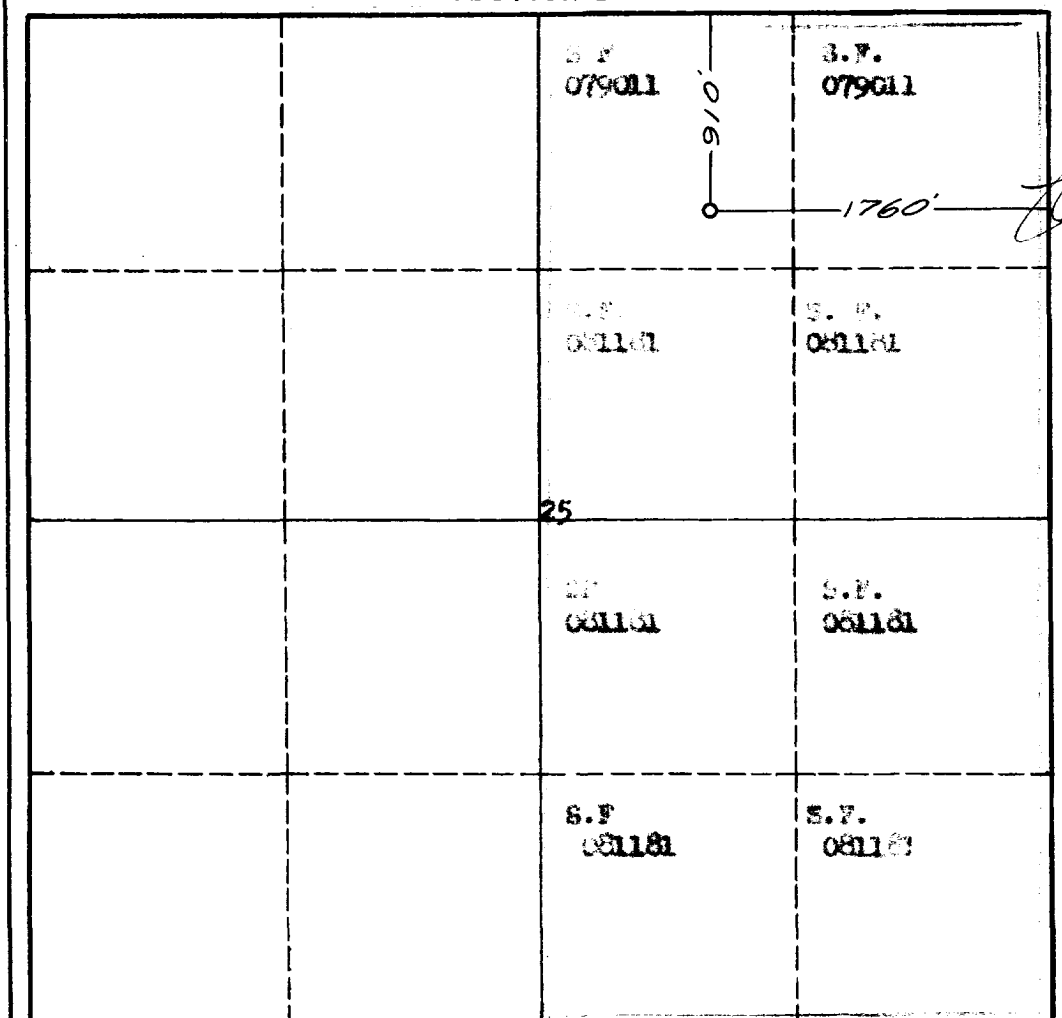

CERTIFICATION

I hereby certify that the information in SECTION A above is true and complete to the best of my knowledge and belief.

Name C. Benson Neal
 Position Agent in Charge
 Company La Plata Gathering System, Inc.
 Date August 29, 1960

I hereby certify that the well location shown on the plat in SECTION B was plotted from field notes of actual surveys made by me or under my supervision, and that the same is true and correct to the best of my knowledge and belief.

Date Surveyed August 29, 1959
 Registered Professional Engineer and/or Land Surveyor James P. Loese
 James P. Loese
 Certificate No. 1463

INSTRUCTIONS FOR COMPLETION OF FORM C-128

1. Operator shall furnish and certify to the information called for in Section A.
2. Operator shall outline the dedicated acreage for *both* oil and gas wells on the plat in Section B.
3. A registered professional engineer or land surveyor registered in the State of New Mexico or approved by the Commission shall show on the plat the location of the well and certify this information in the space provided.
4. All distances shown on the plat must be from the outer boundaries of the Section.
5. If additional space is needed for listing owners and their respective interests as required in question 3 of Section A, please use space below.