

(SUBMIT IN TRIPLICATE)

UNITED STATES
DEPARTMENT OF THE INTERIOR
GEOLOGICAL SURVEY

Indian Agency _____

Window Rock

Allottee Tribal

Lease No. 11-60-60-731

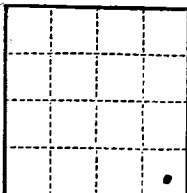

SUNDRY NOTICES AND REPORTS ON WELLS

NOTICE OF INTENTION TO DRILL	<input checked="" type="checkbox"/>	SUBSEQUENT REPORT OF WATER SHUT-OFF	
NOTICE OF INTENTION TO CHANGE PLANS		SUBSEQUENT REPORT OF SHOOTING OR ACIDIZING	
NOTICE OF INTENTION TO TEST WATER SHUT-OFF		SUBSEQUENT REPORT OF ALTERING CASING	
NOTICE OF INTENTION TO REDRILL OR REPAIR WELL		SUBSEQUENT REPORT OF REDRILLING OR REPAIR	
NOTICE OF INTENTION TO SHOOT OR ACIDIZE		SUBSEQUENT REPORT OF ABANDONMENT	
NOTICE OF INTENTION TO PULL OR ALTER CASING		SUPPLEMENTARY WELL HISTORY	
NOTICE OF INTENTION TO ABANDON WELL			

(INDICATE ABOVE BY CHECK MARK NATURE OF REPORT, NOTICE, OR OTHER DATA)

August 7, 1958

Navajo
Well No. 1 is located 660 ft. from [S] line and 117 ft. from [E] line of sec. 32
SE 1/4 SE 1/4 Sec. 32 31 N 16 W
(1/4 Sec. and Sec. No.) (Twp.) (Range) (Meridian)
Horseshoe-Callup San Juan New Mexico
(Field) (County or Subdivision) (State or Territory)

The elevation of the ~~land surface~~ above sea level is 531.6 ft.

DETAILS OF WORK

(State names of and expected depths to objective sands; show sizes, weights, and lengths of proposed casings; indicate mudding jobs, cementing points, and all other important proposed work)

We propose to drill a well at the above location with rotary tools to an approximate total depth of 1300' to test the producing capacity of the upper and lower Toito formations. 125' of 8-5/8" O.D. 2 1/2 J-55 surface casing will be set and cemented to surface. Both of the above zones will be cored. Should the well prove productive a 5-1/2" O.D. oil string will be used.



I understand that this plan of work must receive approval in writing by the Geological Survey before operations may be commenced.

Company The Atlantic Refining Company
Address P. O. Box 520
Casper, Wyoming
By [Signature]
Title Drilling Superintendent

NEW MEXICO OIL CONSERVATION COMMISSION
Well Location and Acreage Dedication Plat

Section A.

Date _____

Operator THE ATLANTIC REFINING COMPANY Lease NAVAJO
Well No. 1 Unit Letter P Section 32 Township 31 NORTH Range 16 WEST, NMPM
Located 660 Feet From the SOUTH Line, 417 Feet From the EAST Line
County SAN JUAN G. L. Elevation 5331.6 Dedicated Acreage 40 38.85 Acres
Name of Producing Formation Tecito Gallup Pool Horseshoe-Gallup

1. Is the Operator the only owner* in the dedicated acreage outlined on the plat below?
Yes _____ No _____.
2. If the answer to question one is "no," have the interests of all the owners been consolidated by communitization agreement or otherwise? Yes _____ No _____. If answer is "yes," Type of Consolidation _____
3. If the answer to question two is "no," list all the owners and their respective interests below:
Ref: SJE plat of Survey

Owner

Land Description

Section B

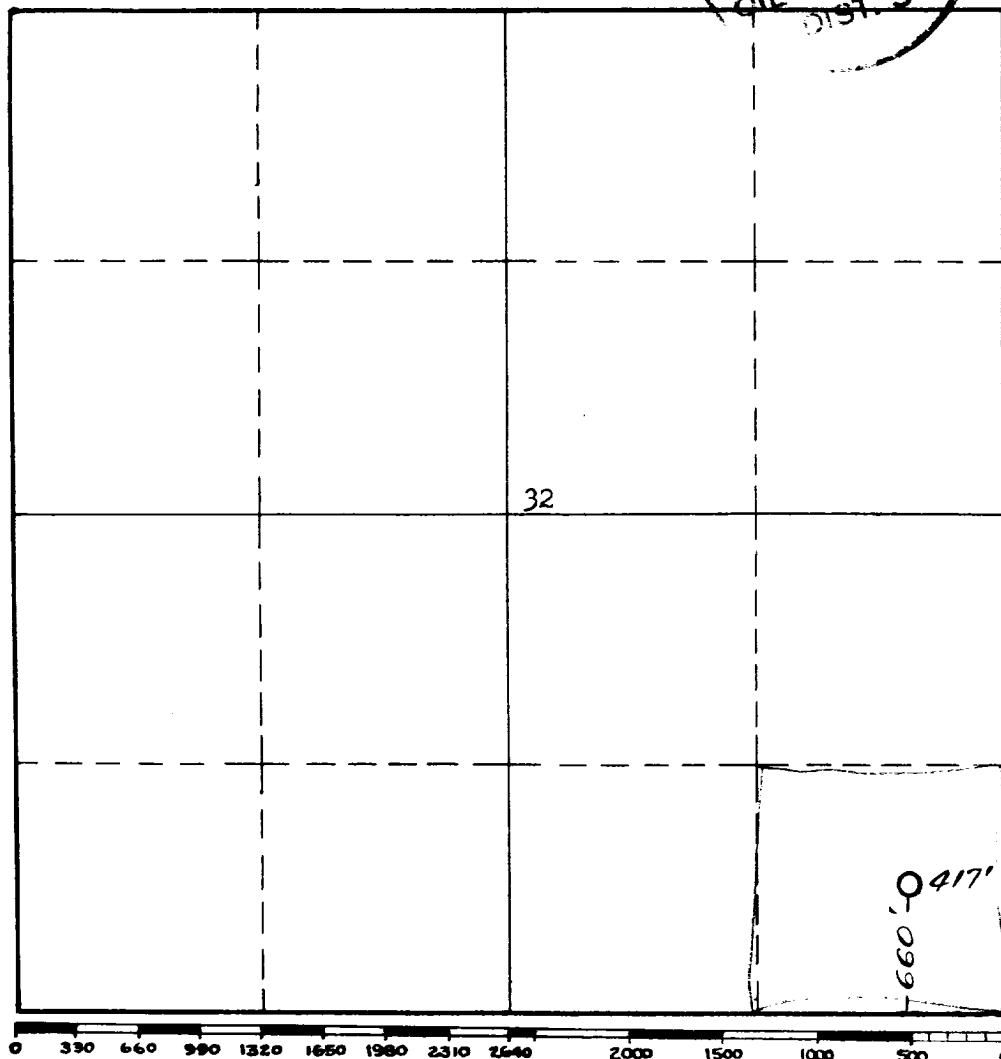

This is to certify that the information in Section A above is true and complete to the best of my knowledge and belief.

The Atlantic Refining Co.
(Operator)

Adrian
(Representative)

Box 520, Casper, Wyoming
Address

This is to certify that the well location shown on the plat in Section B was plotted from field notes of actual surveys made by me or under my supervision and that the same is true and correct to the best of my knowledge and belief.

Date Surveyed 6 August 1958

James P. Leese
Registered Professional
Engineer and/or Land Surveyor.

James P. Leese

Certificate No. 1463

INSTRUCTIONS FOR COMPLETION:

1. Operator shall furnish and certify to the information called for in Section A.
2. Operator shall outline the dedicated acreage for both oil and gas wells on the plat in Section B.
3. A registered professional engineer or land surveyor registered in the State of New Mexico or approved by the Commission shall show on the plat the location of the well and certify this information in the space provided.
4. All distances shown on the plat must be from the outer boundaries of Section.
5. If additional space is needed for listing owners and their respective interests as required in question 3, Section A, please use space below

* "Owner" means the person who has the right to drill into and to produce from any pool and to appropriate the production either for himself or for himself and another. (65-3-29 (e) NMSA 1953 Comp.)