

State
(SUBMIT IN TRIPLICATE)

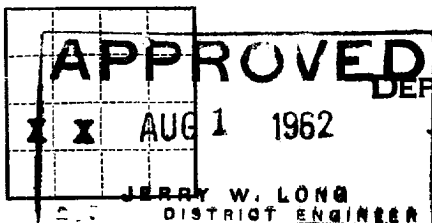

UNITED STATES
DEPARTMENT OF THE INTERIOR
GEOLOGICAL SURVEY

Indian Agency _____
Ute Mountain Tribe
Allottee _____
Lease No. **14-20-604-90**

SUNDRY NOTICES AND REPORTS ON WELLS

NOTICE OF INTENTION TO DRILL	<input checked="" type="checkbox"/>	SUBSEQUENT REPORT OF WATER SHUT-OFF	
NOTICE OF INTENTION TO CHANGE PLANS		SUBSEQUENT REPORT OF SHOOTING OR ACIDIZING	
NOTICE OF INTENTION TO TEST WATER SHUT-OFF		SUBSEQUENT REPORT OF ALTERING CASING	
NOTICE OF INTENTION TO REDRILL OR REPAIR WELL		SUBSEQUENT REPORT OF REDRILLING OR REPAIR	
NOTICE OF INTENTION TO SHOOT OR ACIDIZE		SUBSEQUENT REPORT OF ABANDONMENT	
NOTICE OF INTENTION TO PULL OR ALTER CASING		SUPPLEMENTARY WELL HISTORY	
NOTICE OF INTENTION TO ABANDON WELL			

(INDICATE ABOVE BY CHECK MARK NATURE OF REPORT, NOTICE, OR OTHER DATA)

July 16, 19**62**

Well No. **2 k** is located **1980** ft. from **S** line and **690** ft. from **W** line of sec. **32**
NW 1/4 SEC. 32 **T-31 N R-15 W** **NMPM**
(1/4 Sec. and Sec. No.) (Twp.) (Range) (Meridian)
Verde Gallup **San Juan** **New Mexico**
(Field) (County or Subdivision) (State or Territory)

The elevation of the ~~ground level~~ **ground level** above sea level is **5400.1** ft.

DETAILS OF WORK

(State names of and expected depths to objective sands; show sizes, weights, and lengths of proposed casings; indicate mudding jobs, cementing points, and all other important proposed work)

Gallup 2300. Set 8 5/8 in. J-55, 24 lb. surface casing with 60 sx cement. Rotary drill to 2200 ft and set 5 1/2 in J-55, 14.6 lb casing with 125 sx cement. Air drill to TD, 2300. Remove rig and free open hole with 1000 bbls oil and 10,000 lbs 10-20 sand. Run 2 3/8 in. J-55, 4.6 lb. tubing and 5/8 in. scrapped rods and place on pump.



I understand that this plan of work must receive approval in writing by the Geological Survey before operations may be commenced.

Company **A.L. Duff, Jr.**
Address **515 Simms Bldg.**
Albuquerque, New Mex.

By *Frank A. King*
Title *Landman*

NEW MEXICO OIL CONSERVATION COMMISSION

Well Location and Acreage Dedication Plat

Section A.

Date **July 16, 1962**

Operator **A. L. DUFF, JR.** Lease **(Well: SNOW FLAKE #1) 2**
 Well No. **2** Unit Letter **L** Section **32** Township **31 NORTH** Range **15 WEST** NMPM
 Located **1980** Feet From **the SOUTH** Line, **690** Feet From **the WEST** Line
 County **SAN JUAN** G. L. Elevation **5400.1** Dedicated Acreage _____ Acres
 Name of Producing Formation **Gallup** Pool **Verde Gallup**

1. Is the Operator the only owner in the dedicated acreage outlined on the plat below?
 Yes ☒ No _____
2. If the answer to question one is "no", have the interests of all the owners been consolidated by communitization agreement or otherwise? Yes _____ No _____. If answer is "yes", Type of Consolidation.
3. If the answer to question two is "no", list all the owners and their respective interests below:

Owner

Land Description

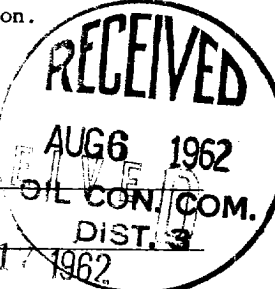

Section B.

This is to certify that the information in Section A above is true and complete to the best of my knowledge and belief.

A. L. Duff, Jr.
 (Operator)
Frank A. King
 (Representative)
515 Sims Bldg.
 (Address)
Albuquerque, New Mexico

Note: All distances must be from outer boundaries of section.

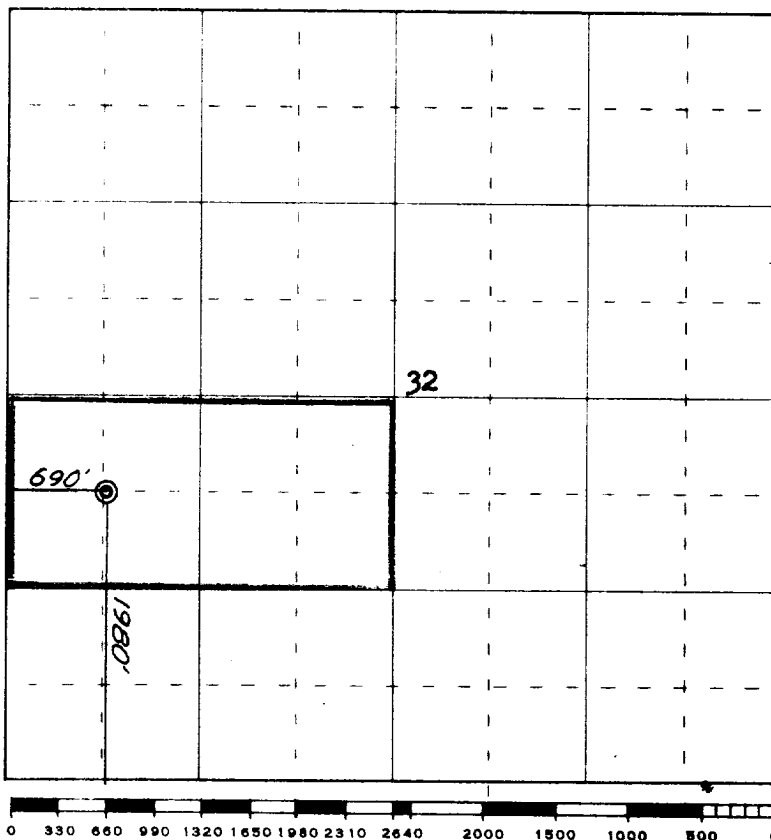

Scale 4 inches equal 1 mile

This is to certify that the above plat was prepared from field notes of actual surveys made by me or under my supervision and that the same are true and correct to the best of my knowledge and belief.

(Seal)

Farmington, New Mexico

Date Surveyed **14 July 1962**

James P. Leese
 Registered Professional Engineer and/or Land Surveyor
 James P. Leese N. Mex. Reg. No. 1463