

(SUBMIT IN TRIPLICATE)

UNITED STATES
DEPARTMENT OF THE INTERIOR
GEOLOGICAL SURVEY

Indian Agency _____
Window Rock _____
Allottee Navajo Tribal _____
Lease No. 14-20-603-734

SUNDRY NOTICES AND REPORTS ON WELLS

NOTICE OF INTENTION TO DRILL <input checked="" type="checkbox"/>	SUBSEQUENT REPORT OF WATER SHUT-OFF
NOTICE OF INTENTION TO CHANGE PLANS	SUBSEQUENT REPORT OF SHOOTING OR ACIDIZING
NOTICE OF INTENTION TO TEST WATER SHUT-OFF	SUBSEQUENT REPORT OF ALTERING CASING
NOTICE OF INTENTION TO REDRILL OR REPAIR WELL	SUBSEQUENT REPORT OF REDRILLING OR REPAIR
NOTICE OF INTENTION TO SHOOT OR ACIDIZE	SUBSEQUENT REPORT OF ABANDONMENT
NOTICE OF INTENTION TO PULL OR ALTER CASING	SUPPLEMENTARY WELL HISTORY
NOTICE OF INTENTION TO ABANDON WELL	

(INDICATE ABOVE BY CHECK MARK NATURE OF REPORT, NOTICE, OR OTHER DATA)

April 21, 1959

Navajo
Well No. 57 is located 1950 ft. from [S] line and 660 ft. from [E] line of sec. 31
NE SE Sec. 31 31 N 16 W N.M., N.M.
(1/4 Sec. and Sec. No.) (Twp.) (Range) (Meridian)
Horseshoe Gallup San Juan New Mexico
(Field) (County or Subdivision) (State or Territory)

The elevation of the ^{ground} ~~land surface~~ above sea level is 5317.30 ft.

DETAILS OF WORK

(State names of and expected depths to objective sands; show sizes, weights, and lengths of proposed casings; indicate mudding jobs, cementing points, and all other important proposed work)

We propose to drill a well at the above location to an approximate total depth of 1200' for completion in the Gallup formation. 8-5/8" O.D. surface casing will be set and cemented to surface, (approximately 100'). Should the well prove productive a 4-1/2" O.D. oil string will be used.

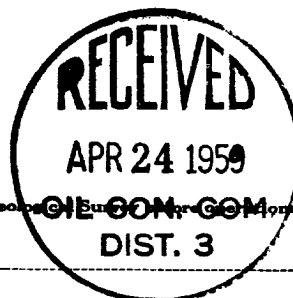

I understand that this plan of work must receive approval in writing by the Geological Survey before work may be commenced.

Company The Atlantic Refining Company

Address P. O. Box 520

Casper, Wyoming

By *Ad Klopfer*

Title Drilling Superintendent

NEW MEXICO OIL CONSERVATION COMMISSION

Well Location and Acreage Dedication Plat

Section A.

Date April 9, 1959

Operator THE ATLANTIC REFINING COMPANY Lease NAVAJO
 Well No. 57 Unit Letter I Section 31 Township 31 NORTH Range 16 WEST NMPM
 Located 1950 Feet From SOUTH Line, 660 Feet From EAST Line
 County SAN JUAN G. L. Elevation 5317.30 Dedicated Acreage _____ Acres
 Name of Producing Formation _____ Pool _____

1. Is the Operator the only owner in the dedicated acreage outlined on the plat below?
 Yes _____ No _____
2. If the answer to question one is "no", have the interests of all the owners been consolidated by communitization agreement or otherwise? Yes _____ No _____. If answer is "yes", Type of Consolidation.
3. If the answer to question two is "no", list all the owners and their respective interests below:

Owner

Land Description

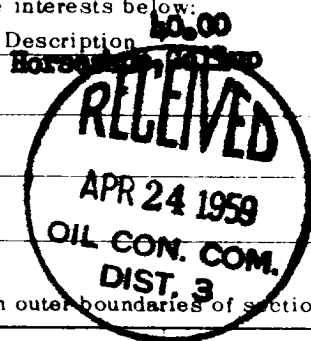
Gallup

Section B.

This is to certify that the information in Section A above is true and complete to the best of my knowledge and belief.

(Operator)

(Representative)

(Address)

The Atlantic Refining CompanyA. D. KlockinP. O. Box 520Casper, Wyoming

Note: All distances must be from outer boundaries of section.

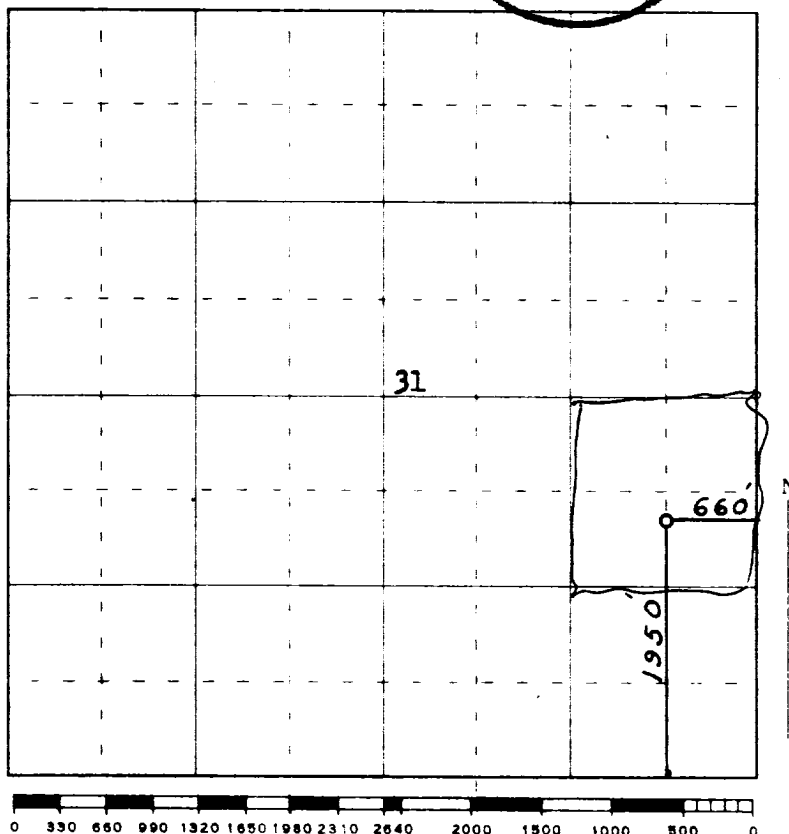

Scale 4 inches equal 1 mile

This is to certify that the above plat was prepared from field notes of actual surveys made by me or under my supervision and that the same are true and correct to the best of my knowledge and belief.

Date Surveyed 7 April 1959

Registered Professional Engineer and/or Land Surveyor

