

(SUBMIT IN TRIPLICATE)

APPROVED UNITED STATES

OCT 24 1962 DEPARTMENT OF THE INTERIOR
GEOLOGICAL SURVEY

JOHN DULETSKY
ACTING DISTRICT ENGINEER

Indian Agency _____
Fonnes _____
Allottee Navajo-Usr Non. Trib. _____
Lease No. 11-20-60-1951

SUNDRY NOTICES AND REPORTS ON WELLS

NOTICE OF INTENTION TO DRILL Water Supply Well X	SUBSEQUENT REPORT OF WATER SHUT-OFF
NOTICE OF INTENTION TO CHANGE PLANS	SUBSEQUENT REPORT OF SHOOTING OR ACIDIZING
NOTICE OF INTENTION TO TEST WATER SHUT-OFF	SUBSEQUENT REPORT OF ALTERING CASING
NOTICE OF INTENTION TO REDRILL OR REPAIR WELL	SUBSEQUENT REPORT OF REDRILLING OR REPAIR
NOTICE OF INTENTION TO SHOOT OR ACIDIZE	SUBSEQUENT REPORT OF ABANDONMENT
NOTICE OF INTENTION TO PULL OR ALTER CASING	SUPPLEMENTARY WELL HISTORY
NOTICE OF INTENTION TO ABANDON WELL	

(INDICATE ABOVE BY CHECK MARK NATURE OF REPORT, NOTICE, OR OTHER DATA)

October 23, 1962

Horseshoe Gallup Unit
Well No. 4-W is located 2370 ft. from XXN ^N line and 738 ft. from XXE ^E line of
NW SW/4 Sec. 34 31N 16-W N78W
(1/4 Sec. and Sec. No.) (Twp.) (Range) (Meridian)
Water Supply Well **San Juan** **New Mexico**
(Field) (County or Subdivision) (State or Territory)

The elevation of the derrick floor above sea level is 5370 ft.

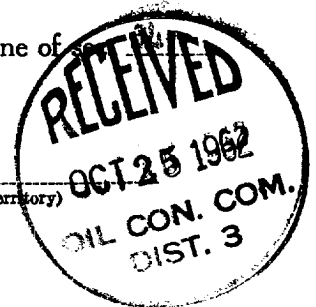

DETAILS OF WORK

(State names of and expected depths to objective sands; show sizes, weights, and lengths of proposed casings; indicate mudding jobs, cementing points, and all other important proposed work)

We propose to drill this water supply well to furnish injection water for the Horseshoe Gallup Unit Waterflood Project. Total depth will be approximately 2750' to penetrate 700' of Morrison Formation. 100' of 10 3/4" O.D. 32.75# casing will be set and cemented to surface. 7" O.D. 20# casing will be set to T.D. and cement brought above the Gallup producing sands. Completion will be through casing perforations in the Morrison. Stimulation probably will not be necessary. Estimated maximum water production from this well is 6500 B.P.D.

This well was included on the Plan of Development and Operation which was submitted July 25, 1962, and located in NW/4 Sec. 34

This well is located on Tract 20 as described in the Horseshoe Gallup Unit. The Atlantic Refining Company has contracted to acquire the working interest owned by R. H. Banner, John E. Banner and Alberta Banner in this tract. This working interest extends to the base of the Dakota Formation only.

I understand that this plan of work must receive approval in writing by the Geological Survey before operations may be commenced.

Company THE ATLANTIC REFINING COMPANY

Address P. O. BOX 2197

FARMINGTON, NEW MEXICO

By B. J. Sartain
Title Dir. & Prod. Supvr.

APPROVED SUBJECT TO APPROVAL BY THE APPROPRIATE INDIAN AGENCIES.

APPROVED

DATE: _____
BY: _____

NEW MEXICO OIL CONSERVATION COMMISSION

Well Location and Acreage Dedication Plat

Section A.

Date October 23, 1962

HORSESHOE GALLUP UNIT

Operator ATLANTIC REFINING COMPANY Lease NET NEUTRALIZED
 Well No. KOL 4-W Unit Letter L Section 34 Township 31 NORTH Range 16 WEST NMPM
 Located 2390 Feet From the SOUTH Line, 738 Feet From the WEST Line
 County SAN JUAN G. L. Elevation 5369.6 Dedicated Acreage ---- Acres
 Name of Producing Formation Morrison Water Source Pool ----

1. Is the Operator the only owner in the dedicated acreage outlined on the plat below?
 Yes _____ No X
2. If the answer to question one is "no", have the interests of all the owners been consolidated by communitization agreement or otherwise? Yes X No _____. If answer is "yes", Type of Consolidation.
HORSESHOE GALLUP UNIT SECONDARY RECOVERY PROJECT

3. If the answer to question two is "no", list all the owners and their respective interests below:

<u>Owner</u>	<u>Land Description</u>
--------------	-------------------------

RECEIVED

OCT 25 1962

U. S. GEOLOGICAL SURVEY
DURING 1960.

Section B.

Note: All distances must be from outer boundaries of section.

This is to certify that the information in Section A above is true and complete to the best of my knowledge and belief.

THE ATLANTIC REFINING CO.
 (Operator)
B. J. Bastain
 (Representative)
P. O. Box 2197
 (Address)
Farmington, N.M.

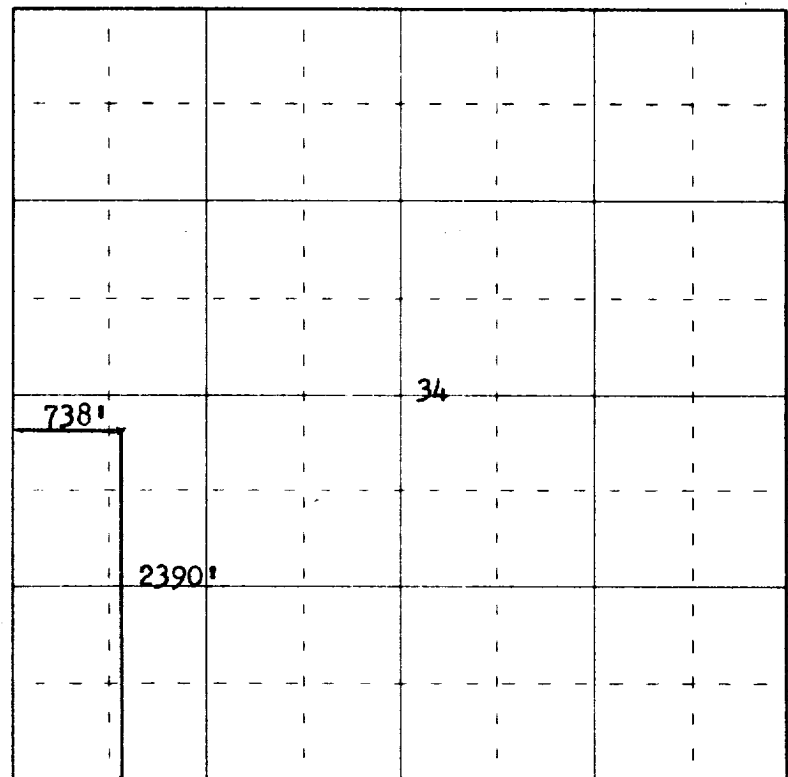

0 330 660 990 1320 1650 1980 2310 2640 2000 1500 1000 500 0

Scale 4 inches equal 1 mile

RECEIVED
 OCT 25 1962

This is to certify that the above plat was prepared from field notes of actual surveys made by me or under my supervision and that the same are true and correct to the best of my knowledge and belief.

Date Surveyed 21 September, 1962

James P. Leese
 Registered Professional Engineer and/or Land Surveyor
 James P. Leese N.Mex. Reg. No. 1463
 San Juan Engineering Co.