

(SUBMIT IN TRIPLICATE)

UNITED STATES  
DEPARTMENT OF THE INTERIOR  
GEOLOGICAL SURVEY

Indian Agency \_\_\_\_\_

Window Rock \_\_\_\_\_

Allottee Navajo Tribal

Lease No. 11-20-603-734

Budget Bureau No. 42-R359.4  
Approval expires 12-31-60.

SUNDRY NOTICES AND REPORTS ON WELLS

NOTICE OF INTENTION TO DRILL _____	SUBSEQUENT REPORT OF WATER SHUT-OFF _____
NOTICE OF INTENTION TO CHANGE PLANS _____	SUBSEQUENT REPORT OF SHOOTING OR ACIDIZING _____
NOTICE OF INTENTION TO TEST WATER SHUT-OFF _____	SUBSEQUENT REPORT OF ALTERING CASING _____
NOTICE OF INTENTION TO REDRILL OR REPAIR WELL _____	SUBSEQUENT REPORT OF REDRILLING OR REPAIR _____
NOTICE OF INTENTION TO SHOOT OR ACIDIZE _____	SUBSEQUENT REPORT OF ABANDONMENT _____
NOTICE OF INTENTION TO PULL OR ALTER CASING _____	SUPPLEMENTARY WELL HISTORY _____
NOTICE OF INTENTION TO ABANDON WELL _____	

(INDICATE ABOVE BY CHECK MARK NATURE OF REPORT, NOTICE, OR OTHER DATA)

April 21, 1959

Well No. 63 is located 1980 ft. from [N] line and 697 ft. from [W] line of sec. 31

34 W Sec. 31 31 W 16 W N.M.P.M.  
(1/4 Sec. and Sec. No.) (Twp.) (Range) (Meridian)

Horseshoe Gallup San Juan New Mexico  
(Field) (County or Subdivision) (State or Territory)

The elevation of the ground above sea level is 5196.7 ft.

DETAILS OF WORK

(State names of and expected depths to objective sands; show sizes, weights, and lengths of proposed casings; indicate mudding jobs, cementing points, and all other important proposed work)

We propose to drill a well at the above location to an approximate total depth of 1300' for completion in the Gallup formation. 100' of 8-5/8" O.D. casing will be set and cemented to surface. Should the well prove productive a 4-1/2" O.D. oil string will be used.

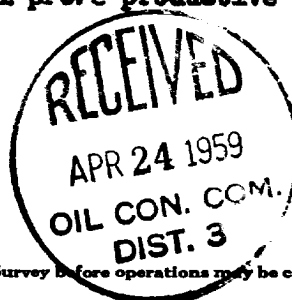

I understand that this plan of work must receive approval in writing by the Geological Survey before operations may be commenced.

Company The Atlantic Refining Company

Address P. O. Box 520

Casper, Wyoming

By [Signature]

Title Drilling Superintendent



## NEW MEXICO OIL CONSERVATION COMMISSION

Well Location and Acreage Dedication Plat

## Section A.

Date April 9, 1959

Operator THE ATLANTIC REFINING COMPANY Lease NAVAJO  
 Well No. 63 Unit Letter E Section 31 Township 31 NORTH Range 16 WEST NMPM  
 Located 1980 Feet From NORTH Line, 697 Feet From WEST Line  
 County SAN JUAN G. L. Elevation 5496.7 Dedicated Acreage 41.86 Acres  
 Name of Producing Formation Gallup Pool Horseshoe Gallup

1. Is the Operator the only owner in the dedicated acreage outlined on the plat below?  
 Yes ☒ No ☐
2. If the answer to question one is "no", have the interests of all the owners been consolidated by communitization agreement or otherwise? Yes ☐ No ☐ If answer is "yes", Type of Consolidation.

3. If the answer to question two is "no", list all the owners and their respective interests below:

OwnerLand Description

\_\_\_\_\_  
 \_\_\_\_\_  
 \_\_\_\_\_

\_\_\_\_\_  
 \_\_\_\_\_  
 \_\_\_\_\_

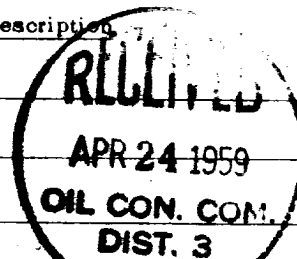

## Section B.

Note: All distances must be from outer boundaries of section.

This is to certify that the information in Section A above is true and complete to the best of my knowledge and belief.

The Atlantic Refining Company  
 (Operator)

A. D. Kloxin  
 (Representative)

P.O. Box 520  
 (Address)

Casper, Wyoming

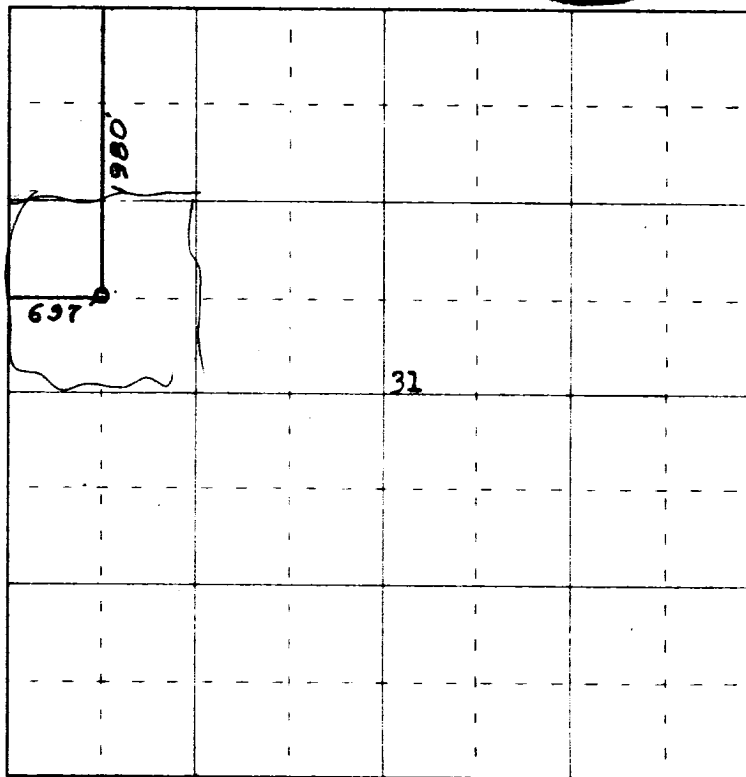

0 330 660 990 1320 1650 1980 2310 2640 2000 1500 1000 500 0

Scale 4 inches equal 1 mile

This is to certify that the above plat was prepared from field notes of actual surveys made by me or under my supervision and that the same are true and correct to the best of my knowledge and belief.

Date Surveyed 8 April 1959

James P. Lane  
 Registered Professional Engineer and/or Land Surveyor

