

(SUBMIT IN TRIPLICATE)

Indian Agency Navajo-Use Tribal  
Contract

UNITED STATES  
DEPARTMENT OF THE INTERIOR  
GEOLOGICAL SURVEY

Allottee \_\_\_\_\_  
Lease No. 14-20-604-1951

X			

SUNDRY NOTICES AND REPORTS ON WELLS

NOTICE OF INTENTION TO DRILL	<input checked="" type="checkbox"/>	SUBSEQUENT REPORT OF WATER SHUT-OFF	RECEIVED
NOTICE OF INTENTION TO CHANGE PLANS		SUBSEQUENT REPORT OF SHOOTING OR ACIDIZING	
NOTICE OF INTENTION TO TEST WATER SHUT-OFF		SUBSEQUENT REPORT OF ALTERING CASING	APR 23 1959
NOTICE OF INTENTION TO REDRILL OR REPAIR WELL		SUBSEQUENT REPORT OF REDRILLING OR REPAIR	
NOTICE OF INTENTION TO SHOOT OR ACIDIZE		SUBSEQUENT REPORT OF ABANDONMENT	U. S. GEOLOGICAL SURVEY
NOTICE OF INTENTION TO PULL OR ALTER CASING		SUPPLEMENTARY WELL HISTORY	
NOTICE OF INTENTION TO ABANDON WELL			

(INDICATE ABOVE BY CHECK MARK NATURE OF REPORT, NOTICE, OR OTHER DATA)

Well No. 13 is located 645 ft. from N line and 3170 ft. from E line of sec. 33  
NE NW/4 of Section 33 31N 16W NMPM  
(34 Sec. and Sec. No.) (Twp.) (Range) (Meridian)  
Horsehoe Gallup San Juan New Mexico  
(Field) (County or Subdivision) (State or Territory)

The elevation of the derrick floor above sea level is 5663 ft.

DETAILS OF WORK

(State names of and expected depths to objective sands; show sizes, weights, and lengths of proposed casings; indicate mudding jobs, cementing points, and all other important proposed work)

It is intended to drill a well through the Lower-Gallup Formation using rotary tools and mud circulation. Possible productive intervals will be perforated and sandell fractured. Estimated Total Depth 1630'.

Casing Program:

8-5/8" at 100' with 100 sacks cement circulated to surface.

5-1/2" at 1630' with 100 sacks cement.

The NE NW/4 of Section 33 is dedicated to this well.

NE NW/4 Section 33 Navajo-Use 14-20-604-1951



I understand that this plan of work must receive approval in writing by the Geological Survey before operations may be commenced.  
 Company El Paso Natural Gas Products Company

Address Post Office Box 1545  
Farmington, New Mexico

ORIGINAL SIGNED BY: WILLIAM K. GLAENER  
 By \_\_\_\_\_  
 Title Petroleum Engineer



NEW MEXICO OIL CONSERVATION COMMISSION

Well Location and Acreage Dedication Plat

Section A.

Date April 21, 1959

Operator El Paso Natural Gas Products Company Lease Horseshoe Ute Navajo-Ute  
Well No. 13 Unit Letter 33 Section 33 Township 31 North Range 16 West NMP  
Located 645 Feet From North Line, 3170 Feet From East Line  
County San Juan G. L. Elevation 5656 Dedicated Acreage 33 Acres  
Name of Producing Formation Gallup Pool Horseshoe-Ute

1. Is the operator the only owner\* in the dedicated acreage outlined on the plat below?  
Yes X No       .
2. If the answer to question one is "no," have the interests of all the owners been consolidated by communitization agreement or otherwise? Yes        No       . If answer is "yes,"  
Type of Consolidation
3. If the answer to question two is "no," list all the owners and their respective interests below:

Owner

Land Description

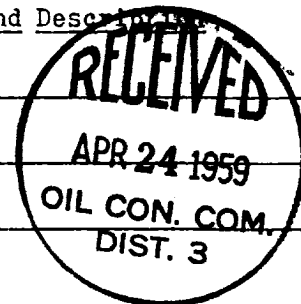

Section. B

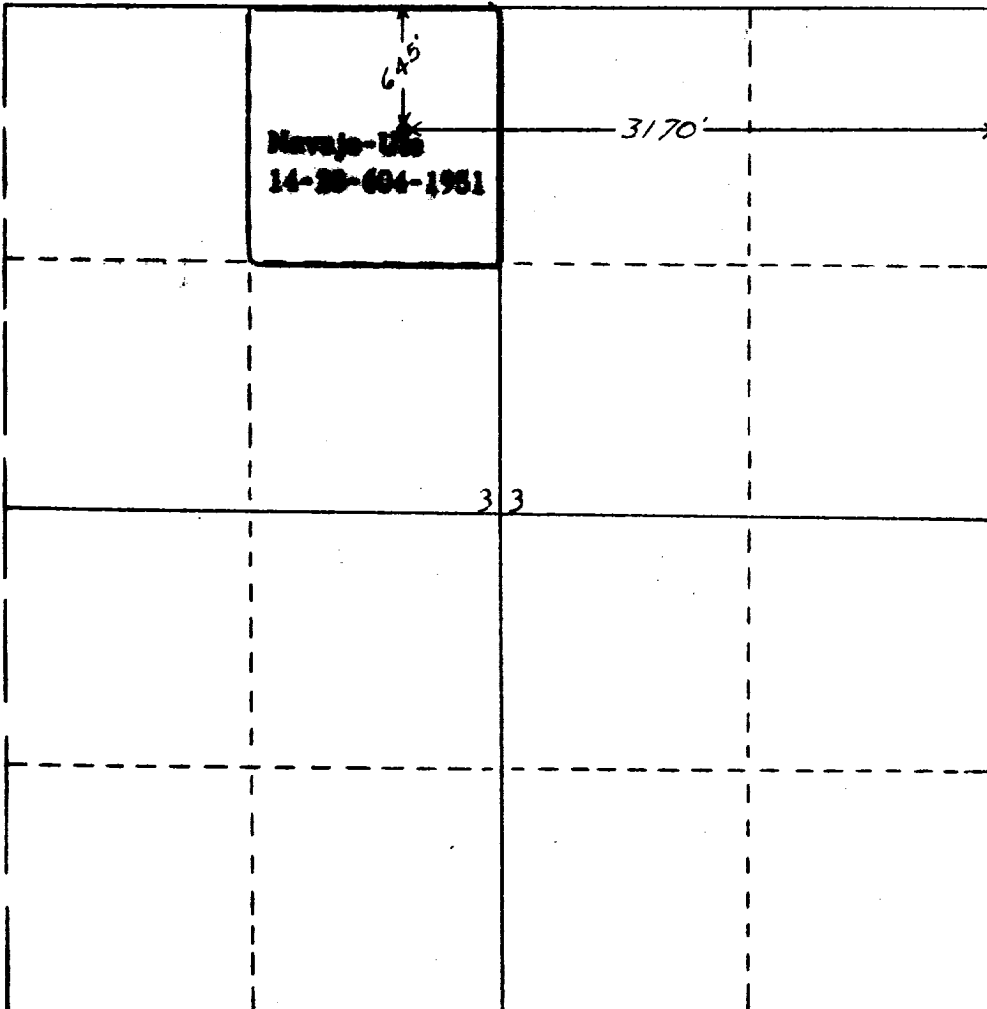

This is to certify that the information in Section A above is true and complete to the best of my knowledge and belief.

El Paso Natural Gas Products Co.

(Operator)

William K. Glynn  
(Representative)

Box 1565, Farmington, New Mexico

Address

This is to certify that the well located on the plat in Section B was located from field notes of actual surveys made by me or under my supervision and that the same is true and correct to the best of my knowledge and belief.

Date Surveyed April 14, 1959

Ernest V. Echoshawk  
Ernest V. Echoshawk  
Registered Land Surveyor.

Certificate No. 1545

X		

(SUBMIT IN TRIPLICATE)

UNITED STATES  
DEPARTMENT OF THE INTERIOR  
GEOLOGICAL SURVEY

Indian Agency Navajo Ute Tribal  
Contract \_\_\_\_\_  
Allottee \_\_\_\_\_  
Lease No. 14-20-604-1951

SUNDRY NOTICES AND REPORTS ON WELLS

NOTICE OF INTENTION TO DRILL.....	SUBSEQUENT REPORT OF WATER SHUT-OFF.....	X
NOTICE OF INTENTION TO CHANGE PLANS.....	SUBSEQUENT REPORT OF SHOOTING OR ACIDIZING.....	
NOTICE OF INTENTION TO TEST WATER SHUT-OFF.....	SUBSEQUENT REPORT OF ALTERING CASING.....	
NOTICE OF INTENTION TO REDRILL OR REPAIR WELL.....	SUBSEQUENT REPORT OF REDRILLING OR REPAIR.....	
NOTICE OF INTENTION TO SHOOT OR ACIDIZE.....	SUBSEQUENT REPORT OF ABANDONMENT.....	
NOTICE OF INTENTION TO PULL OR ALTER CASING.....	SUPPLEMENTARY WELL HISTORY.....	
NOTICE OF INTENTION TO ABANDON WELL.....		

(INDICATE ABOVE BY CHECK MARK NATURE OF REPORT, NOTICE, OR OTHER DATA)

May 14 MAY 14 1959

**Horseshoe Ute**  
Well No. 13 is located 645 ft. from N line and 3170 ft. from E line of sec. 33  
NE NW/4 Section 33 31N 16W NMPM  
( $\frac{1}{4}$  Sec. and Sec. No.) (Twp.) (Range) (Meridian)  
**Horseshoe Gallup** **San Juan** **New Mexico**  
(Field) (County or Subdivision) (State or Territory)

The elevation of the derrick floor above sea level is 5663 ft.

DETAILS OF WORK

(State names of and expected depths to objective sands; show sizes, weights, and lengths of proposed casings; indicate mudding jobs, cementing points, and all other important proposed work)

Spud Date 5-9-59. 5-10-59 Total Depth 170'.

Ran 4 joints 7-5/8", 26.40#, J-55 Csg. ( 156.75' ) set at 164.75' with 125 sacks regular cement, 2% CaCl<sub>2</sub> circulated to surface. Held 500#/30 Minutes.

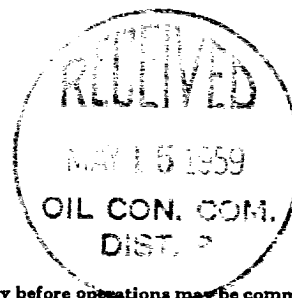

I understand that this plan of work must receive approval in writing by the Geological Survey before operations may be commenced.

Company El Paso Natural Gas Products Company

Address Post Office Box 1565

Farmington, New Mexico

By \_\_\_\_\_

Title Petroleum Engineer