

(SUBMIT IN TRIPLICATE)

Indian Agency Navajo-Ute Tribal

UNITED STATES
DEPARTMENT OF THE INTERIOR
GEOLOGICAL SURVEY

Allottee _____
Lease No. 14-20-604-1951

	X	

SUNDRY NOTICES AND REPORTS ON WELLS

NOTICE OF INTENTION TO DRILL.....	<input checked="" type="checkbox"/>	SUBSEQUENT REPORT OF WATER SHUT-OFF.....	
NOTICE OF INTENTION TO CHANGE PLANS.....		SUBSEQUENT REPORT OF SHOOTING OR ACIDIZING.....	
NOTICE OF INTENTION TO TEST WATER SHUT-OFF.....		SUBSEQUENT REPORT OF ALTERING CASING.....	
NOTICE OF INTENTION TO REDRILL OR REPAIR WELL.....		SUBSEQUENT REPORT OF REDRILLING OR REPAIR.....	
NOTICE OF INTENTION TO SHOOT OR ACIDIZE.....		SUBSEQUENT REPORT OF ABANDONMENT.....	
NOTICE OF INTENTION TO PULL OR ALTER CASING.....		SUPPLEMENTARY WELL HISTORY.....	
NOTICE OF INTENTION TO ABANDON WELL.....			

(INDICATE ABOVE BY CHECK MARK NATURE OF REPORT, NOTICE, OR OTHER DATA)

August 24, 1959

Horseshoe-Ute

Well No. 22 is located 1980 ft. from NE line and 1980 ft. from E line of sec. 28

NW SE/4 Section 28
(1/4 Sec. and Sec. No.)

31N
(Twp.)

16W
(Range)

NMPM
(Meridian)

Horseshoe Gallup
(Field)

San Juan
(County or Subdivision)

New Mexico
(State or Territory)

The elevation of the derrick floor above sea level is 5760 ft.

DETAILS OF WORK

(State names of and expected depths to objective sands; show sizes, weights, and lengths of proposed casings; indicate mudding jobs, cementing points, and all other important proposed work)

It is intended to drill a well through the Lower-Gallup Formation using rotary tools and mud circulation. Possible productive intervals will be perforated and sandoil fractured. Estimated Total Depth 1770'.

Casing Program:

8-5/8" at 100' with 100 sacks cement circulated to surface.

5-1/2" at 1770' with 100 sacks cement.

The NW SE/4 of Section 28 is dedicated to this well.

NW SE/4 Section 28 Navajo-Ute Tribal 14-20-604-1951

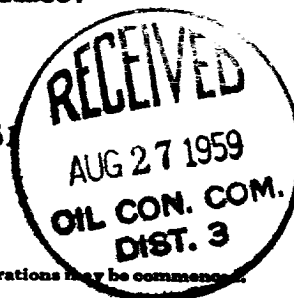

I understand that this plan of work must receive approval in writing by the Geological Survey before operations may be commenced.

Company El Paso Natural Gas Products Company

Address Post Office Box 1565
Farmington, New Mexico

ORIGINAL SIGNED BY: WILLIAM K. GLAZENER

By _____

Title Petroleum Engineer



U. A. 3-21-59 10 00 AM 340000

NEW MEXICO OIL CONSERVATION COMMISSION

Well Location and Acreage Dedication Plat

Section A.

Date August 24, 1959

Operator El Paso Natural Gas Products Company Lease Horseshoe- Ute Navajo-Ute Tribal Contract
14-20-604-1951
Well No. 22 Unit Letter I Section 28 Township 31 North Range 16 West NMPN
Located 1980' Feet From South Line, 1980' Feet From East Line
County San Juan G. L. Elevation 5753 Dedicated Acreage 40 Acres
Name of Producing Formation Gallup Pool Horseshoe Gallup

1. Is the Operator the only owner* in the dedicated acreage outlined on the plat below?
Yes X No
2. If the answer to question one is "no," have the interests of all the owners been consolidated by communitization agreement or otherwise? Yes No . If answer is "yes,"
Type of Consolidation
3. If the answer to question two is "no," list all the owners and their respective interests below:

Owner

Land Description

Section. B

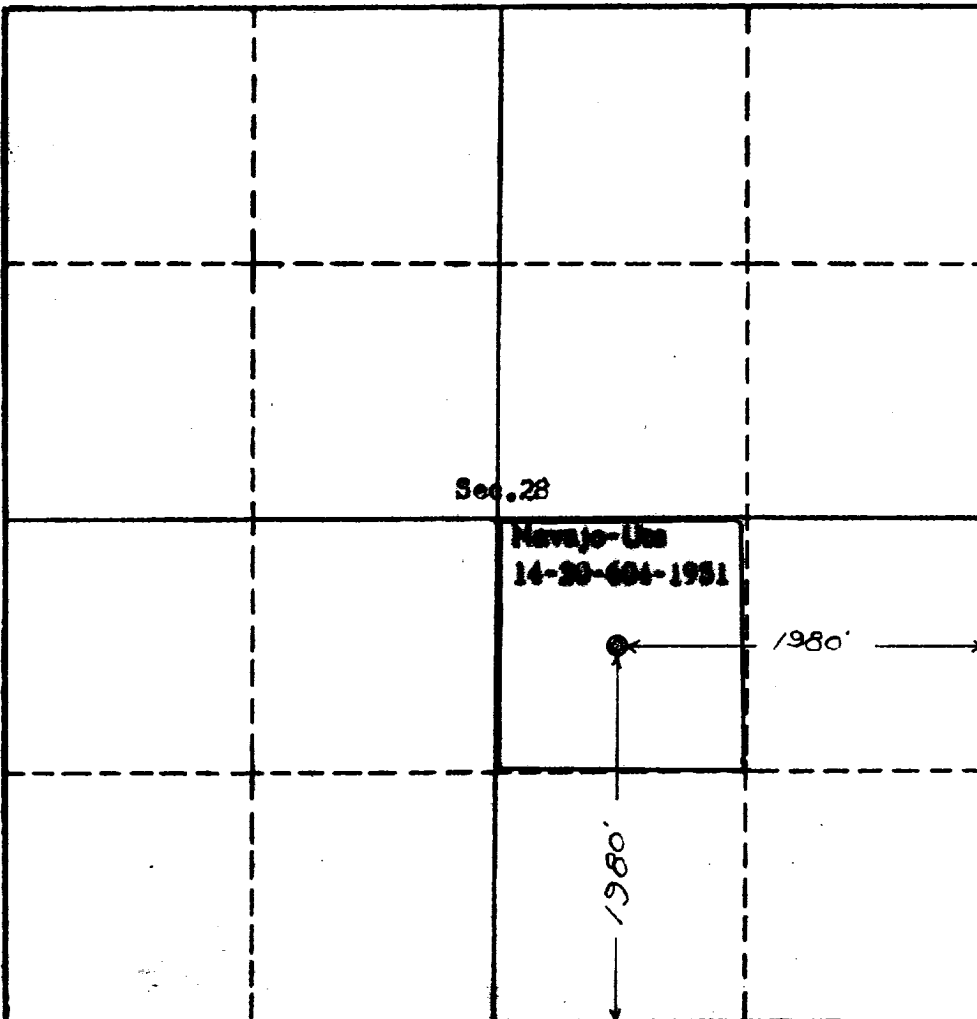

This is to certify that the information in Section A above is true and complete to the best of my knowledge and belief.

El Paso Natural Gas Products Co.

(Operator)

William K. Higgins
(Representative)

Box 1545, Farmington, New Mexico

Address

This is to certify that the well location on the plat in Section B is located from field notes of a survey made by me or under my supervision and that the same is true to the best of my knowledge and belief.

Date Surveyed August 17, 1959

Ernest V. Echobawk
Ernest V. Echobawk
Registered Land Surveyor.

Certificate No. 1545

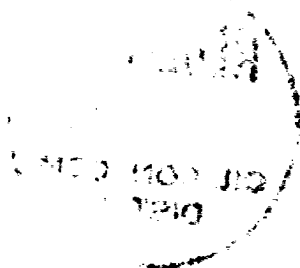

1

1