

## NEW MEXICO OIL CONSERVATION COMMISSION

## Well Location and Acreage Dedication Plat

Section A.

Date **November 17, 1958**

Operator **EL PASO NATURAL GAS PRODUCTS CO.** Lease **CHIMNEY ROCK, NAVAJO**  
 Well No. **1** Unit Letter **P** Section **24** Township **31 NORTH** Range **17 WEST**, NMPM  
 Located **660** Feet From **THE SOUTH** Line, **660** Feet From **THE EAST** Line  
 County **SAN JUAN** G. L. Elevation **5748.0** Dedicated Acreage **40** Acres  
 Name of Producing Formation **Gallup** Pool **Undesignated**

1. Is the Operator the only owner in the dedicated acreage outlined on the plat below?

Yes **X** No

2. If the answer to question one is "no", have the interests of all the owners been consolidated by communitization agreement or otherwise? Yes No If answer is "yes", Type of Consolidation.

Ref: S.J.E. Plat dated 15 Nov. 1958

3. If the answer to question two is "no", list all the owners and their respective interests below:

Owner

Land Description

Section B.

This is to certify that the information  
 in Section A above is true and complete  
 to the best of my knowledge and belief.

El Paso Natural Gas Products Co.

(Operator)  
**ORIGINAL SIGNED BY: JOSEPH E. KREGER**

(Representative)

Post Office Box 1565

(Address)

Farmington, New Mexico



RECEIVED

NOV 19 1958

U.S. GEOLOGICAL SURVEY  
ALBUQUERQUE, NEW MEXICO

Note: All distances must be from outer boundaries of Section

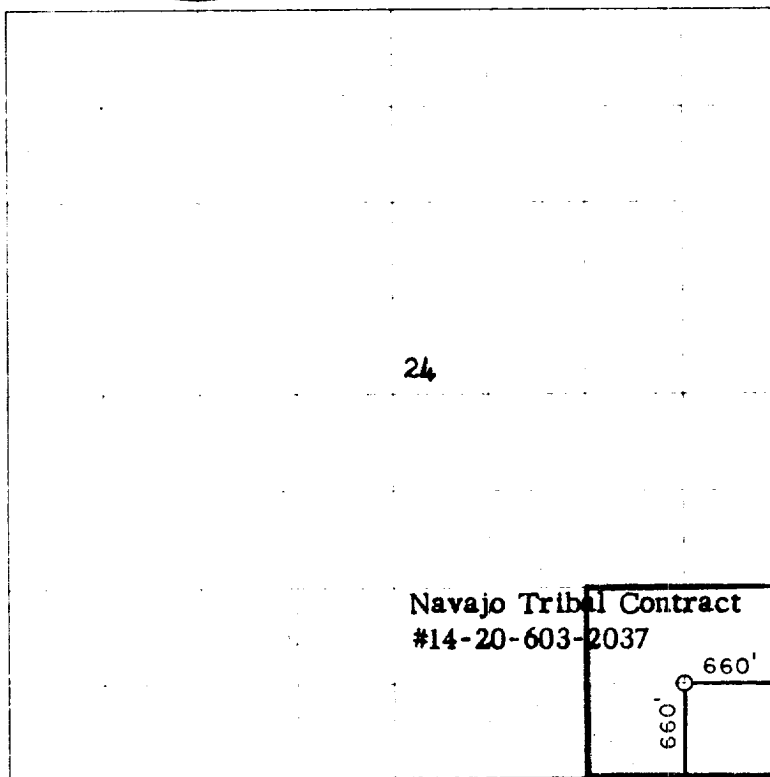

0 40 80 120 160 195 230 260 2000 1500 1000 500

Scale 4 inches equal 1 mile

This is to certify that the above plat was prepared from field notes of actual surveys made by me or under my supervision and that the same are true and correct to the best of my knowledge and belief.

Date Surveyed **15 November 1958**

*James P. Leese*  
 Registered Professional Engineer and/or Land Surveyor  
 James P. Leese, N. Mex. Reg. No. 1463



Farmington, New Mexico