

Form 9-331b  
(April 1952)

(SUBMIT IN TRIPLICATE)

Indian Agency **The Mountain**

UNITED STATES  
DEPARTMENT OF THE INTERIOR  
GEOLOGICAL SURVEY

Allottee \_\_\_\_\_

Lease No. **14-22-604-22**

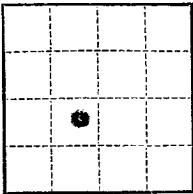

SUNDRY NOTICES AND REPORTS ON WELLS

NOTICE OF INTENTION TO DRILL _____	<input checked="" type="checkbox"/>	SUBSEQUENT REPORT OF WATER SHUT-OFF _____	
NOTICE OF INTENTION TO CHANGE PLANS _____		SUBSEQUENT REPORT OF SHOOTING OR ACIDIZING _____	
NOTICE OF INTENTION TO TEST WATER SHUT-OFF _____		SUBSEQUENT REPORT OF ALTERING CASING _____	
NOTICE OF INTENTION TO REDRILL OR REPAIR WELL _____		SUBSEQUENT REPORT OF REDRILLING OR REPAIR _____	
NOTICE OF INTENTION TO SHOOT OR ACIDIZE _____		SUBSEQUENT REPORT OF ABANDONMENT _____	
NOTICE OF INTENTION TO PULL OR ALTER CASING _____		SUPPLEMENTARY WELL HISTORY _____	
NOTICE OF INTENTION TO ABANDON WELL _____			

**RECEIVED**  
**JUN 24 1958**  
**U. S. GEOLOGICAL SURVEY**  
**FARMINGTON, NEW MEXICO**

(INDICATE ABOVE BY CHECK MARK NATURE OF REPORT, NOTICE, OR OTHER DATA)

**June 20,** 19 **58**

Well No. **14-22-604-22** is located **1900** ft. from **N** line and **1900** ft. from **W** line of sec. **20**  
**NE/4, Section 20** (1/4 Sec. and Sec. No.) **11-N** (Twp.) **14-W** (Range) **N.M.P.M.** (Meridian)  
**Woods-Gallup** (Field) **San Juan** (County or Subdivision) **New Mexico** (State or Territory)

The elevation of the derrick floor above sea level is \_\_\_\_\_ ft.

DETAILS OF WORK

(State names of and expected depths to objective sands; show sizes, weights, and lengths of proposed casings; indicate mudding jobs, cementing points, and all other important proposed work)

Propose to: Set 30' of 10 1/2" casing with 100 sacks cement. Drill to approximately 2950'. Set 5 1/2" casing at 2950' and cement with 50 sacks, set two-stage cement collar below oilstone marker, approximately 2950', and cement to base of Point Lobos formation with 50 sacks cement. Drill to total depth of 3050'. Shut-off free open hole with 40,000 gallons oil 40,000 lbs. sand. Install 2 1/8" tubing, rods and pump.

I understand that this plan of work must receive approval in writing by the Geological Survey before operations may be commenced

Company **AMERIC OIL & GAS COMPANY**  
Address **P O Box 706**  
**Farmington, New Mexico**

By **Joe C. Salmon**  
**Joe C. Salmon**  
Title **District Superintendent**

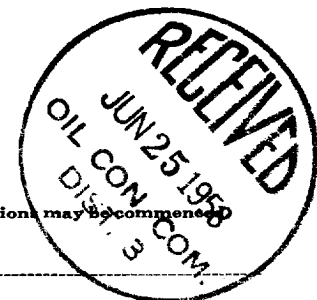



NEW MEXICO OIL CONSERVATION COMMISSION

Well Location and Acreage Dedication Plat

Section A.

Date June 22, 1958

Operator Aztec Oil and Gas Company Lease Ute-Indian  
Well No. 2-5 Unit Letter \_\_\_\_\_ Section 20 Township 31 North Range 14 West NMPM  
Located 1980 Feet From South Line, 1980 Feet From West Line  
County San Juan G. L. Elevation 5657 Dedicated Acreage 40 Acres  
Name of Producing Formation Lower Gallup Pool Verde-Gallup

1. Is the Operator the only owner\* in the dedicated acreage outlined on the plat below?  
Yes ☒ No \_\_\_\_\_
2. If the answer to question one is "no," have the interests of all the owners been consolidated by communitization agreement or otherwise? Yes \_\_\_\_\_ No \_\_\_\_\_. If answer is "yes,"  
Type of Consolidation \_\_\_\_\_
3. If the answer to question two is "no," list all the owners and their respective interests below:

Owner

Land Description

Section B

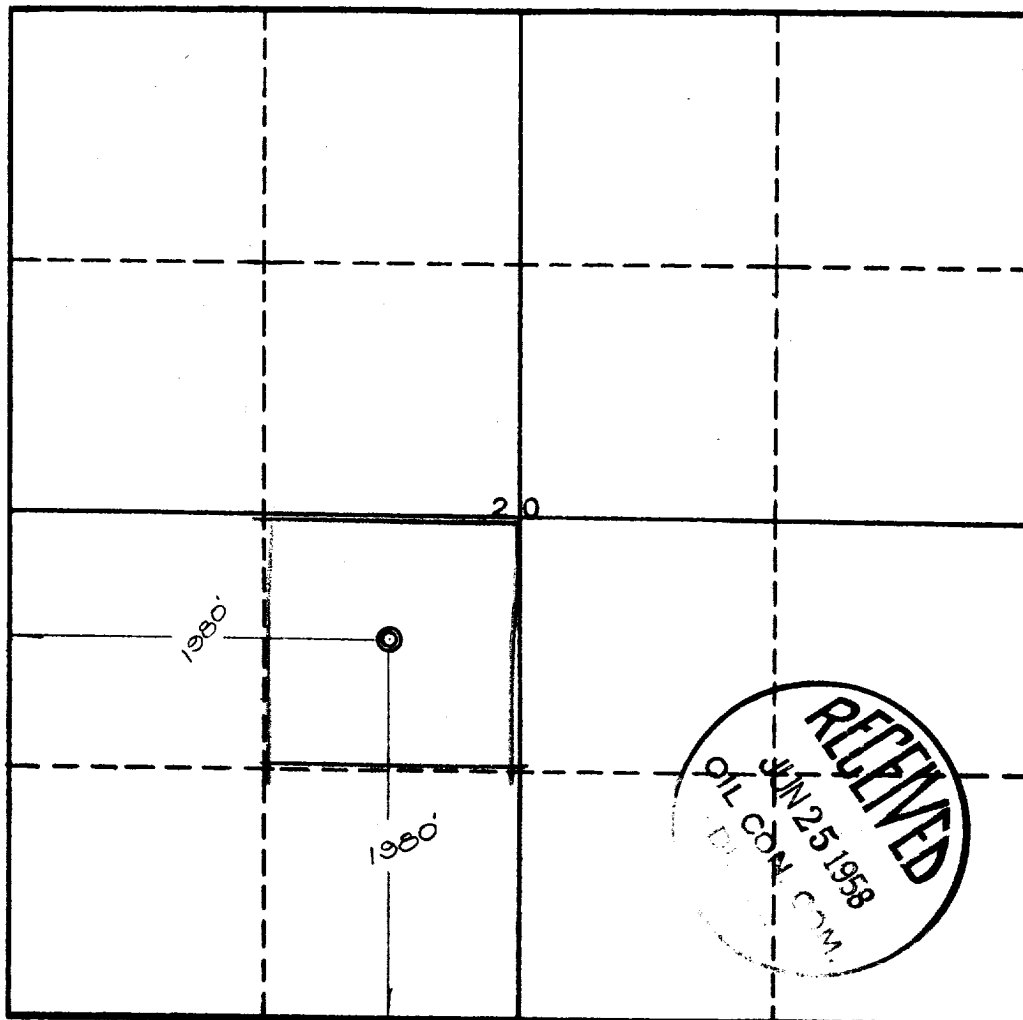

This is to certify that the information in Section A above is true and complete to the best of my knowledge and belief.

AMERCO OIL & GAS COMPANY

(Operator)

Joe C. Salmon  
(Representative)

Box 786, Farmington, N.M.

Address

This is to certify that the well location shown on the plat in Section B was taken from field notes of actual surveys made by me or under my supervision and that the same is true to the best of my knowledge and belief.

Date Surveyed April 7, 1958

Ernest V. Echohawk  
Ernest V. Echohawk  
Registered Land Surveyor.

Certificate No. 1545

