

(SUBMIT IN TRIPLICATE)

UNITED STATES
DEPARTMENT OF THE INTERIOR
GEOLOGICAL SURVEY

Budget Bureau 42-R353.3
~~Ute Mountain~~
Tribal Lands
Land Office
Contract **14-20-604-87**
Lease No. _____
Unit _____

SUNDRY NOTICES AND REPORTS ON WELLS

NOTICE OF INTENTION TO DRILL	XX	SUBSEQUENT REPORT OF WATER SHUT-OFF
NOTICE OF INTENTION TO CHANGE PLANS		SUBSEQUENT REPORT OF SHOOTING OR CASING
NOTICE OF INTENTION TO TEST WATER SHUT-OFF		SUBSEQUENT REPORT OF ALTERING CASING
NOTICE OF INTENTION TO RE-DRILL OR REPAIR WELL		SUBSEQUENT REPORT OF RE-DRILLING OR REPAIR
NOTICE OF INTENTION TO SHOOT OR ACIDIZE		SUBSEQUENT REPORT OF ABANDONMENT
NOTICE OF INTENTION TO PULL OR ALTER CASING		SUPPLEMENTARY WELL HISTORY
NOTICE OF INTENTION TO ABANDON WELL		

(INDICATE ABOVE BY CHECK MARK NATURE OF REPORT, NOTICE, OR OTHER DATA)

July 30, 1956

Ute Mountain Tribe "A"
Well No. **2** is located **1980** ft. from **31N** line and **660** ft. from **15W** line of sec. **21**
NW SW Sec 21 (1/4 Sec. and Sec. No.)
S.W. Barker Dome (Field)
San Juan County (County or Subdivision)
New Mexico (State or Territory)

The elevation of the derrick floor above sea level is **5692** ft. **GL 5685**

DETAILS OF WORK

(State names of and expected depths to objective sands; show sizes, weights, and lengths of proposed casings; indicate mudding jobs, cementing points, and all other important proposed work)

We propose to drill a well at the above location through the **Tocito** formation anticipated at a depth of **1940'** to an approximate TD of **2100'**. We will set and cement to the surface **120'**, **8-5/8"**, **24# J-55** casing and approximately **2300'**, **4-1/2"**, **9.50# J-55** casing will be set through the **Tocito** with **100** sacks, perforated at the proper interval, and sand fraced.

Electrical surveys will be run to total depth.

All work will be done in accordance with the Rules and Regulations of the U.S.G.S. and New Mexico Oil and Gas Conservation Commission.

I understand that this plan of work must receive approval in writing by the Geological Survey before operations may be commenced.

Company **Tennessee Gas Transmission Company**

Address **Box 1772**

Casper, Wyoming

Original Signed By:
PAT LAY

By _____

Title **Pat Lay, District Superintendent**



— —

11
12
13
14

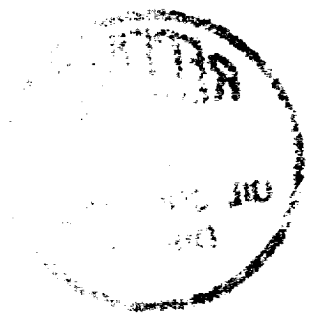

NEW MEXICO
OIL CONSERVATION COMMISSION

Form C-128

Well Location and/or Gas Proration Plat

Date 8-2-56

Operator **TENNESSEE GAS TRANSMISSION CO** Lease **UTE MOUNTAIN TRIBE "A"**
Well No. **2** Section **21** Township **31 North** Range **15 West** NMPM
Located **1980** Feet From **south** Line, **660** Feet From **west** Line.
San Juan County, New Mexico, G. L. Elevation **5689**
Name of Producing Formation **Tecito** Pool **57** Dedicated Acreage **--**

(Note: All distances must be from outer boundaries of Section)

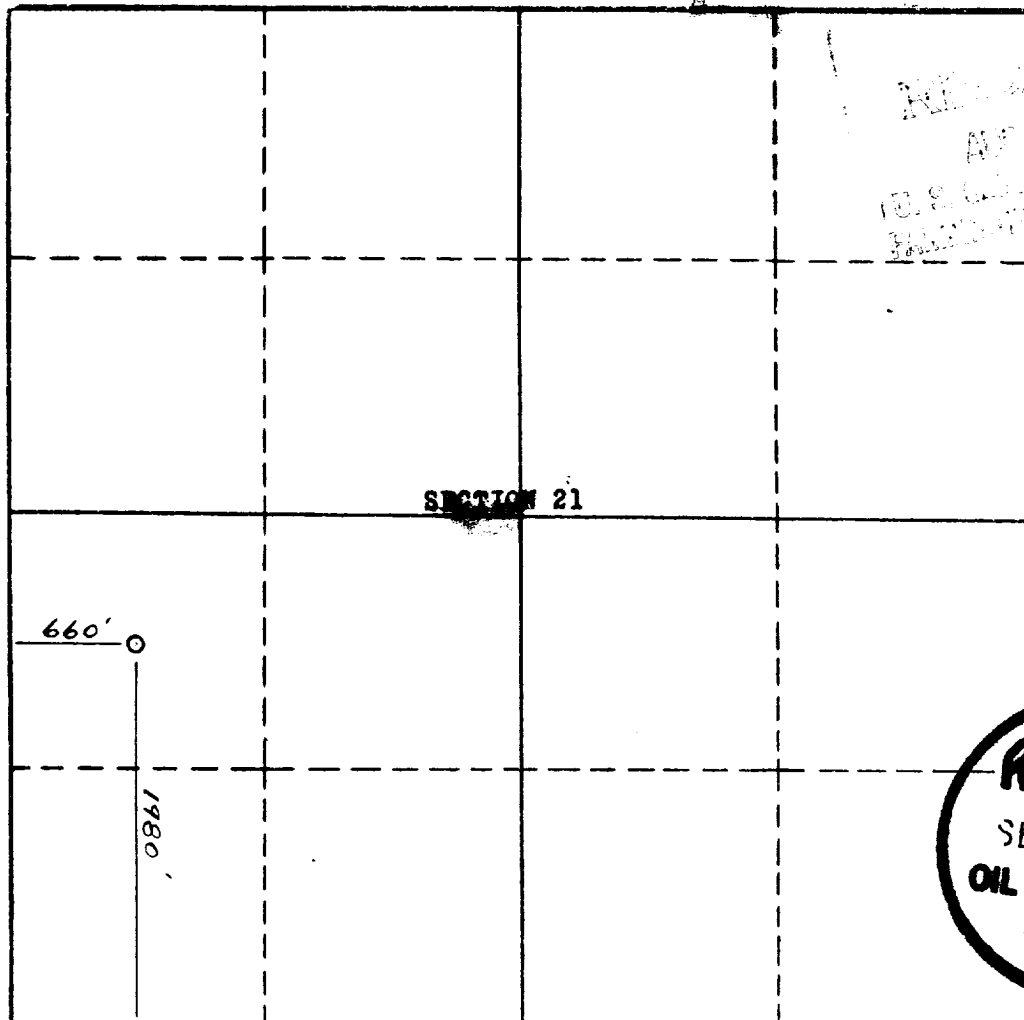

Scale—1 Inch Equals 1000 Feet

1. Is this Well a Dual Comp.? Yes ☐ No ☒ xx
2. If the answer to Question 1 is yes, are there any other dually completed wells within the dedicated acreage? Yes ☐ No ☒

Name **Stephen H. Kinney**
Position **Dist. Eng., District Superintendent**
Representing **Tennessee Gas Transmission Co.**
Address **Box 1572, Casper, Wyoming**

This is to certify that the above plat was prepared from field notes of actual surveys made by me or under my supervision and that the same are true and correct to the best of my knowledge and belief.

Date Surveyed **July 21, 1956**

Stephen H. Kinney

STEPHEN H. KINNEY,
Registered Professional Engineer and Land Surveyor

