

Form 9-331b
(April 1952)

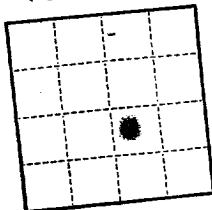

(SUBMIT IN TRIPLICATE)

UNITED STATES
DEPARTMENT OF THE INTERIOR
GEOLOGICAL SURVEY

Indian Agency

Allottees

Lease No. _____

SUNDRY NOTICES AND REPORTS ON WELLS

SUNDRY NOTICES AND REPORTS ON WELL	
NOTICE OF INTENTION TO DRILL	SUBSEQUENT REPORT OF WATER SHUT-OFF
NOTICE OF INTENTION TO CHANGE PLANS	SUBSEQUENT REPORT OF SHOOTING OR ACIDIZING
NOTICE OF INTENTION TO TEST WATER SHUT-OFF	SUBSEQUENT REPORT OF ALTERING CASING
NOTICE OF INTENTION TO REDRILL OR REPAIR WELL	SUBSEQUENT REPORT OF REDRILLING OR REPAIR
NOTICE OF INTENTION TO SHOOT OR ACIDIZE	SUBSEQUENT REPORT OF ABANDONMENT
NOTICE OF INTENTION TO PULL OR ALTER CASING	SUPPLEMENTARY WELL HISTORY
NOTICE OF INTENTION TO ABANDON WELL	

(INDICATE ABOVE BY CHECK MARK NATURE OF REPORT, NOTICE, OR OTHER DATA)

19

BANDON WELL

(INDICATE ABOVE BY CHECK MARK NATURE OF REPORT, NOTICE, OR OTHER DATA)

Well No. _____ is located _____ ft. from _____ line and _____ ft. from _____ line of sec _____ (Meridian) _____

($\frac{1}{4}$ Sec. and Sec. No.)

(Twp.)

(Range)

(Meridian)

(State or Territory)

The elevation of the derrick floor above sea level is _____ ft.

DETAILS OF WORK

DETAILS OF WORK

The elevation of the derrick floor above sea

DETAILS OF WORK

(State names of and expected depths to objective sands; show sizes, weights, and lengths of proposed casings; indicate mudding jobs, cementing points, and all other important proposed work)

[illegible]

I understand that this plan of work must receive approval in writing by the Geological Survey before operations may be commenced.

P. S. Holden

Company

Address

B:

Title

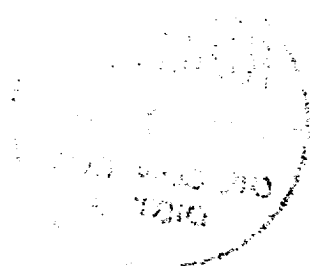

Form 9-331b
(April 1952)

(SUBMIT IN TRIPLICATE)

Indian Agency ~~Consolidated~~ **San Juan**
Agency, ~~Ignacio, Colorado~~
Allottee **The Navajo Tribe**
Lease No. **14-20-404-110**

UNITED STATES
DEPARTMENT OF THE INTERIOR
GEOLOGICAL SURVEY

SUNDRY NOTICES AND REPORTS ON WELLS

NOTICE OF INTENTION TO DRILL		SUBSEQUENT REPORT OF WATER SHUT-OFF	
NOTICE OF INTENTION TO CHANGE PLANS		SUBSEQUENT REPORT OF SHOOTING OR ACIDIZING	
NOTICE OF INTENTION TO TEST WATER SHUT-OFF		SUBSEQUENT REPORT OF ALTERING CASING	
NOTICE OF INTENTION TO REDRILL OR REPAIR WELL		SUBSEQUENT REPORT OF REDRILLING OR REPAIR	
NOTICE OF INTENTION TO SHOOT OR ACIDIZE		SUBSEQUENT REPORT OF ABANDONMENT	
NOTICE OF INTENTION TO PULL OR ALTER CASING		SUPPLEMENTARY WELL HISTORY	
NOTICE OF INTENTION TO ABANDON WELL			

(INDICATE ABOVE BY CHECK MARK NATURE OF REPORT, NOTICE, OR OTHER DATA)

June 24, 1959

Well No. **14-20-404-110** is located **1900** ft. from **[S]** line and **1900** ft. from **[E]** line of sec. **19**
SW/4 NE/4 section 19 **T11N** **R14E** **S20W**
(1/4 Sec. and Sec. No.) (Twp.) (Range) (Meridian)
Navajo **San Juan County** **New Mexico**
(Field) (County or Subdivision) (State or Territory)

The elevation of the derrick floor above sea level is **5413** ft.

DETAILS OF WORK

(State names of and expected depths to objective sands; show sizes, weights, and lengths of proposed casings; indicate mudding jobs, cementing points, and all other important proposed work)

It is proposed to drill with rotary tools to a depth of 1000 feet, run 8 1/8 casing and cement to surface with 100 cas. Thereafter to drill with rotary to the top of the fractured Gallup producing zone, estimated at 9500, run electric log and run 2 1/2 casing with a 2-stage IV cementing tool. It is proposed to cement the first stage with 30 cas and to cement the second stage with 30 cas to be followed by a temperature survey in order to determine cement fill-up. It is proposed to place the IV tool approximately 100 feet below the base of the Point Lookout formation. After waiting a minimum of 24 hours on cement, it is proposed to drill to with rotary using oil as drilling fluid and then run through casing with 65,000 gallons of cement and then run tubing and pump until daily rate of production is established after recovering from oil. The SW/4 NE/4 of the section, containing 60 acres more or less, is dedicated to the well site. Estimated total depth, 2,100 feet.

I understand that this plan of work must receive approval in writing by the Geological Survey before operations may be commenced.

Company **PERCUTAN CORPORATION**
Address **P. O. Box 1413**
Albuquerque, New Mexico

By **James E. Holdeman**
James E. Holdeman
District Geologist
Title

NEW MEXICO OIL CONSERVATION COMMISSION
Well Location and Acreage Dedication Plat

Section A.

Date June 24, 1959

Operator PUBCO PETROLEUM CO. Lease UTE MOUNTAIN
Well No. 19-10 Unit Letter J Section 19 Township 31 N Range 14 W NMPM
Located 1980 Feet From south Line, 1980 Feet From east Line
County San Juan G. L. Elevation 5612 Dedicated Acreage NW/4 SE/4 40 Acres
Name of Producing Formation Gallup Pool Verde-Gallup

1. Is the Operator the only owner* in the dedicated acreage outlined on the plat below?
Yes X No .
2. If the answer to question one is "no," have the interests of all the owners been consolidated by communitization agreement or otherwise? Yes No . If answer is "yes," Type of Consolidation
3. If the answer to question two is "no," list all the owners and their respective interests below:

Owner

Land Description

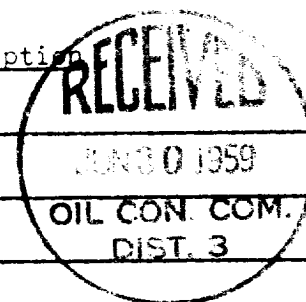

Section B

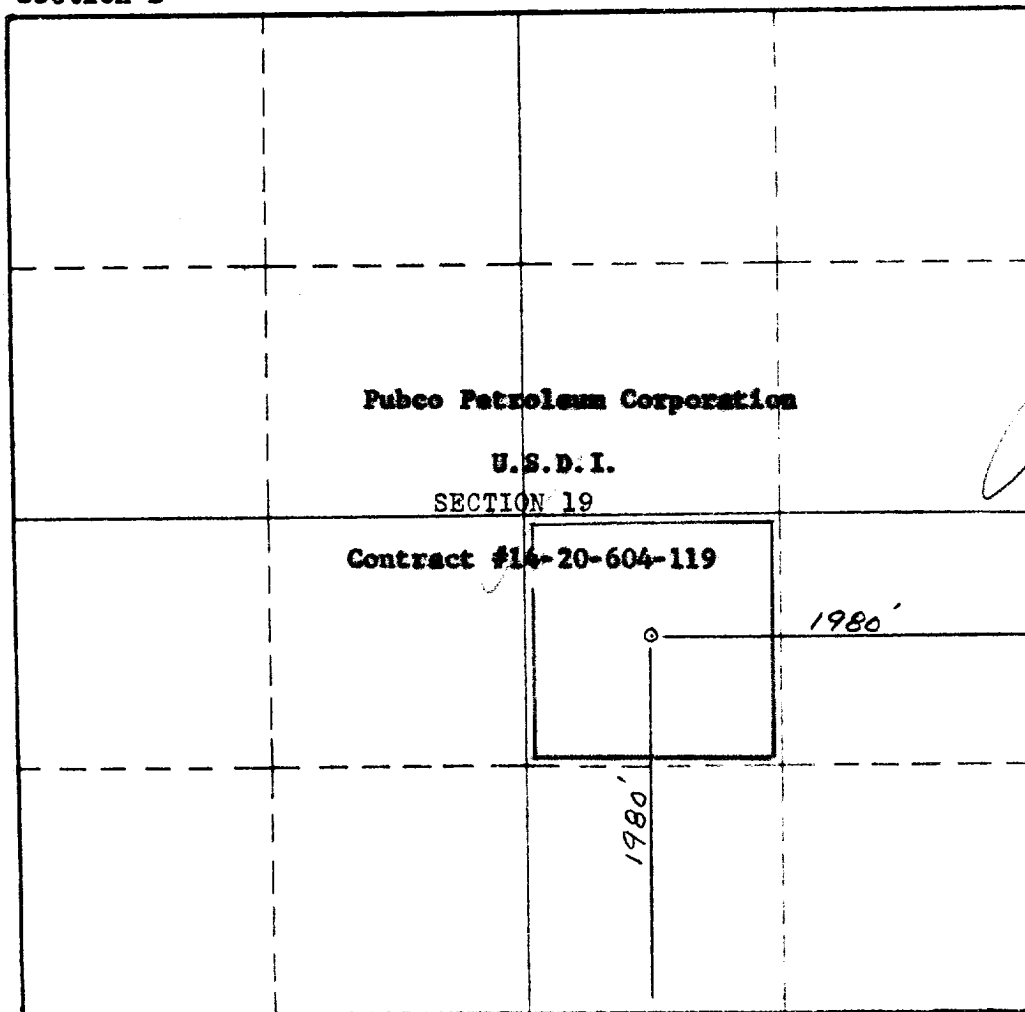

This is to certify that the information in Section A above is true and complete to the best of my knowledge and belief.

PUBCO PETROLEUM CORPORATION

(Operator)

James E. Holdeman
(Representative)

James E. Holdeman, Dis. Geol.

Post Office Box 1419

Address

Albuquerque, New Mexico

This is to certify that the well location shown on the plat in Section B was plotted from field notes of actual surveys made by me or under my supervision and that the same is true and correct to the best of my knowledge and belief.

Date Surveyed June 22, 1959

Stephen H. Kinney
STEPHEN H. KINNEY

Registered Professional
Engineer and/or Land Surveyor.

Certificate No. 2803

(See instructions for completing this form on the reverse side)