

(SUBMIT IN TRIPLICATE)

Indian Agency **San Juan**

UNITED STATES
DEPARTMENT OF THE INTERIOR
GEOLOGICAL SURVEY

Allottee _____

Lease No. **San Juan Tribal**
Contract No.
14-00-004-123

SUNDRY NOTICES AND REPORTS ON WELLS

NOTICE OF INTENTION TO DRILL	<input checked="" type="checkbox"/>	SUBSEQUENT REPORT OF WATER SHUT-OFF	<input type="checkbox"/>
NOTICE OF INTENTION TO CHANGE PLANS	<input type="checkbox"/>	SUBSEQUENT REPORT OF SHOOTING OR ACIDIZING	<input type="checkbox"/>
NOTICE OF INTENTION TO TEST WATER SHUT-OFF	<input type="checkbox"/>	SUBSEQUENT REPORT OF ALTERING CASING	<input type="checkbox"/>
NOTICE OF INTENTION TO REDRILL OR REPAIR WELL	<input type="checkbox"/>	SUBSEQUENT REPORT OF REDRILLING OR REPAIR	<input type="checkbox"/>
NOTICE OF INTENTION TO SHOOT OR ACIDIZE	<input type="checkbox"/>	SUBSEQUENT REPORT OF ABANDONMENT	<input type="checkbox"/>
NOTICE OF INTENTION TO PULL OR ALTER CASING	<input type="checkbox"/>	SUPPLEMENTARY WELL HISTORY	<input type="checkbox"/>
NOTICE OF INTENTION TO ABANDON WELL	<input type="checkbox"/>		

RECEIVED
OCT 10 1958
U. S. GEOLOGICAL SURVEY
FARMINGTON, NEW MEXICO

(INDICATE ABOVE BY CHECK MARK NATURE OF REPORT, NOTICE, OR OTHER DATA)

October 8, 1958

Well No. **San Juan 5-D** is located **1980** ft. from **[N]** line and **1980** ft. from **[E]** line of sec. **24**
14/36, section 24 **T-31-N, R-15-W** **S.M.P.M.**
(1/4 Sec. and Sec. No.) (Twp.) (Range) (Meridian)
Ward-Collins **San Juan** **New Mexico**
(Field) (County or Subdivision) (State or Territory)

The elevation of the ~~land surface~~ above sea level is **2315** ft. **ungraded ground**

DETAILS OF WORK

(State names of and expected depths to objective sands; show sizes, weights, and lengths of proposed casings; indicate mudding jobs, cementing points, and all other important proposed work)

Propose to: Set 90' of 8 1/8" surface casing and cement with 100 sacks cement. Drill to an approximate depth of 2675' - Set 5 1/2" casing at 2675' and cement with 50 sacks. Set two-stage cement collar below silty sand marker, and cement with 50 sacks to an approximate depth of 1900'. Drill to a total depth of 2735. Land-oil free open hole 2675 to 2735 with 30,000 gallons oil and 30,000 lbs. sand. Run 2 1/8" tubing to total depth. Install rods and pump.

I understand that this plan of work must receive approval in writing by the Geological Survey before operation and repair work.

Company **AMSEC OIL & GAS COMPANY**

Address **P O Box 726**
Farmington, New Mexico

By **ORIGINAL SIGNED BY JOE C. SALMON**
Joe C. Salmon
Title **District Superintendent**

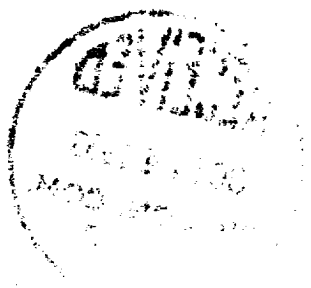
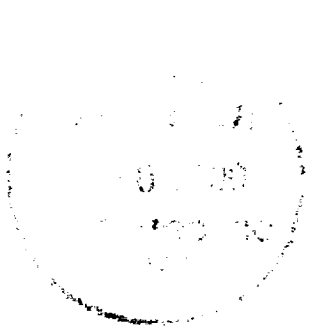

NEW MEXICO OIL CONSERVATION COMMISSION

Well Location and Acreage Dedication Plat

Section A.

Date September 29, 1958

Operator Aztec Oil and Gas Company Lease Uta-Indian
Well No. 5-B Unit Letter Section 24 Township 31 North Range 15 West NMPM
Located 1980 Feet From North Line, 1980 Feet From East Line
County San Juan G. L. Elevation 5518 Dedicated Acreage 40 Acres
Name of Producing Formation Lower Gallup Pool Verde-Gallup

1. Is the Operator the only owner* in the dedicated acreage outlined on the plat below?
Yes ☒ No ☐
2. If the answer to question one is "no," have the interests of all the owners been consolidated by communitization agreement or otherwise? Yes ☐ No ☐ . If answer is "yes,"
Type of Consolidation
3. If the answer to question two is "no," list all the owners and their respective interests below:

Owner

Land Description

RECEIVED

OCT 10 1958

U. S. GEOLOGICAL SURVEY
FARMINGTON NEW MEXICO

Section. B

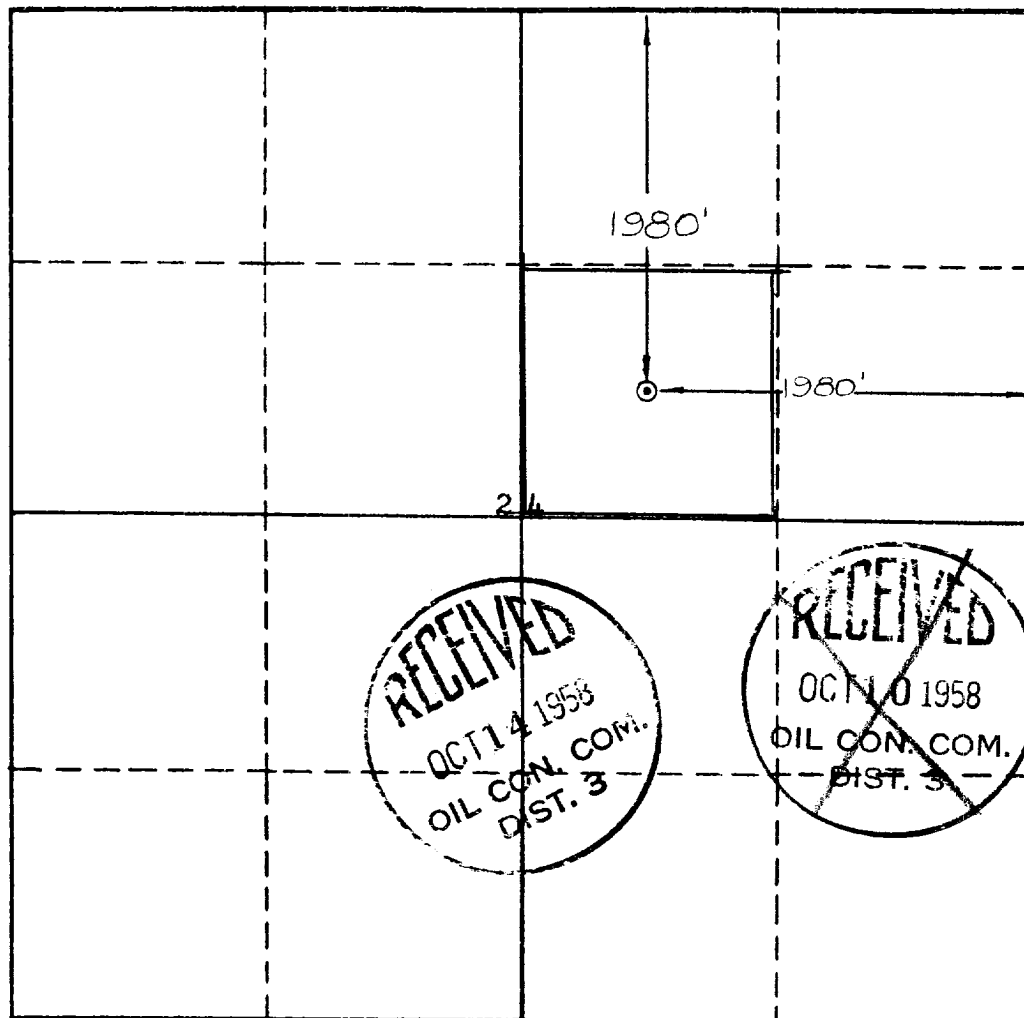

This is to certify that the information in Section A above is true and complete to the best of my knowledge and belief.

AZTEC OIL & GAS COMPANY
(Operator)

ORIGINAL SIGNED BY JOE C. SALMON
(Representative)

Box 786, Farmington, N.M.
Address

This is to certify that the well location shown on the plat in Section B was plotted from field notes of actual surveys made by me or under my supervision and that the same is true and correct to the best of my knowledge and belief.

Date Surveyed Sept. 26, 1958

Ernest V. Echohawk
Ernest V. Echohawk
Registered Land Surveyor.

Certificate No. 1545