

UNITED STATES
DEPARTMENT OF THE INTERIOR
GEOLOGICAL SURVEY

APPLICATION FOR PERMIT TO DRILL, DEEPEN, OR PLUG BACK

1a. TYPE OF WORK DRILL <input checked="" type="checkbox"/> DEEPEN <input type="checkbox"/> PLUG BACK <input type="checkbox"/>		5. LEASE DESIGNATION AND SERIAL NO. #14-20-604-1949	
b. TYPE OF WELL OIL WELL <input checked="" type="checkbox"/> GAS WELL <input type="checkbox"/> OTHER <input type="checkbox"/> SINGLE ZONE <input type="checkbox"/> MULTIPLE ZONE <input type="checkbox"/>		6. IF INDIAN, ALLIANCE OR TRIBE NAME Ute Mountain Tribal	
2. NAME OF OPERATOR Zoller and Danneberg		7. UNIT AGREEMENT NAME	
3. ADDRESS OF OPERATOR 219 Patterson Building, Denver, Colorado 80202		8. FARM OR LEASE NAME Ute	
4. LOCATION OF WELL (Report location clearly and in accordance with any State requirements.) At surface 1980' FSL x 330' FWL At proposed prod. zone approximately same		9. WELL NO. #3	
14. DISTANCE IN MILES AND DIRECTION FROM NEAREST TOWN OR POST OFFICE* 10 miles NW of Fruitland, New Mexico		10. FIELD AND POOL, OR WILDCAT Horseshoe-Gallup Ext.	
15. DISTANCE FROM PROPOSED* LOCATION TO NEAREST PROPERTY OR LEASE LINE, FT. (Also to nearest drlg. unit line, if any) 330'		11. SEC., T., R., M., OR BLK. AND SURVEY OR AREA 23-31N-16W, NMPM	
16. NO. OF ACRES IN LEASE 80		12. COUNTY OR PARISH San Juan	
17. NO. OF ACRES ASSIGNED TO THIS WELL 40		13. STATE New Mexico	
18. DISTANCE FROM PROPOSED LOCATION* TO NEAREST WELL, DRILLING, COMPLETED, OR APPLIED FOR, ON THIS LEASE, FT. 1280'		19. PROPOSED DEPTH 1750' (Gallup)	
20. ROTARY OR CABLE TOOLS Rotary		21. APPROX. DATE WORK WILL START* August 16, 1965	
21. ELEVATIONS (Show whether DF, RT, GR, etc.) 5589' Ground		22. APPROX. DATE WORK WILL START*	
23. PROPOSED CASING AND CEMENTING PROGRAM			

SIZE OF HOLE	SIZE OF CASING	WEIGHT PER FOOT	SETTING DEPTH	QUANTITY OF CEMENT

It is intended to drill a 1750' Gallup test in the following manner: Drill 8-3/4" hole to 30 feet and cement 7" casing to surface. Drill a 6-1/4" hole to approximately 1750' with air. If commercial production is encountered, cement 4-1/2" casing and sand-oil frac. Put well on production.

IN ABOVE SPACE DESCRIBE PROPOSED PROGRAM: If proposal is to deepen or plug back, give data on present productive zone and proposed new productive zone. If proposal is to drill or deepen directionally, give pertinent data on subsurface locations and measured and true vertical depths. Give blowout preventer program, if any.

24. SIGNED John F. Mitchell TITLE Agent for Zoller and Danneberg DATE August 6, 1965
(This space for Federal or State office use)

PERMIT NO. _____ APPROVAL DATE _____

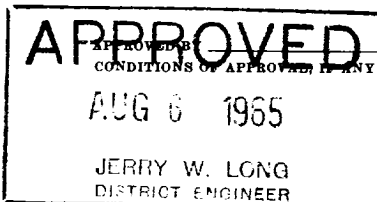

TITLE _____ DATE _____

*See Instructions On Reverse Side

Instructions

General: This form is designed for submitting proposals to perform certain well operations, as indicated, on all types of lands and leases for appropriate action by either a Federal or a State agency, or both, pursuant to applicable Federal and/or State laws and regulations. Any necessary special instructions concerning the use of this form and the number of copies to be submitted, particularly with regard to local, area, or regional procedures and practices, either are shown below or will be issued by, or may be obtained from, the local Federal and/or State office.

Item 1: If the proposal is to redrill to the same reservoir at a different subsurface location or to a new reservoir, use this form with appropriate notations. Consult applicable State or Federal regulations concerning subsequent work proposals or reports on the well.

Item 4: If there are no applicable State requirements, locations on Federal or Indian land should be described in accordance with Federal requirements. Consult local State or Federal office for specific instructions.

Item 14: Needed only when location of well cannot readily be found by road from the land or lease description. A plat, or plat, separate or on this reverse side, showing the roads to, and the surveyed location of, the well, and any other required information, should be furnished when required by Federal or State agency offices.

Items 15 and 18: If well is to be, or has been directionally drilled, give distances for subsurface location of hole in any present or objective production zone.

Item 22: Consult applicable Federal or State regulations, or appropriate officials, concerning approval of the proposal before operations are started.

**NEW MEXICO OIL CONSERVATION COMMISSION
WELL LOCATION AND ACREAGE DEDICATION PLAT**

Form C-102
Supersedes C-128
Effective 1-1-65

All distances must be from the outer boundaries of the Section.

Operator Zoller & Danneberg			Lease 14-20-604-1949 Ute Mtn Tribal		Well No. #3
Unit Letter NWSV	Section 23	Township 31 N	Range 16 W	County San Juan	
Actual Footage Location of Well: 1980 feet from the South line and 330 feet from the West line					
Ground Level Elev. 5589	Producing Formation Gallup		Pool Horseshoe-Gallup Ext.		Dedicated Acreage: 40 Acres

1. Outline the acreage dedicated to the subject well by colored pencil or hachure marks on the plat below.
2. If more than one lease is dedicated to the well, outline each and identify the ownership thereof (both as to working interest and royalty).
3. If more than one lease of different ownership is dedicated to the well, have the interests of all owners been consolidated by communitization, unitization, force-pooling, etc?

☐ Yes ☐ No If answer is "yes," type of consolidation _____

If answer is "no," list the owners and tract descriptions which have actually been consolidated. (Use reverse side of this form if necessary.) _____

No allowable will be assigned to the well until all interests have been consolidated (by communitization, unitization, forced-pooling, or otherwise) or until a non-standard unit, eliminating such interests, has been approved by the Commission.

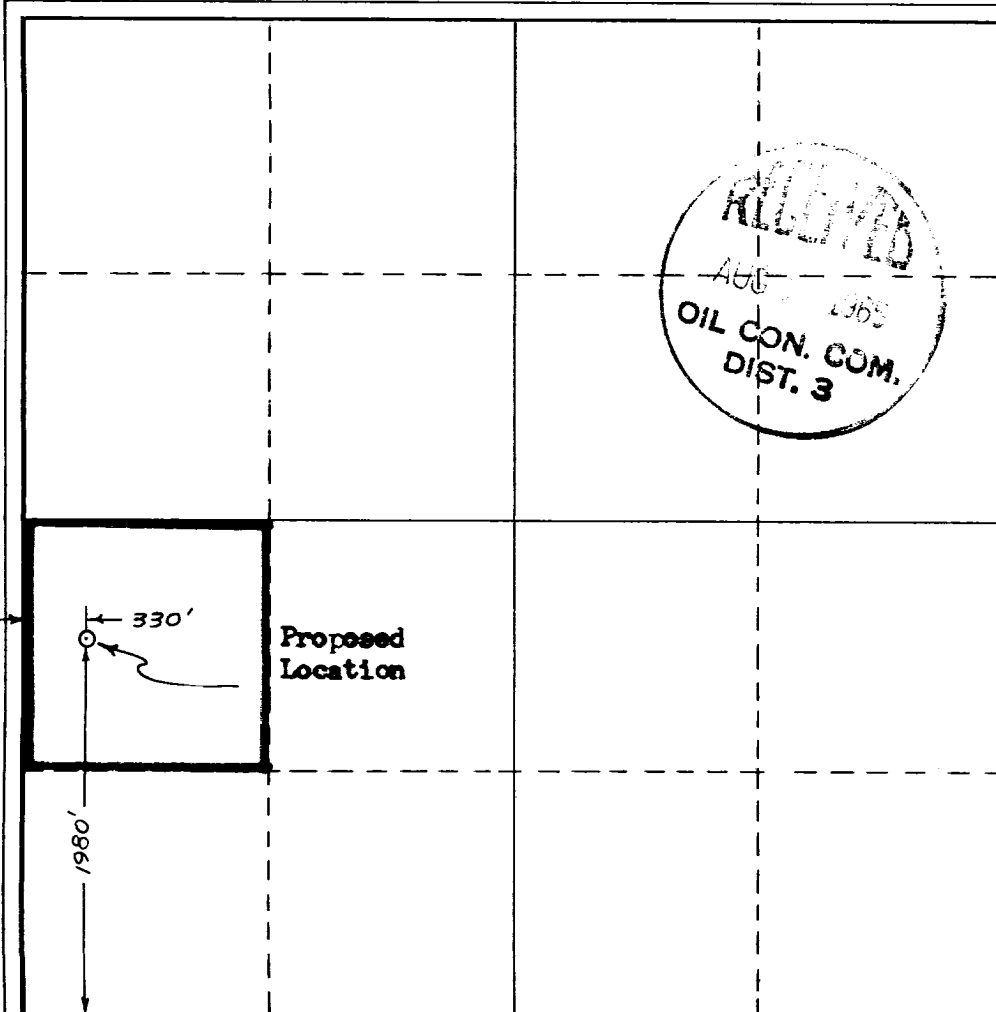

CERTIFICATION

I hereby certify that the information contained herein is true and complete to the best of my knowledge and belief.

John F. Mitchell
Name

John F. Mitchell

Position

Agent

Company

Zoller & Danneberg

Date

August 6, 1965

I hereby certify that the well location shown on this plat was plotted from field notes of actual surveys made by me or under my supervision, and that the same is true and correct to the best of my knowledge and belief.

Date Surveyed

August 4, 1965

Registered Professional Engineer
and/or Land Surveyor

Richard H. Reed

Certificate No.

N. M. # 3795

