

© strip
P.O. Box 1980 Hobbs, NM

District II
P.O. Drawer DD Artesia, NM 88221

District III
2000 Rio Brazos Rd. Aztec, NM 87410

Denny E. Hunt
DEPUTY OIL & GAS INSPECTOR

State of New Mexico
Energy, Minerals and Natural Resources Department

OIL CONSERVATION DIVISION

2040 South Pacheco Street
Santa Fe, New Mexico 87505

RECEIVED
JUL 10 1996
OIL, GAS, BTL
BTL

SUBMIT 1 COPY TO
APPROPRIATE
DISTRICT OFFICE
AND 1 COPY TO
SANTA FE OFFICE

OCT 11 9 1996

PIT REMEDIATION AND CLOSURE REPORT

Operator: <u>PNM Gas Services (Meridian)</u>		Telephone: <u>324-3764</u>	
Address: <u>603 W. Elm Street Farmington, NM 87401</u>			
Facility or Well Name: <u>East #11 A</u>			
Location:	Unit: <u>4</u>	Sec. <u>24</u>	T. <u>31 N</u> R. <u>12 W</u> County <u>San Juan</u>
Pit Type:	Separator <u> </u>	Dehydrator <input checked="" type="checkbox"/>	Other <u> </u>
Land Type:	BLM <input checked="" type="checkbox"/>	State <u> </u>	Fee <u> </u> Other <u> </u>
Pit Location:		Pit dimensions: length <u>20</u> width <u>20</u> depth <u>3</u>	
(Attach diagram)	Reference: wellhead <input checked="" type="checkbox"/> other <u> </u>		
Footage from reference: <u>137'</u>			
Direction from reference: <u>80</u> Degrees <u> </u> East <u> </u> North <input checked="" type="checkbox"/>			
<u> </u> of <u> </u> <input checked="" type="checkbox"/> West <u> </u> South <u> </u>			
Depth to Ground Water:			
(Vertical distance from contaminants to seasonal high water elevation of ground water)		Less than 50 feet (20 points)	
		50 feet to 99 feet (10 points)	
		Greater than 100 feet (0 points)	<u>10</u>
Wellhead Protection Area:			
(Less than 200 feet from a private domestic water source, or, less than 1,000 feet from all other water sources)		Yes (20 points)	
		No (0 points)	<u>0</u>
Distance to Surface Water:			
(Horizontal distance to perennial lakes, ponds, rivers, streams, creeks, irrigation canals and ditches)		Less than 200 feet (20 points)	
		200 feet to 1,000 feet (10 points)	
		Greater than 1,000 feet (0 points)	<u>0</u>
RANKING SCORE (TOTAL POINTS):			<u>10</u>

Date Remediation Started:	<u>3/27/96</u>	Date Completed:	<u>3/27/96</u>
Remediation Method:	Excavation <u>X</u>	Approx. Cubic Yard	<u>130</u>
(Check all appropriate sections)	Landfarmed <u>X</u>	Amount Landfarmed (cubic yds)	<u>130</u>
	Other _____		
Remediation Location:	Onsite <u>X</u>	Offsite	_____
(i.e., landfarmed onsite, name and location of offsite facility)			
Backfill Material Location:	_____		
General Description of Remedial Action:			
Excavated contaminated soil to pit size of 16'x16'x18' and landfarmed soil onsite within a bermed area at a depth of 6" to 12". Soil will be aerated by plowing/disking until soil meets regulatory levels.			

Ground Water Encountered:	No <u>✓</u>	Yes _____	Depth _____

Final Pit Closure Sampling:

(if multiple samples, attach sample result and diagram of sample locations and depths.)

Sample Location	<u>5 pt. composite-4 side walls and center of pit bottom</u>		
Sample depth	<u>18'</u>		
Sample date	<u>2/27/96</u>	Sample time	<u>9:30:00 AM</u>
Sample Results			
Benzene (ppm)	<u>0.0163</u>		
Total BTEX (ppm)	<u>2.9418</u>		
Field headspace (ppm)	_____		
TPH	<u>245.00</u>	Method	<u>418.1</u>
Vertical Extent (ft)	_____	Risk Assessment form attached	Yes _____ No <u>✓</u>
Ground Water Sample:	Yes _____	No <u>✓</u>	(If yes, attach sample results)

I HEREBY CERTIFY THAT THE INFORMATION ABOVE IS TRUE AND COMPLETE TO THE BEST OF MY KNOWLEDGE AND MY BELIEF

DATE

7-26-96

SIGNATURE

Demetrius BeardenPRINTED NAME
AND TITLE

East #11

3-27-96

Meridian Oil

Sec. 24, T31N, R12W

1150' FN L + 990' FEL

(2 pits)

Pit #1 - Active Dehydrator

Pit #2 - abandoned

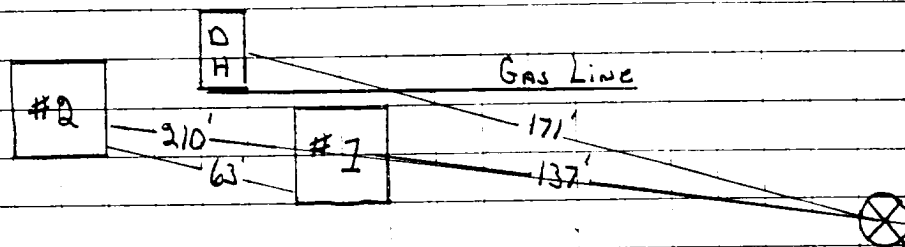

Gas line 1' North of Pit #1.

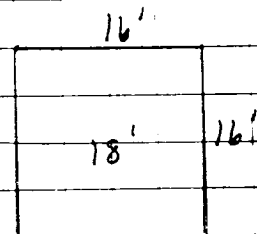
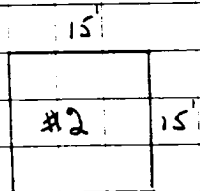

Pit #1

Pit #2: No remediation necessary

4' = 3.2 ppm

6' = 22 ppm

pit backfilled.

Composite Sample # 960326/1600

Composite Sample # = 9603270

18' Bottom = 110 ppm

15' North Wall = 52 ppm

10' South Wall = 10 ppm

14' East Wall = 38 ppm

14' West Wall = 22 ppm

OFF: (505) 325-8786



LAB: (505) 325-5667

TOTAL PETROLEUM HYDROCARBONS

Attn: *Denver Bearden*
Company: *PNM Gas Services*
Address: *603 W. Elm*
City, State: *Farmington, NM 87401*

Date: *28-Mar-96*
COC No.: *4593*
Sample No. *10514*
Job No. *2-1000*

Project Name: *PNM Gas Services - East #11*
Project Location: *9603270930; 5pt. Composite, 4 Walls & Bottom, 18'*
Sampled by: *GC* Date: *27-Mar-96* Time: *9:30*
Analyzed by: *HR* Date: *28-Mar-96*
Type of Sample: *Soil*

Laboratory Analysis

Laboratory Identification	Sample Identification	Total Petroleum Hydrocarbons
<i>10514-4593</i>	<i>PNM Gas Services - East #11</i> <i>9603270930; 5pt. Composite, 4 Walls & Bottom, 18'</i>	<i>245 mg/kg</i>

Quality Assurance Report

Laboratory Identification	Analyzed Value	Acceptable Range	Units of Measure
<i>Laboratory Fortified Blank Soil - QCBS2</i>	<i>< 25</i>	<i>< 25</i>	<i>mg/kg</i>
<i>Laboratory Fortified Spike Soil - QCSS1</i>	<i>877</i>	<i>828 - 1024</i>	<i>mg/kg</i>

Method - EPA Method 418.1 Total Petroleum Hydrocarbons

Approved by: *[Signature]*

Date: *3/28/96*

P. O. BOX 2606 • FARMINGTON, NM 87499

- TECHNOLOGY BLENDING INDUSTRY WITH THE ENVIRONMENT -