

C O P Y

Budget Bureau No. 42-R358.4.  
Form Approved.

Form 9-331a  
(Feb. 1951)

(SUBMIT IN TRIPLICATE)

**UNITED STATES  
DEPARTMENT OF THE INTERIOR  
GEOLOGICAL SURVEY**

Land Office Santa Fe  
Lease No. 077651  
Unit Sadie West

o		
	21	

**SUNDRY NOTICES AND REPORTS ON WELLS**

NOTICE OF INTENTION TO DRILL.....	<input checked="" type="checkbox"/>	SUBSEQUENT REPORT OF WATER SHUT-OFF.....	
NOTICE OF INTENTION TO CHANGE PLANS.....		SUBSEQUENT REPORT OF SHOOTING OR ACIDIZING.....	
NOTICE OF INTENTION TO TEST WATER SHUT-OFF.....		SUBSEQUENT REPORT OF ALTERING CASING.....	
NOTICE OF INTENTION TO RE-DRILL OR REPAIR WELL.....		SUBSEQUENT REPORT OF RE-DRILLING OR REPAIR.....	
NOTICE OF INTENTION TO SHOOT OR ACIDIZE.....		SUBSEQUENT REPORT OF ABANDONMENT.....	
NOTICE OF INTENTION TO PULL OR ALTER CASING.....		SUPPLEMENTARY WELL HISTORY.....	
NOTICE OF INTENTION TO ABANDON WELL.....			

(INDICATE ABOVE BY CHECK MARK NATURE OF REPORT, NOTICE, OR OTHER DATA)

July 24, 19 64

Well No. 2 is located 920 ft. from N line and 830 ft. from W line of sec. 21  
NW/4 Section 21 31N 12W NMPM  
(1/4 Sec. and Sec. No.) (Twp.) (Range) (Meridian)  
Basin Dakota San Juan New Mexico  
(Field) (County or Subdivision) (State or Territory)

The elevation of the <sup>GL</sup>~~derrick floor~~ above sea level is 6134 ft.

**DETAILS OF WORK**

(State names of and expected depths to objective sands; show sizes, weights, and lengths of proposed casings; indicate mudlogging jobs, cementing points, and all other important proposed work)

12-1/4" hole to 250 ft. 8-5/8" 24# J-55 smls casing at 250, cement to surface.  
 7-7/8" hole to estimated TD 7250. Run ES-Induction and GR Sonic logs. Set  
 5-1/2" OD 14# and 15-1/2" J-55 smls casing at TD, cement w/750 cu. ft. Class  
 "C" cement. Selectively perforate Dakota, sand water frac.

320 acre spacing. Acreage communitized as outlined on attached.



I understand that this plan of work must receive approval in writing by the Geological Survey before operations may be commenced.

Company Union Texas Petroleum, A Division of Allied Chemical Corporation

Address Suite B-400, 1740 Broadway

Denver, Colorado 80202

By /s/ Charles M. Heard

Title District Superintendent

C O P Y

GPO 914974

NEW MEXICO OIL CONSERVATION COMMISSION  
WELL LOCATION AND ACREAGE DEDICATION PLAT

SECTION A.

DATE July 1, 1964

OPERATOR UNION TEXAS PETROLEUM

LEASE SADIE WEST

WELL NO. 2 UNIT LETTER D SECTION 21 TOWNSHIP 31 NORTH RANGE 12 WEST NMPM

LOCATED 920 FEET FROM NORTH LINE, 830 FEET FROM WEST LINE

COUNTY SAN JUAN G. L. ELEVATION 6134 DEDICATED ACREAGE 318.5 <sup>10' 320</sup> ACRES

NAME OF PRODUCING FORMATION DAKOTA POOL Basin Dakota

1. IS THE OPERATOR THE ONLY OWNER\* IN THE DEDICATED ACREAGE OUTLINED ON THE PLAT BELOW? YES \_\_\_\_\_ NO X
2. IF THE ANSWER TO QUESTION ONE IS "NO," HAVE THE INTERESTS OF ALL THE OWNERS BEEN CONSOLIDATED BY COMMUNITIZATION AGREEMENT OR OTHERWISE? YES X NO X IF ANSWER IS "YES," TYPE OF CONSOLIDATION COMM-UNITIZATION AGREEMENT.

3. IF THE ANSWER TO QUESTION TWO IS "NO," LIST ALL THE OWNERS AND THEIR RESPECTIVE INTERESTS BELOW:

OWNER

LAND DESCRIPTION

SECTION B.

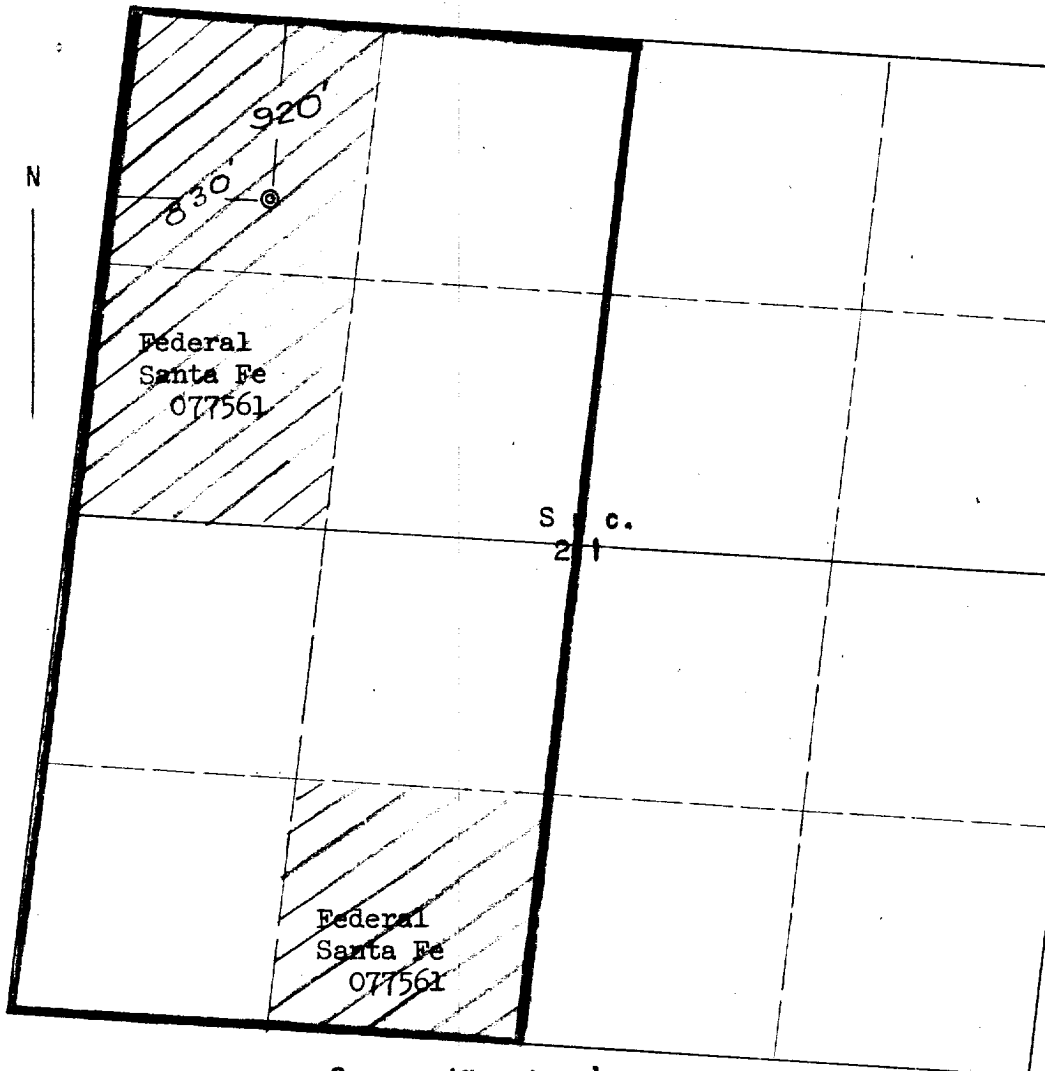

SCALE, 1" = 1000'



THIS IS TO CERTIFY THAT THE INFORMATION IN SECTION A ABOVE IS TRUE AND COMPLETE TO THE BEST OF MY KNOWLEDGE AND BELIEF.

Union Texas Petroleum  
(OPERATOR)

/s/ Charles M. Beard  
(REPRESENTATIVE)

Suite B-400, 1740 Broadway  
Denver, Colorado 80202

THIS IS TO CERTIFY THAT THE WELL LOCATION SHOWN ON THE PLAT IN SECTION B WAS PLOTTED FROM FIELD NOTES OF ACTUAL SURVEYS MADE BY ME OR UNDER MY SUPERVISION AND THAT THE SAME IS TRUE AND CORRECT TO THE BEST OF MY KNOWLEDGE AND BELIEF.

DATE SURVEYED JULY 1, 1964

FOUR STATES  
ENGINEERING CO.

FARMINGTON, NEW MEXICO

Emuel V. Cookshaw  
REGISTERED ENGINEER OR  
LAND SURVEYOR

CERTIFICATE NO. 3602