

NEW MEXICO OIL CONSERVATION COMMISSION

Well Location and Acreage Dedication Plat

Section A.

Date JUNE 15, 1957

Operator COLORADO WESTERN EXPLORATION CO. Lease CONTRACT - STARR
 Well No. 1-113 Unit Letter 3 Section 3 Township 13 N Range 13 E NMPN
 Located 1135 Feet From 1135 Line, 1135 Feet From 1135 Line
 County CONJO G. L. Elevation 3450 Dedicated Acreage 320-00 Acres
 Name of Producing Formation DEKOTA Pool WILBERT

1. Is the Operator the only owner* in the dedicated acreage outlined on the plat below?
 Yes ☒ No ☐
2. If the answer to question one is "no," have the interests of all the owners been consolidated by communitization agreement or otherwise? Yes ☐ No ☐ If answer is "yes," Type of Consolidation _____
3. If the answer to question two is "no," list all the owners and their respective interests below:

Owner

Land Description

Section B

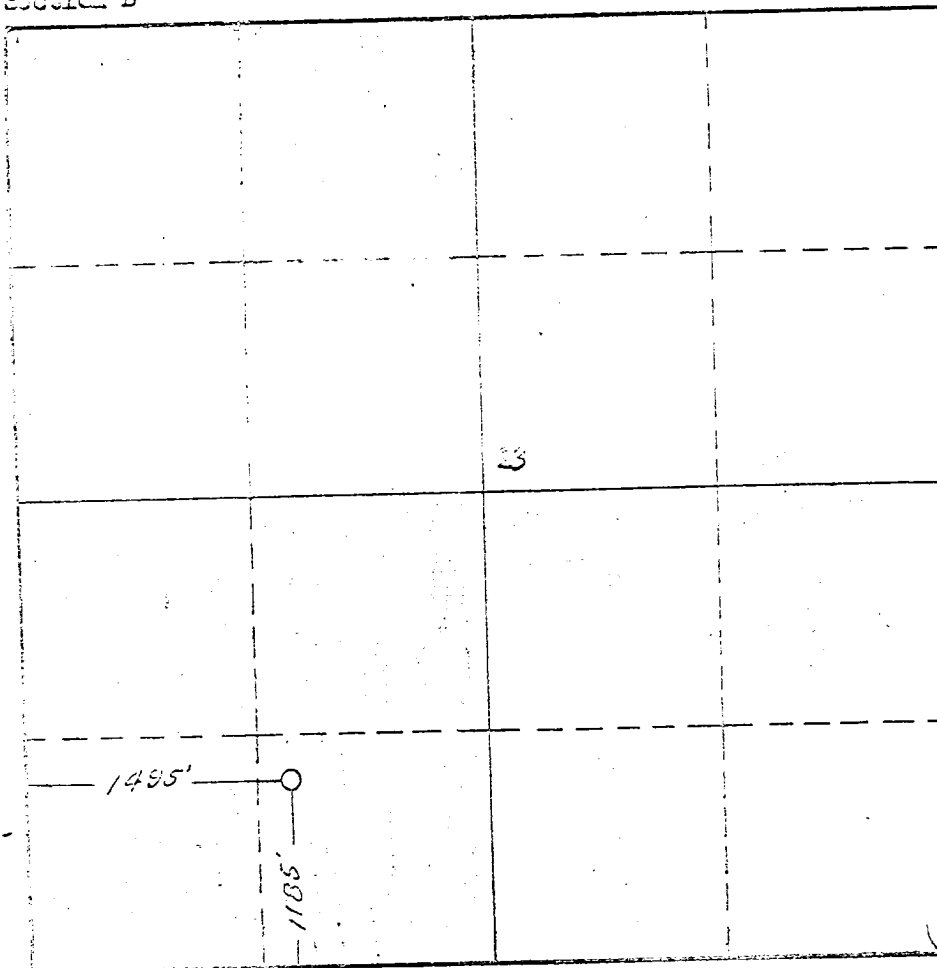

This is to certify that the information in Section A above is true and complete to the best of my knowledge and belief.

SOUTHERN UNION GAS COMPANY

(Operator)
BY COLORADO WESTERN EXPLORATION INC

(Representative)
BY [Signature] President
312 U.S. NATIONAL Bk Bldg
DENVER

This is to certify that the well location shown on the plat in Section B was plotted from field notes of actual surveys made by me or under my supervision and that the same is true and correct to the best of my knowledge and belief.

Date Surveyed June 15, 1957

[Signature]
 Registered Professional Engineer and/or Land Surveyor
 Since 1950

Certificate No. 1135

(See instructions for completion this form on the reverse side)