

NEW MEXICO OIL CONSERVATION COMMISSION
Well Location and Lease Dedication Plat

Revised 1-1-57

Section A.

Date JUNE 15, 1957

Operator COLORADO WESTERN EXPLORATION CO. Lease CO7-12821 - STARR
Well No. 15 Unit Letter 13 Section 13 Township 21 N Range 13 E ASME
located 11.35 Feet From END SOUTH Line 1495 Feet From the WEST Line
County SAN JUAN G. L. Elevation 5705.0 Dedicated Acreage 1.12 Acres
Name of Producing Formation MESA VERDE Pool BLANCO

1. Is the Operator the only owner* in the dedicated acreage outlined on the plat below?
Yes ☒ No ☐
2. If the answer to question one is "no," have the interests of all the owners been consolidated by communitization agreement or otherwise? Yes ☐ No ☐. If answer is "yes," Type of Consolidation _____
3. If the answer to question two is "no," list all the owners and their respective interests below:

Owner

Land Description

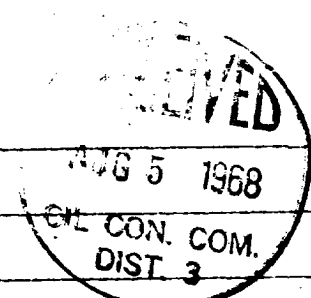

Section B

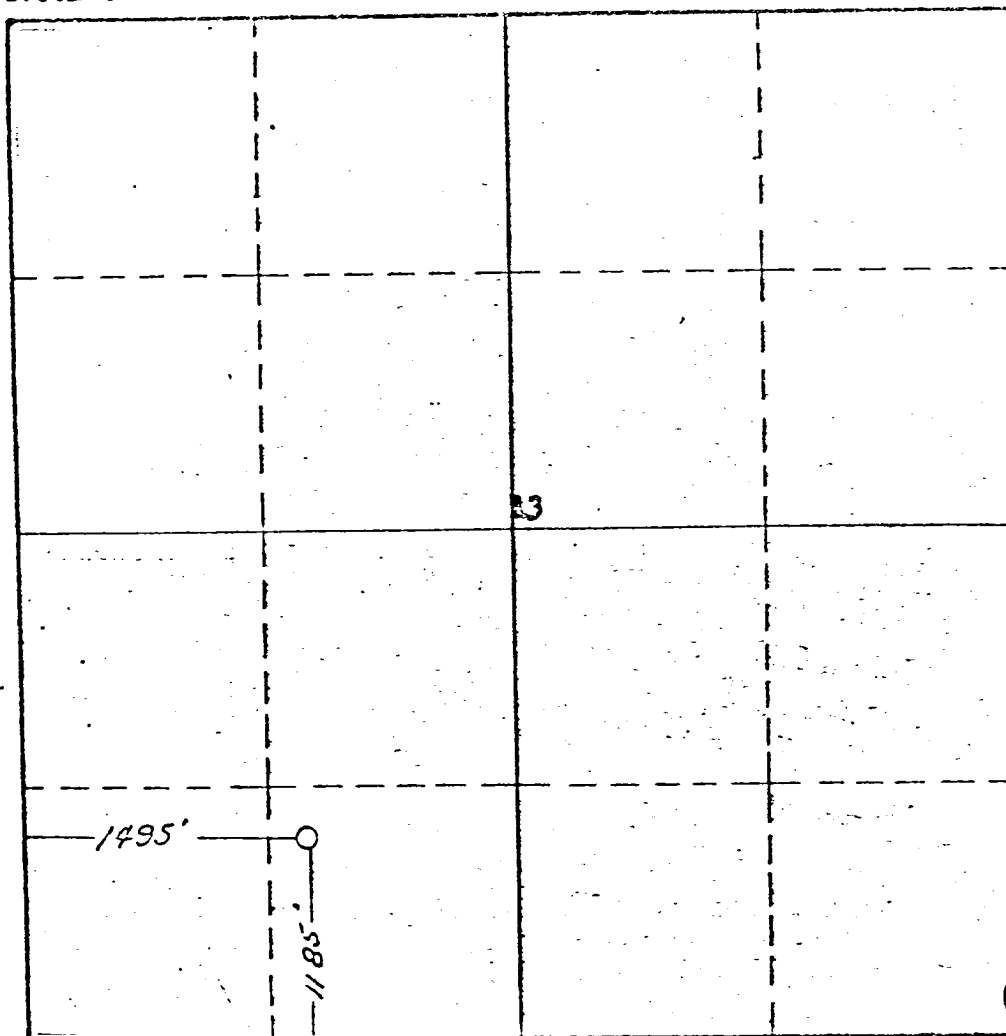

This is to certify that the information in Section A above is true and complete to the best of my knowledge and belief.

SOUTHERN UNION GAS COMPANY
by COLORADO WESTERN EXPLORATION CO.
(Operator)

by J. H. Threlkeld
(Representative)
312 U.S. National Bank Bldg
DENVER, COLORADO
Address

This is to certify that the well location shown on the plat in Section B was plotted from field notes of actual surveys made by me or under my supervision and that the same is true and correct to the best of my knowledge and belief.

Date Surveyed JUN 17 1957

James P. Looze
Registered Professional
Engineer and/or Land Surveyor.
James P. Looze

Certificate No. 1163

(See instructions for completing this form on the reverse side)

0 330 660 990 1320 1650 1980 2310 2640 2970 3300 3630 3960 4290 4620 4950 5280 5610 5940 6270 6600