

(SUBMIT IN TRIPLICATE)

UNITED STATES
DEPARTMENT OF THE INTERIOR
GEOLOGICAL SURVEY

Approval expires 12-31-55.
Ignacio
Indian Agency _____
Allottee _____
Lease No. **14-01-604-02**

SUNDRY NOTICES AND REPORTS ON WELLS

NOTICE OF INTENTION TO DRILL	<input checked="" type="checkbox"/>	SUBSEQUENT REPORT OF WATER SHUT-OFF	
NOTICE OF INTENTION TO CHANGE PLANS		SUBSEQUENT REPORT OF SHOOTING OR ACIDIZING	
NOTICE OF INTENTION TO TEST WATER SHUT-OFF		SUBSEQUENT REPORT OF ALTERING CASING	
NOTICE OF INTENTION TO REDRILL OR REPAIR WELL		SUBSEQUENT REPORT OF REDRILLING OR REPAIR	
NOTICE OF INTENTION TO SHOOT OR ACIDIZE		SUBSEQUENT REPORT OF ABANDONMENT	
NOTICE OF INTENTION TO PULL OR ALTER CASING		SUPPLEMENTARY WELL HISTORY	
NOTICE OF INTENTION TO ABANDON WELL			

(INDICATE ABOVE BY CHECK MARK NATURE OF REPORT, NOTICE, OR OTHER DATA)

Well No. **1** is located **1810** ft. from **S** line and **600** ft. from **E** line of sec. **17**
Range 17 (Range) **T. 31-N, R. 18-W** (Meridian)
Verde-Gallup (Field) **San Juan** (County or Subdivision) **New Mexico** (State or Territory)

The elevation of the derrick floor above sea level is _____ ft.

DETAILS OF WORK

(State names of and expected depths to objective sands; show sizes, weights, and lengths of proposed casings; indicate mudding jobs, cementing points, and all other important proposed work)

Propose to: Set 90' of 8 1/8" surface casing and cement to surface. Drill with rotary to an approximate depth of 2500'. Set 4 1/2" casing at 2500'. Drill in with cable tools to a total depth of 2570'. Sand-oil from open hole with 40,000 gallons oil and 40,000 lbs. sand. Install 2 1/8" tubing and rods.



I understand that this plan of work must receive approval in writing by the Geological Survey before operations may be commenced.

Company **AGRIC OIL & GAS COMPANY**

Address **P O Box 786**
Farmington, New Mexico

By **ORIGINAL SIGNED BY JOE C. SALMON**
Joe C. Salmon
Title **District Superintendent**

NEW MEXICO OIL CONSERVATION COMMISSION

Well Location and Acreage Dedication Plat

Section A.

Date April 29, 1959

Operator Aztec Oil and Gas Company Lease Ute Indian
Well No. 6-E Unit Letter Section 17 Township 31 North Range 14 West NMPM
Located 1810 Feet From South Line, 620 Feet From East Line
County San Juan G. L. Elevation 5847 Dedicated Acreage 10 Acres
Name of Producing Formation Gallup Pool Verde-Gallup

1. Is the Operator the only owner* in the dedicated acreage outlined on the plat below?
Yes XXX No
2. If the answer to question one is "no," have the interests of all the owners been consolidated by communitization agreement or otherwise? Yes No . If answer is "yes,"
Type of Consolidation
3. If the answer to question two is "no," list all the owners and their respective interests below:

Owner

Land Description



Section B

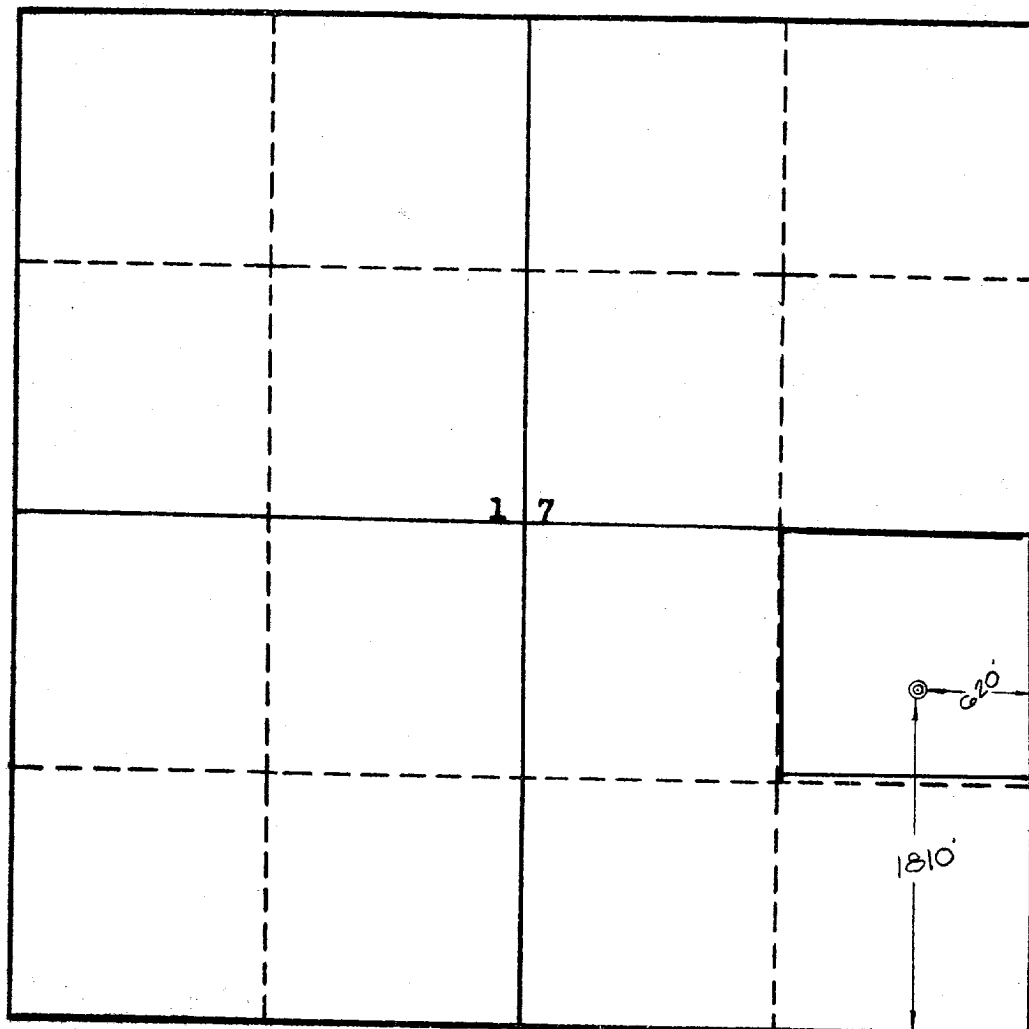

This is to certify that the information in Section A above is true and complete to the best of my knowledge and belief.

Aztec Oil & Gas Company
(Operator)

ORIGINAL SIGNED BY JOE C. SALMON

(Representative)

Box 786, Farmington, N.M.
Address

This is to certify that the well location shown on the plat in Section B was plotted from field notes of actual surveys made by me or under my supervision and that the same is true and correct to the best of my knowledge and belief.

Date Surveyed March 26, 1959

Ernest V. Echohawk
Ernest V. Echohawk
Registered Land Surveyor.

Certificate No. 1545