

Sec. 13

(SUBMIT IN TRIPLICATE)

Indian Agency Navajo Tribal

Conty. Navajo

Allottee Trust

Lease No. Navajo #1

UNITED STATES
DEPARTMENT OF THE INTERIOR
GEOLOGICAL SURVEY

SUNDRY NOTICES AND REPORTS ON WELLS

NOTICE OF INTENTION TO DRILL	<input checked="" type="checkbox"/>	SUBSEQUENT REPORT OF WATER SHUT-OFF	
NOTICE OF INTENTION TO CHANGE PLANS		SUBSEQUENT REPORT OF SHOOTING OR ACIDIZING	
NOTICE OF INTENTION TO TEST WATER SHUT-OFF		SUBSEQUENT REPORT OF ALTERING CASING	
NOTICE OF INTENTION TO REDRILL OR REPAIR WELL		SUBSEQUENT REPORT OF REDRILLING OR REPAIR	
NOTICE OF INTENTION TO SHOOT OR ACIDIZE		SUBSEQUENT REPORT OF ABANDONMENT	
NOTICE OF INTENTION TO PULL OR ALTER CASING		SUPPLEMENTARY WELL HISTORY	
NOTICE OF INTENTION TO ABANDON WELL			

RECEIVED

U. S. GEOLOGICAL SURVEY
FARMINGTON
NEW MEXICO

(INDICATE ABOVE BY CHECK MARK NATURE OF REPORT, NOTICE, OR OTHER DATA)

July 13, 1959

Well No. 15 is located 660 ft. from S line and 1900 ft. from W line of sec. 13

Sec. 13

(1/4 Sec. and Sec. No.)

13N

(Twp.)

17W

(Range)

109N

(Meridian)

Navajo Gallup

(Field)

San Juan

(County or Subdivision)

New Mexico

(State or Territory)

The elevation of the G.L. above sea level is 5076 ft.

DETAILS OF WORK

(State names of and expected depths to objective sands; show sizes, weights, and lengths of proposed casings; indicate mudding jobs, cementing points, and all other important proposed work)

Propose to drill the above well to a total depth of approximately 1800'. To test the Gallup formation at approximately 1700' and any other zones which appear productive of oil or gas.

Casing pattern: 100' of 8 5/8" cas w/150 lbs
1800' of 5 1/2" cas w/100 lbs

If necessary, to sand oil free.



I understand that this plan of work must receive approval in writing by the Geological Survey before operations may be commenced.

Company Magnolia Petroleum Company

Address Box 2406,

Hobbs, New Mexico

By [Signature]
Title District Superintendent

NEW MEXICO OIL CONSERVATION COMMISSION

Well Location and Acreage Dedication Plat

Section A.

Date July 9, 1959

Operator MAGNOLIA PETROLEUM COMPANY Lease Navajo "A"
Well No. 15 Unit Letter N Section 13 Township 31N Range 17W NMPM
Located 660 Feet From South Line, 1980 Feet From West Line
County San Juan G. L. Elevation 5874 Dedicated Acreage 40 Acres
Name of Producing Formation Gallup Pool Horseshoe Gallup

1. Is the Operator the only owner* in the dedicated acreage outlined on the plat below?
Yes X No .
2. If the answer to question one is "no," have the interests of all the owners been consolidated by communitization agreement or otherwise? Yes No . If answer is "yes," Type of Consolidation
3. If the answer to question two is "no," list all the owners and their respective interests below:

Owner

Land Description

Section B

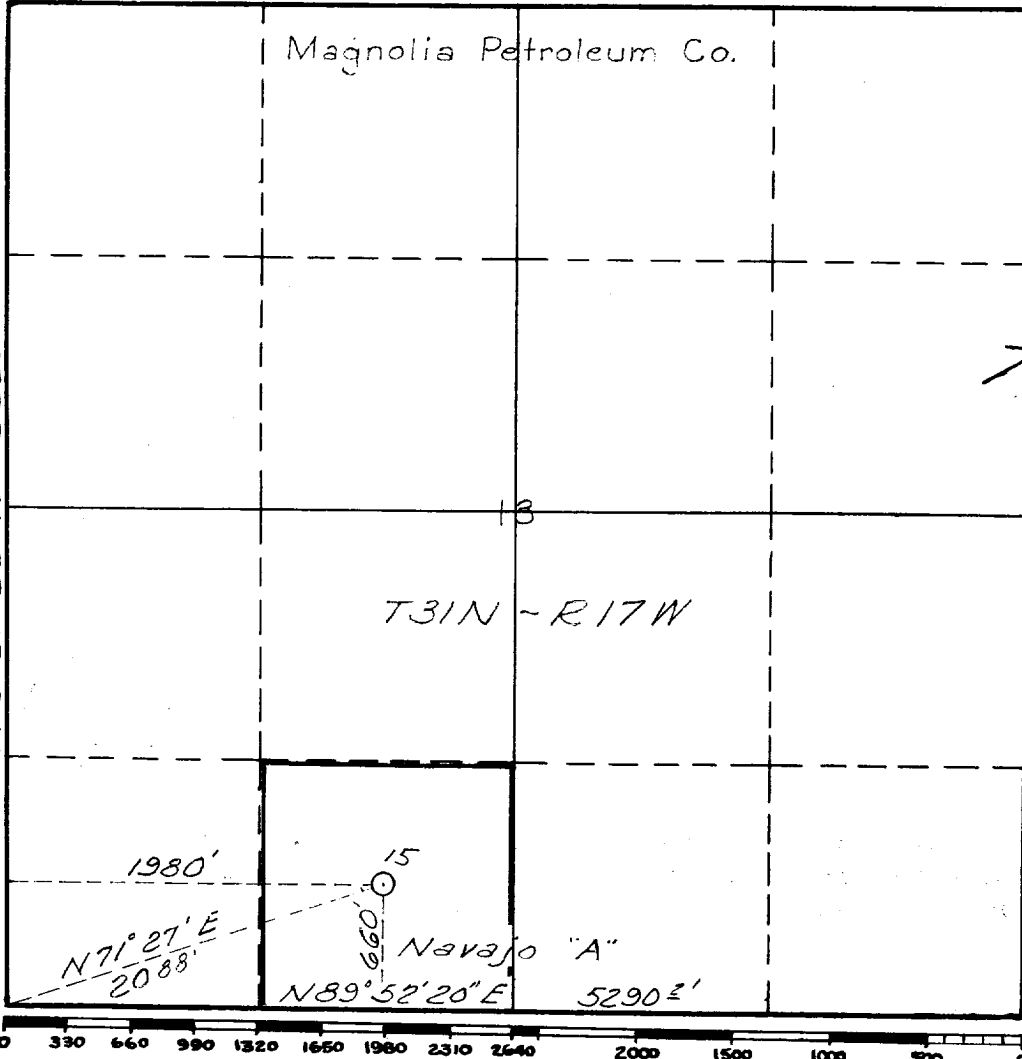

This is to certify that the information in Section A above is true and complete to the best of my knowledge and belief.

Magnolia Petroleum Company
(Operator)

Representative

Box 2406, H. bbs, New Mexico
Address

This is to certify that the well location shown on the plat in Section B was plotted from field notes of actual surveys made by me or under my supervision and that the same is true and correct to the best of my knowledge and belief.

Date Surveyed April 17, 1959

Carl E. Turner
Registered Professional
Engineer and/or Land Surveyor.

Certificate No. 2490

(See instructions for completing this plat)