

(SUBMIT IN TRIPLICATE)

Indian Agency Ute Mountain

UNITED STATES
DEPARTMENT OF THE INTERIOR
GEOLOGICAL SURVEY

Allottee _____

Lease No. 14-20-151-16

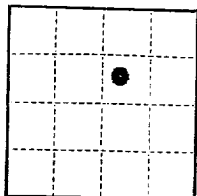

SUNDRY NOTICES AND REPORTS ON WELLS

NOTICE OF INTENTION TO DRILL	<input checked="" type="checkbox"/>	SUBSEQUENT REPORT OF WATER SHUT-OFF	
NOTICE OF INTENTION TO CHANGE PLANS		SUBSEQUENT REPORT OF SHOOTING OR ACIDIZING	
NOTICE OF INTENTION TO TEST WATER SHUT-OFF		SUBSEQUENT REPORT OF ALTERING CASING	
NOTICE OF INTENTION TO REDRILL OR REPAIR WELL		SUBSEQUENT REPORT OF REDRILLING OR REPAIR	
NOTICE OF INTENTION TO SHOOT OR ACIDIZE		SUBSEQUENT REPORT OF ABANDONMENT	
NOTICE OF INTENTION TO PULL OR ALTER CASING		SUPPLEMENTARY WELL HISTORY	
NOTICE OF INTENTION TO ABANDON WELL			

(INDICATE ABOVE BY CHECK MARK NATURE OF REPORT, NOTICE, OR OTHER DATA)

April 17, 1957

Well No. 1-A Ute Indian is located 1980 ft. from [N] line and 1960 ft. from [E] line of sec. 15

SW/4, Section 15 T-31-N, R-15-W N.M.P.M.
(34 Sec. and Sec. No.) (Twp.) (Range) (Meridian)
Verde-Gallup San Juan New Mexico
(Field) (County or Subdivision) (State or Territory)

The elevation of the ~~surface~~ above sea level is 5745 ft. ungraded ground

DETAILS OF WORK

(State names of and expected depths to objective sands; show sizes, weights, and lengths of proposed casings; indicate mudding jobs, cementing points, and all other important proposed work)

Propose to: Set 150' of surface casing. Drill through Tooto formation with Rotary Tools. Set 5 1/2" casing at an approximate total depth of 2050'. Perforate Tooto formation. Sand-oil free with 30,000 gallons oil and 25,000 lbs. sand. Run 2" tubing and install pump.



I understand that this plan of work must receive approval in writing by the Geological Survey before operations may be commenced.

Company AZTEC OIL & GAS COMPANY

Address P.O. Box 786

Farmington, New Mexico

By Joe C. Salmon

Joe C. Salmon

Title District Superintendent



OIL CONSERVATION COMMISSION

Form C-128

Well Location and/or Gas Proration Plat

Date _____

Operator Aztec Oil and Gas Company Lease _____Well No. 4-A Section 15 Township 31 North Range 15 West 17, 1957
Ute-IndianLocated 1980 Feet From North Line, 1980 Feet From East Line,San Juan County, New Mexico. G. L. Elevation 5745

Name of Producing Formation _____ Pool _____ Dedicated Acreage _____

(Note: All distances must be from outer boundaries of Section)

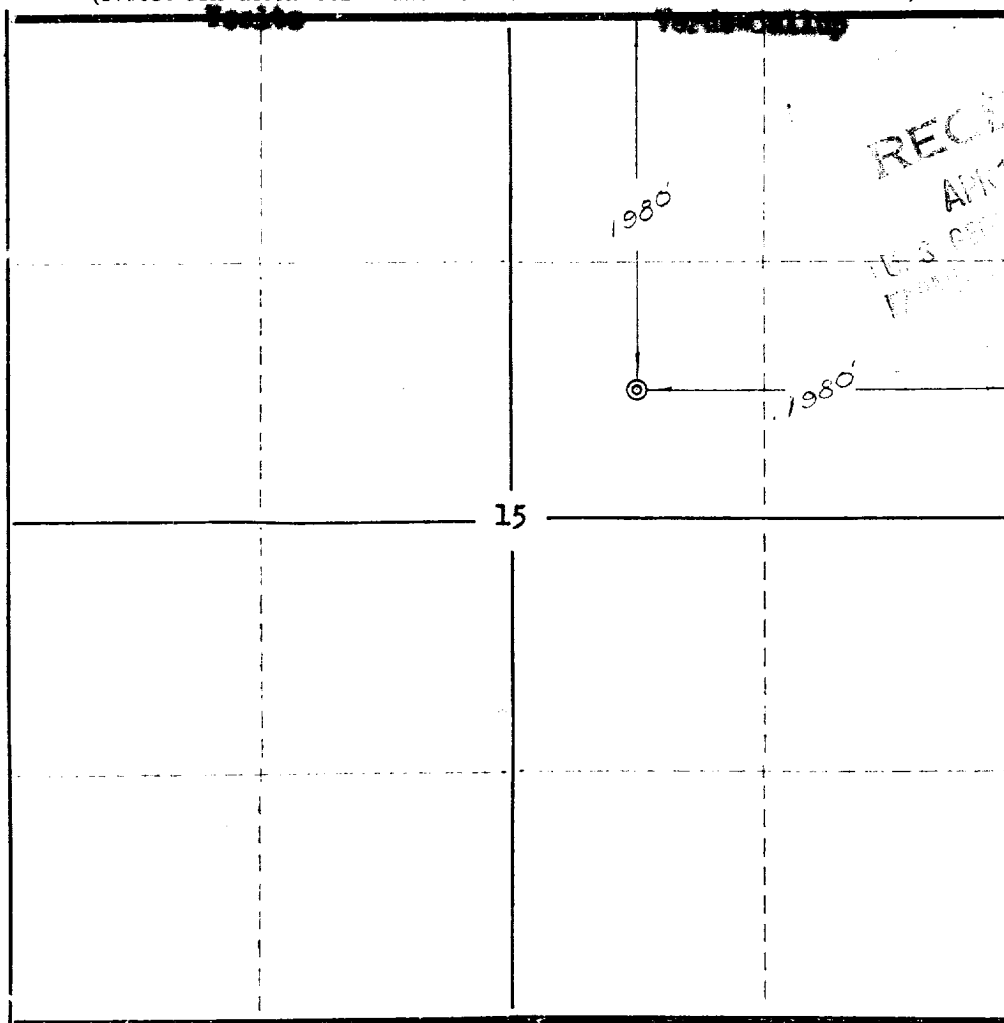

NOTE

This section of form is to be used for gas wells only.

↓

SCALE: 1" = 1000'

1. Is this Well a Dual Comp. ? Yes No
2. If the answer to Question 1 is yes, are there any other dually completed wells within the dedicated acreage?
Yes No

Name Joe C. Salmon

Position _____

Representing _____

Address District SuperintendentAztec Oil & Gas CompanyBox 786, Farmington, New Mexico

This is to certify that the above plat was prepared from field notes of actual surveys made by me or under my supervision and that the same are true and correct to the best of my knowledge and belief.

Date Surveyed April 12, 1957Ernest V. Echohawk

Ernest V. Echohawk

Reg. Land Surveyor, N. Mex., Reg. No. 1545