

(SUBMIT IN TRIPLICATE)

UNITED STATES
DEPARTMENT OF THE INTERIOR
GEOLOGICAL SURVEY

Land Office Santa Fe
Lease No. SE 078464
Unit _____

SUNDRY NOTICES AND REPORTS ON WELLS

NOTICE OF INTENTION TO DRILL		SUBSEQUENT REPORT OF WATER SHUT-OFF	
NOTICE OF INTENTION TO CHANGE PLANS		SUBSEQUENT REPORT OF SHOOTING OR ACIDIZING	
NOTICE OF INTENTION TO TEST WATER SHUT-OFF		SUBSEQUENT REPORT OF ALTERING CASING	
NOTICE OF INTENTION TO RE-DRILL OR REPAIR WELL		SUBSEQUENT REPORT OF RE-DRILLING OR REPAIR	
NOTICE OF INTENTION TO SHOOT OR ACIDIZE		SUBSEQUENT REPORT OF ABANDONMENT	
NOTICE OF INTENTION TO PULL OR ALTER CASING		SUPPLEMENTARY WELL HISTORY	
NOTICE OF INTENTION TO ABANDON WELL			

(INDICATE ABOVE BY CHECK MARK NATURE OF REPORT, NOTICE, OR OTHER DATA)

Government Jackson May 25, 1960
Well No 2-13 is located 750 ft. from $\begin{matrix} N \\ S \end{matrix}$ line and 750 ft. from $\begin{matrix} E \\ W \end{matrix}$ line of sec 15
SE NE of Sec. 15 31N 12W N.M.P.M.
(1/4 Sec. and Sec. No.) (Twp.) (Range) (Meridian)
Undesignated Dakota San Juan New Mexico
(Field) (County or Subdivision) (State or Territory)
The elevation of the ~~ground~~ derrick floor above sea level is 514 ft.

DETAILS OF WORK

(State names of and expected depths to objective sands; show sizes, weights, and lengths of proposed casings; indicate mudding jobs, cementing points, and all other important proposed work)

- (1) Set 200 feet of 7 5/8" surface casing.
- (2) Drill with mud to about 5300' or 150' of Dakota penetration.
- (3) Log run 5 1/2" production casing and cement opposite Dakota and Mesa Verde.
- (4) Perforate and water frac Dakota and complete as single zone Dakota gas producer.

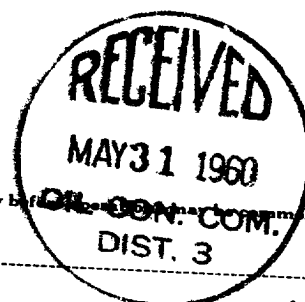

I understand that this plan of work must receive approval in writing by the Geological Survey before any work may be commenced.

Company Consolidated Oil & Gas, Inc.
Address Suite 3112, 1700 Broadway
Denver 2, Colorado

By E. Ladd
Title E. Ladd, Vice President



NEW MEXICO OIL CONSERVATION COMMISSION
WELL LOCATION AND ACREAGE DEDICATION PLAT

FORM C-128
Revised 5/1/57

SEE INSTRUCTIONS FOR COMPLETING THIS FORM ON THE REVERSE SIDE

SECTION A

Operator CONSOLIDATED OIL AND GAS CORPORATION		Lease Government Jackson		Well No. 2-18
Unit Letter G	Section 18	Township 31 NORTH	Range 12 WEST	County SAN JUAN
Actual Footage Location of Well: 1750 feet from the NORTH line and 1750 feet from the EAST line				
Ground Level Elev. 5874.0	Producing Formation Dakota		Pool Undesignated Dakota	Dedicated Acreage: 320 Acres
Ref: GEO plat dated 18 November 1953				
1. Is the Operator the only owner in the dedicated acreage outlined on the plat below? YES <input checked="" type="checkbox"/> NO <input type="checkbox"/> ("Owner" means the person who has the right to drill into and to produce from any pool and to appropriate the production either for himself or for himself and another. (65-3-29 (e) NMSA 1935 Comp.)				
2. If the answer to question one is "no," have the interests of all the owners been consolidated by communitization agreement or otherwise? YES <input type="checkbox"/> NO <input type="checkbox"/> If answer is "yes," Type of Consolidation _____				
3. If the answer to question two is "no," list all the owners and their respective interests below:				
Owner		Land Description		

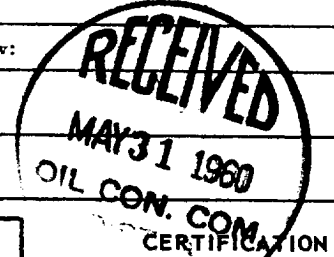

SECTION B

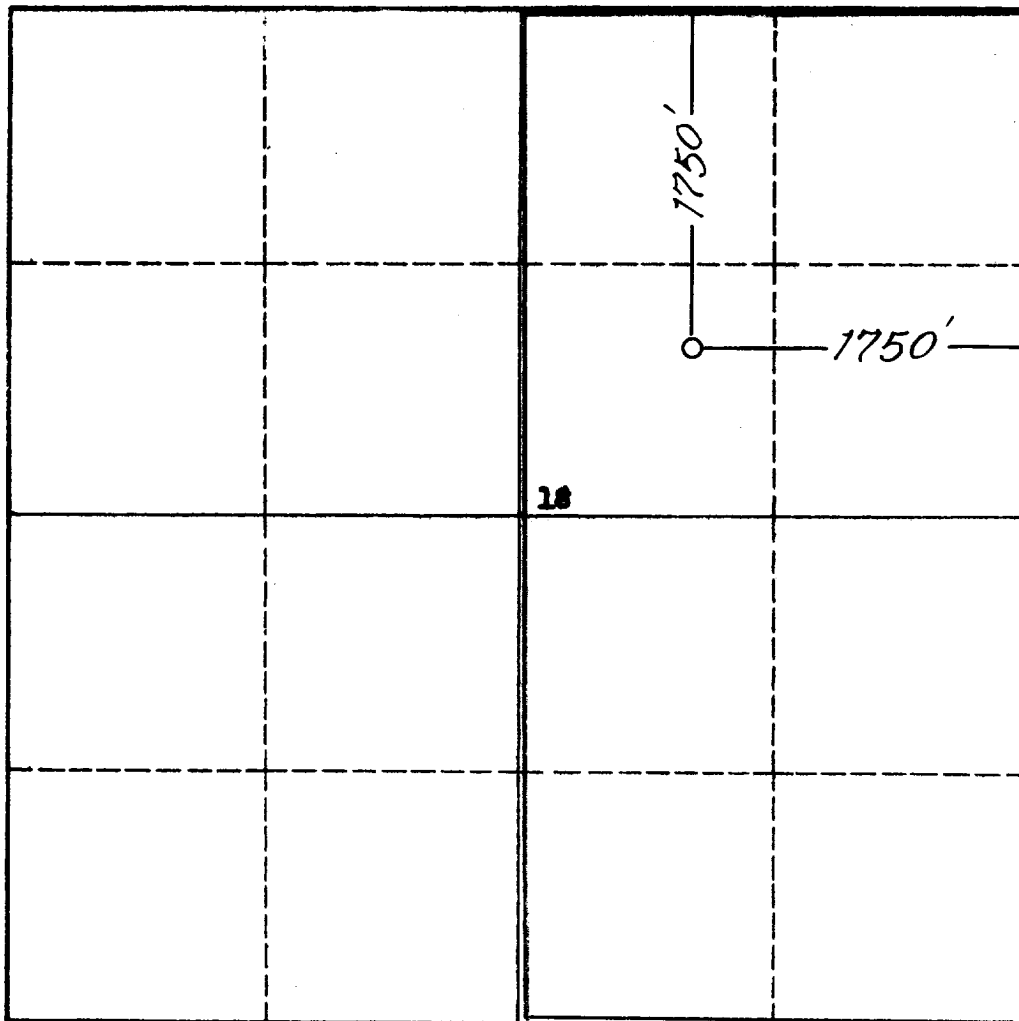

I hereby certify that the information in SECTION A above is true and complete to the best of my knowledge and belief.

Name
J. B. Ladd, Vice resident
Position
Consolidated Oil & Gas, Inc.
Company

Date
May 26, 1960

I hereby certify that the well location shown on the plat in SECTION B was plotted from field notes of actual surveys made by me or under my supervision, and that the same is true and correct to the best of my knowledge and belief.

Date Surveyed
6 April 1960
Registered Professional Engineer and/or Land Surveyor

James P. Leese
Certificate No. **1463**

0 330 660 990 1320 1650 1980 2310 2640 2000 1500 1000 500 0

INSTRUCTIONS FOR COMPLETION OF FORM C-128

1. Operator shall furnish and certify to the information called for in Section A.
2. Operator shall outline the dedicated acreage for *both* oil and gas wells on the plat in Section B.
3. A registered professional engineer or land surveyor registered in the State of New Mexico or approved by the Commission shall show on the plat the location of the well and certify this information in the space provided.
4. All distances shown on the plat must be from the outer boundaries of the Section.
5. If additional space is needed for listing owners and their respective interests as required in question 3 of Section A, please use space below.

STATE OF NEW MEXICO	
OIL AND GAS COMMISSION	
RECORDS AND SURVEY OFFICE	
PLAT NO. _____	
DATE OF RECORDING _____	
SECTION _____	
TOWNSHIP _____	
RANGE _____	
COUNTY _____	
OPERATOR _____	
1	2
✓	✓