

Indian Agency San Juan
Agency, Ignacio, ColoradoAllottee Mountain Ute Tribe
Lease No. 14-00-604-119(SUBMIT IN TRIPPLICATE)
UNITED STATES
DEPARTMENT OF THE INTERIOR
GEOLOGICAL SURVEY

SUNDRY NOTICES AND REPORTS ON WELLS

NOTICE OF INTENTION TO DRILL	<input checked="" type="checkbox"/>	SUBSEQUENT REPORT OF WATER SHUT-OFF	
NOTICE OF INTENTION TO CHANGE PLANS		SUBSEQUENT REPORT OF SHOOTING OR ACIDIZING	
NOTICE OF INTENTION TO TEST WATER SHUT-OFF		SUBSEQUENT REPORT OF ALTERING CASING	
NOTICE OF INTENTION TO REDRILL OR REPAIR WELL		SUBSEQUENT REPORT OF REDRILLING OR REPAIR	
NOTICE OF INTENTION TO SHOOT OR ACIDIZE		SUBSEQUENT REPORT OF ABANDONMENT	
NOTICE OF INTENTION TO PULL OR ALTER CASING		SUPPLEMENTARY WELL HISTORY	
NOTICE OF INTENTION TO ABANDON WELL			

(INDICATE ABOVE BY CHECK MARK NATURE OF REPORT, NOTICE, OR OTHER DATA)

RECEIVED
MAY 22 1957
U. S. GEOLOGICAL SURV.
FARMINGTON, NEW MEXICO
MAY 21, 19 57

Well No. 118-3 is located 990 ft. from N line and 1870 ft. from W line of sec. 18
118-3 (4 Sec. and Sec. No.) 118 (Twp.) 118 (Range) N.M.P.M. (Meridian)
San Juan (County or Subdivision) New Mexico (State or Territory)
San Juan (Field)

The elevation of the ground level above sea level is 9990 ft.

DETAILS OF WORK

(State names of and expected depths to objective sands; show sizes, weights, and lengths of proposed casings; indicate mudding jobs, cementing points, and all other important proposed work)

It is proposed to drill with rotary tools to a depth of 100 feet, set 9-5/8" casing and cement to surface w/100 sacks. Thereafter to drill with rotary tools to the top of the producing zone, run electric log and run 5-1/2" casing at approximately 2000 feet and cement w/30 sacks. Thereafter to drill in with cable tools, run GHI log, free through casing w/20,000 gallons of crude and 20,000 sacks, and test well with cable tool rig until daily rate of production is established, and complete. The height of the section, containing no more, more or less, is dedicated to the well site. Estimated total depth: 2,970 feet.

I understand that this plan of work must receive approval in writing by the Geological Survey before operations may be commenced.

Company FURCO FURNACE CORPORATIONAddress Post Office Box 1419Albuquerque, New MexicoBy Frank D. Gorman, Jr.
Title Vice President

NEW MEXICO
OIL CONSERVATION COMMISSION

Well Location and/or Gas Proration Plat

Form C-122

Date **May 21, 1957**

Operator **PUECO PETROLEUM CO.**

Lease **MOUNTAIN UTE**

Well No. **18-3** Section **18** Township **31 N** Range **14 W** NMPM

Located **990** Feet From **north** Line, **1850** Feet From **west** Line.

San Juan County, New Mexico, G. L. Elevation **5930**

Name of Producing Formation **Callup** Pool **Verde-Callup** Dedicated Acreage **40.000** (40 ac)

(Note: All distances must be from outer boundaries of Section)

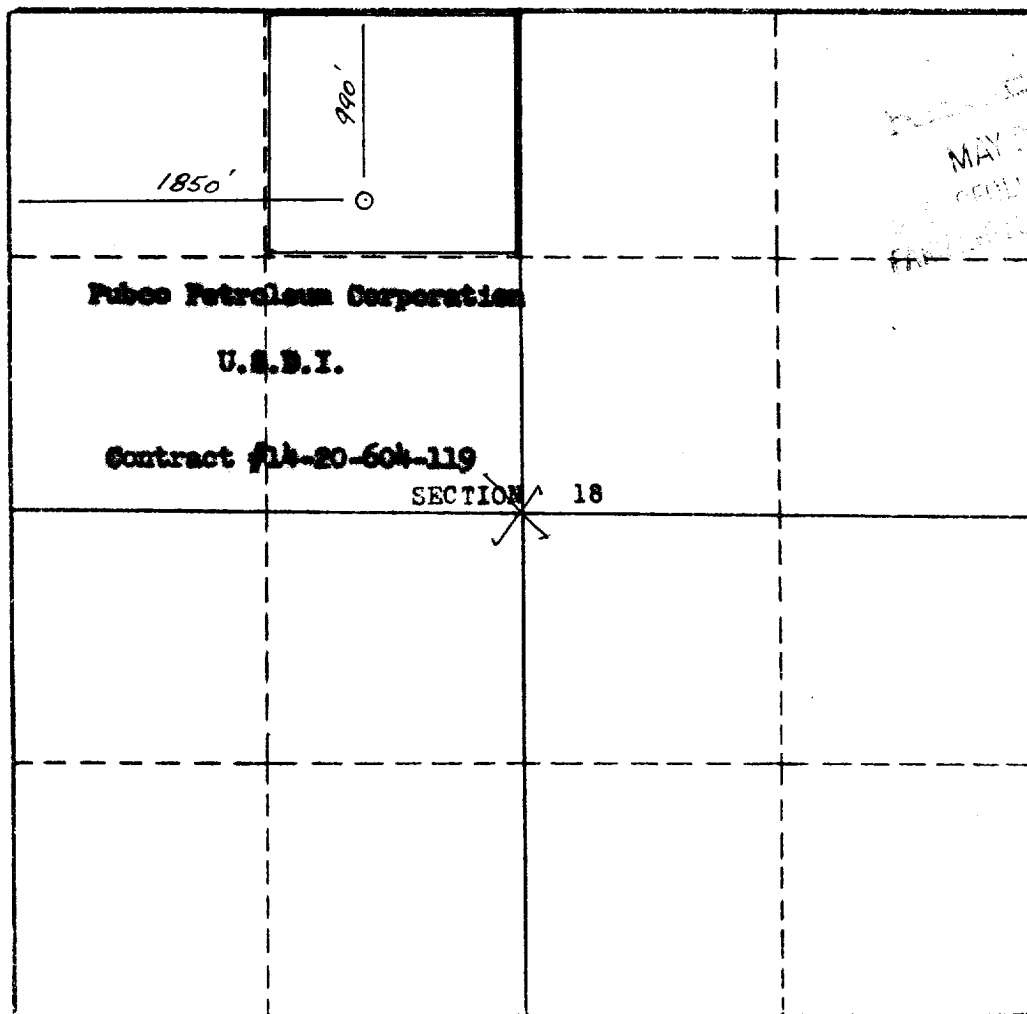

Scale—1 Inch Equals 1000 Feet

1. Is this Well a Dual Comp.? Yes ☐ No ☒
2. If the answer to Question 1 is yes, are there any other dually completed wells within the dedicated acreage? Yes ☐ No ☒

Name **Frank B. Gorman, Jr.**

Position **Vice President**

Representing **Pueco Petroleum Corporation**

Address **Box 1419, Albuquerque, New Mexico**

This is to certify that the above plat was prepared from field notes of actual surveys made by me or under my supervision and that the same are true and correct to the best of my knowledge and belief.

Date Surveyed **May 17, 1957**

Stephen H. Kinney

STEPHEN H. KINNEY,

Registered Professional Engineer and Land Surveyor