

(SUBMIT IN TRIPLICATE)

Indian Agency Ute Indian

UNITED STATES
DEPARTMENT OF THE INTERIOR
GEOLOGICAL SURVEY

Allotted Ute Mountain Tribal
Contract No.
Lease No. 14-00-004-22

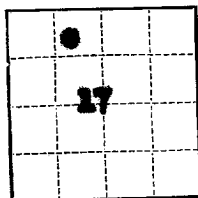

SUNDRY NOTICES AND REPORTS ON WELLS

NOTICE OF INTENTION TO DRILL	<input checked="" type="checkbox"/>	SUBSEQUENT REPORT OF WATER SHUT-OFF	
NOTICE OF INTENTION TO CHANGE PLANS		SUBSEQUENT REPORT OF SHOOTING OR ACIDIZING	
NOTICE OF INTENTION TO TEST WATER SHUT-OFF		SUBSEQUENT REPORT OF ALTERING CASING	
NOTICE OF INTENTION TO REDRILL OR REPAIR WELL		SUBSEQUENT REPORT OF REDRILLING OR REPAIR	
NOTICE OF INTENTION TO SHOOT OR ACIDIZE		SUBSEQUENT REPORT OF ABANDONMENT	
NOTICE OF INTENTION TO PULL OR ALTER CASING		SUPPLEMENTARY WELL HISTORY	
NOTICE OF INTENTION TO ABANDON WELL			

(INDICATE ABOVE BY CHECK MARK NATURE OF REPORT, NOTICE, OR OTHER DATA)

Well No. 3-17 Ute Indian is located 700 ft. from N line and 810 ft. from W line of sec. 17
SW/4 NW/4 Section 17 SW 1W N.M.P.M.
(1/4 Sec. and Sec. No.) (Twp.) (Range) (Meridian)
Verde Gulch San Juan New Mexico
(Field) (County or Subdivision) (State or Territory)

The elevation of the derrick floor above sea level is 6000 ft. G.L.

DETAILS OF WORK

(State names of and expected depths to objective sands; show sizes, weights, and lengths of proposed casings; indicate mudding jobs, cementing points, and all other important proposed work)

Propose to: Set 100' 2-1/8" casing at 100', cement to surface. Drill with Rotary Tools to approximately 2750'. Set 3/4" casing at 2750' with 125 cwt cement. Footnote Casing formation. Sand oil free. Run 2-1/8" tubing to 2700'. Install pump.

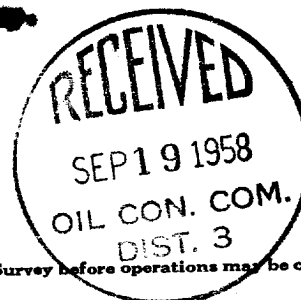

I understand that this plan of work must receive approval in writing by the Geological Survey before operations may be commenced.

Company SOUTHERN UNION GAS COMPANY

Address 1001 HUNT BUILDING
DALLAS, TEXAS

By L. E. Mendenhall
Title Exploration Engineer

NEW MEXICO OIL CONSERVATION COMMISSION
Well Location and Acreage Dedication Plat

Section A.

Date September 16, 1958

Operator SOUTHERN UNION GAS COMPANY Lease UTE INDIAN #3-17
Well No. _____ Unit Letter C Section 17 Township 31 NORTH Range 14 WEST, NMPM
Located 780' Feet From the NORTH Line, 2110 Feet From the WEST Line
County SAN JUAN G. L. Elevation 6041.0 Dedicated Acreage 80 Acres
Name of Producing Formation Gallup Pool Varde Gallup

1. Is the Operator the only owner* in the dedicated acreage outlined on the plat below?
Yes _____ No X.
2. If the answer to question one is "no," have the interests of all the owners been consolidated by communitization agreement or otherwise? Yes X No _____. If answer is "yes," Type of Consolidation Operating Agreement
3. If the answer to question two is "no," list all the owners and their respective interests below:

Owner

Land Description

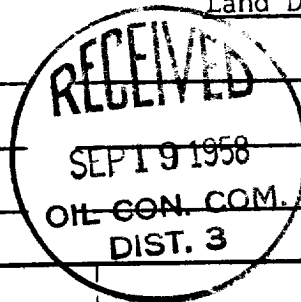

Section B

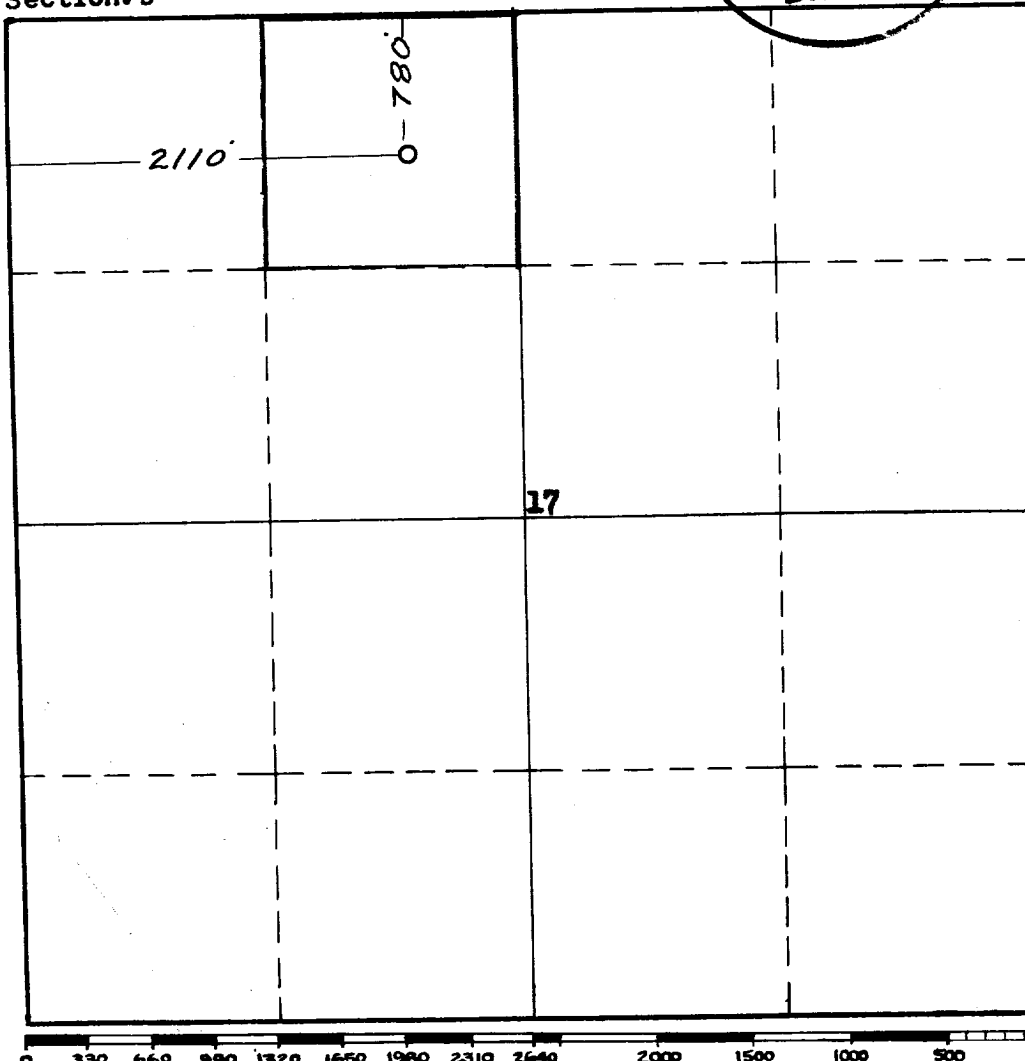

This is to certify that the information in Section A above is true and complete to the best of my knowledge and belief.

SOUTHERN UNION GAS COMPANY

(Operator)

J. L. McNeill
Exploration Engineer

Dart Bldg., Dallas, Texas

Address

This is to certify that the well location shown on the plat in Section B was plotted from field notes of actual surveys made by me or under my supervision and that the same is true and correct to the best of my knowledge and belief.

Date Surveyed 7 September 1958

James P. Leese
Registered Professional
Engineer and/or Land Surveyor.
James P. Leese

Certificate No. 1463

(See instructions for completing this form on the reverse side)