

Form 9-331 b  
(April 1952)

(SUBMIT IN TRIPLICATE)

Indian Agency Navajo Indian  
Center FM-23-423-0000  
Allottee Trust FM  
Lease No. Navajo 24

UNITED STATES  
DEPARTMENT OF THE INTERIOR  
GEOLOGICAL SURVEY

SUNDRY NOTICES AND REPORTS ON WELLS

NOTICE OF INTENTION TO DRILL	<input checked="" type="checkbox"/>	SUBSEQUENT REPORT OF WATER SHUT-OFF	<input type="checkbox"/>
NOTICE OF INTENTION TO CHANGE PLANS	<input type="checkbox"/>	SUBSEQUENT REPORT OF SHOOTING OR ACIDIZING	<input type="checkbox"/>
NOTICE OF INTENTION TO TEST WATER SHUT-OFF	<input type="checkbox"/>	SUBSEQUENT REPORT OF ALTERING CASING	<input type="checkbox"/>
NOTICE OF INTENTION TO REDRILL OR REPAIR WELL	<input type="checkbox"/>	SUBSEQUENT REPORT OF REDRILLING OR REPAIR	<input type="checkbox"/>
NOTICE OF INTENTION TO SHOOT OR ACIDIZE	<input type="checkbox"/>	SUBSEQUENT REPORT OF ABANDONMENT	<input type="checkbox"/>
NOTICE OF INTENTION TO PULL OR ALTER CASING	<input type="checkbox"/>	SUPPLEMENTARY WELL HISTORY	<input type="checkbox"/>
NOTICE OF INTENTION TO ABANDON WELL	<input type="checkbox"/>		<input type="checkbox"/>

(INDICATE ABOVE BY CHECK MARK NATURE OF REPORT, NOTICE, OR OTHER DATA)

July 21, 1959

Well No. 17 is located 2000 ft. from N line and 600 ft. from E line of sec. 24

NE 1/4 Sec. 24  
(1/4 Sec. and Sec. No.)

10N  
(Twp.)

10W  
(Range)

10W  
(Meridian)

Navajo Indian  
(Field)

San Juan  
(County or Subdivision)

New Mexico  
(State or Territory)

The elevation of the surface above sea level is 5000 ft.

DETAILS OF WORK

(State names of and expected depths to objective sands; show sizes, weights, and lengths of proposed casings; indicate mudding jobs, cementing points, and all other important proposed work)

Propose to drill the above well to a total depth of approximately 1700'. Expect to test the Gallup formation at approximately 1400', and any other zones that appear productive of oil or gas.

Casing Patterns: 100' of 8 5/8" cas w/100 lbs  
1700' of 5 1/2" cas w/100 lbs

If necessary propose to mud all from w/100,000 gals.

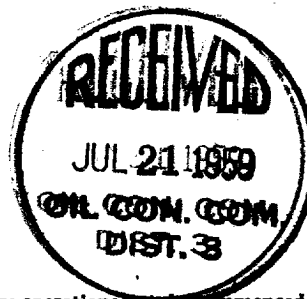

I understand that this plan of work must receive approval in writing by the Geological Survey before operations may be commenced.

Company Navajo Petroleum Company

Address Box 2424

Albia, New Mexico

By [Signature]  
Title District Superintendent

NEW MEXICO OIL CONSERVATION COMMISSION

Well Location and Acreage Dedication Plat

Section A.

Date July 10, 1959

Operator MAGNOLIA PETROLEUM COMPANY Lease "Navajo" A  
Well No. 17 Unit Letter \_\_\_\_\_ Section 14 Township 31N Range 17W NMPM  
Located 2080 Feet From North Line, 660 Feet From East Line  
County San Juan G. L. Elevation 5596 Dedicated Acreage 40 Acres  
Name of Producing Formation Gallup Pool Horseshoe Gallup

1. Is the Operator the only owner\* in the dedicated acreage outlined on the plat below?  
Yes X No \_\_\_\_\_.
2. If the answer to question one is "no," have the interests of all the owners been consolidated by communitization agreement or otherwise? Yes \_\_\_\_\_ No \_\_\_\_\_. If answer is "yes," Type of Consolidation \_\_\_\_\_
3. If the answer to question two is "no," list all the owners and their respective interests below:

Owner

Land Description



Section B

N89° 56' 10" W 5288'

Magnolia Petroleum Co.

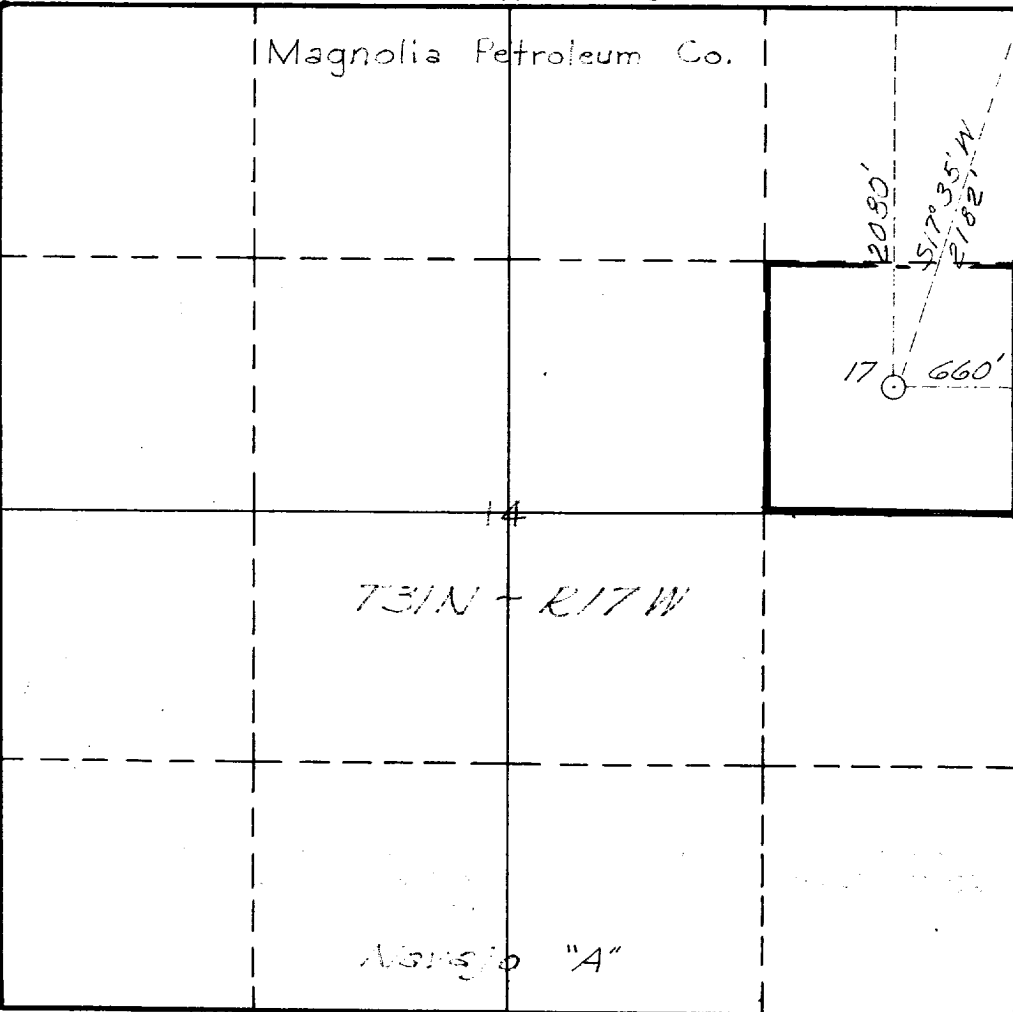

This is to certify that the information in Section A above is true and complete to the best of my knowledge and belief.

Magnolia Petroleum Company  
(Operator)

(Representative)

Box 2406, Hobbs, New Mexico  
Address

This is to certify that the well location shown on the plat in Section B was plotted from field notes of actual surveys made by me or under my supervision and that the same is true and correct to the best of my knowledge and belief.

Date Surveyed July 9, 1959

Carl E. Turner  
Registered Professional  
Engineer and/or Land Surveyor.

Certificate No. 2490

(See instructions for completing this form on the reverse side)