

APPROVED

OCT 26 1962

(SUBMIT IN TRIPLICATE)

UNITED STATES

JERRY W. LONG
DISTRICT ENGINEERDEPARTMENT OF THE INTERIOR
GEOLOGICAL SURVEYBudget Bureau No. 43-R350.4
Approval expires 12-31-60.

Ute Mountain

Indian Agency

Towns, Colorado

Allottee

14-20-151-45

Lease No.

SUNDRY NOTICES AND REPORTS ON WELLS

NOTICE OF INTENTION TO DRILL	<input checked="" type="checkbox"/>	SUBSEQUENT REPORT OF WATER SHUT-OFF	<input type="checkbox"/>
NOTICE OF INTENTION TO CHANGE PLANS	<input type="checkbox"/>	SUBSEQUENT REPORT OF SHOOTING OR ACIDIZING	<input type="checkbox"/>
NOTICE OF INTENTION TO TEST WATER SHUT-OFF	<input type="checkbox"/>	SUBSEQUENT REPORT OF ALTERING CASING	<input type="checkbox"/>
NOTICE OF INTENTION TO REDRILL OR REPAIR WELL	<input type="checkbox"/>	SUBSEQUENT REPORT OF REDRILLING OR REPAIR	<input type="checkbox"/>
NOTICE OF INTENTION TO SHOOT OR ACIDIZE	<input type="checkbox"/>	SUBSEQUENT REPORT OF ABANDONMENT	<input type="checkbox"/>
NOTICE OF INTENTION TO PULL OR ALTER CASING	<input type="checkbox"/>	SUPPLEMENTARY WELL HISTORY	<input type="checkbox"/>
NOTICE OF INTENTION TO ABANDON WELL	<input type="checkbox"/>		

OCT 17 1962
U. S. GEOLOGICAL SURVEY
DURANGO, COLO.

(INDICATE ABOVE BY CHECK MARK NATURE OF REPORT, NOTICE, OR OTHER DATA)

October 16, 1962

Well No. Artes No. 1 is located 885 ft. from S line and 2826 ft. from W line of sec. 19
Sw 1/4 Sec. 19 31 North 15 East N.M.P.M.
 (34 Sec. and Sec. No.) (Twp.) (Range) (Meridian)
Verde Gallup San Juan New Mexico
 (Field) (County or Subdivision) (State or Territory)

The elevation of the derrick floor above sea level is 5735 ft.

DETAILS OF WORK

(State names of and expected depths to objective sands; show sizes, weights, and lengths of proposed casings; indicate mudlogging jobs, cementing points, and all other important proposed work)

It is intended to drill this well in the following manner:

Drill an 8 1/4" hole to the top of the Mancos shale (approx. 700') and run and cement 700' of 7" casing with 150 sacks of cement to shut off all water. Cement to be circulated to the surface.

A 6 1/2" hole will then be drilled with air to approximately 1800' or the top of the Gallup formation where 1800' of 4 1/2" casing will be run and cemented with 60 sacks of cement.

The expected Gallup pay zone will then be cased or drilled with air to an approximate depth of 2150' and the well completed open hole.

If found necessary, the well will be sand-oil-fractured with approximately 25,000 gallons of oil and 25,000 pounds of sand.

Completion procedure will be determined by conditions and/or fluid encountered.

I understand that this plan of work must receive approval in writing by the Geological Survey before operations may be commenced.

M. Martin Oil & Gas Co.

Company 2827 East Camelback

Address Phoenix, Arizona

By E. A. Clement
Agent & Consulting Geologist

Title

NUMBER OF COPIES RECEIVED	
DISTRIBUTION	
SANTA FE	
FILE	
U.S.G.S.	
LAND OFFICE	
TRANSPORTER	OIL GAS
PRODUCTION OFFICE	
OPERATOR	

NEW MEXICO OIL CONSERVATION COMMISSION
WELL LOCATION AND ACREAGE DEDICATION PLAT
 SEE INSTRUCTIONS FOR COMPLETING THIS FORM ON THE REVERSE SIDE

FORM C-128
 Revised 5/1/57

SECTION A

Operator M. Martin Oil & Gas Co.		Lease Aztec		Well No. 1
Unit Letter	Section 10	Township 31 North	Range 15 West	County San Juan
Actual Footage Location of Well: 535 feet from the South line and 2238 feet from the West line				
Ground Level Elev. 5789	Producing Formation Gallup	Pool Verde Gallup	Dedicated Acreage: 40 Acres	

1. Is the Operator the only owner in the dedicated acreage outlined on the plat below? YES _____ NO **X** . ("Owner" means the person who has the right to drill into and to produce from any pool and to appropriate the production either for himself or for himself and another. (65-3-29 (e) NMSA 1935 Comp.)
2. If the answer to question one is "no," have the interests of all the owners been consolidated by communitization agreement or otherwise? YES **X** NO _____. If answer is "yes," Type of Consolidation **Federal**
3. If the answer to question two is "no," list all the owners and their respective interests below:

Owner	Land Description
	OCT 17 1962

SECTION B

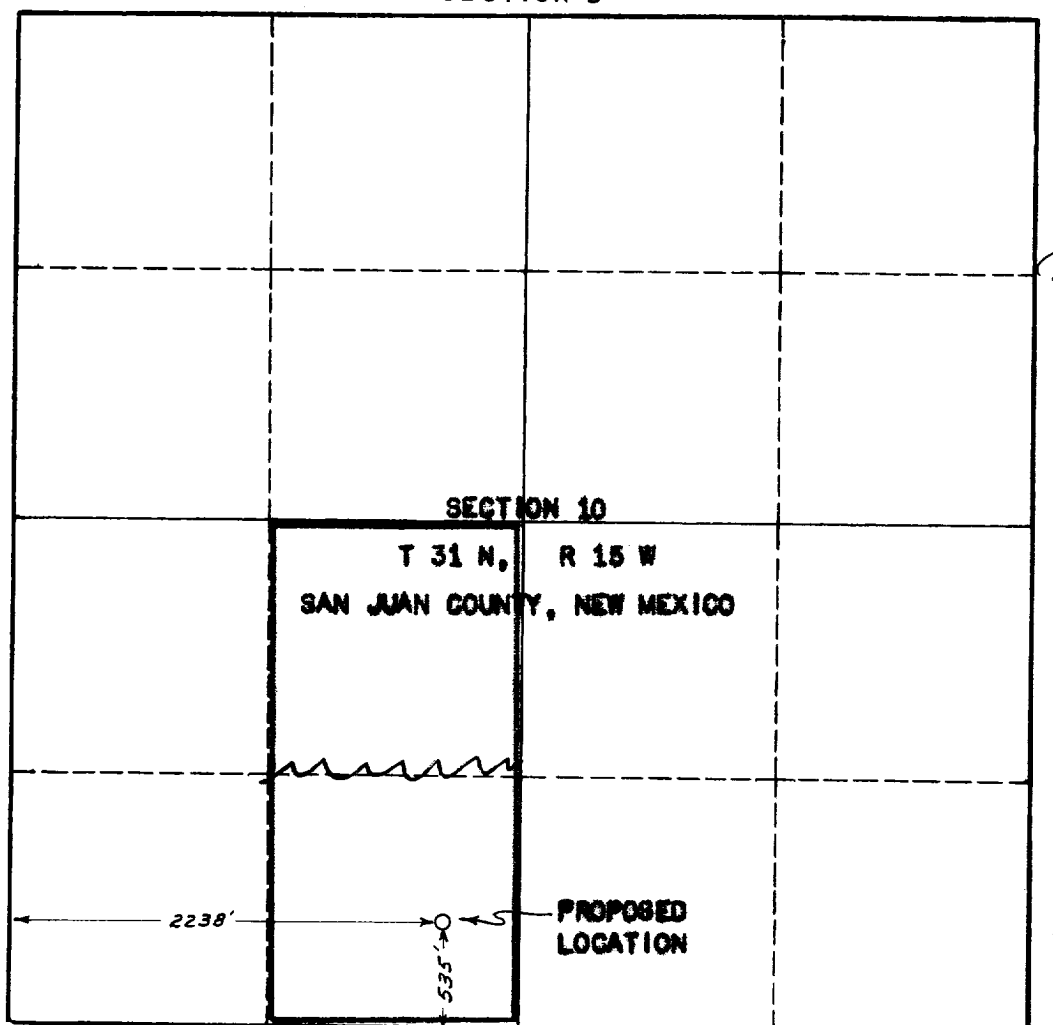

U. S. GEOLOGICAL SURVEY
 DURANGO, COLORADO
CERTIFICATION

I hereby certify that the information in SECTION A above is true and complete to the best of my knowledge and belief.

Name	E. A. Clement
Position	E. A. Clement
Agent & Consulting Geologist	
Company	M. Martin Oil & Gas Co.
Date	October 15, 1962

I hereby certify that the well location shown on the plat in SECTION B was plotted from field notes of actual surveys made by me or under my supervision, and that the same is true and correct to the best of my knowledge and belief.

Date Surveyed	10-4-62
Registered Professional Engineer and/or Land Surveyor	

E. A. Clement
 Certificate No. **3189**

0 330 660 990 1320 1650 1980 2310 2640 2000 1500 1000 500 0

INSTRUCTIONS FOR COMPLETION OF FORM C-128

1. Operator shall furnish and certify to the information called for in Section A.
2. Operator shall outline the dedicated acreage for *both* oil and gas wells on the plat in Section B.
3. A registered professional engineer or land surveyor registered in the State of New Mexico or approved by the Commission shall show on the plat the location of the well and certify this information in the space provided.
4. All distances shown on the plat must be from the outer boundaries of the Section.
5. If additional space is needed for listing owners and their respective interests as required in question 3 of Section A, please use space below.